

FLEX 15x15 HORIZONTAL

0.6x0.6"

- STATIC WHITE
- FREE CUT
- TUNABLE WHITE
- WARM DIM
- RGB

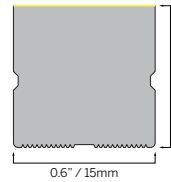
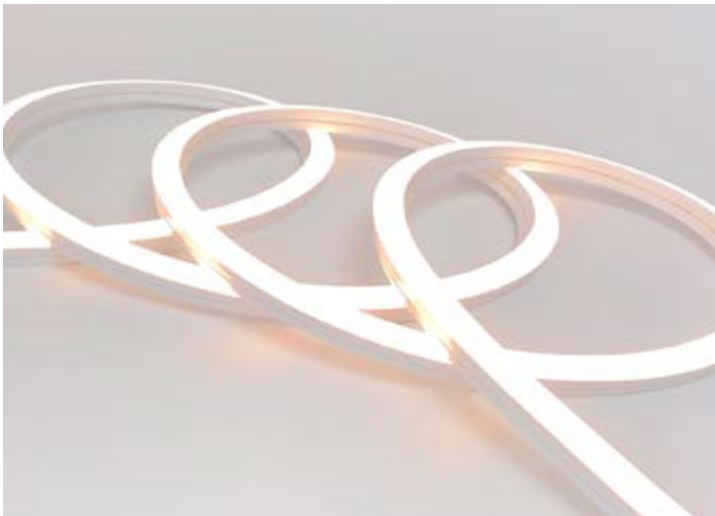

Horizontal Bending

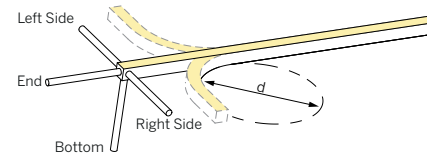

SPECIFICATION	
MATERIAL	Silicone
MOUNTING	Surface
IP RATING	IP67, IP20
BINNING	3 Step
LIFETIME (L70)	50,000hrs based on LM-80 & TM-21 applicable test data
DRIVER REQUIREMENT	24VDC Constant voltage
PROTECTION	UV, flame, salt and chlorine resistant
WARRANTY	5 Years

DRIVERS STATIC WHITE (CRI >90 Ra)

SPECIFICATION (MINIMUM BEND DIAMETER >9.8" / 250 mm)

- DRIVERS
- IES FILES

DRIVER OPTIONS (See driver page for details)	
D010 = eldoLED, 10%, 0-10V dimming, 120-277V	DALI-DT6 = eldoLED DALI (DT6), 0.1% dimming, 120-277V
EL96 = eldoLED 24V, 0.1% 0-10V dimming, 120-277V	UNV96-WL = 0-10V / Phase Dim 96W Wet Location, 1% dimming, 120-277V
DPH = Phase Dimming, 1% dimming, 120V only	
L3D0E = Lutron Hi-lume Premier 0.1% EcoSystem, 120-277V	UNV384-WL = 0-10V / Phase Dim 384W Wet Location, 1% dimming, 120-277V

Cut Interval	DELIVERED LUMENS lm/ft						
	1800K	2400K	2700K	3000K	3500K	4000K	6000K
S05 50 mm (2")	54	71	77	84	85	88	87
S12 50 mm (2")	125	164	179	193	196	202	199

- ACCESSORIES

ORDERING INFORMATION									
MODEL	JACKET	CCT	LED TYPE	CABLE ENTRY	IP RATING	CABLE LENGTH	LENGTH	DRIVERS	
63S1515H Flex 15x15 Horizontal	1 White	C18 1800K	S05 5 W/m (15m max.) 1.5 W/ft (49.2ft max.) S12 12 W/m (6m max.) 3.7 W/ft (19.7ft max.)	E End	7 IP67 2 IP20	003 0.3m (1ft)	.XXXX Length in inches	D010 EL96 DPH L3D0E DALI-DT6 UNV96-WL UNV384-WL	
		C24 2400K		B Bottom		010 1m (3.3ft)			
		C27 2700K		SL Side Left		030 3m (9.8ft)			
		C30 3000K		SR Side Right		050 5m (16.4ft)			
		C35 3500K				100 10m (32.8ft)			
		C40 4000K C60 6000K							
63S1515H	1		S13						

STATIC WHITE - HIGH OUTPUT (CRI >90 Ra)

SPECIFICATION (MINIMUM BEND DIAMETER >9.8" / 250 mm)

- DRIVERS
- IES FILES

DRIVER OPTIONS (See driver page for details)	
D010 = eldoLED, 10%, 0-10V dimming, 120-277V	DALI-DT6 = eldoLED DALI (DT6), 0.1% dimming, 120-277V
EL96 = eldoLED 24V, 0.1% 0-10V dimming, 120-277V	UNV96-WL = 0-10V / Phase Dim 96W Wet Location, 1% dimming, 120-277V
DPH = Phase Dimming, 1% dimming, 120V only	
L3D0E = Lutron Hi-lume Premier 0.1% EcoSystem, 120-277V	UNV384-WL = 0-10V / Phase Dim 384W Wet Location, 1% dimming, 120-277V

Cut Interval	DELIVERED LUMENS lm/ft						
	1800K	2400K	2700K	3000K	3500K	4000K	6000K
S13 62.5 mm (2.5")	216	282	305	332	338	338	343

ORDERING INFORMATION									
MODEL	JACKET	CCT	LED TYPE	CABLE ENTRY	IP RATING	CABLE LENGTH	LENGTH	DRIVERS	
63S1515HOH Flex 15x15 Horizontal High Output	1 White	C18 1800K	S13 13.5 W/m (5m max.) 4.1 W/ft (16.4ft max.)	E End	7 IP67 2 IP20	003 0.3m (1ft)	.XXXX Length in inches	D010 EL96 DPH L3D0E DALI-DT6 UNV96-WL UNV384-WL	
		C24 2400K		B Bottom		010 1m (3.3ft)			
		C27 2700K		SL Side Left		030 3m (9.8ft)			
		C30 3000K		SR Side Right		050 5m (16.4ft)			
		C35 3500K				100 10m (32.8ft)			
		C40 4000K C60 6000K							
63S1515HOH	1		S13						

FLEX 15x15 HORIZONTAL

0.6x0.6"

- STATIC WHITE
- FREE CUT
- TUNABLE WHITE
- WARM DIM
- RGB

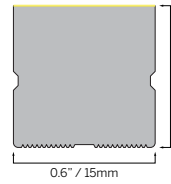

Horizontal Bending

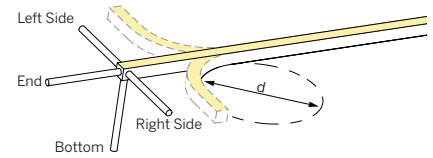

SPECIFICATION	
MATERIAL	Silicone
MOUNTING	Surface
IP RATING	IP67, IP20
BINNING	3 Step
LIFETIME (L70)	50,000hrs based on LM-80 & TM-21 applicable test data
DRIVER REQUIREMENT	24VDC Constant voltage
PROTECTION	UV, flame, salt and chlorine resistant
WARRANTY	5 Years

DRIVERS STATIC WHITE FREE CUT (CRI >90 Ra)

SPECIFICATION (MINIMUM BEND DIAMETER >9.8" / 250 mm)

- IES FILES

DRIVER OPTIONS (See driver page for details)	
D010 = eldoLED, 10%, 0-10V dimming, 120-277V	DALI-DT6 = eldoLED DALI (DT6), 0.1% dimming, 120-277V
EL96 = eldoLED 24V, 0.1% 0-10V dimming, 120-277V	UNV96-WL = 0-10V / Phase Dim 96W Wet Location, 1% dimming, 120-277V
DPH = Phase Dimming, 1% dimming, 120V only	
L3D0E = Lutron Hi-lume Premier 0.1% EcoSystem, 120-277V	UNV384-WL = 0-10V / Phase Dim 384W Wet Location, 1% dimming, 120-277V

Cut Interval	DELIVERED LUMENS lm/ft							
	1800K	2400K	2700K	3000K	3500K	4000K	6000K	
SF05	Free Cut	47	62	72	72	74	79	75
SF12	Free Cut	109	141	165	167	170	183	173

- ACCESSORIES

ORDERING INFORMATION									
MODEL	JACKET	CCT	LED TYPE	CABLE ENTRY	IP RATING	CABLE LENGTH	LENGTH	DRIVERS	
63S1515H Flex 15x15 Horizontal	1 White	C18 1800K	SF05 5 W/m (12.5m max.)	E End	7 IP67	003 0.3m (1ft)	.XXXX Length in inches	D010	
		C24 2400K	1.5 W/ft (41ft max.)	B Bottom	2 IP20	010 1m (3.3ft)		EL96	
		C27 2700K	SF12 12 W/m (6m max.)	SL Side Left		030 3m (9.8ft)		DPH	
		C30 3000K	3.7 W/ft (19.7ft max.)	SR Side Right		050 5m (16.4ft)		L3D0E	
		C35 3500K				100 10m (32.8ft)		DALI-DT6	
		C40 4000K						UNV96-WL	
63S1515H	1							UNV384-WL	

FLEX 15x15 HORIZONTAL

0.6x0.6"

- STATIC WHITE
- FREE CUT
- TUNABLE WHITE
- WARM DIM
- RGB

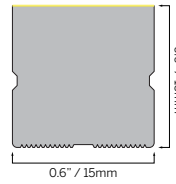
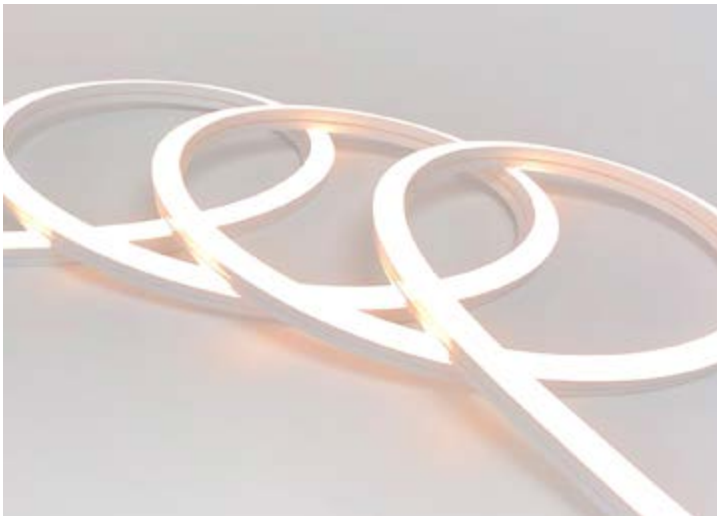

Horizontal Bending

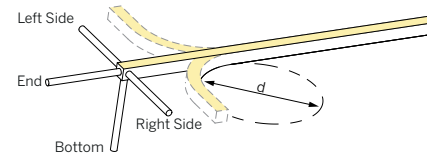

SPECIFICATION	
MATERIAL	Silicone
MOUNTING	Surface
IP RATING	IP67, IP20
BINNING	3 Step
LIFETIME (L70)	50,000hrs based on LM-80 & TM-21 applicable test data
DRIVER REQUIREMENT	24VDC Constant voltage
PROTECTION	UV, flame, salt and chlorine resistant
WARRANTY	5 Years

DRIVERS TUNABLE WHITE (CRI >90 Ra)

SPECIFICATION (MINIMUM BEND DIAMETER >9.8" / 250 mm)

DRIVER OPTIONS (See driver page for details)	
IES FILES	DALI-DT6 = eldoLED DALI (DT6), 0.1% dimming, 120-277V
	DALI-DT8 = eldoLED DALI (DT8), 0.1% dimming, 120-277V

	Cut Interval	DELIVERED LUMENS lm/ft						
		1800K	2400K	2700K	3000K	3500K	4000K	6000K
CT10	62.5 mm (2.5")	93	130	143	151	152	153	159

ACCESSORIES ORDERING INFORMATION

MODEL	JACKET	CCT (LOW)	CCT (HIGH)	LED TYPE*	CABLE ENTRY	IP RATING	CABLE LENGTH	LENGTH	DRIVERS
63S1515H Flex 15x15 Horizontal	1 White	C18 1800K	24 2400K	CT10 2x9.6 W/m (7m max.) 2x2.9 W/ft (23ft max.) <small>* Rated wattage is maximum wattage per channel. Combined power must also not exceed this value.</small>	E End	7 IP67	003 0.3m (1ft)	.XXXX Length in inches	DALI-DT6 DALI-DT8
		C24 2400K	27 2700K		B Bottom	2 IP20	010 1m (3.3ft)		
		C27 2700K	30 3000K		SL Side Left		030 3m (9.8ft)		
		C30 3000K	35 3500K		SR Side Right		050 5m (16.4ft)		
		C35 3500K	40 4000K				100 10m (32.8ft)		
		C40 4000K	60 6000K						
63S1515H	1			CT10					

TUNABLE WHITE - HIGH OUTPUT (CRI >90 Ra)

SPECIFICATION (MINIMUM BEND DIAMETER >9.8" / 250 mm)

DRIVER OPTIONS (See driver page for details)	
IES FILES	DALI-DT6 = eldoLED DALI (DT6), 0.1% dimming, 120-277V
	DALI-DT8 = eldoLED DALI (DT8), 0.1% dimming, 120-277V

	Cut Interval	DELIVERED LUMENS lm/ft						
		1800K	2400K	2700K	3000K	3500K	4000K	6000K
CT10	83.3 mm (3.3")	148	208	228	240	242	244	254
CT13	83.3 mm (3.3")	193	270	297	311	315	318	330

ACCESSORIES ORDERING INFORMATION

MODEL	JACKET	CCT (LOW)	CCT (HIGH)	LED TYPE*	CABLE ENTRY	IP RATING	CABLE LENGTH	LENGTH	DRIVERS
63S1515HOH Flex 15x15 Horizontal High Output	1 White	C18 1800K	24 2400K	CT10 2x10 W/m (4m max.) 2x3 W/ft (13.1ft max.) CT13 2x13 W/m (3m max.) 2x4 W/ft (9.8ft max.) <small>* Rated wattage is maximum wattage per channel. Combined power must also not exceed this value.</small>	E End	7 IP67	003 0.3m (1ft)	.XXXX Length in inches	DALI-DT6 DALI-DT8
		C24 2400K	27 2700K		B Bottom	2 IP20	010 1m (3.3ft)		
		C27 2700K	30 3000K		SL Side Left		030 3m (9.8ft)		
		C30 3000K	35 3500K		SR Side Right		050 5m (16.4ft)		
		C35 3500K	40 4000K				100 10m (32.8ft)		
		C40 4000K	60 6000K						
63S1515HOH	1								

FLEX 15x15 HORIZONTAL

0.6x0.6"

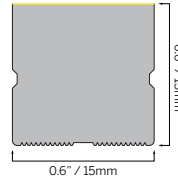
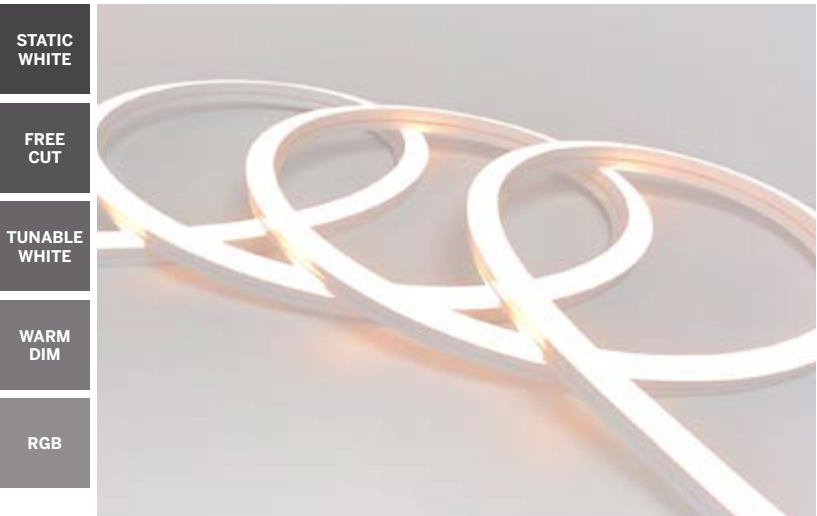

Horizontal Bending

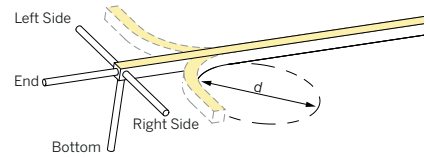

SPECIFICATION	
MATERIAL	Silicone
MOUNTING	Surface
IP RATING	IP67, IP20
BINNING	3 Step
LIFETIME (L70)	50,000hrs based on LM-80 & TM-21 applicable test data
DRIVER REQUIREMENT	24VDC Constant voltage
PROTECTION	UV, flame, salt and chlorine resistant
WARRANTY	5 Years

DRIVERS **WARM DIM (CRI >90 Ra)**
 SPECIFICATION (MINIMUM BEND DIAMETER >11.8" / 300 mm)

DRIVER OPTIONS (See driver page for details)

MAGSDM96-WD = 0-10V / Phase Dim 96W, 0.1% CCR Dimming for Warm Dim, 120-277V (Phase - 120V only)
--

	DELIVERED LUMENS lm/ft		
	Cut Interval	2700K	3000K
14R	83.33 mm (2")	151	164

ACCESSORIES ORDERING INFORMATION

MODEL	JACKET	CCT	LED TYPE	CABLE ENTRY	IP RATING	CABLE LENGTH	LENGTH	DRIVERS
63S1515H Flex 15x15 Horizontal	1 White	C2718W 2700-1800K C3018W 3000-1800K	14R 14 W/m (5m max.) 4.3 W/ft (16.4ft max.)	E End B Bottom SL Side Left SR Side Right	7 IP67 2 IP20	003 0.3m (1ft) 010 1m (3.3ft) 030 3m (9.8ft) 050 5m (16.4ft) 100 10m (32.8ft)	.XXXX Length in inches	MAGSDM96-WD
63S1515H	1		14R					MAGSDM96-WD

FLEX 15x15 HORIZONTAL

0.6x0.6"

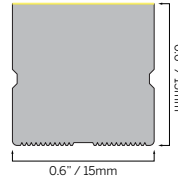
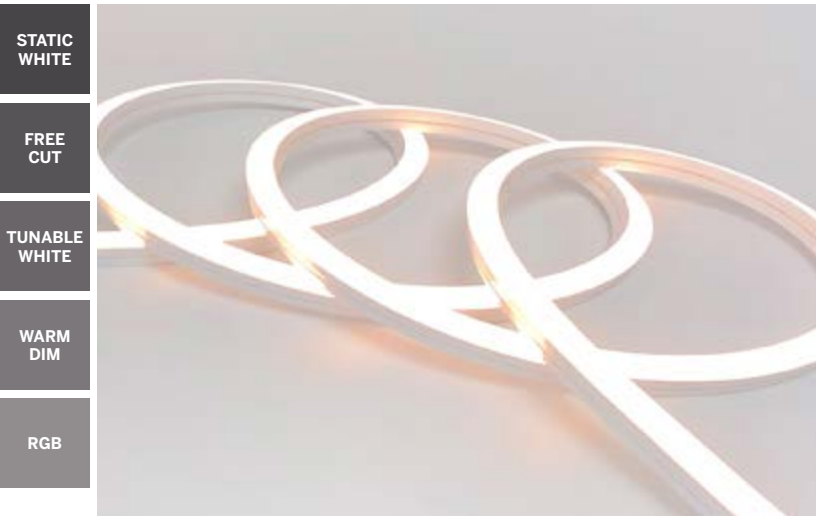

Horizontal Bending

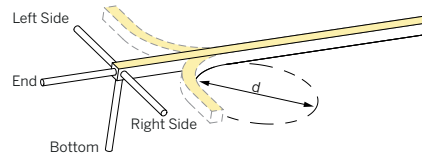

SPECIFICATION	
MATERIAL	Silicone
MOUNTING	Surface
IP RATING	IP67, IP20
BINNING	3 Step
LIFETIME (L70)	50,000hrs based on LM-80 & TM-21 applicable test data
DRIVER REQUIREMENT	24VDC Constant voltage
PROTECTION	UV, flame, salt and chlorine resistant
WARRANTY	5 Years

DRIVERS

RGB

SPECIFICATION (MINIMUM BEND DIAMETER >11.8" / 300 mm)

DRIVER OPTIONS (See driver page for details)
DMX = eldoLED, 24V, 0.1% DMX Dimming

	DELIVERED LUMENS lm/ft			
	Cut Interval	RED	GREEN	BLUE
S12	62.5 mm (2.5")	26	78	17

ACCESSORIES

ORDERING INFORMATION

MODEL	JACKET	CCT	LED TYPE	CABLE ENTRY	IP RATING	CABLE LENGTH	LENGTH	DRIVERS
63S1515H Flex 15x15 Horizontal	1 White	RGB RGB	S12 12 W/m (6m max.) 3.7 W/ft (19.7ft max.)	E End B Bottom SL Side Left SR Side Right	7 IP67 2 IP20	003 0.3m (1ft) 010 1m (3.3ft) 030 3m (9.8ft) 050 5m (16.4ft) 100 10m (32.8ft)	.XXXX Length in inches	DMX
63S1515H	1	RGB	S12					DMX

FLEX 15x15 HORIZONTAL

0.6x0.6"

ACCESSORIES

STATIC WHITE

TYPE Aluminum profile
MOUNTING Surface mount

FREE CUT

ORDERING INFORMATION

MODEL	FINISH	LENGTH
63S1515X	5AP Silver	0030 30mm (1.18")
	2AP Black	1000 1000mm (39.37")
63S1515X		

TUNABLE WHITE

WARM DIM

RGB

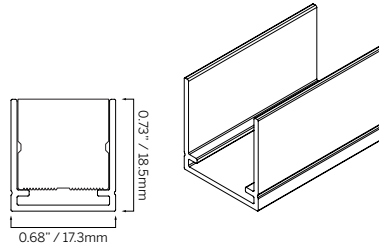

30

1000

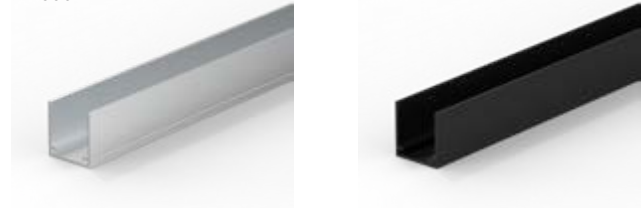

DRIVERS

TYPE Locking profile
MOUNTING Surface mount

IES FILES

ORDERING INFORMATION

MODEL	FINISH	LENGTH
63S1515X	5LP Silver	0035 35mm (1.38")
	2LP Black	1000 1000mm (39.37")
		2000 2000mm (78.74")
		2500 2500mm (98.43")
63S1515X		

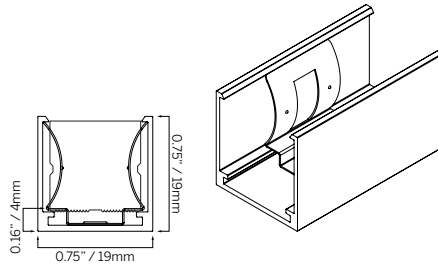

35

1000/2000/2500



TYPE Deep Self Locking Profile
MOUNTING Surface mount

ORDERING INFORMATION

MODEL	FINISH	LENGTH
63S1515X	5LPC Silver	0035 35mm (1.38")
	2LPC Black	1000 1000mm (39.37")
63S1515X		

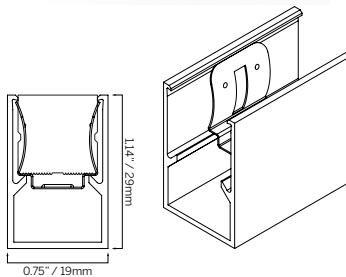

35

1000



FLEX 15x15 HORIZONTAL

0.6x0.6"

ACCESSORIES

STATIC WHITE

TYPE Stainless Mounting Clip
MOUNTING Surface mount

FREE CUT

ORDERING INFORMATION

MODEL	FINISH	LENGTH
63S1515H	5SC Silver 2SC Black	0020 20mm (0.79") 1000 1000mm (39.37")
63S1515H		

TUNABLE WHITE

WARM DIM

RGB

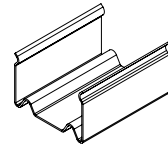
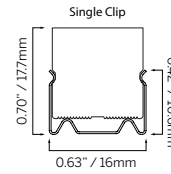

DRIVERS

IES FILES

ACCESSORIES

TYPE Stainless Bendable Profile
MOUNTING Surface mount

ORDERING INFORMATION

MODEL	FINISH	LENGTH
63S1515X	5SC Silver 2SC Black	1000 1000mm (39.37")
63S1515X		1000

