

20 Linear Recessed Regressed



inter•lux



Contents

- 1 overview
- 2 specifications / configurator
- 3 photometry

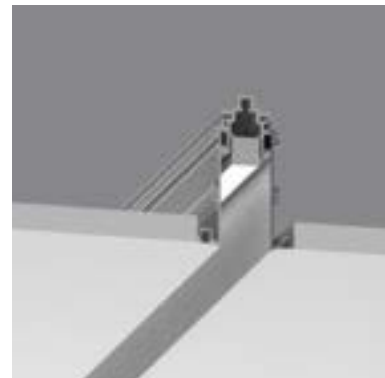

Miniature, recessed linear downlight with regressed lens for low brightness. Trimless and bezel trim for seamless integration into any drywall, wood and metal surfaces.

QS Quick Ship Available

- Recessed fixture with fully regressed light for continuous mounting to any desired length (1/4" increments), as well as standard grid multiples.
- Multiple lens options for diffuse, high efficiency and luminous effect.
- Extruded aluminum housing, easily installed. Field maintainable and upgradeable LED and driver without upsetting the ceiling.
- Efficacy up to 47 lumens per watt (delivered) @ 3000K, see photometry page for details.
- 90+ CRI, 3 Step MacAdam (Static White).
- L70 (TM21 Projected 85C) Static White 60,000 hours, RGBW / Tunable White 50,000 hours, WD 36,000 hours.
- ETL and ETL-C for dry and damp locations.
- Lengths and angles factory cut to exact field dimensions.
- Powdercoat painted.

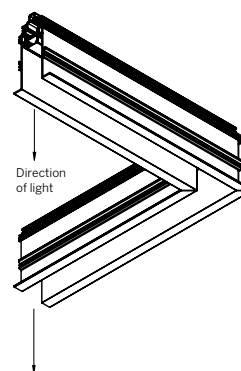
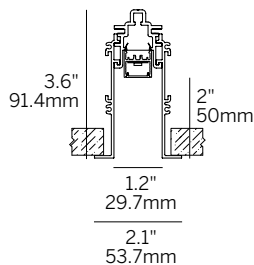
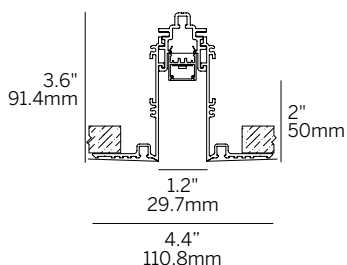

Pattern Corner

Minimum Angle 45°
Maximum Angle 180°

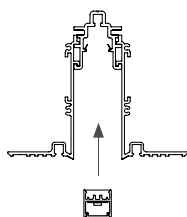
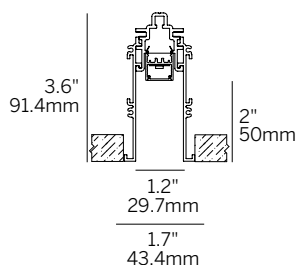

Ordering Information									
Model	Fixation	Pattern	Length	Power ²	CRI/CCT ³	Driver ⁴	Lens	Finish	Options
WG-20LRR	RPT RBT RRT RGT9 RGT15	S P ¹ PZ ¹	A A x B A x B x C A x B x A x B	L M H P0 P1 P2 P3	927 930 935 940 WD RGBW TW1840 TW2765	X L3D0E S EL96 D010 DALI DPH DMX L3DAE D2DT6 D2DT8	OD (std) MPL NL16 LL45B ⁵ LL45W ⁵	W (std) B S F	AWNRF BT EM WL ⁵

Model

- WG-20LRR = 20 Linear Recessed Regressed

Fixation

- RPT = Recessed plaster trim
- RBT = Recessed bezel trim
- RRT = Recessed return trim
- RGT9 = Recessed grid trim 9/16"
- RGT15 = Recessed grid trim 15/16"

Pattern

- S = Straight run
- P = Standard patterns 2, 3 or 4 sided with 90° corners on the same plane¹
- PZ = Non-standard patterns and/or corners other than 90° on multiple planes, consult factory¹

Length

- A, B, C = specify inches to the nearest 0.25" (i.e. 72.25")
For patterns specify each length (i.e. 2 sided: A x B = 72.25" x 48";
3 sided: A x B x C; 4 sided: A x B x A x B)
- For 2 and 4 foot fixtures to fit ceiling grids specify 24" and 48" lengths

Power²

- L = 3W/ft low power (WD 2.7 W/ft) (24V)
- M = 6W/ft mid power (WD 5.5 W/ft) (24V)(RGBW - 7.6 W/ft)
- H = 10W/ft high power (WD 8 W/ft) (24V)
- P0 = 1.5 W/ft
- P1 = 3 W/ft
- P2 = 6 W/ft
- P3 = 10 W/ft

CRI / CCT (90+ CRI minimum)³

- 927 = 2700K
- 930 = 3000K
- 935 = 3500K
- 940 = 4000K
- WD = Warm Dimming (1800K - 3000K)
- RGBW = 3000K White (M power only)
- TW1840 = Tunable white (1800K - 4000K)
- TW2765 = Tunable white (2700K - 6500K)

Driver (remote)⁴

- X = No driver, ordered separately
- S = Standard, non-dim driver 120-277V
- D010 = eldoLED, 10%, 0-10V dimming, 120-277V
- DPH = Phase Dimming, 1% dimming, 120V only
- L3DAE = Lutron Hi-lume 1% EcoSystem, 120-277V
- L3D0E = Lutron Hi-lume Premier 0.1% EcoSystem, 120-277V
- DALI = eldoLED DALI (DT6), 0.1% dimming (120-277V)
- DMX = eldoLED, 24V, 0.1% DMX Dimming
- D2DT6 = DALI-2 (DT6), 0.1% dimming (120-277V) [TW only]
- D2DT8 = DALI-2 (DT8), 0.1% dimming (120-277V) [TW only]

Lens

- OD = Satin opal diffuser (standard)
- MPL = Micro-prismatic lens
- NL16 = Linear narrow lens, 16°
- LL45B = Linear louver black⁵
- LL45W = Linear louver white⁵

Finish

- W = White, 15% gloss, RAL 9010 (standard)
- B = Black, 15% gloss, RAL 9005
- S = Silver, 15% gloss, RAL 9006
- F = Custom finished trim, specify RAL

Options

- AWNRF = Lutron Athena Wireless Node RF (specify with D010, EL96, DALI or D2DT6/D2DT8 for TW)
- BT = Wireless CAS - Casambi (specify with D010, EL96, DALI, DMX or D2DT6/D2DT8 for TW)
- EM = Emergency (remote)
- WL = Wet Location Under Canopy / Cover⁶

- See pattern spec sheet.
- Wattage shown is for LED boards only, system wattage varies depending on driver selected.
- See photometric data sheet for delivered lumens.
- Remote power supply required. See power supply page for details.
- Louver available in 0.5" increments.
- Wet Location option available for OD / MPL lenses and recessed / surface ceiling applications only.

Lenses/Accessories

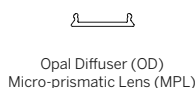

Cutout Dimensions

RPT = 2.25" width / length + ¼"
RBT = 1.75" width / length + ¼"
RRT = 1.75" width / length + ¼"

20 Linear Recessed Regressed

WG-20LRR-...-OD-W Delivered Lumens Per Foot					
		Power			
		L [3 W/ft]	M [6 W/ft]	H [10 W/ft]	RGBW [7.6 W/ft]
CCT	927	124	248	435	-
	930	135	270	472	-
	935	160	321	561	-
	940	190	381	667	-
	WD ²	95	197	286	-
	RGBW ³	-	-	-	161
UGR ⁴		24.3	26.9	28.7	-

		Power			
		PO [1.5 W/ft]	P1 [3 W/ft]	P2 [6 W/ft]	P3 [10 W/ft]
CCT	TW1840 ⁵	118	230	427	657
	TW2765 ⁵	118	224	421	657

WG-20LRR-...-LL45B-W Delivered Lumens Per Foot					
		Power			
		L [3 W/ft]	M [6 W/ft]	H [10 W/ft]	RGBW [7.6 W/ft]
CCT	927	47	93	163	-
	930	51	101	177	-
	935	60	121	211	-
	940	72	143	251	-
	WD ²	36	74	107	-
	RGBW ³	-	-	-	61
UGR ⁴		11.2	13.7	15.5	-

		Power			
		PO [1.5 W/ft]	P1 [3 W/ft]	P2 [6 W/ft]	P3 [10 W/ft]
CCT	TW1840 ⁵	44	86	160	247
	TW2765 ⁵	44	84	158	247

WG-20LRR-...-LL45W-W Delivered Lumens Per Foot					
		Power			
		L [3 W/ft]	M [6 W/ft]	H [10 W/ft]	RGBW [7.6 W/ft]
CCT	927	91	181	317	-
	930	99	197	345	-
	935	117	234	410	-
	940	139	278	487	-
	WD ²	69	144	209	-
	RGBW ³	-	-	-	118
UGR ⁴		17.7	20.3	22.1	-

		Power			
		PO [1.5 W/ft]	P1 [3 W/ft]	P2 [6 W/ft]	P3 [10 W/ft]
CCT	TW1840 ⁵	86	168	311	480
	TW2765 ⁵	86	164	307	480

Power Multiplier				
	L [3 W/ft]	M [6 W/ft]	H [10 W/ft]	RGBW [7.6 W/ft]
9XX/RGBW	0.29	0.57	1.00	0.29
WD	0.17	0.35	0.51	-

Power Multiplier				
	PO [1.5 W/ft]	P1 [3 W/ft]	P2 [6 W/ft]	P3 [10 W/ft]
TW1840	0.21	0.41	0.76	1.17
TW2765	0.21	0.40	0.75	1.17

CCT Multiplier				
	927	930	935	940
	0.77	0.84	1.00	1.19

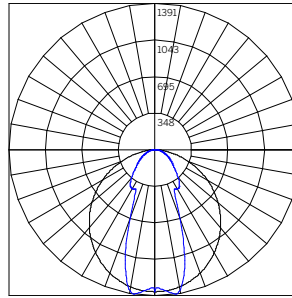

BEAM ANGLE (0-180) = 40.0
BEAM ANGLE (90-270) = 110.3

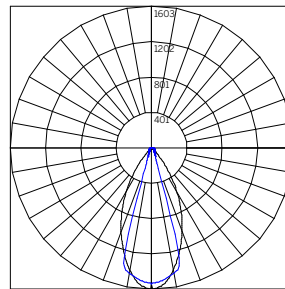

BEAM ANGLE (0-180) = 31.2
BEAM ANGLE (90-270) = 49.6

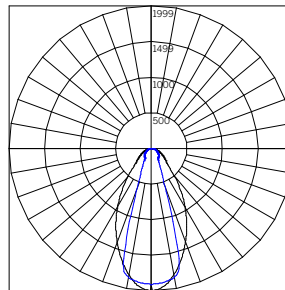

BEAM ANGLE (0-180) = 34.1
BEAM ANGLE (90-270) = 57.7

ILLUMINANCE - 48" OD H 3500K WG-20LRR-...-S-48-H-935-...-OD-W-... ¹		
Mounting Height [ft]	Illuminance [fc at max cd]	Beam Width [ft]
2	348	1.5
4	87	2.9
6	39	4.4
8	22	5.8
10	14	7.3
12	10	8.7
14	7	10.2
16	5	11.7
18	4	13.1
20	3	14.6

ILLUMINANCE - 48" LL45B H 3500K WG-20LRR-...-S-48-H-935-...-LL45B-W-... ¹		
Mounting Height [ft]	Illuminance [fc at max cd]	Beam Width [ft]
2	401	1.1
4	100	2.2
6	45	3.3
8	25	4.5
10	16	5.6
12	11	6.7
14	8	7.8
16	6	8.9
18	5	10
20	4	11.2

ILLUMINANCE - 48" LL45W H 3500K WG-20LRR-...-S-48-H-935-...-LL45W-W-... ¹		
Mounting Height [ft]	Illuminance [fc at max cd]	Beam Width [ft]
2	500	1.2
4	125	2.5
6	56	3.7
8	31	4.9
10	20	6.1
12	14	7.4
14	10	8.6
16	8	9.8
18	6	11
20	5	12.3

- 1 Polar Plot and Cone of Light are applicable to part number noted; use Multiplication Factor table to approximate other models or refer to online photometry.
- 2 WD lumen data at maximum output (3000K).
- 3 RGBW lumen data at maximum output with 3000K White LED.
- 4 UGR value noted is the maximum UGR (crosswise) with 935 LEDs / 48" length.
- 5 TW lumen data at maximum output (4000K and 6500K, respectively). TW1840 produces approx. 40% less lumens at 1800K; TW2765 produces approx. 5% less lumens at 2700K.