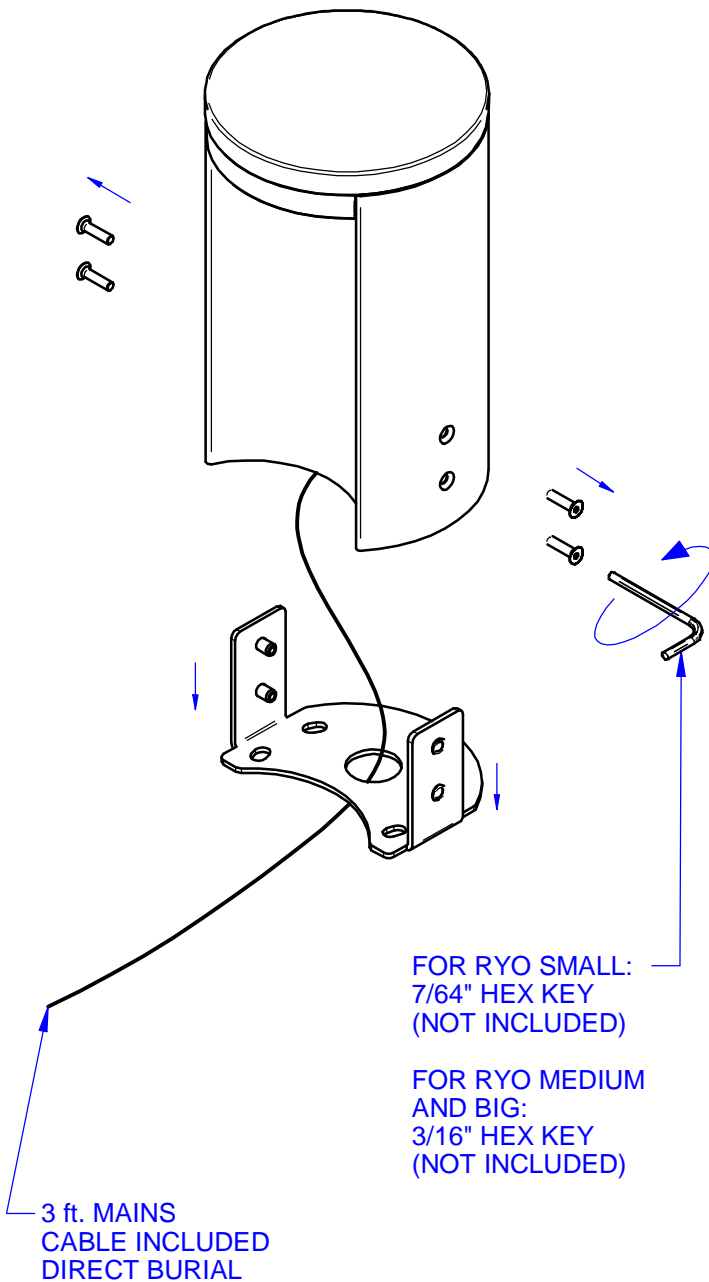
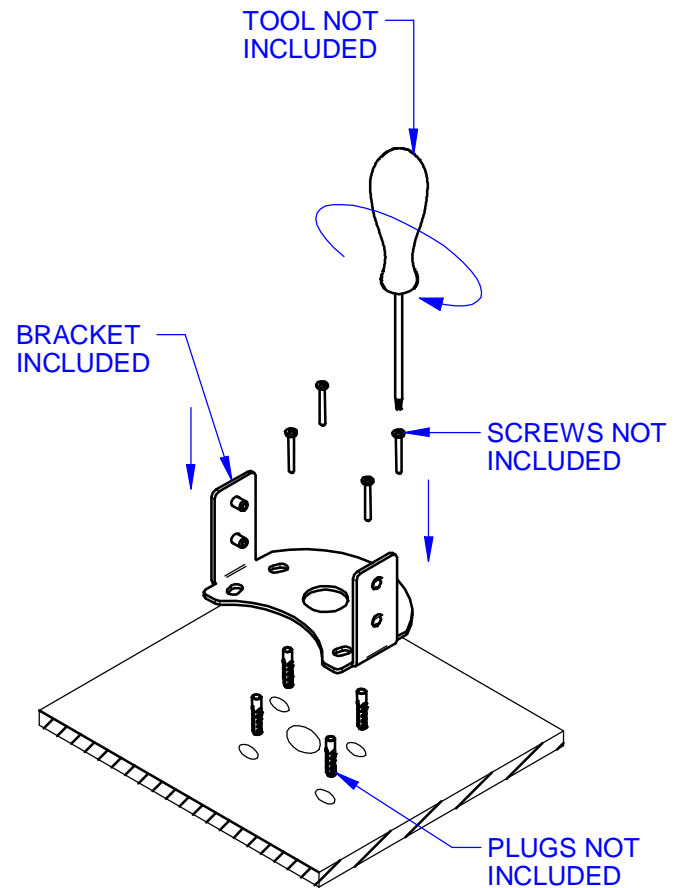

1

(Asymmetric Emission shown)

**2****Wiring diagram**

Mains Cable Colors	Pole
Black wire	L
White wire	N
Green wire	GROUND
Purple wire	+ Dim
Grey wire	- Dim

1. Insert 2 or 3 stripped wires completely into the connector and check their position by looking through the translucent connector body.
2. Hold the tool perpendicular to the wires and make the connection by driving the cap down flush with the top edge of the connector body.

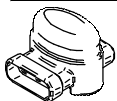
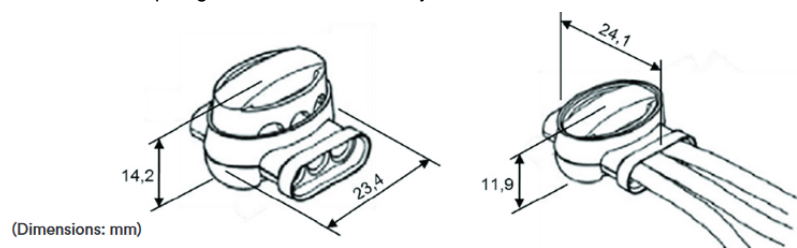
**5pcs included**

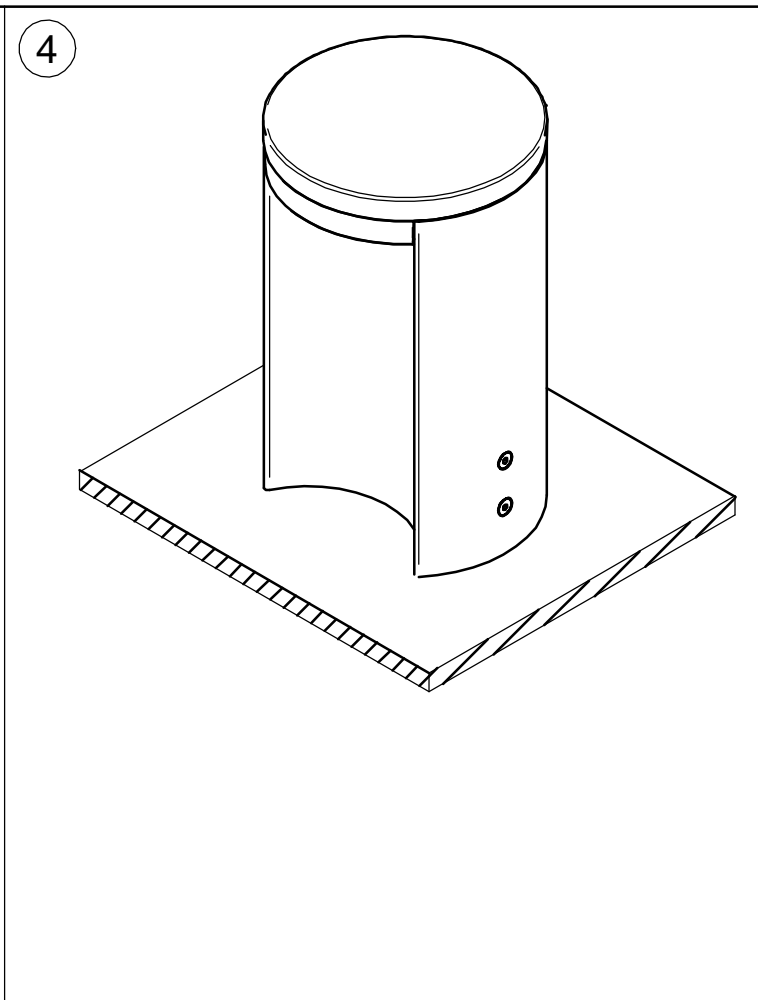
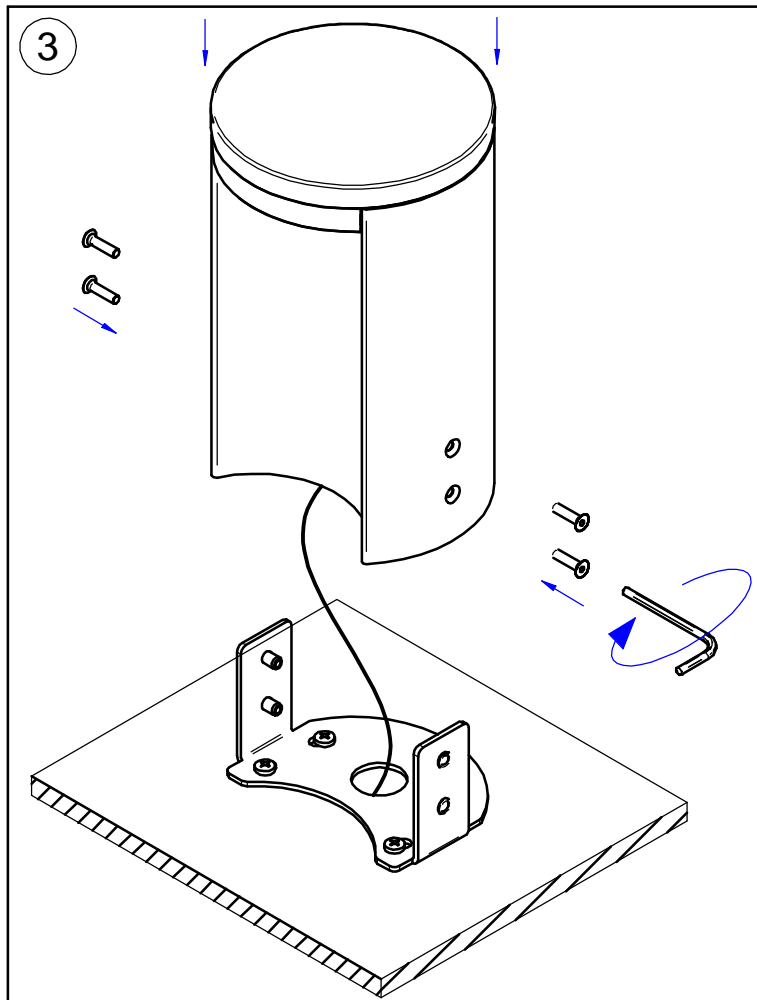

BRACKET FOR RYO ASYMMETRIC EMISSION

(Included with fixture)

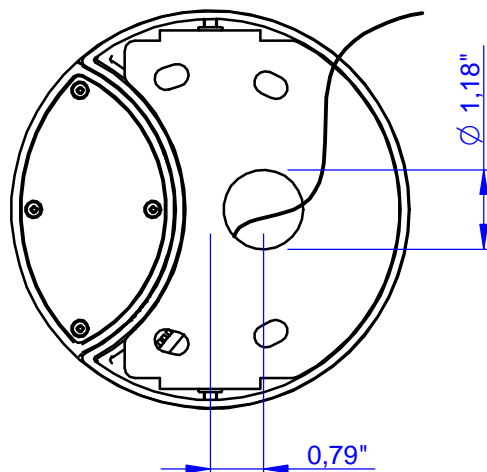

BRACKET FOR RYO ROUND EMISSION

(Included with fixture)

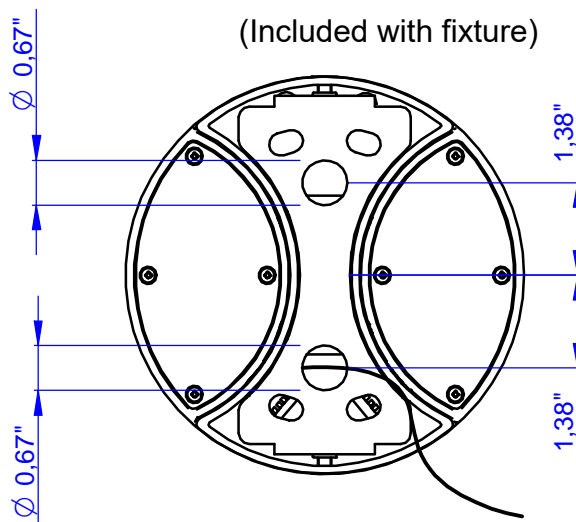

THIS PRODUCT MUST BE INSTALLED IN ACCORDANCE WITH THE APPLICABLE INSTALLATION CODE BY A PERSON FAMILIAR WITH THE CONSTRUCTION AND OPERATION OF THE PRODUCT AND THE HAZARDS INVOLVED

MOUNTING INSTRUCTIONS

READ ALL OF THESE INSTRUCTIONS BEFORE INSTALLING FIXTURES

- CAUTION: USE ONLY WITH CLASS 2 POWER UNIT
- Keep all of the instructions for future reference
- Turn off power before installing fixture
- Installation is to be performed by a qualified electrician only
- All installations must conform to the National Electrical Code as well as all local jurisdictional codes and regulations
- Any modification of the luminaire will void any and all written or implied warranties
- The manufacture accepts no responsibility for damage to persons or property arising through improper use or installation

INSTALLATION SEQUENCE

- Ensure power is off before connecting driver to line voltage
- Unscrew the screws for remove the bracket from the Ryo [1]
- Fix the bracket on the ground/floor [2]
- Connect mains wiring to fixture wiring
- Fix the Ryo on the bracket with the screws [3]
- Energize