



20 Linear

whitegoods

# whitegoods

Whitegoods has developed the most complete range of small scale linear fittings and integration profiles to illuminate any interior space. The 20 Linear range was conceived to apply the right quality and quantity of illumination to the space while minimizing the source of the light and eliminating obtrusive light spill - all while holding true to our brand philosophy:

- Reduction of detail
- Seamless architectural integration
- Logical, modular systems and families of products
- Ease of specification, installation and maintenance



## 20 Linear

The 20 Linear range is the most flexible architectural lighting tool developed to allow designers the freedom to work with light in an instinctive way.

Utilizing the small form factor, the range includes a family of profiles all based around the same high performance linear LED technology, developed by Whitegoods specifically for this product line. Coves, coffers, perimeter wash and seamless lines, all beautifully rendered with smooth even light.

This is Whitegoods:  
this is 20 Linear.





whitegoods

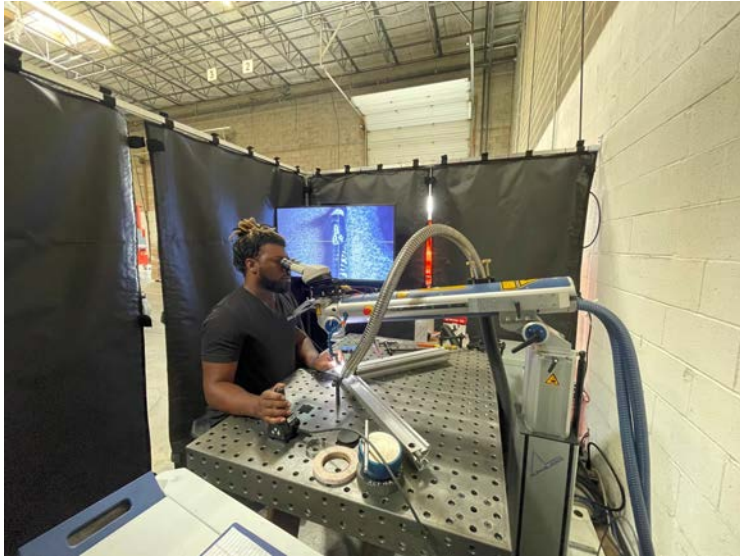



1925

To celebrate its 50th anniversary, ABA establishes the Educational Foundation with a \$500,000 endowment.



1949

ABA supports the first effort by establishing the National Center for Consumer Education.



ABA sponsors adoption of SEC's first common practice language for check clearing, endorsing, check payment.

1956

ABA sponsors the first check clearing, endorsing, check payment.

1968

ABA sponsors the first check clearing, endorsing, check payment.

ABA sponsors the first check clearing, endorsing, check payment.

ABA sponsors the first check clearing, endorsing, check payment.

ABA sponsors the first check clearing, endorsing, check payment.

ABA sponsors the first check clearing, endorsing, check payment.

ABA sponsors the first check clearing, endorsing, check payment.

ABA sponsors the first check clearing, endorsing, check payment.

ABA sponsors the first check clearing, endorsing, check payment.

ABA sponsors the first check clearing, endorsing, check payment.

ABA sponsors the first check clearing, endorsing, check payment.

ABA sponsors the first check clearing, endorsing, check payment.

ABA sponsors the first check clearing, endorsing, check payment.

ABA sponsors the first check clearing, endorsing, check payment.

ABA sponsors the first check clearing, endorsing, check payment.

ABA sponsors the first check clearing, endorsing, check payment.

ABA sponsors the first check clearing, endorsing, check payment.

ABA sponsors the first check clearing, endorsing, check payment.

ABA sponsors the first check clearing, endorsing, check payment.

ABA sponsors the first check clearing, endorsing, check payment.

ABA sponsors the first check clearing, endorsing, check payment.

ABA sponsors the first check clearing, endorsing, check payment.

ABA sponsors the first check clearing, endorsing, check payment.

ABA sponsors the first check clearing, endorsing, check payment.

ABA sponsors the first check clearing, endorsing, check payment.

ABA sponsors the first check clearing, endorsing, check payment.

ABA sponsors the first check clearing, endorsing, check payment.

ABA sponsors the first check clearing, endorsing, check payment.

# 20 Linear

whitegoods



20 Linear Recessed



20 Linear Wash Light Surface



20 Linear Perimeter Recessed



20 Linear Surface



20 Linear Wash Light Suspended



20 Linear Mini Edgeless Cove



20 Linear Suspended



20 Linear Wash Light Semi-Recessed



Mini Edgeless Cove + 20 Linear Direct



20 Linear Direct/Indirect Suspended



20 Linear Recessed Flush



20 Linear Mini Z Cove



20 Linear Direct/Indirect Surface Wall



20 Linear Recessed Regressed



20 Linear Under Cabinet



20 Linear Wash Light Recessed



20 Linear Perimeter Flush

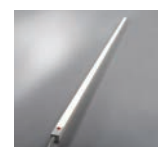

20 Linear Wand

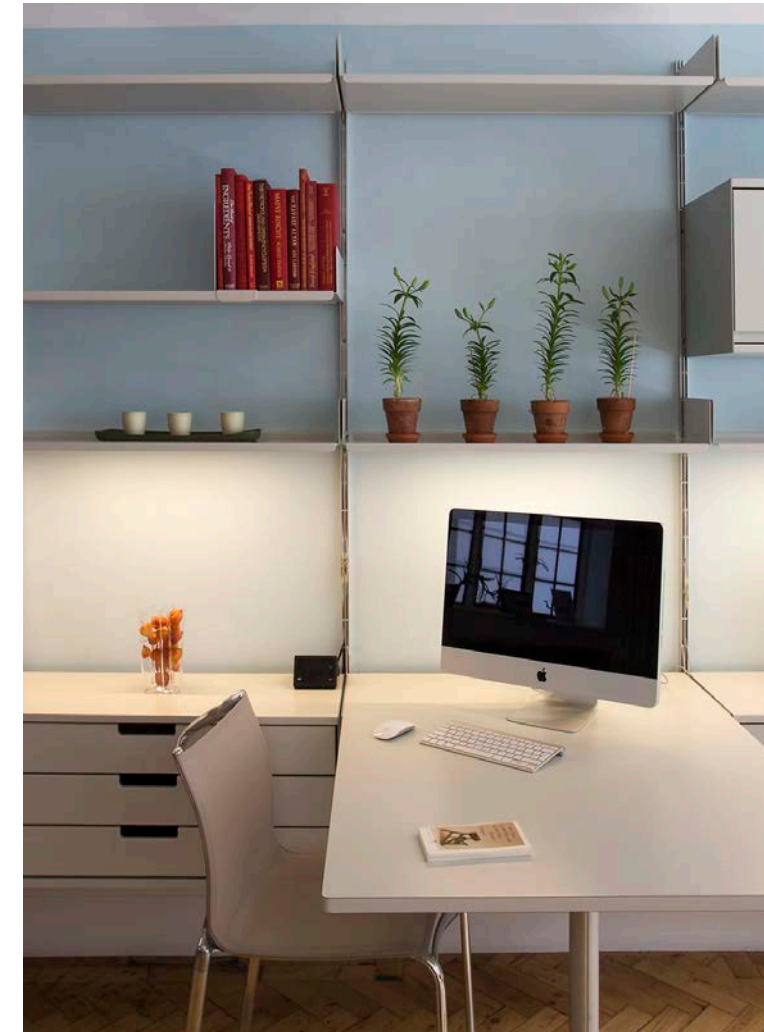

# 20 Linear Configurations

whitegoods



20 Linear  
Surface Frame  
Square



20 Linear  
Surface Frame  
Triangle



20 Linear  
Direct/Indirect  
Suspended Frame  
Square



20 Linear  
Direct/Indirect  
Suspended Frame  
Triangle



20 Linear  
Surface Frame  
Rectangle



20 Linear  
Direct/Indirect  
Suspended  
Ypsilon



20 Linear  
Direct/Indirect  
Suspended Frame  
Rectangle



20 Linear  
Multi - Suspended





## Direct



20LDL-RPT  
Plaster Trim



20LDL-RBT  
Bezel Trim



20LDL-RGT  
Grid Trim



20LDL-SM  
Surface



20LDL  
Suspended

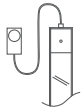

20LUC  
Under Cabinet



## Direct/Indirect

20LDI  
Suspended  
Direct/Indirect



20LDI-SW  
Surface  
Wall Mounted  
Direct/Indirect

## Wash

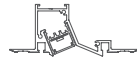

20LWW-RPT  
Wash Light  
Recessed  
Plaster Trim



20LWW-RBT  
Wash Light  
Recessed  
Bezel Trim



20LWW-SM  
Wash Light  
Surface



20LWW-SRPT  
Wash Light  
Semi-Recessed  
Plaster Trim



20LWW-SRBT  
Wash Light  
Semi-Recessed  
Bezel Trim

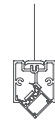

20LWW  
Wash Light  
Suspended

## Perimeter

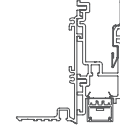

20LPF-RPT  
Flush Plaster Trim

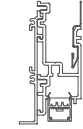

20LPF-RBT  
Flush Bezel Trim



20LPF-RRT  
Flush Return Trim



20LPF-RGT  
Flush Grid Trim

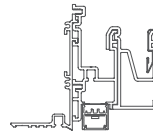

20LPFSG-RPT  
Flush Bezel Trim  
Soft-graze

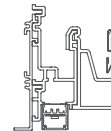

20LPFSG-RBT  
Flush Bezel Trim  
Soft-graze

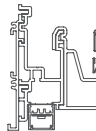

20LPFSG-RRT  
Flush Return Trim  
Soft-graze

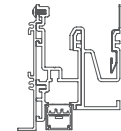

20LPFSG-RGT  
Flush Grid Trim  
Soft-graze

## Cove / Perimeter

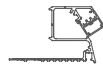

20MZC  
20 Linear  
Mini Z Cove

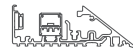

20MEC  
20 Linear  
Mini Edgeless Cove



MEC20L  
Mini Edgless Cove  
+ 20 Linear

## Graze

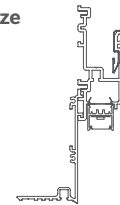

20LPR-RPT  
Regressed Plaster Trim

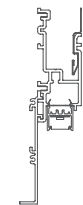

20LPR-RBT  
Regressed Bezel Trim

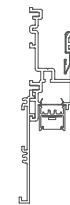

20LPR-RRT  
Regressed Return Trim

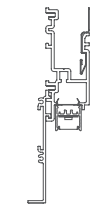

20LPR-RGT  
Regressed Grid Trim

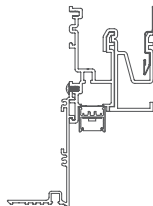

20LPRSG-RPT  
Regressed Plaster Trim  
Soft-graze

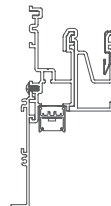

20LPRSG-RBT  
Regressed Bezel Trim  
Soft-graze

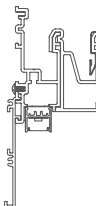

20LPRSG-RRT  
Regressed Return Trim  
Soft-graze

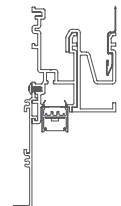

20LPRSG-RGT  
Regressed Grid Trim  
Soft-graze

## Delivered Lumens Per Foot WG-20LDL-SM-...-OD

CCT	Power		
	L [3 W/ft]	M [6 W/ft]	H [10 W/ft]
927	183	366	641
930	199	398	697
935	236	473	828
940	281	562	983
WD <sup>1</sup>	140	291	421
RGBW <sup>2</sup>			238

1 WD: L = 2.7 W/ft, M = 5.5 W/ft, H = 7.6 W/ft  
2 RGBW [7.6 W/ft]

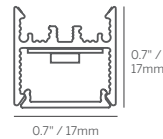

# Product Details: 20 Linear Range Logic

whitegoods

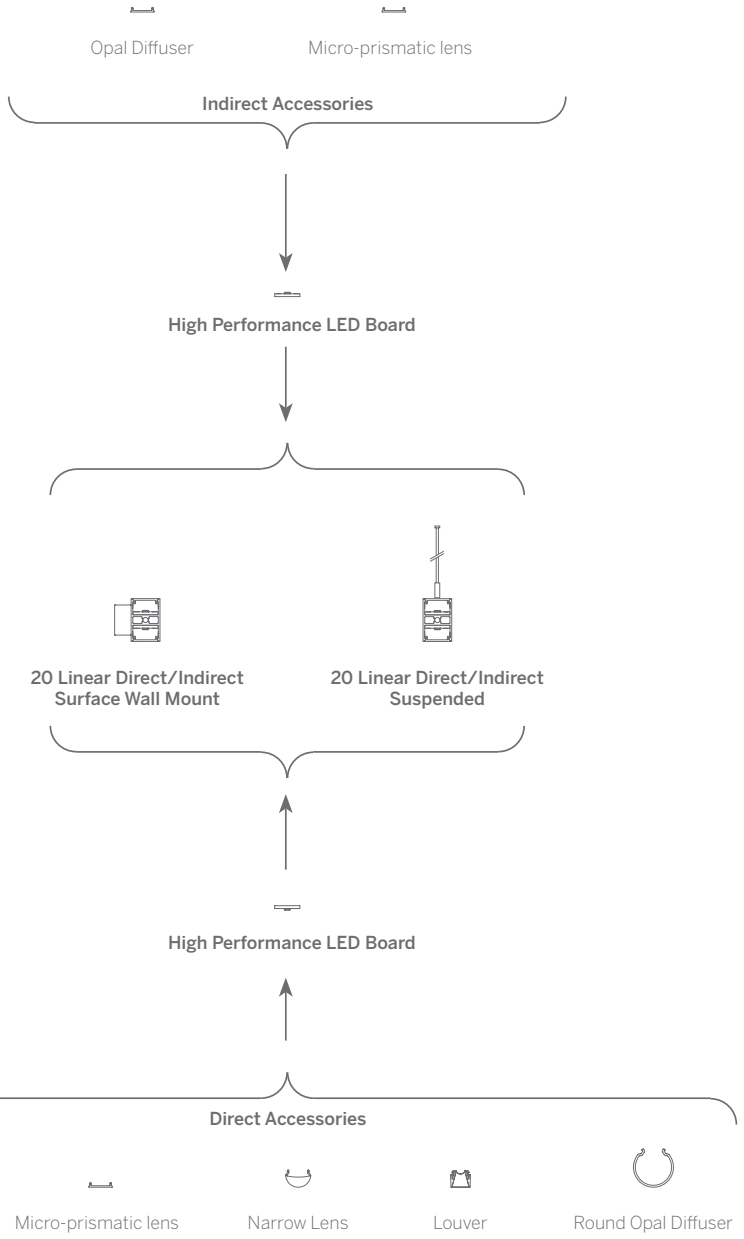
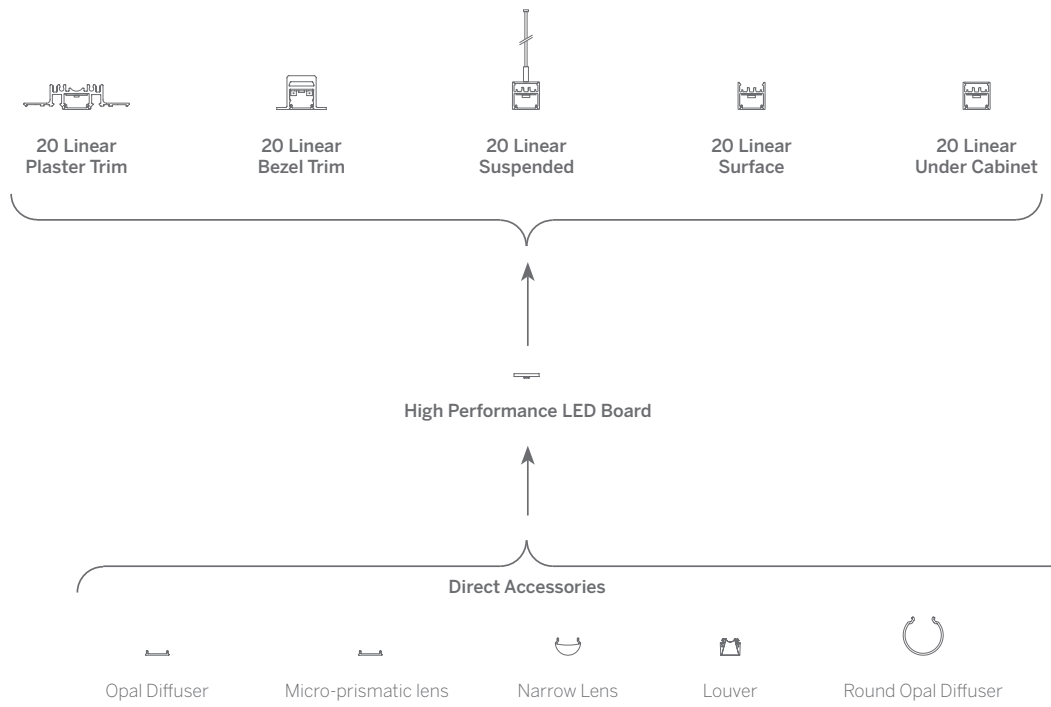

# 20 Linear Modularity

Whitegoods utilizes modularity throughout the range to ensure maximum efficiency of design, manufacture and maintenance. For the specifier this means absolute consistency across all product types and applications, as well as making sense economically.

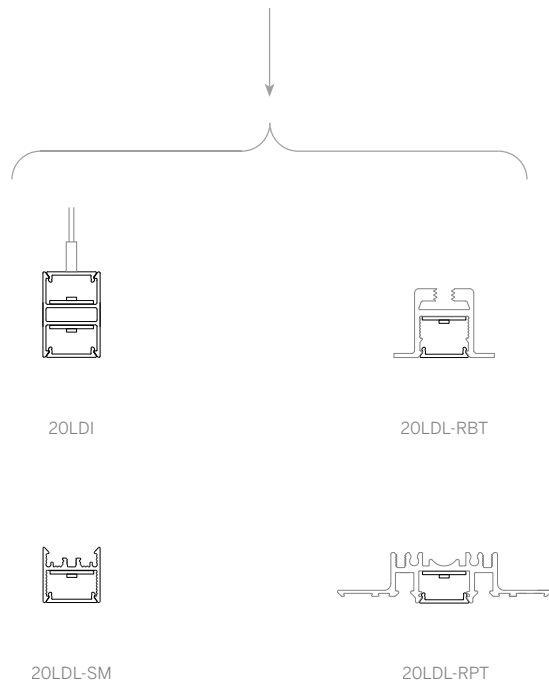
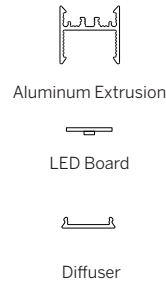

whitegoods



Whitegoods 20 Linear

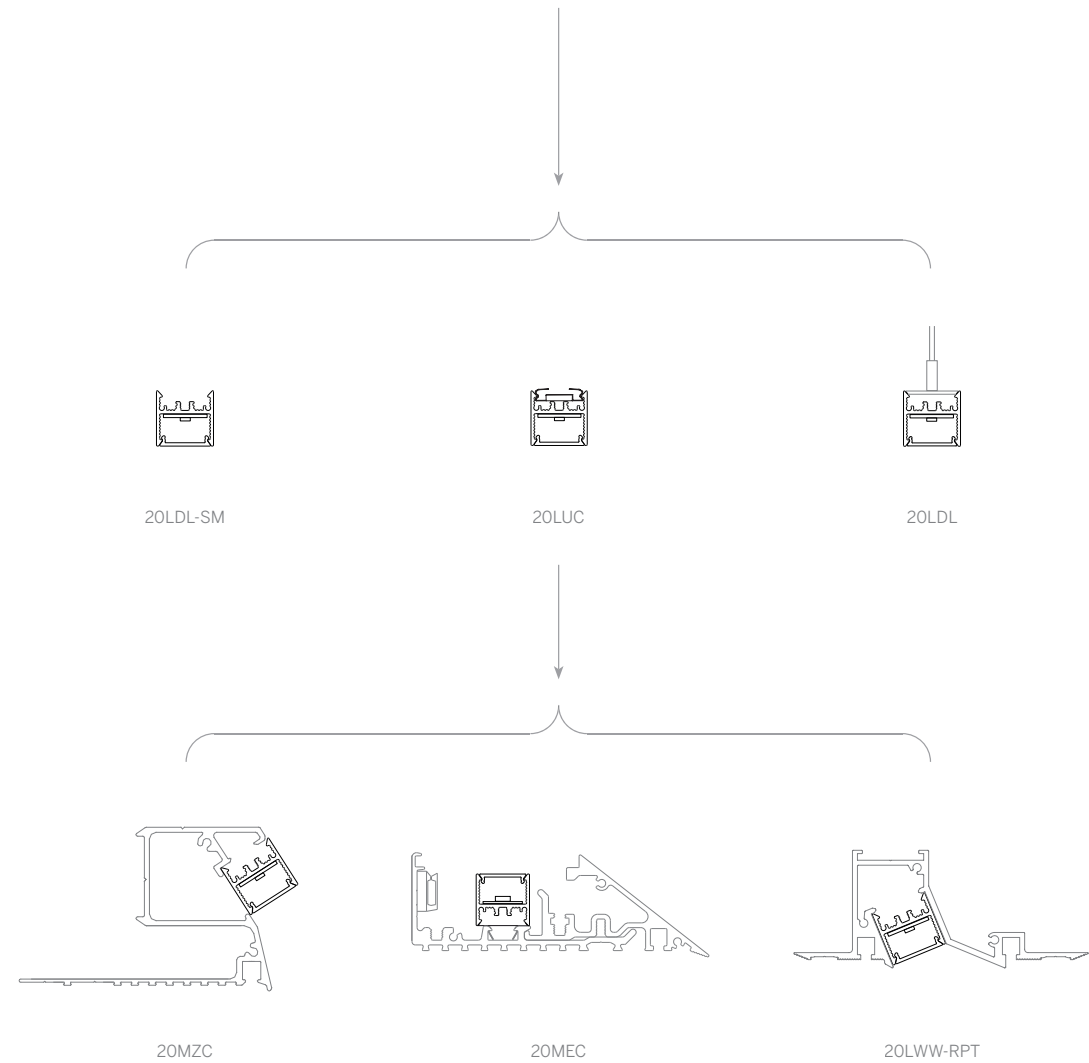



## 20 Linear Technology

Whitegoods developed a specific LED light source optimized for our linear products, using the highest performance and quality LED devices available on a form factor that best fits our product mechanically and electronically.

Whitegoods products are developed in a modular fashion that allows easy repair or replacement of the light source without upsetting the installation. We term this: future proofing.



- Replaceable light source guarantees sustainability.
- Available in any continuous length to accommodate exacting installations.
- Multiple wattages and lumen output for maximum flexibility within any application.
- Constant Voltage and Constant Current 90+ CRI, 3 step MacAdam.
- Four standard color temperatures from 2700K-4000K.
- Compatible with all common dimmer and control standards such as 0-10V, forward-phase with neutral, ELV, DALI and DMX.
- High efficiency design delivers up to 135 lumens/watt.
- Used throughout Whitegoods 20 Linear, Linear, Cove and Perimeter products for color and performance consistency.
- 5-year warranty.

# Tunable White

Whitegoods Tunable White allows you to select any color temperature between 1800K - 4000K and 2700K - 6500K, while maintaining the same high quality color rendering as the standard led. This feature is often used in health and wellness applications, as well as work spaces to increase productivity, architectural spaces to match natural light, and for design focus in retail and hospitality environments.

Color Temperature	Description	Typical Usage
6500K	Cool, Daylight	Commercial, Hospital
5000K	Cool, Daylight	Commercial, Hospital, Exterior
4000K	Cool	Office, Exterior
3500K	Neutral Cool	Office
3000K	Neutral Warm	Office, Residential
2700K	Warm: Halogen Incandescent	Residential, Hotel
2200K	Warm Amber Incandescent	Residential, Hospitality
1800K	Very Warm Incandescent	Residential



# Warm Dim

Warm Dim lighting provides LED dimming and warm LED lights virtually indistinguishable from an incandescent light source. Designed to precisely mimic the black body curve of a standard 100W A19 lamp by gradually transitioning from 1800K to 3000K.

whitegoods

Color Temperature	Description	Typical Usage
3000K	Neutral Warm	Office, Residential
2700K	Warm: Halogen Incandescent	Residential, Hotel
1800K	Very Warm Incandescent	Residential



## RGBW

The ability to add dynamic color-changing to a very small scale product is an exclusive benefit of LED lighting. When used in conjunction with the 20 Linear range, colored light can be introduced into the space for accent, health and mood-setting results.



# 20 Linear Lenses / Accessories

whitegoods

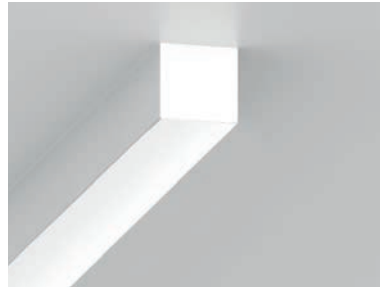

## Satin Opal

Continuous, evenly illuminated snap-in lens

- Provides uniform light diffusion, reducing harsh shadows and glare.
- Very minimal size allows the luminaire to be placed near the object being illuminated to eliminate glare, light spill and reduce the energy required.
- High-angled light illuminates adjacent vertical surfaces.
- Available in any length required.

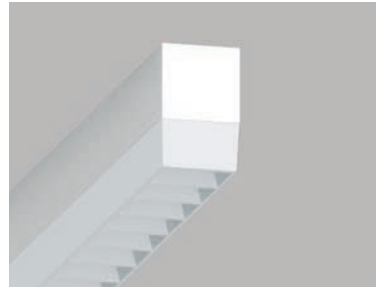
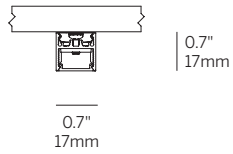

## Louver

Glare control louver for complete shielding of light source

- Cross blade louver with integrated holographic film.
- Exact 45° cut-off with soft edges.
- End-to-end mounting gives uninterrupted lighting effect.
- Available in any length required.

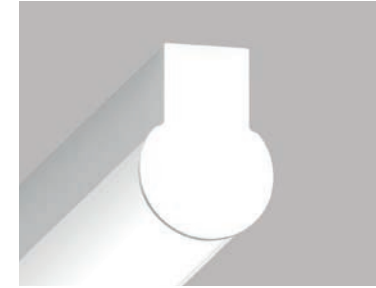
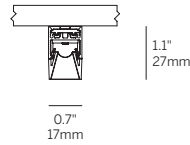

## Round Opal Diffuser

Tubular design gives light in all directions, including behind the luminaire.

- 315° distribution.
- Delivers a soft, even spread of light.
- End-to-end mounting gives uninterrupted lighting effect.
- Available in any length required.

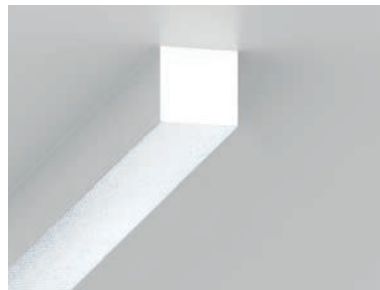
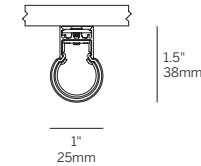

## Micro-prismatic

High-efficiency and lower brightness, general illumination

- Improve efficiency and reduce lens brightness.
- Distributes light evenly, minimizing hot spots and ensuring consistent illumination.
- Maximizing brightness while reducing energy consumption.
- Available in any length required.

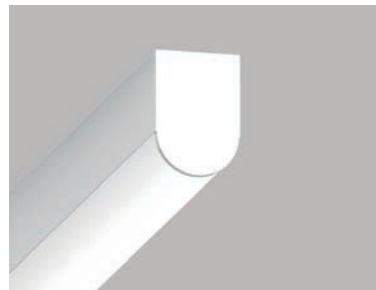
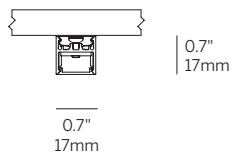

## Narrow Lens

Accurate beam control delivering a soft-edged narrow linear beam

- 15° axially-symmetrical linear beam.
- 'Clean' beam spread, free from striations.
- End-to-end mounting gives uninterrupted lighting effect.
- Available in any length required.

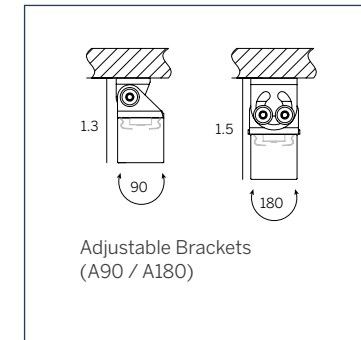
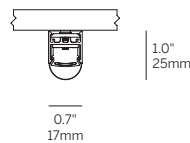

# 20 Linear Integration

whitegoods

Seamless architectural integration interfacing with all ceiling types

- Plaster in for drywall
- Flanged for hard ceilings
- T Grid flange for grid
- Return edge for specialized ceilings such as metal or wood

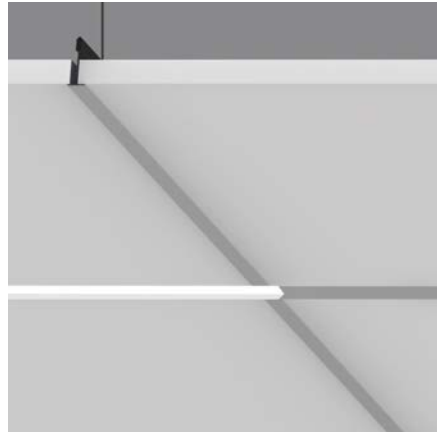

Plaster Trim

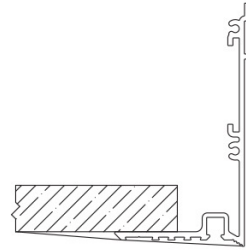

Bezel Trim

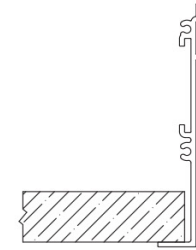

Return Trim

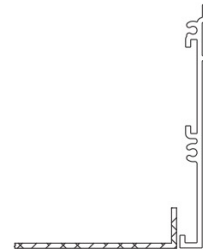

Grid Trim

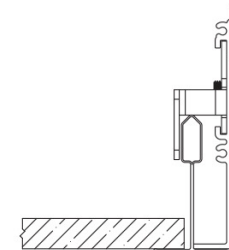

# 20 Linear Integration

## 20 Linear Recessed

Grid On Bezel  
Front Section Elevation

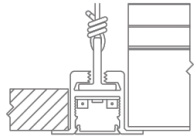

0.7"  
18mm

Bezel Flush to Grid  
Right Side Elevation

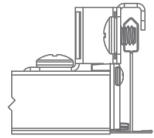

9/16"  
14mm

Solid Ceiling Mounting Options

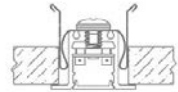

1.5"  
40mm

1.2"  
30mm

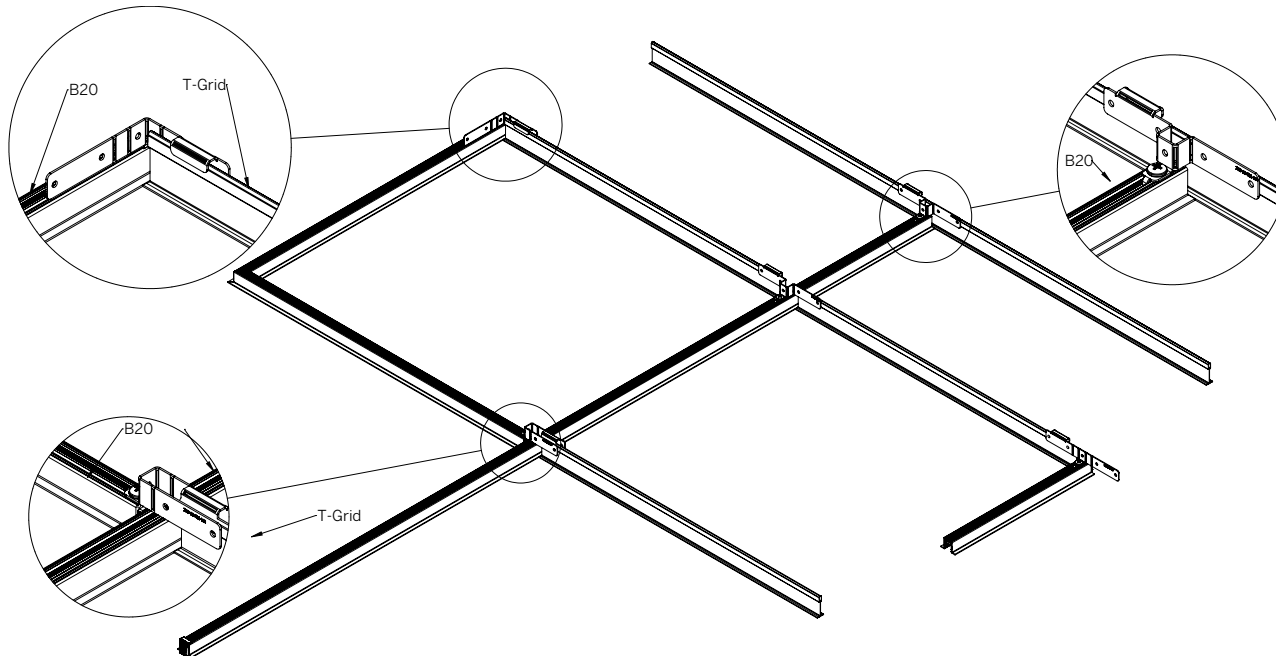

## 20 Linear Surface

Screw Clip (SC)

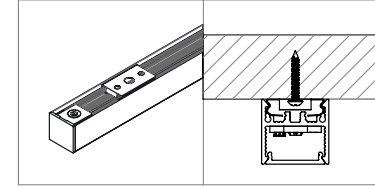

Magnet (MM)

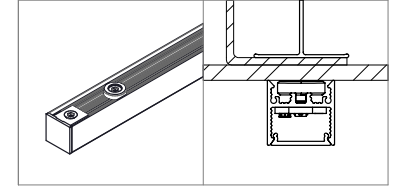

Square Lay-In Grid Clip (GT9)

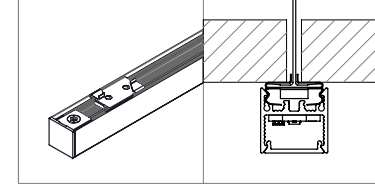

Square Lay-In Grid Clip (GT15)

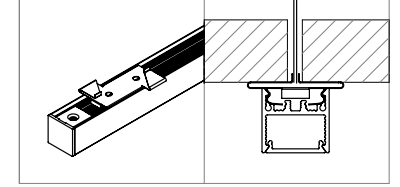

Tegular Grid Clip (GT9T)

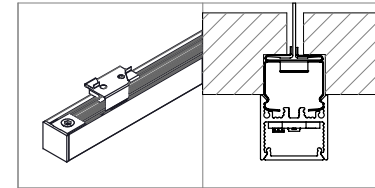

9/16 BOLT SLOT TEGULAR CLIP  
(1/4 REVEAL) (BS9T)

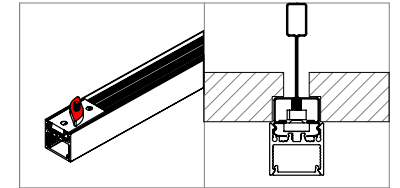

## 20 Linear

Recessed, surface, suspended and wall mounted to any surface type.

The ability to utilize the same form and technology throughout any multipurpose space to deliver a cohesive language of light.

Small scale to integrate invisibly into the architecture, close to the surface being illuminated for greater energy efficiency and minimal spill light. Specifiable in standard and completely tailored lengths to fit any space.

So much performance from such a small luminaire.



# 20 Linear Suspended, within a wood slat ceiling system

Section of Ceiling

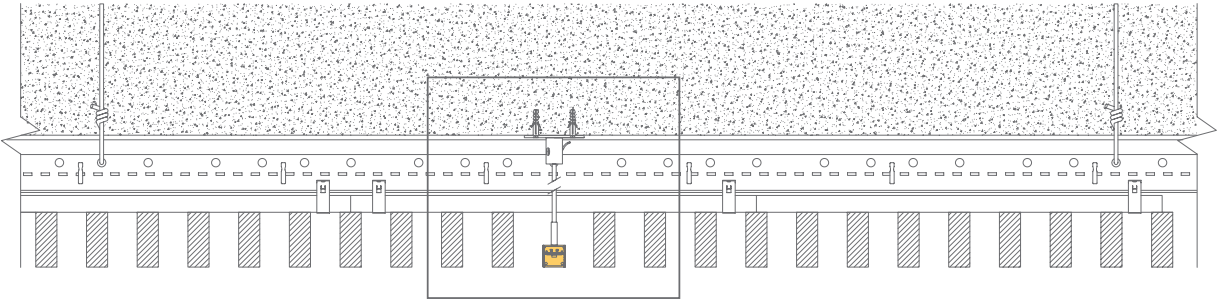

Detail @ 1:2

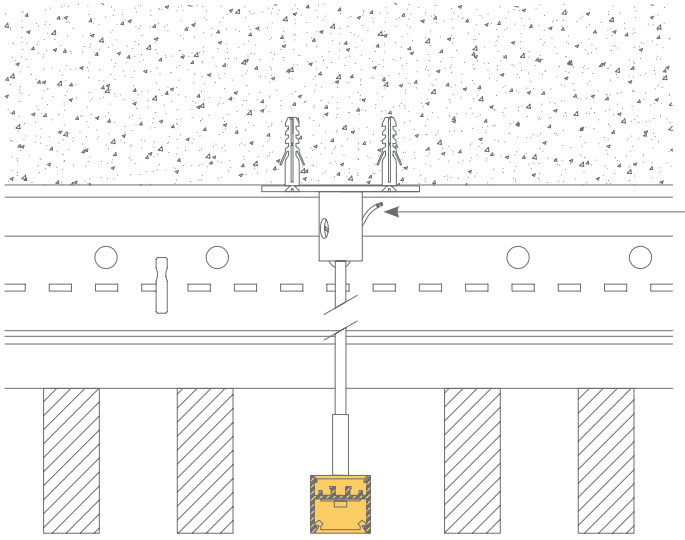

Hard Ceiling Suspension with Power Cable



# 20 Linear Mini Z Cove, forming a perimeter wash detail

Ceiling Section Option A @ 1:2

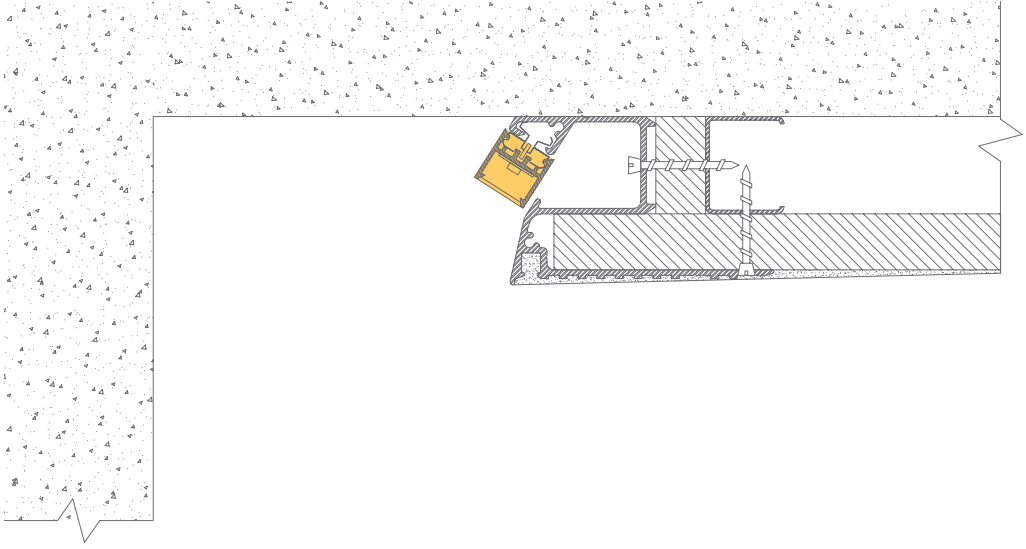

Ceiling Section Option B @ 1:2

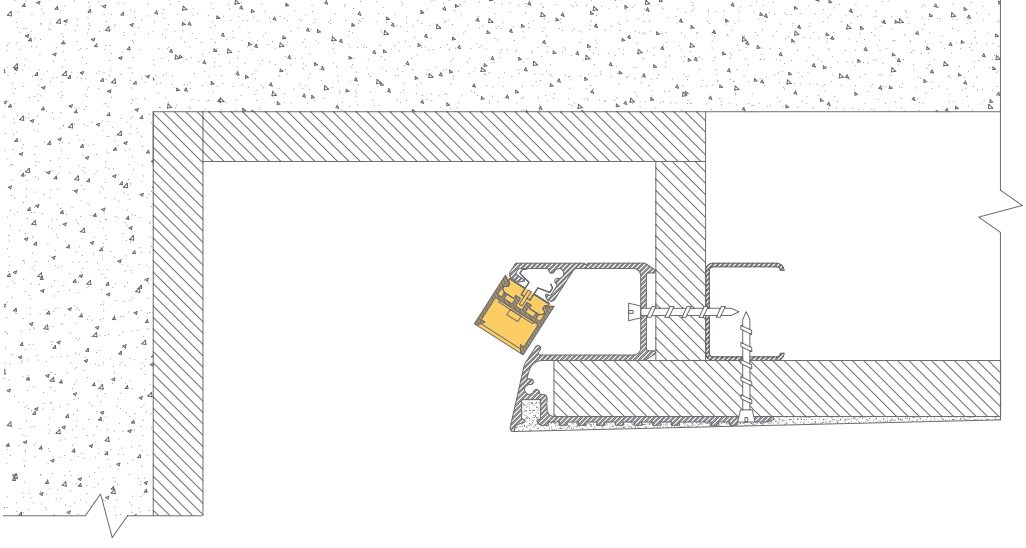



# 20 Linear Mini Edgeless Cove, in a wall-to-ceiling transition

Ceiling Section & Wall Plan Section

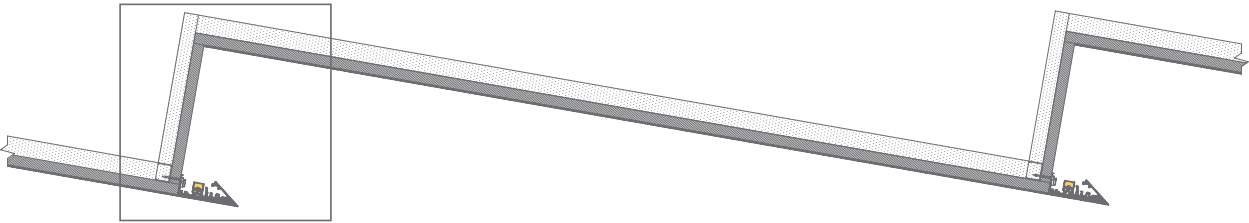

Detail of Ceiling Section @ 1:2

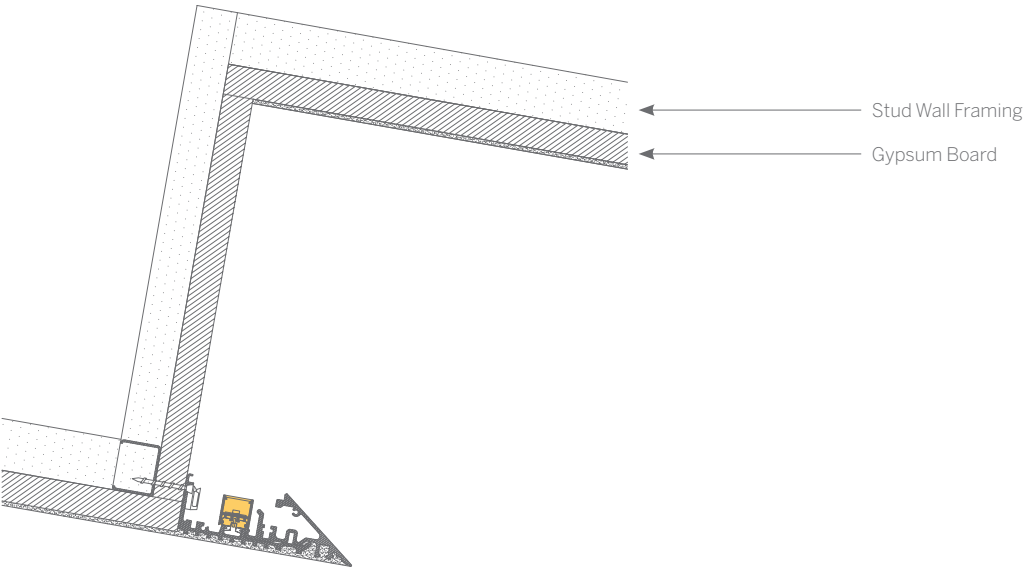



## 20 Linear Mini Z Cove, in concealed floor wash detail

Plan View of the Curved wall and Section Detail

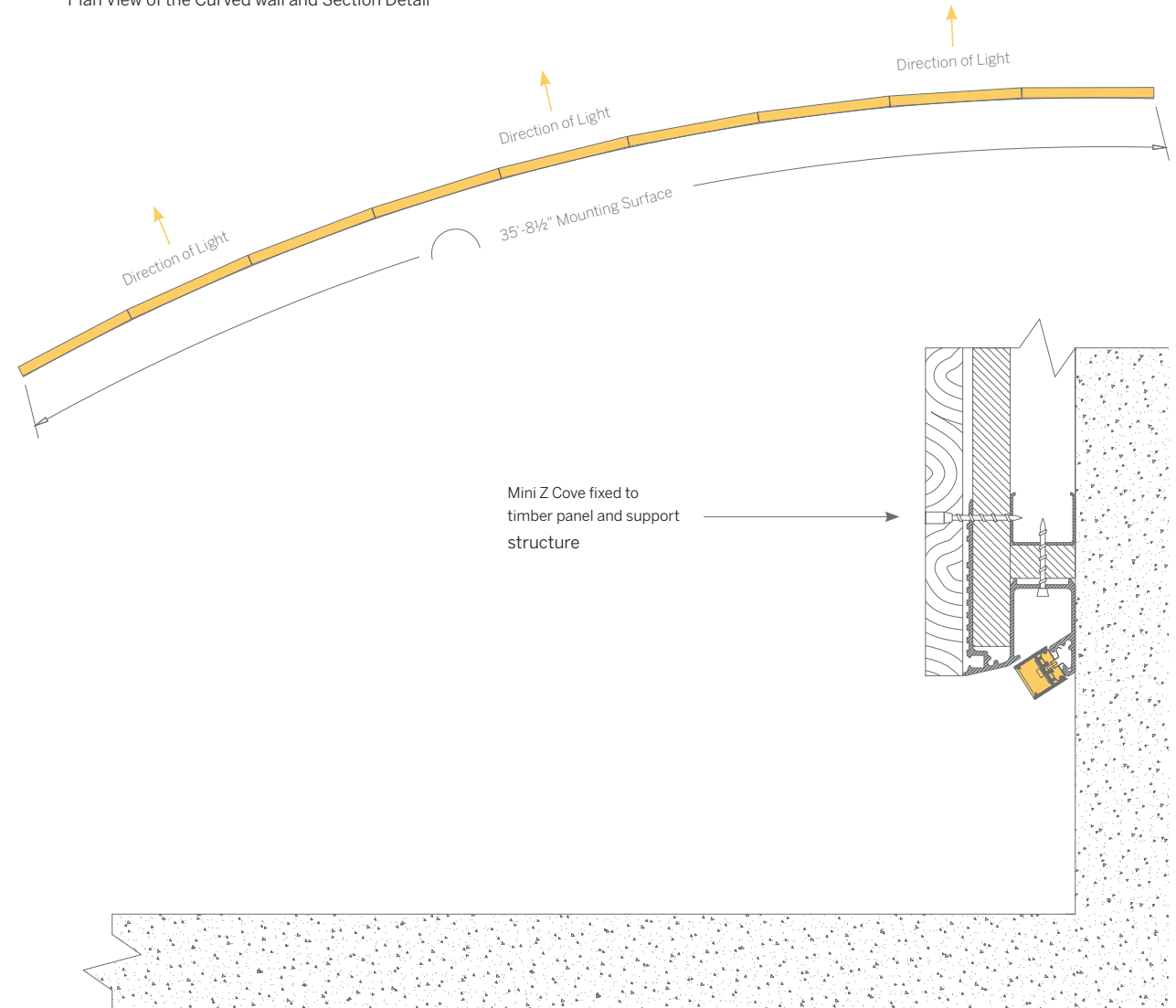

# 20 Linear, tailored to exact dimensions

Section Detail of Ceiling

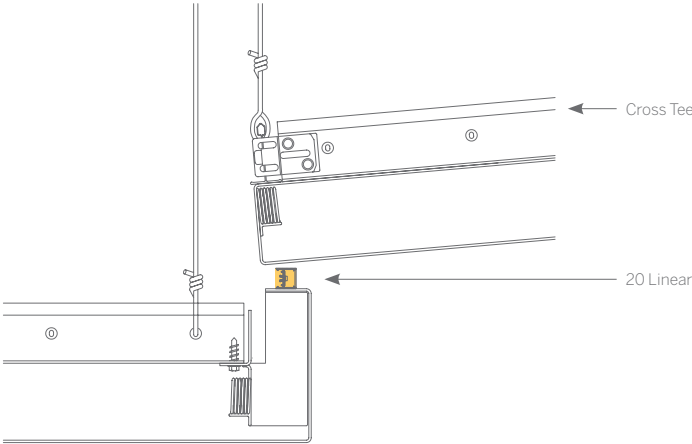

Plan of Ceiling

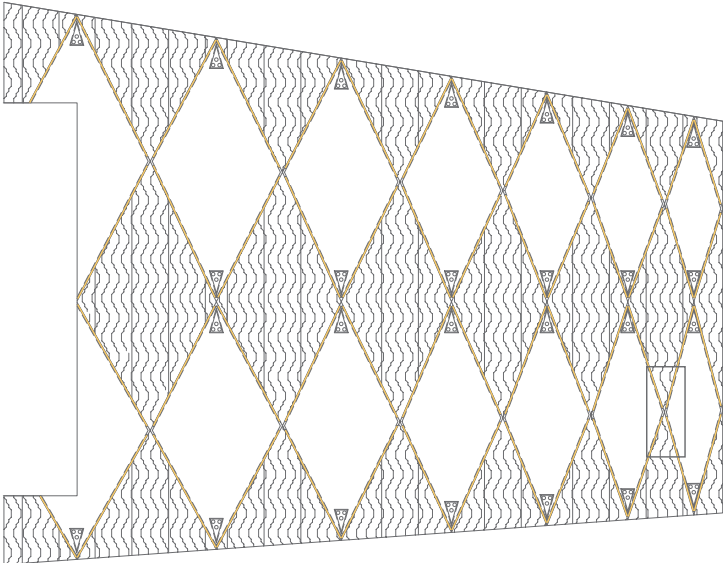

Close-Up of Ceiling Plan

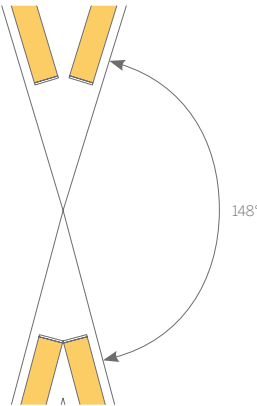

# 20 Linear, horizontal transition within skylight

Section of Skylight Showing 20 Linear with Plaster Trim



Detail of 20 Linear integration

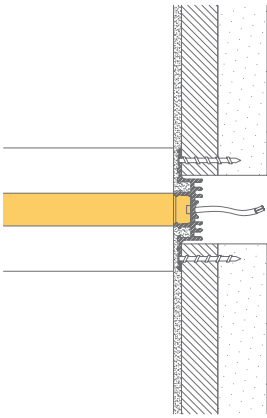

Section in Plan View Showing Overlapping Fixtures



## 20 Linear

Applications include:

- General illumination
- Wall wash
- Wall graze
- Accent lighting
- Direct/indirect lighting
- Cove lighting
- Perimeter lighting

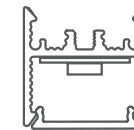

E  
18

F  
18

A  
18

B  
18

20 Linear Direct



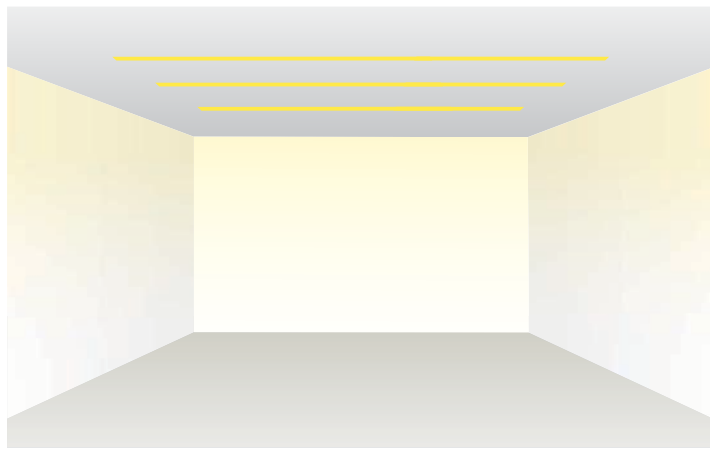

Perhaps the most common lighting solution utilized for general area lighting, arranging a group of lights in a grid to give even illumination to the surface below. A space can have a lot of light being delivered into it, but if the walls are not sufficiently illuminated, there is a good chance that the space will feel gloomy, even though there is plenty of light falling on horizontal surfaces like desks or the floor.

Whitegoods luminaires have good 'high angle distribution', which can help to deal with this common issue (see Washlight). Also note that narrow optic accessories can further concentrate or restrict the light to the intended surfaces.

## Angle of Illumination / High Angle Lighting Performance

WG-20LDL-SM, WG-20LUC-SM

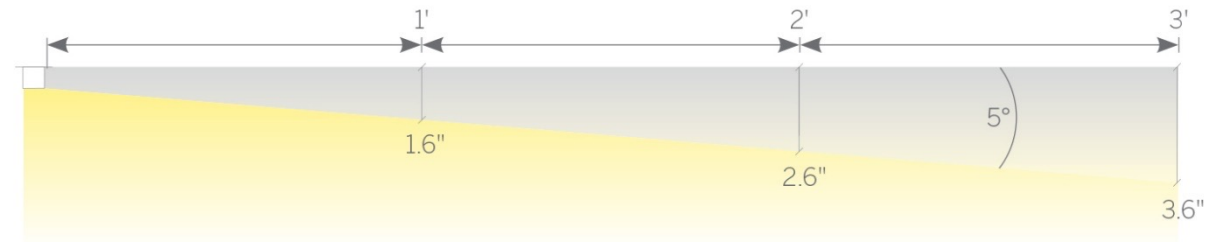

**Tip**  
Look for Whitegoods product codes which include "LDL" and "LD", to find products ideal for Downlight applications.

# 20 Linear Direct

whitegoods

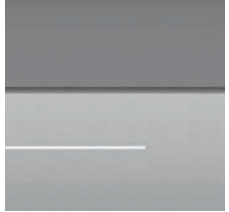

20 Linear Recessed



20 Linear Under Cabinet

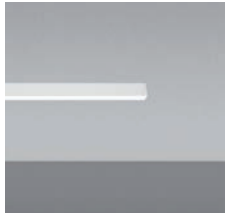

20 Linear Surface



20 Linear Recessed - Flush



20 Linear Suspended



20 Linear Recessed - Regressed



20 Linear Direct Surface Wall



20LDL-RPT Plaster Trim



20LDL-RBT Bezel Trim



20LDL-RGT Grid Trim



20LDL-SM Surface



20LDL Suspended

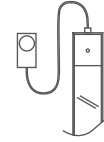

20LUC Under Cabinet

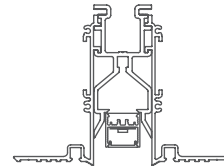

20LRF-RPT Recessed Flush Plaster Trim

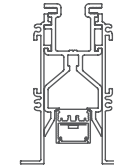

20LRF-RBT Recessed Flush Bezel Trim

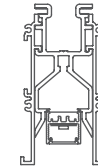

20LRF-RGT RECESSED FLUSH RETURN TRIM

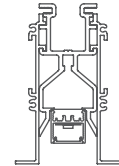

20LRF-RRT Recessed Flush Grid Trim

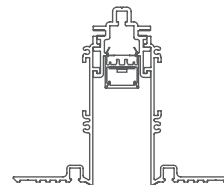

20LRR-RPT Recessed Regressed Plaster Trim

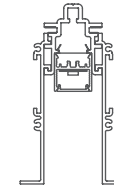

20LRR-RBT Recessed Regressed Bezel Trim

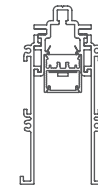

20LRF-RGT Recessed Regressed Return Trim

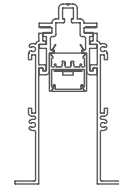

20LRF-RRT Recessed Regressed Grid Trim

# Association of American Universities

location: **Washington, DC**  
architect: **OTJ Architects**  
photography: **Chris Spielmann**

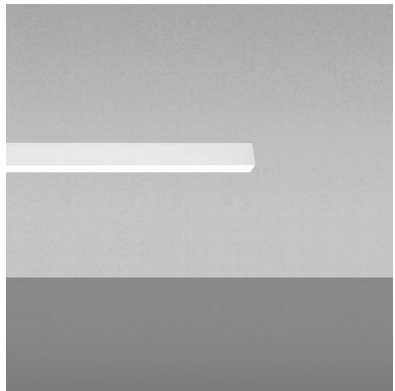

20 Linear Surface

30 Whitegoods 20 Linear



## 41 L Street

location: **Washington, DC**  
architect: **SK+I Architecture**  
specifier: **CMK**  
photography: **Max Zhang, IRIS22**

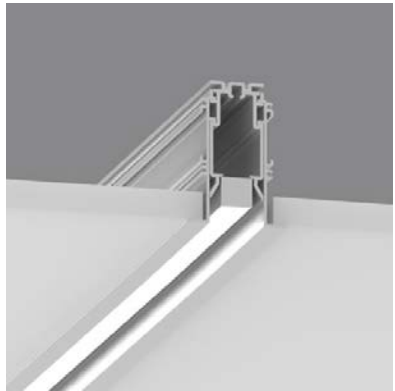

**20 Linear Recessed –  
Flush**





## American Bankers Association

location: **Washington, DC**  
architect: **OTJ Architects**  
lighting design: **CM Kling**  
photography: **Trent Bell**

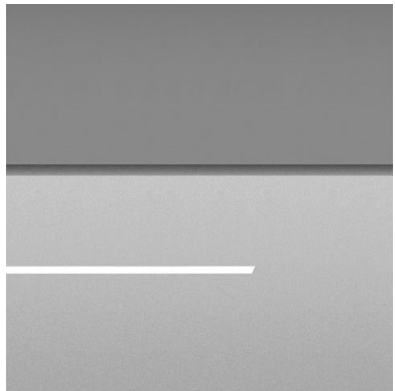

**20 Linear Recessed**





# Duke Energy 21st floor

location: **Charlotte, NC**  
architect: **Gensler**

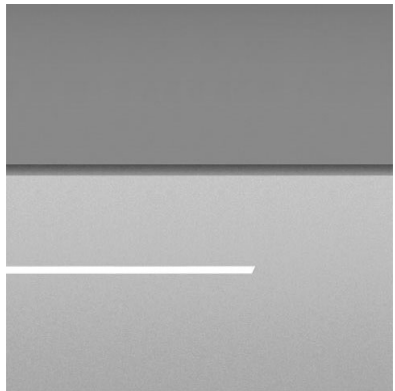

**20 Linear Recessed**





TEST  
IT OUT

LIVING OUR  
PURPOSE

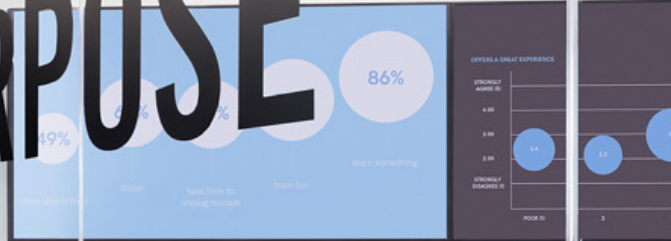





PROJECT [24]

TRANSFORMING  
FOR THE FUTURE

# Morgan State University Health and Human Services Center

location: **Baltimore, MD**

specifier: **MCLA**

architect: **HOK Architects**

photography: © **Brad  
Feinknopf/OTTO**

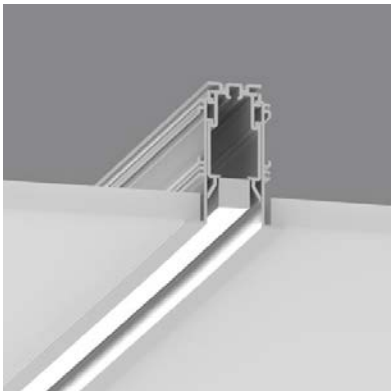

**20 Linear Recessed  
– Flush**









20 Linear Wash Light

# 20 Linear Wash Light

whitegoods

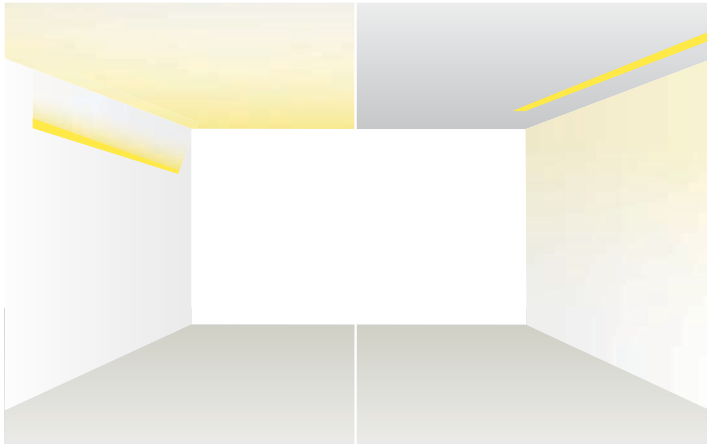

The aim of wall washing, or in fact washing any surface with light (wall, ceiling or floor), is to create an even 'wash' of light across the surface. The wall wash is a great way to introduce light into a room as the brightness of the vertical surfaces around us play a crucial role in our perception of a space. You can use linear sources which emit a wide, even beam of light directed towards the intended surface.

Consider all of the mounting opportunities afforded by the 20 Linear washlights: recessed, semi-recessed, surface and suspended

**Tip**  
Look for Whitegoods product codes which include "WW", "LWW", to find products ideal for Washlight applications.

## Angle of Illumination / High Angle Lighting Performance

Values in ft & in



SRP/B20LWW

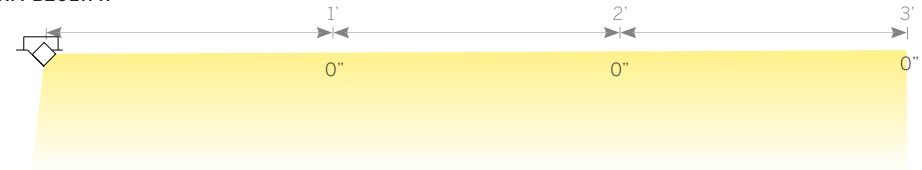

# 20 Linear Wash Light



20 Linear Wash Light Recessed



20 Linear Wash Light Suspended



20 Linear Wash Light Surface



20 Linear Wash Light Semi-Recessed

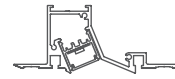

20LWW-RPT Wash Light Recessed Plaster Trim

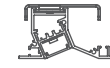

20LWW-RBT Wash Light Recessed Bezel Trim



20LWW-SM Wash Light Surface



20LWW-SRPT Wash Light Semi-Recessed Plaster Trim

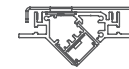

20LWW-SRBT Wash Light Semi-Recessed Bezel Trim



20LWW Wash Light Suspended

# Clarendon Apartments

location: **Arlington, VA**

architect: **WDG Architecture**

photography: **IRIS22 Productions**

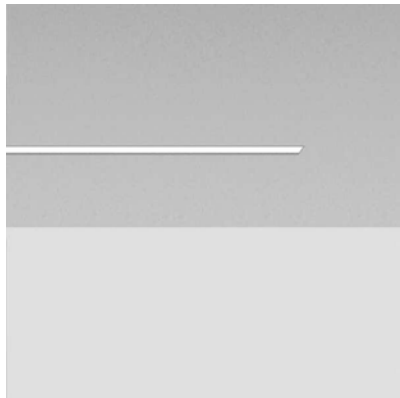

**20 Linear Wash Light  
Recessed**



## Private Residence

location: **Snowmass, CO**  
specifier: **Alpenglow Lighting Design**  
photography: **Dallas & Harris**

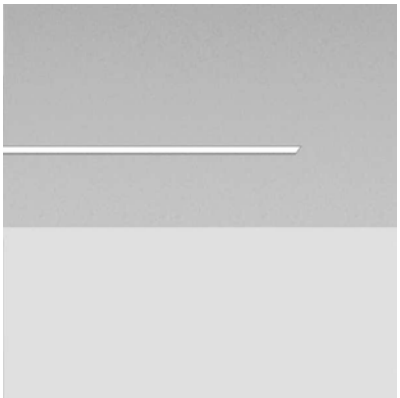

**20 Linear Wash Light Recessed**





## Axinn Veltrop & Harkrider

location: **Washington, DC**  
architect: **OTJ Architects**  
photography: **Eric Laignel**

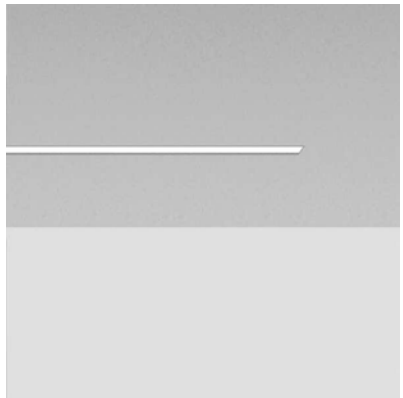

**20 Linear Wash Light  
Recessed**





AXINN



AXINN

502

## 20 Linear Perimeter and Wallgraze



## 20 Linear Perimeter

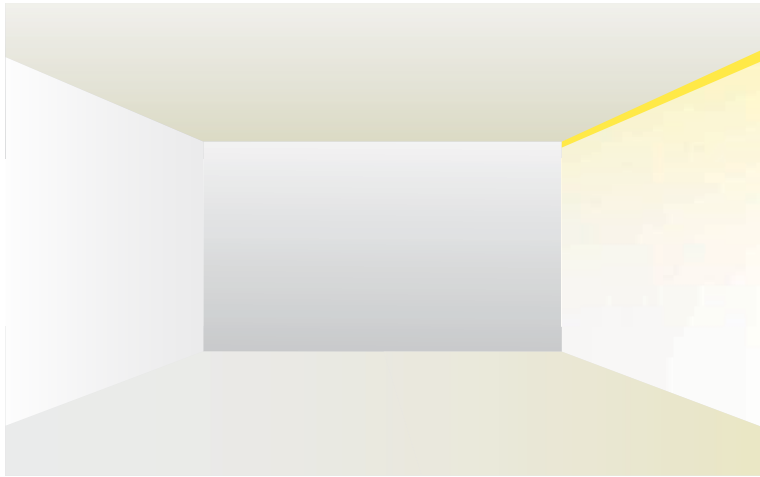

Another simple and highly effective way to add natural feeling light into a space is via a concealed linear light source detailed into the intersection of the wall and ceiling. This luminaire, typically recessed into the ceiling and providing an even illumination from a homogeneously illuminated lens, gives definition to the space, and functional light on the perimeter.

Perfect for defining lobby and conference space perimeters, as well as vanity light over a mirror as the source of light is hidden from normal viewing angles (including mirror reflection), while functional illumination is distributed down the wall and into the space.

The 20 Linear Perimeter, with its minimal aperture provides the perfect detail for perimeter applications.

**Tip**  
Look for Whitegoods product codes which include "LPF", "LPR", "MEC", "MZC", to find products ideal for Perimeter applications.

## 20 Linear Wallgraze

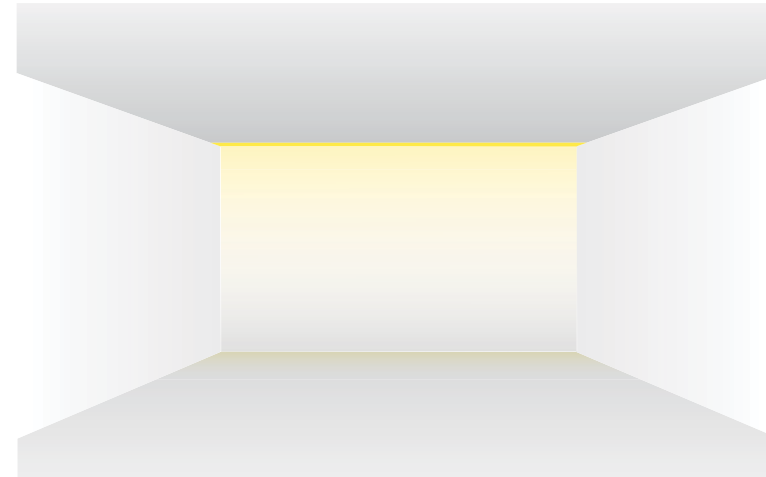

Surface Grazing is typically used to reveal and highlight textured feature surfaces such as stone, brick, wood and fabric to name a few. To achieve this, a focused narrow beam of light flows across the entire wall from top to bottom, delivering a sheet of light across the featured surface.

The design may be a recessed niche at the top of the wall with a surface mounted grazing luminaire, or one of several 20 Linear recessed profiles that integrate into any ceiling type and project an even sheet of light down the wall.

Either way the finished wall should be allowed to go past and above the ceiling plane so that the entire wall is illuminated top to bottom.

whitegoods

**Tip**  
Look for Whitegoods linear product codes which include "LDL", "LD", "LPR", "LRR" with "NL16" or "LL45x" to find products ideal for Grazing applications.

## 20 Linear Perimeter Flush

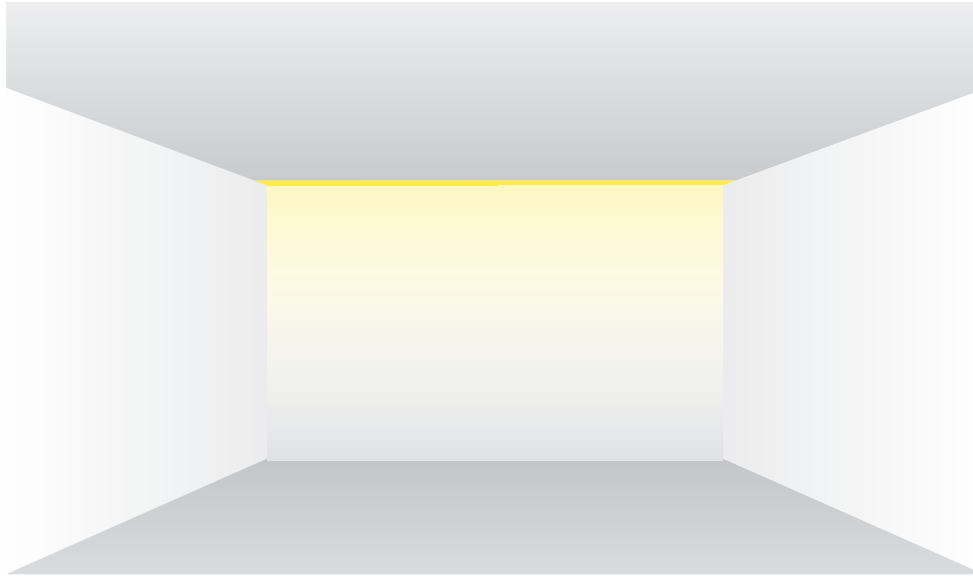

### Mounting and Recommended Spacing

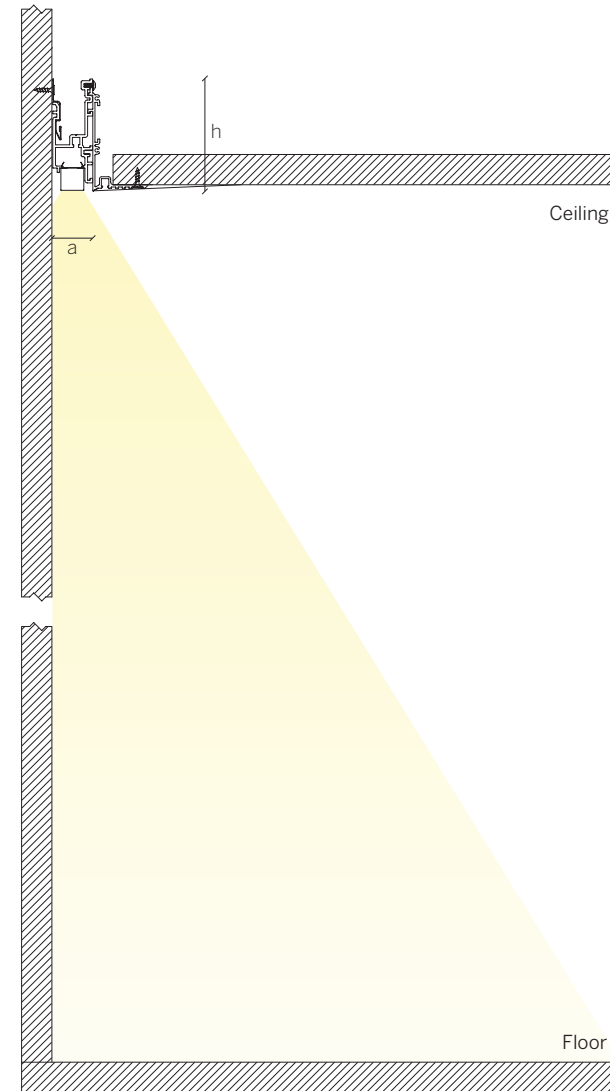

Plaster Trim Mounting shown in diagram

20 Linear Perimeter Flush Dimensions  
(regardless of mounting)

$a = 1.2''$  (33mm)

$H = 3.3''$  (83mm)

# 20 Linear Perimeter Regressed and Wallgraze

whitegoods

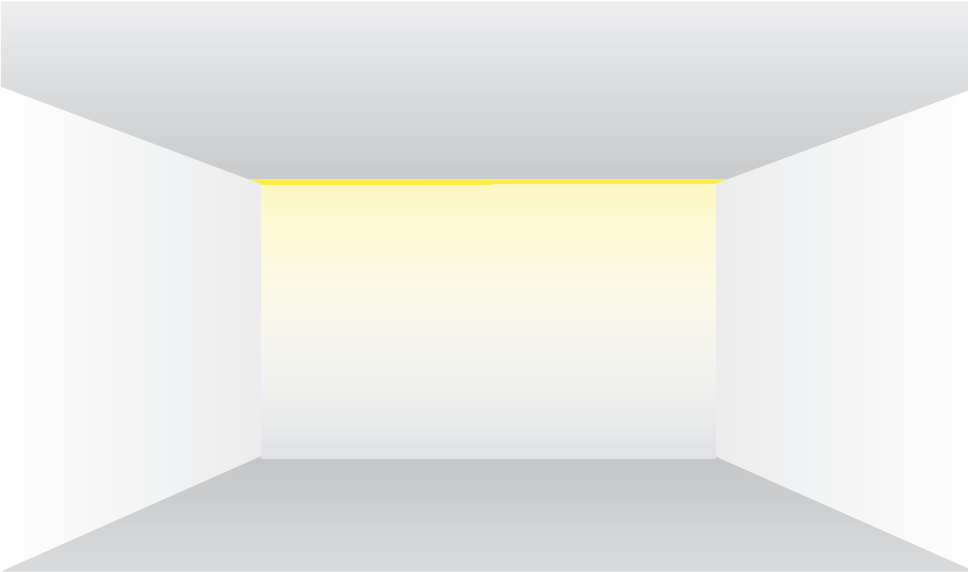

## Mounting and Recommended Spacing

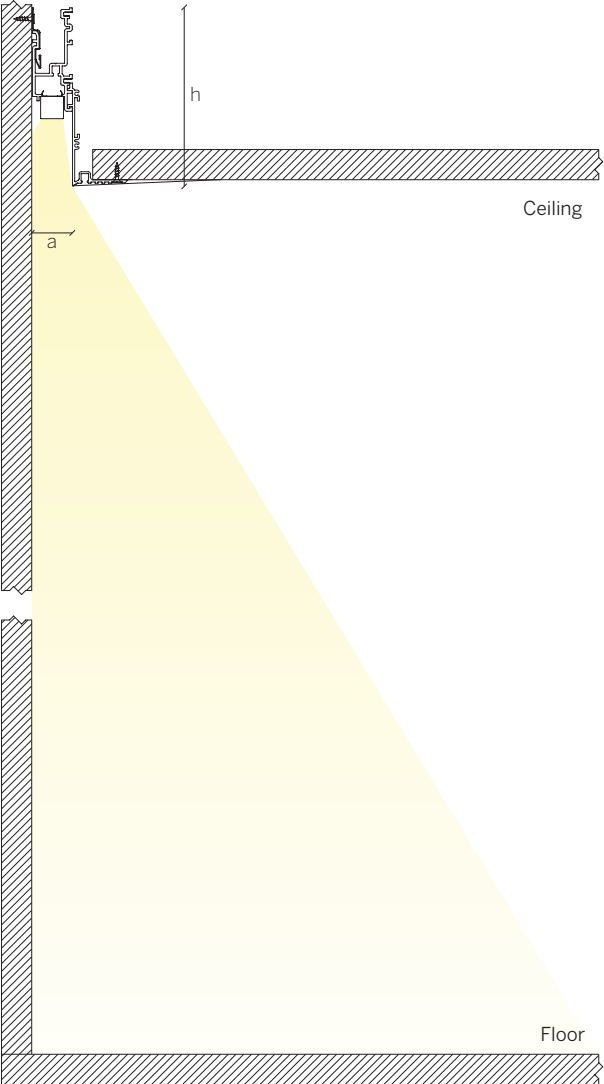

Plaster Trim Mounting shown in diagram

20 Linear Perimeter Flush Dimensions (regardless of mounting)

a = 1.2" (33mm)  
H = 3.3" (83mm)

# 20 Linear Mini Edgeless Cove

whitegoods

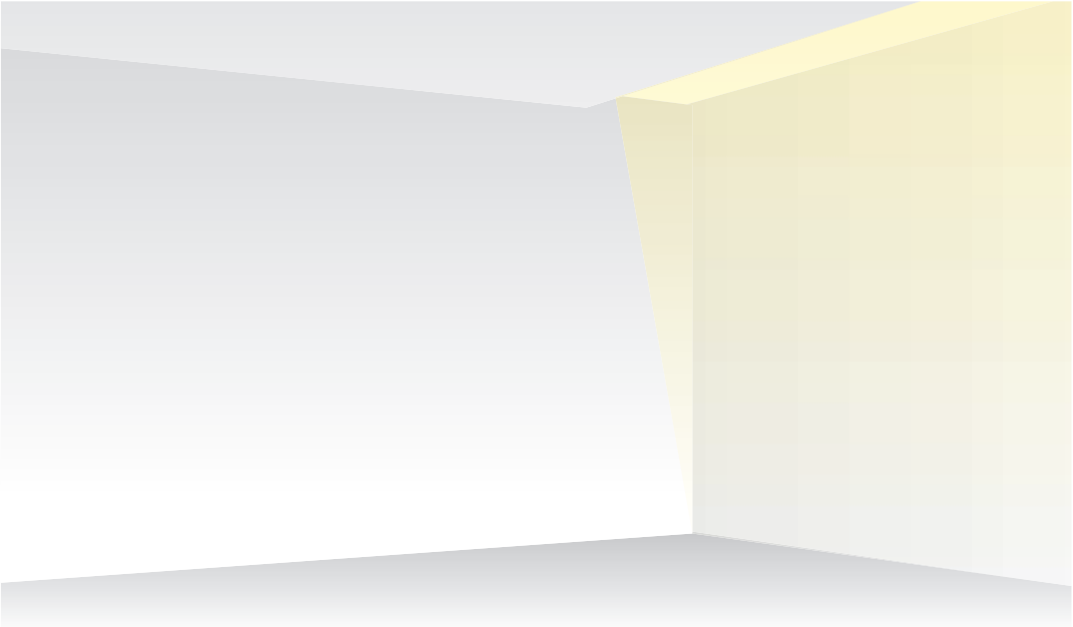

## Mounting and Recommended Spacing

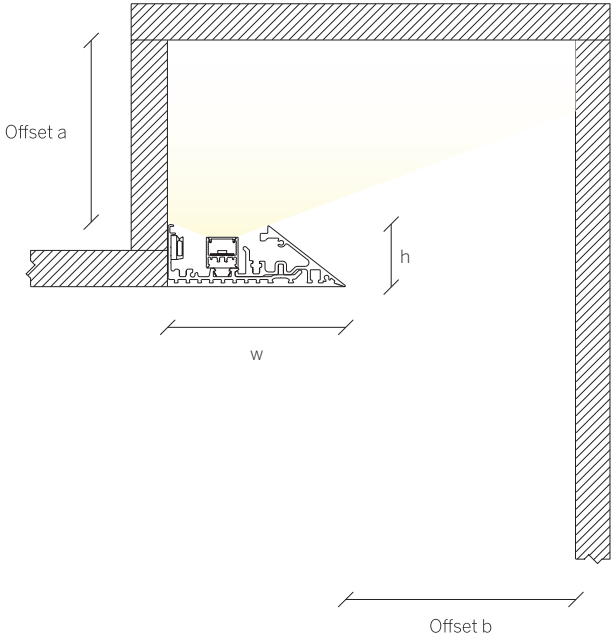

Note  
Paint out all internal surfaces of cove in matt white.

Offset a  
Typical Offset 12"  
Optimum Offset 24"  
Minimum Offset 6"

Offset b  
Recommended Offset 12"-36"  
Minimum Offset 6"  
Optimum Offset 36"

Dimensions  
w = 3.7" (94mm)  
h = 1.3" (33mm)

# 20 Linear Mini Z Cove

whitegoods

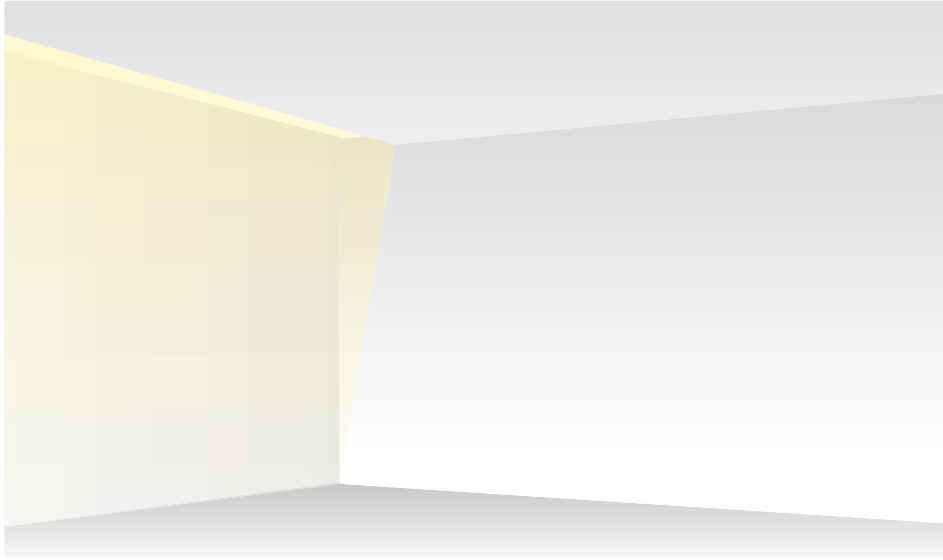

## Mounting and Recommended Spacing

Option 1 Mounting to plenum structure only

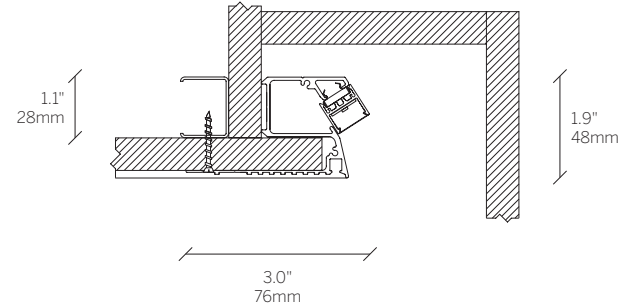

Option 2 Mounting tight against ceiling structure

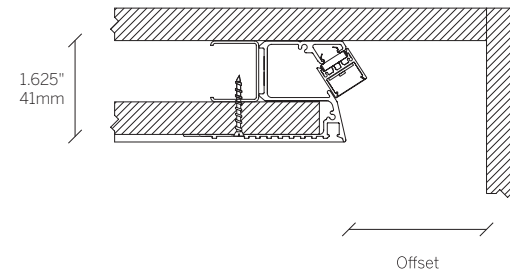

Installs within less than a single layer of standard 3 5/8" gypsum framing system and 5/8" board.

## Alternative Mounting Options

Concealed ceiling wash from wall pocket

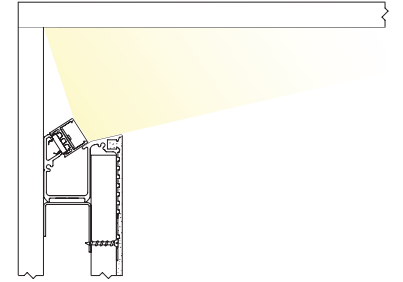

Concealed floor wash from wall pocket

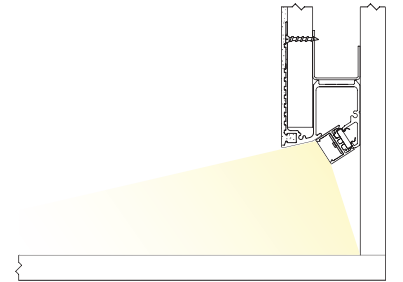

# 20 Linear Perimeter

whitegoods



20 Linear  
Mini Z Cove

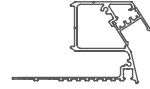

20MZC  
20 Linear  
Mini Z Cove

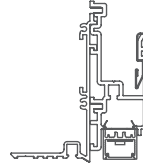

20LPF-RPT  
Flush Plaster Trim



20LPF-RBT  
Flush Bezel Trim



20LPF-RGT  
Flush Return Trim

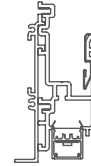

20LPF-RRT  
Flush Grid Trim



20 Linear  
Mini Edgeless Cove

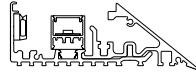

20 Linear  
Mini Edgeless Cove

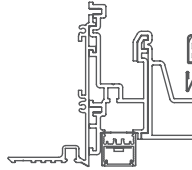

20LPFSG-RPT  
Flush Plaster Trim  
Soft-graze

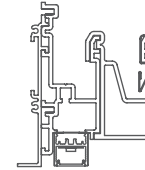

20LPFSG-RBT  
Flush Bezel Trim  
Soft-graze

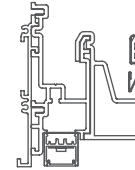

20LPFSG-RRT  
Flush Return Trim  
Soft-graze

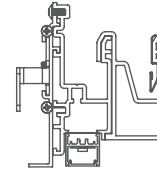

20LPFSG-RGT  
Flush Grid Trim  
Soft-graze



20 Linear  
Perimeter Flush

# 20 Linear Wallgraze

whitegoods



20 Linear  
Perimeter Regressed  
and Wallgraze

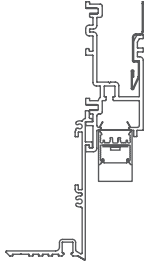

20LPR-RPT  
Regressed Plaster Trim

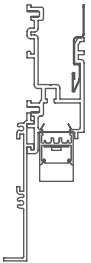

20LPR-RBT  
Regressed Bezel Trim

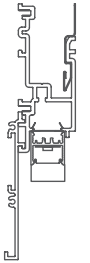

20LPR-RRT  
Regressed Return Trim

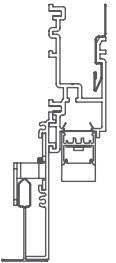

20LPR-RGT  
Regressed Grid Trim

Narrow Lens

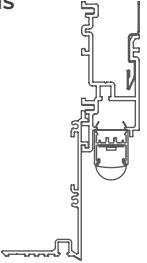

20LPR-RPT  
Regressed Plaster Trim

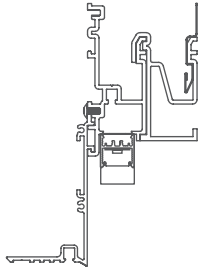

20LPRSG-RPT  
Regressed Plaster Trim  
Soft-graze

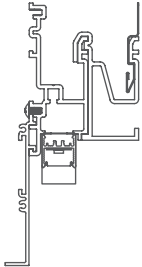

20LPRSG-RBT  
Regressed Bezel Trim  
Soft-graze

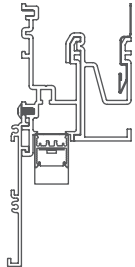

20LPRSG-RRT  
Regressed Return Trim  
Soft-graze

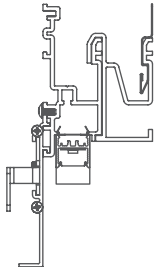

20LPRSG-RGT  
Regressed Grid Trim  
Soft-graze

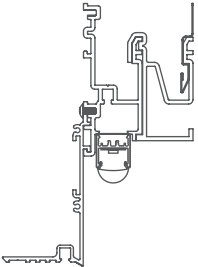

20LPRSG-RPT  
Regressed Plaster Trim  
Soft-graze

# Confidential Healthcare Association

location: **Washington, DC**  
architect: **OTJ Architects**  
lighting design: **Sarah Richter**  
photography: **Trent Bell**



**20 Linear Perimeter – Flush**

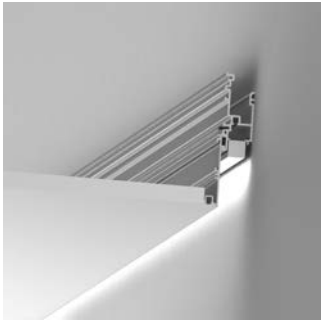

**20 Linear Perimeter  
Regressed and Wallgraze**







## IDA Headquarters

location: **Washington, DC**  
architect: **KGD Architecture**  
lighting designer: **CM Kling**  
photography: **Kristopher Ilich**



**20 Linear Perimeter  
– Flush**





## Confidential Client

location: **Washington, DC**  
specifier: **HYL Architecture**  
photography: **Garrett Rowland**



**20 Linear Perimeter – Flush**

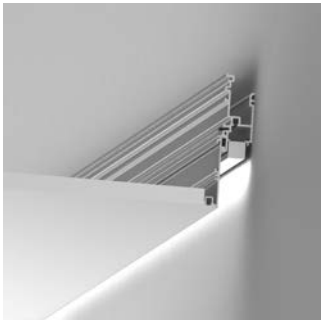

**20 Linear Perimeter  
Regressed and Wallgraze**







# WETA HQ

location: **Arlington, VA**  
specifier: **Studios Architecture**  
photography: **©Judy Davis**



**20 Linear Perimeter – Flush**



**20 Linear Perimeter  
Regressed and Wallgraze**







# TIAA Charlotte Campus

location: **Charlotte, NC**  
specifier: **IA Interior Architects  
Charlotte**  
photography: **Keith Isaacs**

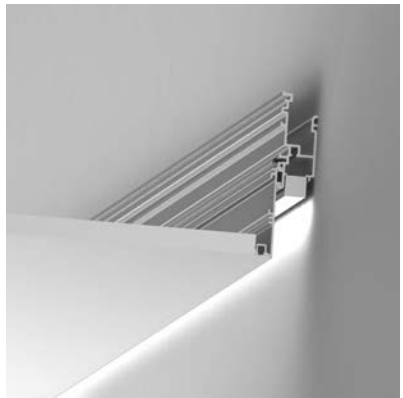

**20 Linear Perimeter  
Regressed and Wallgraze**



whitegoods





20 Linear Direct / Indirect

## 20 Linear Direct/Indirect

whitegoods

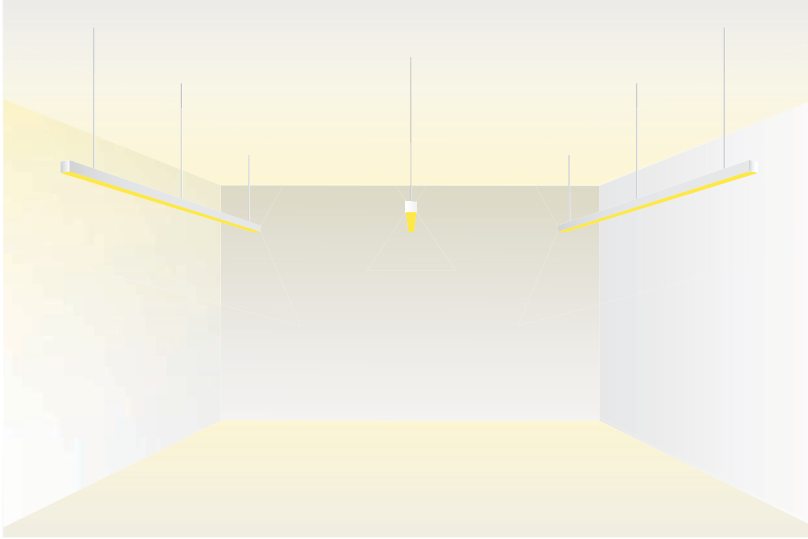

A well-lit room balances indirect uplight to brighten the space with direct light focused where needed.

Pendant lights achieve this by emitting light both up and down, providing even illumination and efficient task lighting.

Wall-mounted direct/indirect fixtures offer a similar effect while visually expanding the room's height and width.

**Tip**

Look for Whitegoods product codes which include "LDI" to find products ideal for Direct Indirect applications.

# 20 Linear Direct / Indirect Suspended

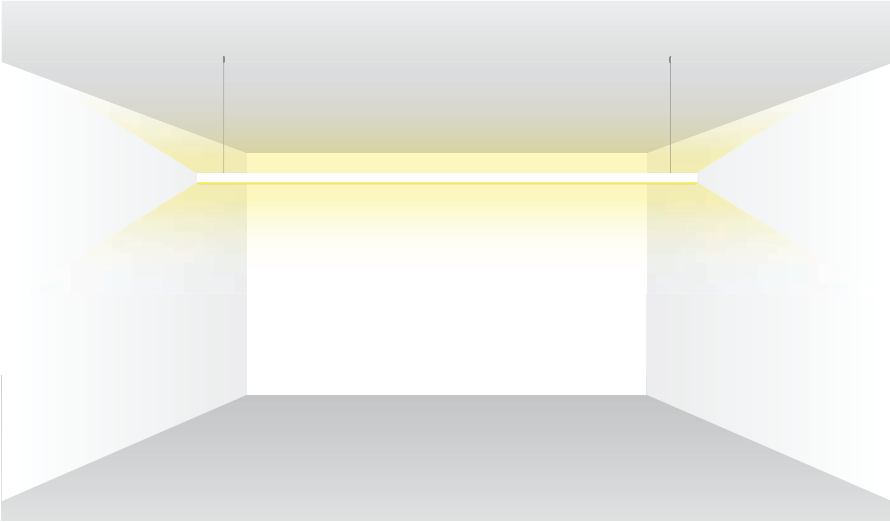

## Optical Accessories



1.4"  
36mm

0.75"  
19mm

WG-20LDI-S-S...-LL45-ODI-W  
WG-20LDI-S-S...-LL45-SDI-W  
Suspended  
Louver

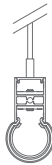

1.8"  
45mm

1.0"  
25mm

WG-20LDI-S-S...-ROD-ODI-W  
WG-20LDI-S-S...-ROD-SDI-W  
Suspended  
Louver

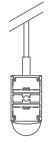

1.3"  
33mm

0.75"  
19mm

WG-20LDI-S-S...-LN16-ODI-W  
WG-20LDI-S-S...-LN16-SDI-W  
Suspended  
Narrow Lens

# 20 Linear Direct / Indirect Wall

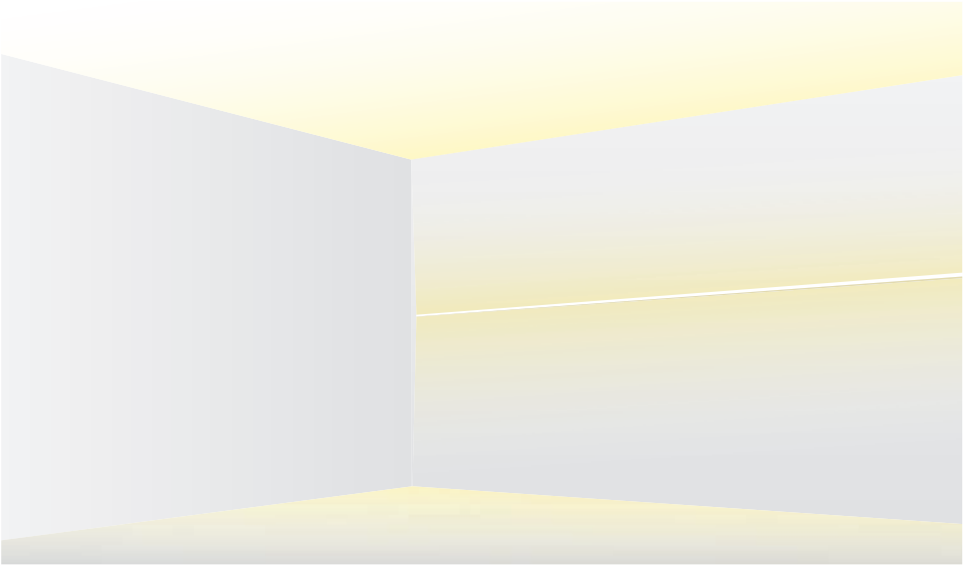

## Mounting and Recommended Spacing

20 Linear Direct / Indirect  
Surface Wall Mount

WG-20LDI-SW-S  
Surface Wall Mount

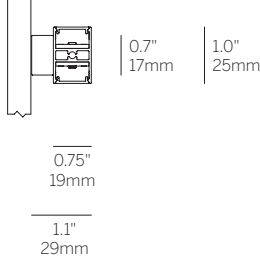
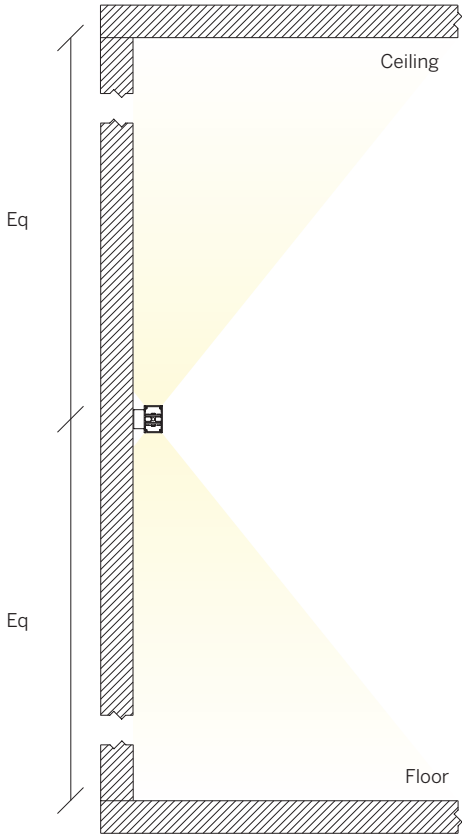

## 20 Linear Direct / Indirect



20 Linear  
Direct / Indirect  
Suspended



20 Linear  
Direct/Indirect  
Surface Wall



Mini Edgeless Cove  
+ 20 Linear Direct



20LDI  
Suspended  
Direct/Indirect



20LDI-SW  
Surface  
Wall Mounted  
Direct/Indirect

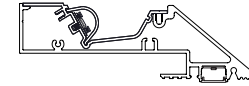

Mini Edgeless Cove  
+ 20 Linear Direct

# Daikin Interiors

location: **Washington, DC**  
architect: **VA-Spaces**  
photography: **Judy Davis Photography, LLC**



20 Linear Suspended

## BWI Airport Concourse D

location: **Baltimore, MD**  
architect: **JMT Architecture**  
lighting design: **MCLA**  
photography: **Nathan Cox Photography**



**20 Linear Suspended**  
**direct / indirect**



whitegoods



# Houston Methodist Hospital Medline Logistics Center

location: Houston, TX



**20 Linear Direct-Indirect  
Surface Wall Mount**

80 Whitegoods 20 Linear







ity  
sion  
tability  
ct  
ence

M

SUPPLY CHAIN

ITIES 4

MAX BR  
TAKE  
NET  
CEL CAP

CAUTION



20 Linear Cove

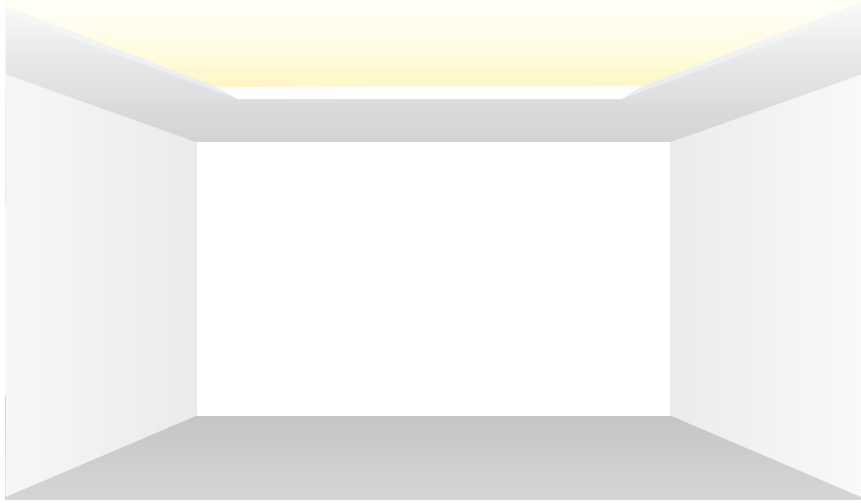

When soft, diffuse light comes from above, it creates a natural feel—much like daylight.

A ceiling cove is an effective way to deliver this light. It requires modest depth—typically 6"–12"—similar to recessed downlights.

Another option is placing a cove 2'–3' from a wall, allowing light to reflect off the ceiling and wash the wall evenly.

This technique works especially well in hospitality and residential spaces. With dimming control, it can shift from bright and fresh to cozy and intimate.

Uplighting makes a room feel bright and airy, even with lower light levels, as ceiling reflections mimic the natural light we experience from the sky.

**Tip**

Look for Whitegoods linear product codes which include "LDL", "MEC", "MZC", to find products ideal for Cove applications.

# 20 Linear Mini Edgeless Cove

whitegoods

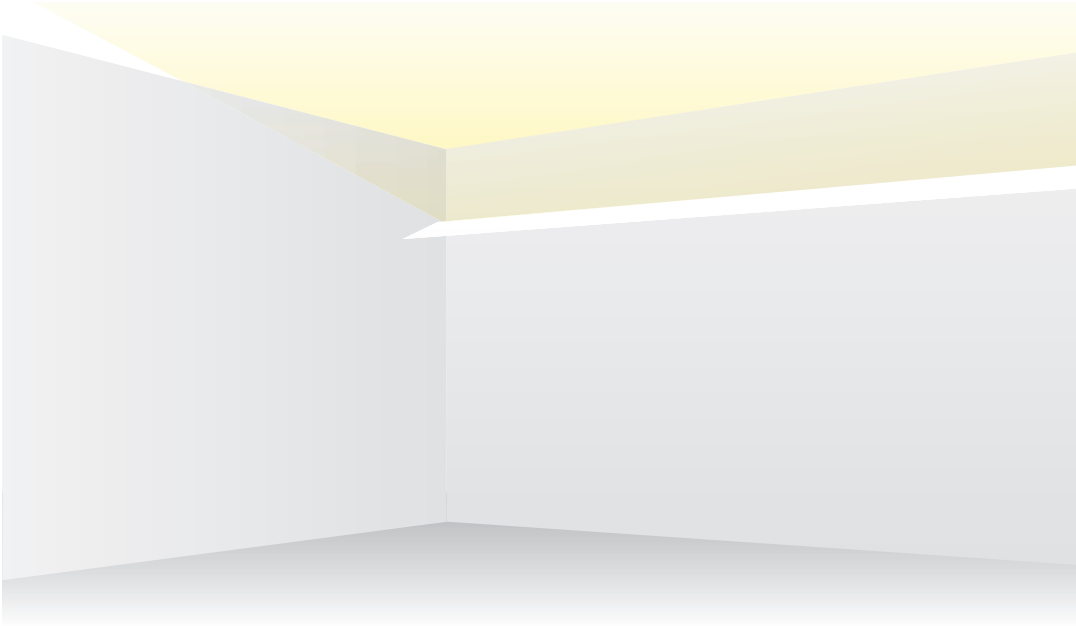

## Mounting and Recommended Spacing

Wall Mounting

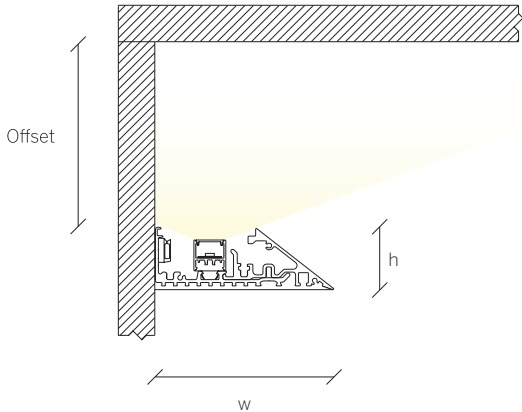

Ceiling Level Change (Coffer or Raft)

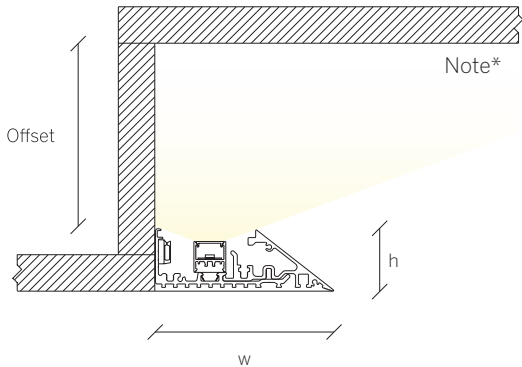

# 20 Linear Mini Z Cove

whitegoods

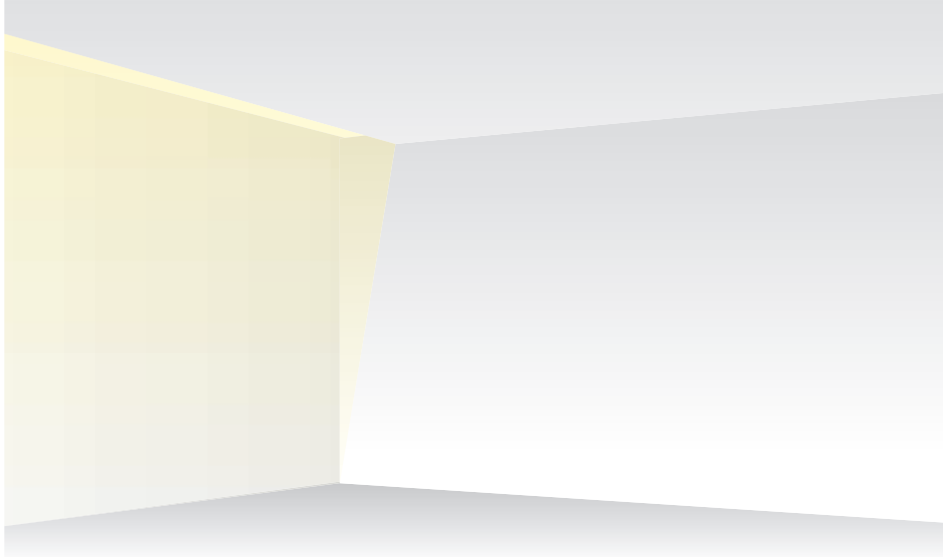

## Mounting and Recommended Spacing

Option 1 Mounting to plenum structure only

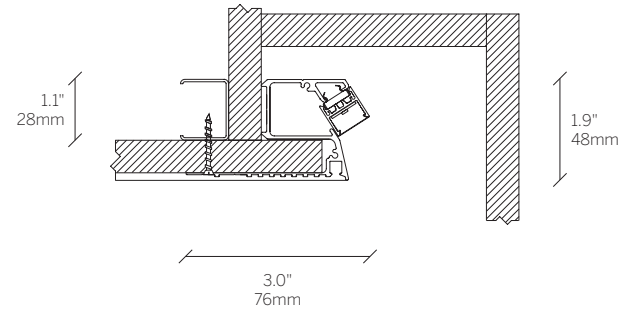

Option 2 Mounting tight against ceiling structure

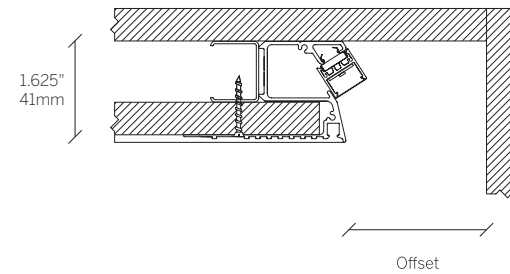

Installs within less than a single layer of standard 3 5/8" gypsum framing system and 5/8" board.

## Alternative Mounting Options

Concealed ceiling wash from wall pocket

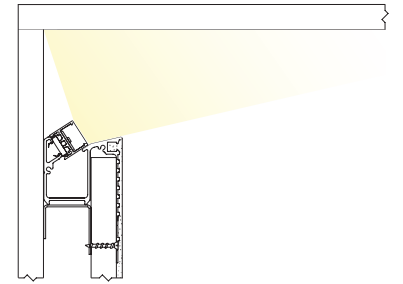

Concealed floor wash from wall pocket

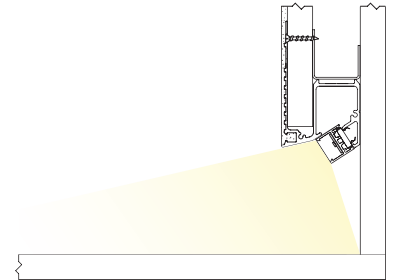

# 20 Linear Cove



20 Linear  
Mini Z Cove

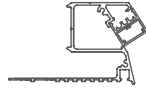

20MZC  
20 Linear  
Mini Z Cove

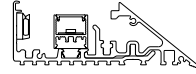

20 Linear  
Mini Edgeless Cove

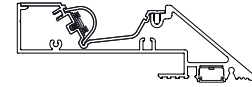

Mini Edgeless Cove  
+ 20 Linear Direct



20 Linear  
Mini Edgeless Cove

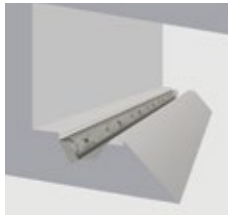

Mini Edgeless Cove  
+ 20 Linear Direct

# Venable LLP

location: **Washington, DC**  
architect: **Alliance Architecture**  
lighting design: **MCLA**  
photography: **Robert Benson and Eric Laignel**



**20 Linear Mini Edgeless Cove (Perimeter)**





**Mini Edgeless Cove + 20 Linear Direct**

whitegoods



**Mini Edgeless Cove  
+ 20 Linear Direct**



20 Linear Configurations

# 20 Linear Configurations

whitegoods



Surface Frame Square



Suspended Frame Square



Surface Frame Rectangle



Suspended Frame Rectangle

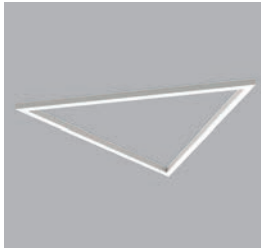

Surface Frame Triangle



Suspended Frame Triangle



Suspended Ypsilon



Multi - Suspended Triangle



# Surface Frame Square

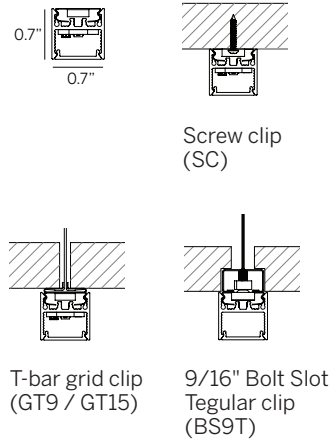

# Suspended Frame Square

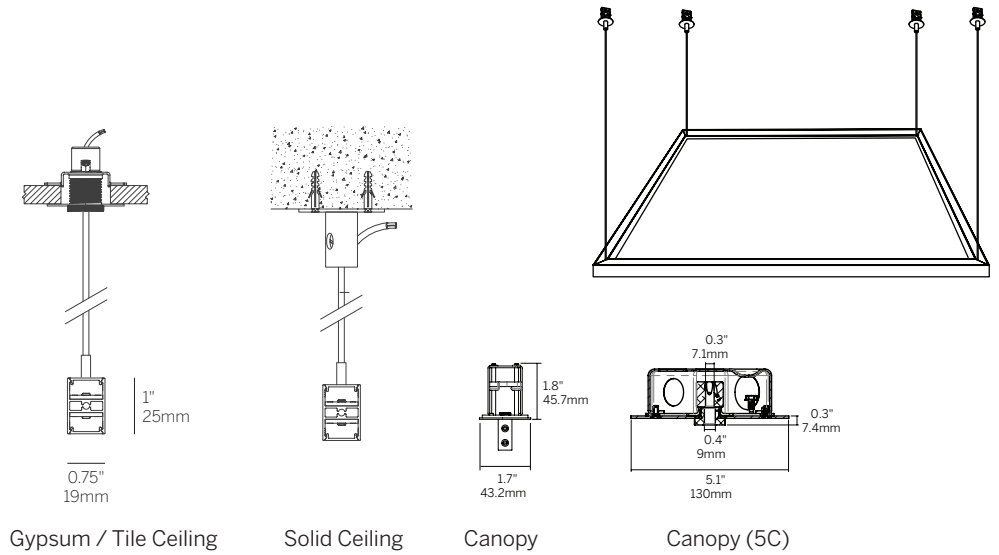
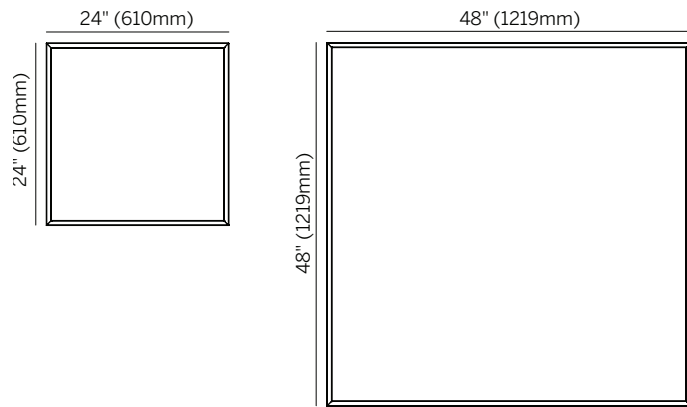

# Surface Frame Rectangle

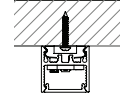
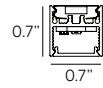

Screw clip (SC)

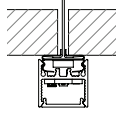

T-bar grid clip (GT9 / GT15)

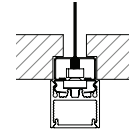

9/16" Bolt Slot Tegular clip (BS9T)

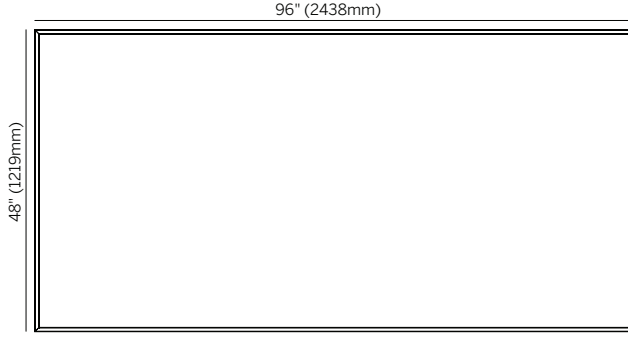
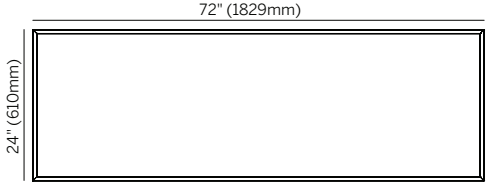
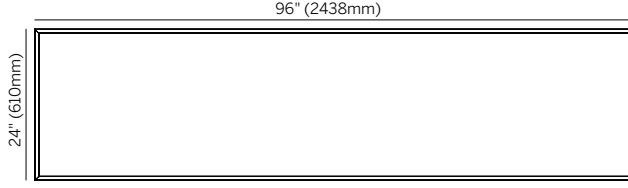
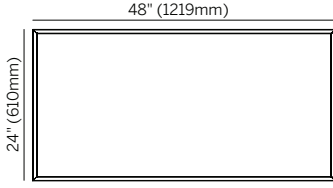

# Suspended Frame Rectangle

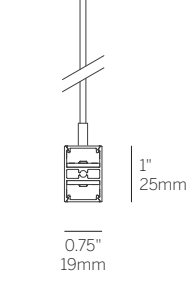
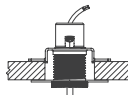

Gypsum / Tile Ceiling

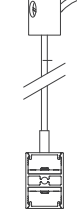
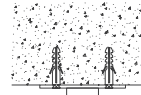

Solid Ceiling

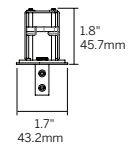

Canopy

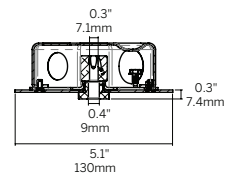

Canopy (5C)

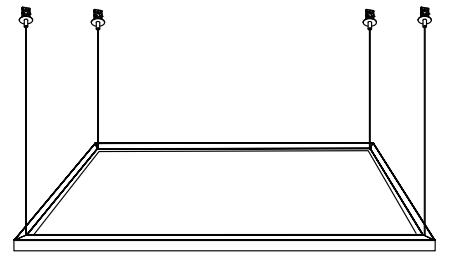

# Surface Frame Triangle

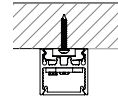
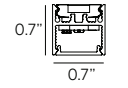

Screw clip  
(SC)

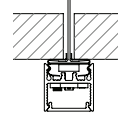

T-bar grid clip  
(GT9 / GT15)

# Suspended Frame Triangle

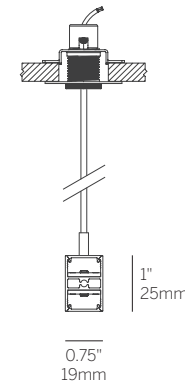
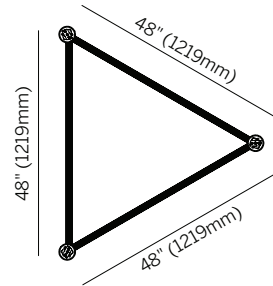
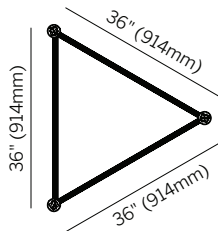
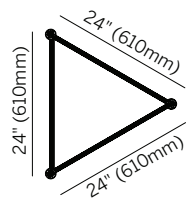

Gypsum / Tile Ceiling

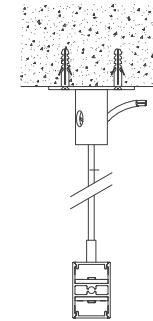

Solid Ceiling

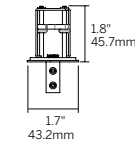

Canopy

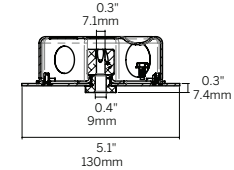

Canopy (5C)

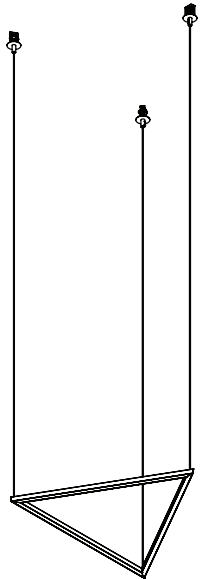

# Suspended Ypsilon

whitegoods



BOTTOM VIEW

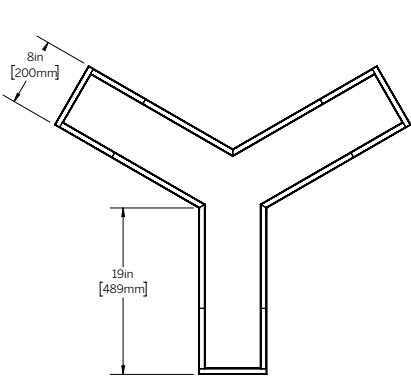

TOP VIEW

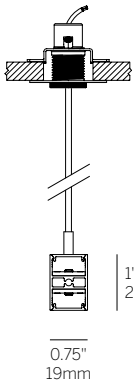
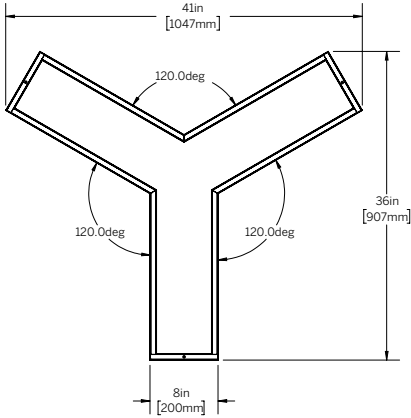

Gypsum / Tile Ceiling

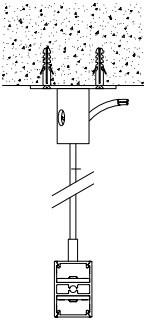

Solid Ceiling

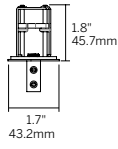

Canopy

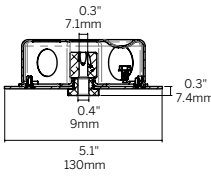

Canopy (5C)

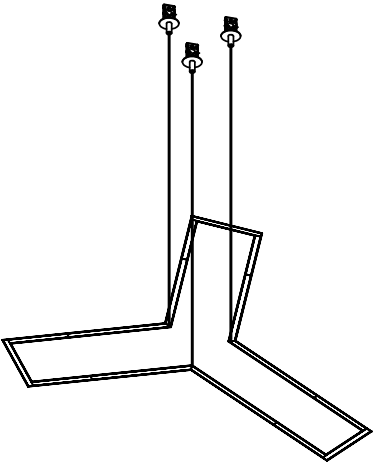

# Multi - Suspended

whitegoods

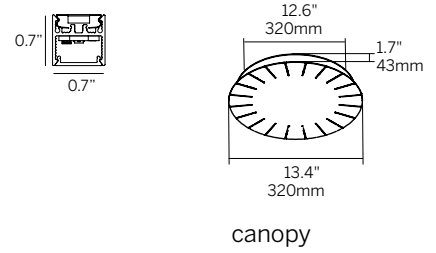
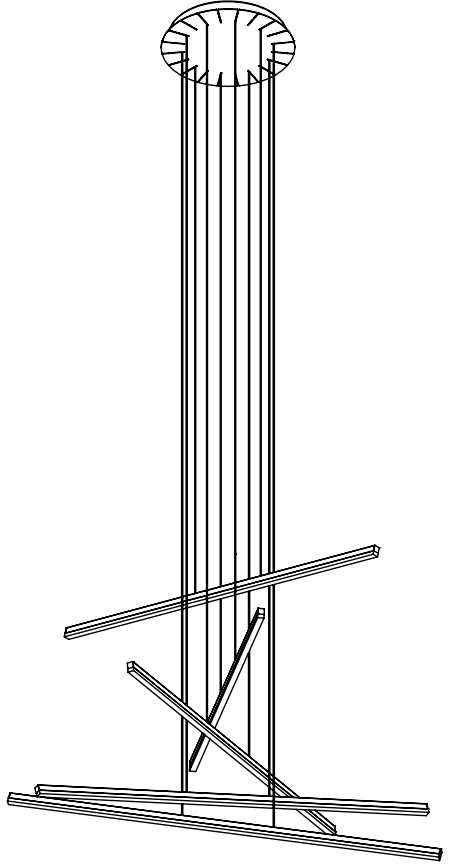
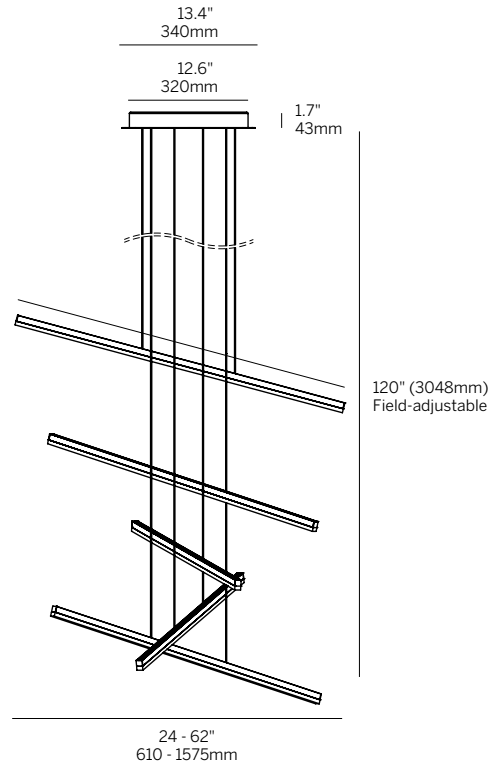



# 20 Linear Wand

We developed the Wand to allow specifiers to see for themselves just how flexible the 20 Linear range is. Direct it up, down, vertically, horizontally, adjacent to a wall, the floor, a frosted panel or tuck it under a shelf. You'll find this is an indispensable tool for roughing out your ideas with light.

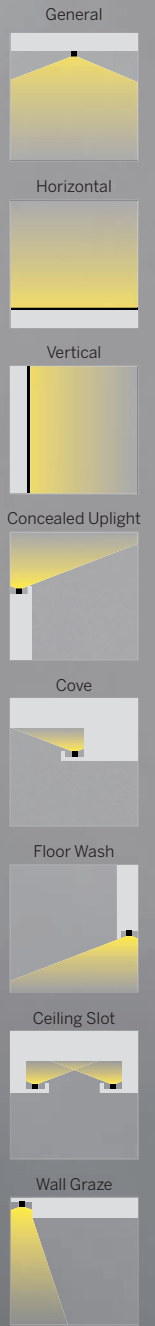

# 20 Linear Catalog



## 20 Linear

whitegoods

### 20 Linear Recessed



Continuous line of light in a 0.7" wide recessed luminaire trimless and bezel trim for seamless integration into any drywall, wood and metal surfaces. Plaster version is less than drywall thickness for easy installation.

- Housing** Precision extruded aluminum for true dimensions and tolerances. Provided with all hardware for seamless integration into selected surface. Standard and tailored lengths including corner configurations. Finishes: white, black, silver and custom.
- Integration** Trimless installation for 1/2"-5/8" drywall without disrupting the structure. Bezel trim for hard surfaces such as drywall, wood and specialty ceilings and walls. Grid trim for installation in grid ceiling systems.
- Distribution** Multiple lens for general, accent and decorative applications.
- LED** Constant Voltage, 90+ CRI, 3 Steps MacAdam, 3W - 10W per foot. L70 lifetime (TM21 Projected 85C). Static White (2700K-4000K) = 60,000 hours. RGBW (3000K White) = 50,000 hours. Warm Dim (1800K-3000K) = 36,000 hours.
- Lens** OD - Opal Diffuser provides even, continuous line of light and general illumination. MPL - Micro-prismatic lens provides lower brightness, general illumination. BD - Block Diffuser of satin acrylic provides general illumination and decorative effect\*. \*straight runs only, no corners.
- Driver** Remote driver. Compatible with quality constant voltage drivers.
- Connectivity** Lutron Athena Wireless Node RF. Casambi BlueTooth.
- Weight** 0.5lbs per foot.
- Operating Temp** Suitable for operation in maximum ambient temperature of 35C (95F).
- Warranty** 5-year Limited (see complete company warranty information).
- Certifications** ETL and ETL-C for dry, damp (WL Wet Location optional), CE.
- Voltages** 24V Fixture / 120-277VAC Driver (remote).

#### Lenses/Accessories



66 Whitegoods 20 Linear



Recessed Plaster Trim (RPT)

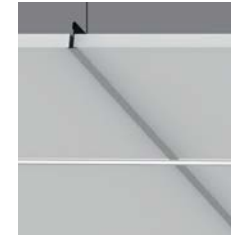

Recessed Grid Trim (RGT)

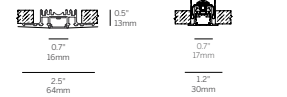

Recessed Plaster Trim (RPT) Recessed Bezel Trim (RBT) Recessed Grid Trim (RGT9/RGT15)

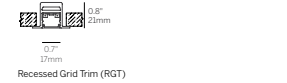

Recessed Grid Trim (RGT) Bezel flush to grid (RGT9/RGT15) Grid on bezel (RGT9/RGT15) Recessed grid trim slot (RGT5)

### 20 Linear Recessed

Model	Fixation	Pattern	Length	Power	CRI/CCT	Driver	Lens	Finish	Cable	Options
WG-20LDL	RPT RBT RGT9 RGT15 RGT5	S P1 PPI PPO PZ	A A x B A x B x C A x B x A x B	L M H	927 930 935 940 WD RGBW	X S S DPH L3DAE L3DOE EL96 DALI DMX	OD (std) MPL BDO BDC	W (std) B S F	C4 (std) C10 C20 C30	AWNRF BT CP EM WL*

#### Model

- WG-20LDL = 20 Linear Downlight

#### Fixation

- RPT = Recessed plaster trim
- RBT = Recessed bezel trim
- RGT9 = Recessed grid trim 9/16"
- RGT15 = Recessed grid trim 15/16"
- RGT5 = Recessed grid trim slot

#### Pattern

- S = Straight run
- P = Standard patterns 2, 3 or 4 sided with 90° corners on the same plane†
- PPI = Wall to ceiling / wall to wall, 90° inside corner†
- PPO = Wall to ceiling / wall to wall, 90° outside corner†
- PZ = Non-standard patterns and/or corners other than 90° on multiple planes, consult factory†

#### Length

- A, B, C = specify inches to the nearest 0.25" (i.e. 72.25")
- For patterns specify each length (i.e. 2 sided: A x B = 72.25" x 48"; 3 sided: A x B x C; 4 sided: A x B x A x B)

#### Power†

- L = 3W/ft low power (WD 2.7 W/ft) (24V)
- M = 6W/ft mid power (WD 5.5 W/ft) (24V) (RGBW - 76 W/ft)
- H = 10W/ft high power (WD 8 W/ft) (24V)
- 927 = 2700K
- 930 = 3000K
- 935 = 3500K
- 940 = 4000K
- WD = Warm Dimming (1800K - 3000K)
- RGBW = 3000K White (M power only)

#### CRI/CCT (90+ CRI)

- 927 = 2700K
- 930 = 3000K
- 935 = 3500K
- 940 = 4000K
- WD = Warm Dimming (1800K - 3000K)
- RGBW = 3000K White (M power only)

#### Driver (remote)

- X = No driver, ordered separately
- S = Standard, non-dim driver 120-277V
- D010 = eldoLED, 10%, 0-10V dimming, 120-277V
- DPH = Phase Dimming, 1% dimming, 120V only
- L3DAE = Lutron Hi-lume 1% EcoSystem, 120-277V
- L3DOE = Lutron Hi-lume Premier 0.1% EcoSystem, 120-277V
- EL96 = eldoLED, 24V, 0.1% 0-10V Dimming
- DALI = eldoLED DALI (DT6), 0.1% dimming (120-277V)
- DMX = eldoLED, 24V, 0.1% DMX Dimming

#### Lens

- OD = Satin opal diffuser (standard)
- MPL = Micro-prismatic lens
- BDO = Block diffuser opal†
- BDC = Block diffuser clear†

#### Finish

- W = White, 15% gloss, RAL 9010 (standard)
- B = Black, 15% gloss, RAL 9005
- S = Silver, 15% gloss, RAL 9006
- F = Custom finished trim, specify RAL

#### Cable

- C4 = 4' tray cable (plenum rated) (standard)
- C10 = 10' tray cable (plenum rated)
- C20 = 20' tray cable (plenum rated)
- C30 = 30' tray cable (plenum rated)

#### Options

- AWNRF = Lutron Athena Wireless Node RF (specify with D010, EL96 or DALI)
- BT = Wireless CAS - Casambi (specify with D010, EL96, DALI or DMX)
- CP = Chicago Plenum
- EM = Emergency (remote)
- WL = Wet Location Under Canopy / Cover†

Whitegoods reserves the right to change any information without prior notice.

#### Notes

- See pattern spec sheet.
- Wattage shown is for LED boards only, system wattage varies depending on driver selected.
- Refer to specsheet for delivered lumen data for all product configurations.
- Remote power supply required. See power supply page for details.
- Butt seam (lens) when in continuous run, straight runs only. BDO/BDC offered for RBT / RGT only.
- Wet Location option available for OD / MPL lenses and recessed / surface ceiling applications only.



whitegoods

20 Linear



20 Linear Plaster Trim

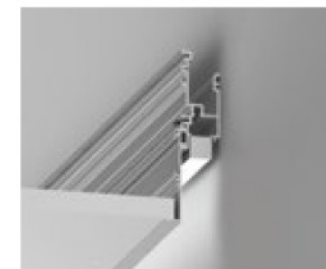

20 Linear Perimeter  
Regressed Bezel Trim



20 Linear Flush Grid Trim

**inter•lux**  
tools for lighting

The 20 Linear profile is a versatile architectural lighting tool developed to allow designers the freedom to work with light in an instinctive way. Utilizing the small form factor, the range includes a family of profiles all based around the same high performance linear LED technology, developed by Whitegoods specifically for this product line.

[inter-lux.com/whitegoods](http://inter-lux.com/whitegoods)

# Credits

whitegoods



**Association of American Universities**  
location: **Washington, DC**  
architect: **OTJ Architects**  
photography: **Chris Spielmann**



**Virginia DOT Virginia State Police**  
location: **Colonial Heights, VA**  
architect: **HGA-DC**  
lighting design: **CM Kling + Associates**  
photography: **Paul Rivera**



**Orrick**  
location: **Washington, DC**  
architect: **OTJ Architects**  
specifier: **CM Kling**  
photography: **Trent Bell**



**41 L Street**  
location: **Washington, DC**  
architect: **SK+I Architecture**  
specifier: **CMK**  
photography: **Max Zhang, IRIS22**



**Confidential VC Firm**  
location: **Northern Virginia**  
specifier: **sshape**  
rep: **Alliance Lighting**  
photography: **Garrett Rowland**



**TIAA Charlotte Campus**  
location: **Charlotte, NC**  
specifier: **IA Interior Architects**  
photography: **Keith Isaacs**



**Daikin Interiors**  
location: **Washington, DC**  
architect: **VA-Spaces**  
lighting designer: **StudioHDP**  
photography: **Judy Davis**



**BWI Airport Concourse D**  
location: **Baltimore, MD**  
architect: **JMT Architecture**  
lighting design: **MCLA**  
rep: **Alliance Lighting**  
photography: **Nathan Cox**



**Confidential Client**  
location: **Washington, DC**  
specifier: **HYL Architecture**  
photography: **Garrett Rowland**



**American Bankers Association**  
location: **Washington, DC**  
architect: **OTJ Architects**  
lighting design: **CM Kling**  
photography: **Trent Bell**



**Georgetown Visitation Prep School**  
location: **Washington, DC**  
specifier: **CGS Architects**  
rep: **Alliance Lighting**  
photography: **Chris Ambridge**



**Confidential Healthcare Association**  
location: **Washington, DC**  
architect: **OTJ Architects**  
lighting design: **Sarah Richter**  
photography: **Trent Bell**



**Warner Building**  
location: **Washington, DC**  
architect: **STUDIOS Architecture**  
specifier/lighting design: **MCLA**  
photography: **Barry Harley**

THANK YOU

whitegoods

inter•lux

