

Installation Instructions

Luminaires must be installed by a qualified electrician. Check with local and national codes for proper installation.



To prevent electrical shock disconnect electrical supply before installation or servicing.
Never connect a live fixture!!!

Contractor is responsible for adequately reinforcing walls and/or ceilings to support fixture weight. Provide blocking when necessary.

Step 1 - **Open the Box**

Unpack luminaire unit. Unit consists of (3) major parts: Housing, Luminaire with Diffuser, and Remote Housing with Driver. Plenum-rated cable with bare leads is also provided. Remote Drivers and Housings are supplied by Inter-lux.

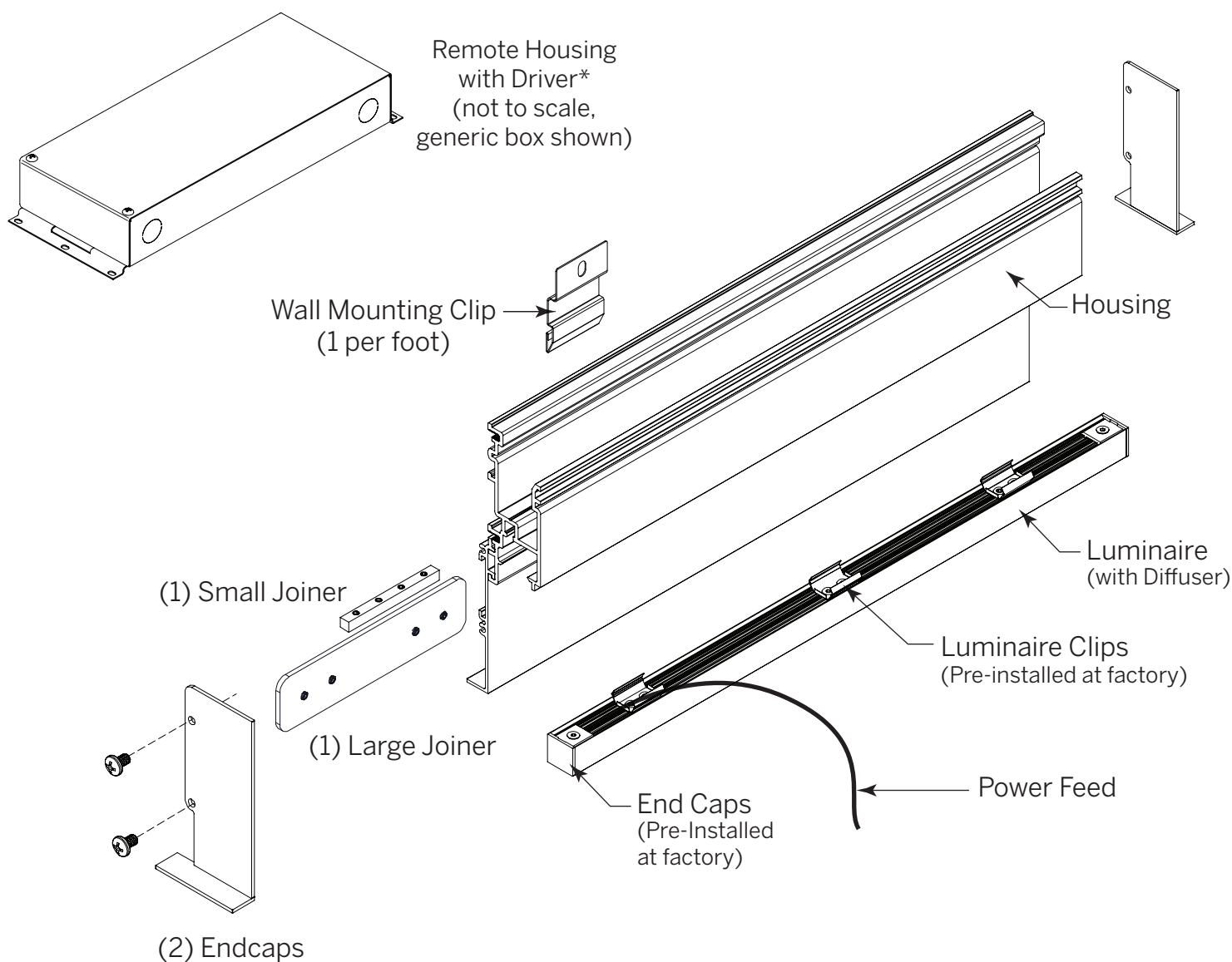

(2) Endcaps
Endcaps come in Kits
on **Stand Alone Units**
and on **Multi Unit Runs**

**Need
Help?**

*See Wiring and Driver Pages for actual
Remote Driver and Housing Pairings

20 Linear

WG-20LPR-RBT

Perimeter Regressed

Recessed Bezel Trim

2/5

Step 2 - *Installation Prep*

Cut 1½" opening between Wall and existing Drywall Ceiling or, in the case of new construction, allow 1½" between Wall and edge of installed ceiling.

Step 3 - *Install Wall Mounting Clips*

Mark wall 5-3/16" above exposed surface of Drywall Ceiling. Screws and anchors supplied by others. Blocking is recommended to support weight of fixture (1½ lbs/ft.). Locate clips no less than 3" from each end of fixture.

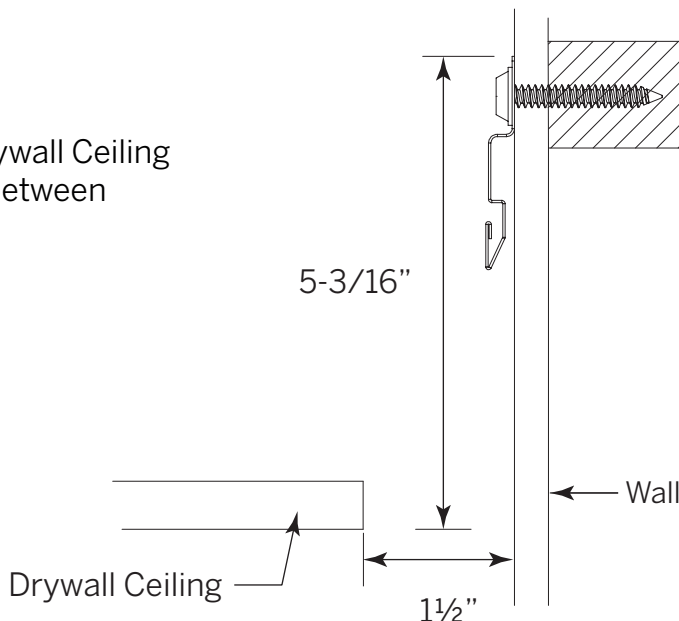

Step 4 - *Drill Power Feed Holes*

- a** Determine on which end of Luminaire Power Feed will enter on Housing and mark location at least 3" from end. Drill ¼" hole at mark on V-Groove.
- b** Drill another ¼" hole through Wall above Mounting Clips adjacent to hole in Housing.
- c** Install Remote Drivers and run low voltage wires through drilled hole in Wall.

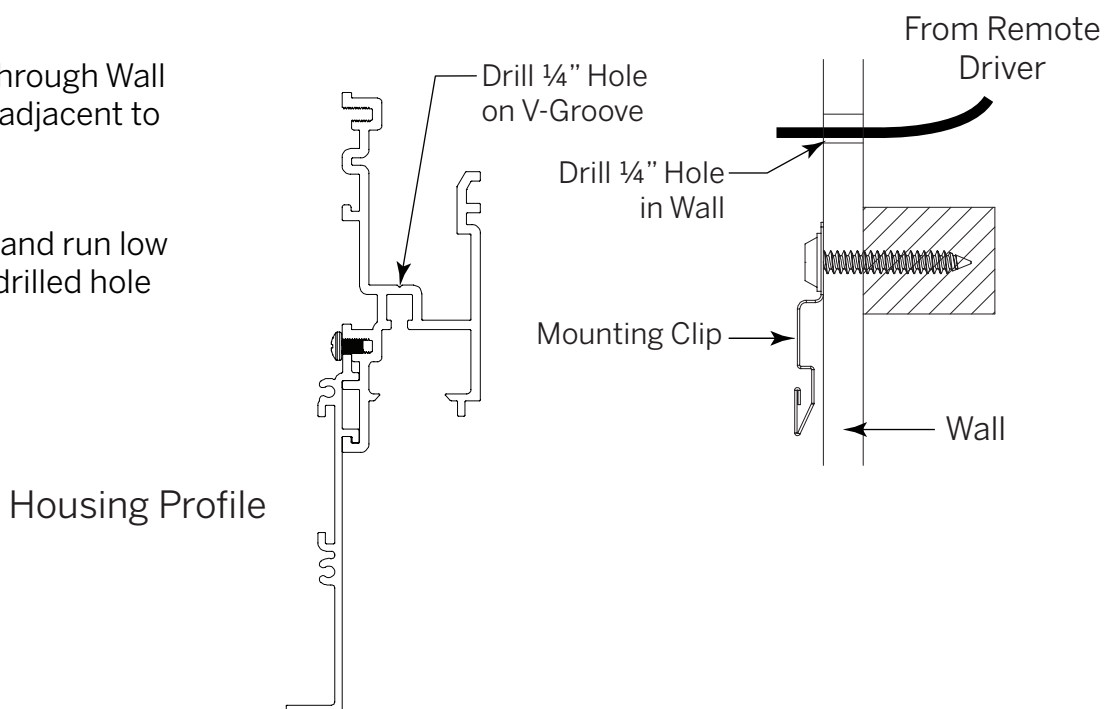

Need
Help?

Step 5 - *Install Endcaps*

Attach Endcaps to Housings at beginning and end of Run. Align holes with round channels indicated at right. Fasten with supplied screws.

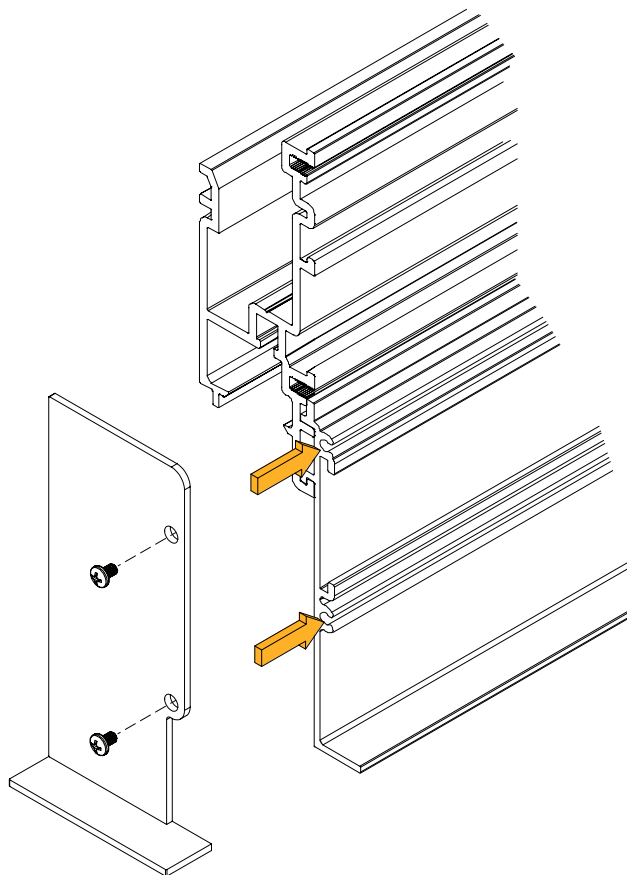

NOTE: End Caps may be omitted from a wall-to-wall installation.

Step 6 - *Install Joiners - Multi Unit Run only*

- a** On the Starting Unit on the open end (opposite End Cap), slide Large Joiner halfway into major channel on outer face of Housing. Fasten with supplied Set Screws.
- b** Slide Small Joiner halfway into center square channel, as shown at right. Fasten from bottom with supplied Set Screws.
- c** Repeat for every Middle unit in Run, on the same end as Starting Unit.

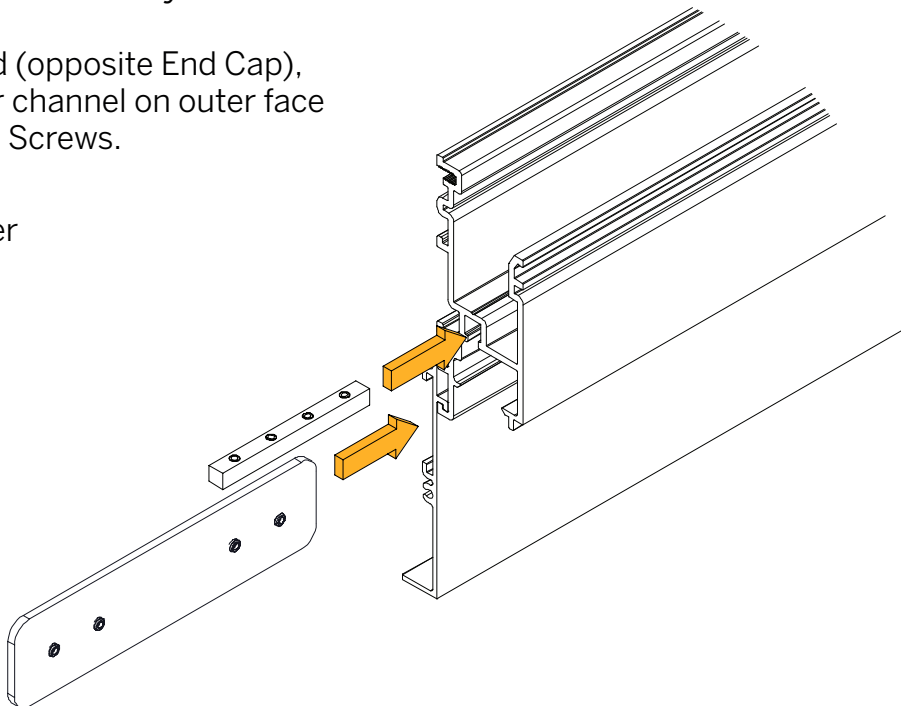

NOTE:

Large Joiner uses (4) M4 x 4mm Set Screws

Small Joiner uses (4) M3 x 5mm Set Screws

**Need
Help?**

Step 7 - *Install Housing(s)*

- a** Slide Housing upward such that Back Rail slides up and underneath Mounting Clip.
- b** Pull Low Voltage wire from Wall.
- c** For a **Multi Unit Run**, repeat step **a** for each additional unit, then slide unit onto exposed Joiners of installed unit. Long runs may have additional power feeds. Tighten Set Screws to fasten.

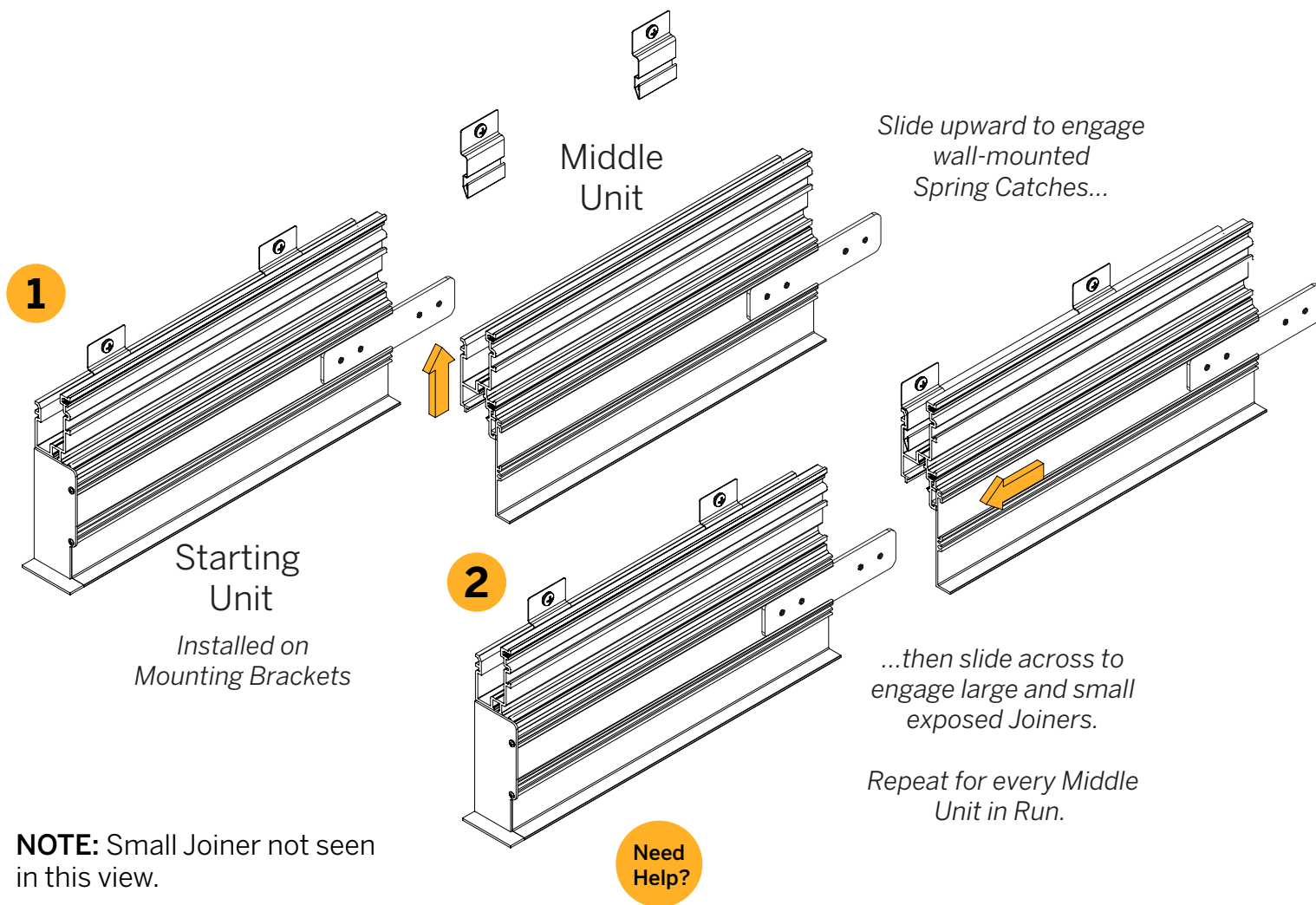
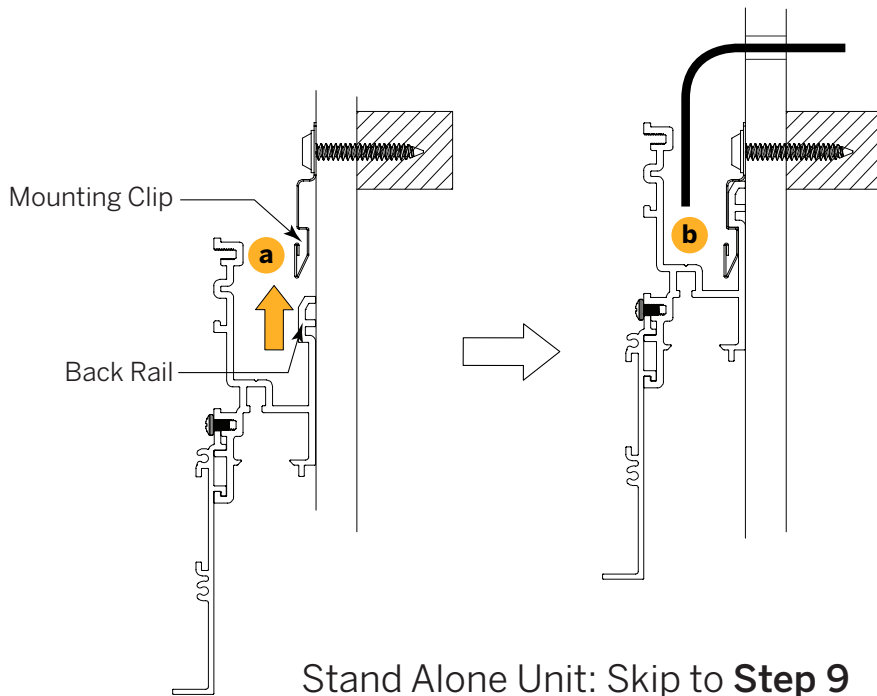

Step 8 - **Corners** - Multi Unit Run only

Pattern Inside (PI) and Pattern Outside (PO) Corners are welded at the factory. Follow **Step 7c** to mount to existing Run. Illustration of light output shows direction only, and is not indicative of color, intensity, or actual spread.

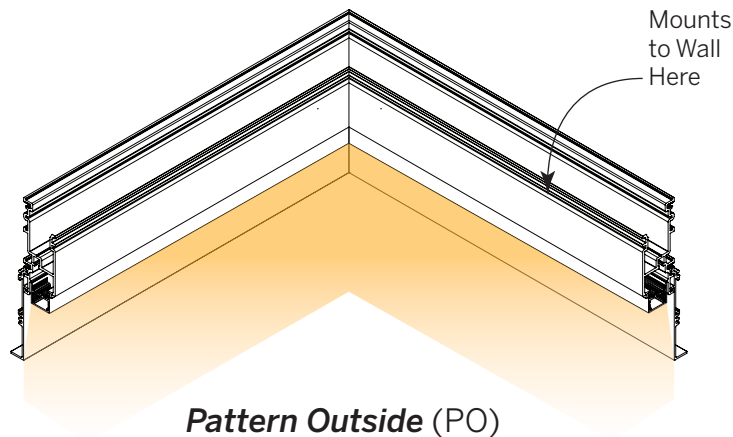
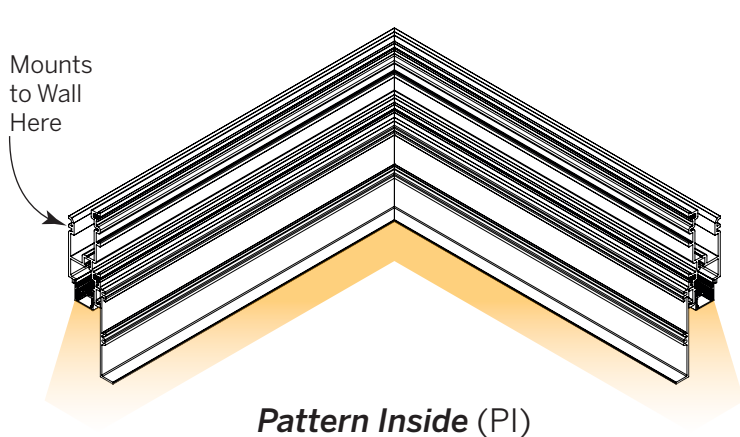

Step 9 - **Install Luminaire(s)**

- a** Raise Luminaire up into Housing. Connect Low Voltage Wires from Luminaire to those coming from Remote Driver using appropriate connectors (by others).
- b** Push Luminaire into Housing until Luminaire Clips engage.

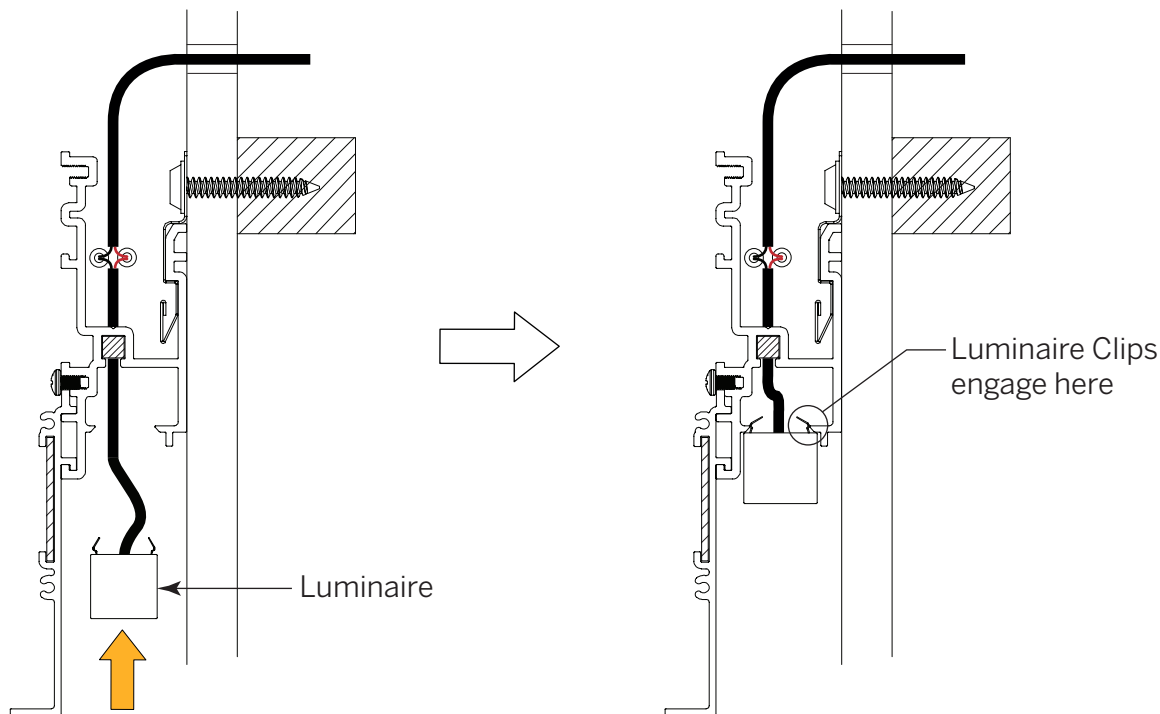

- c** Energize!

**Need
Help?**