

ARCHILINE WALL

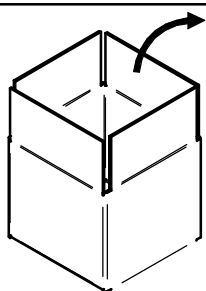

BRACKET

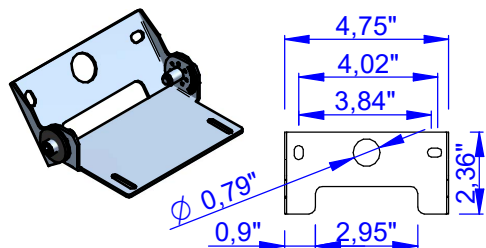
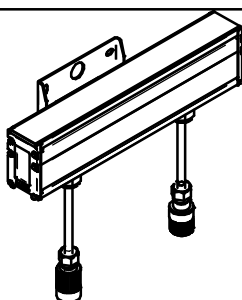

FLAP ACCESSORY

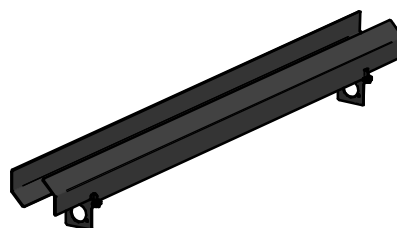

COD.	L (inch)
98675	24,41"
98676	36,22"
98677	48,03"

BAR FIXING

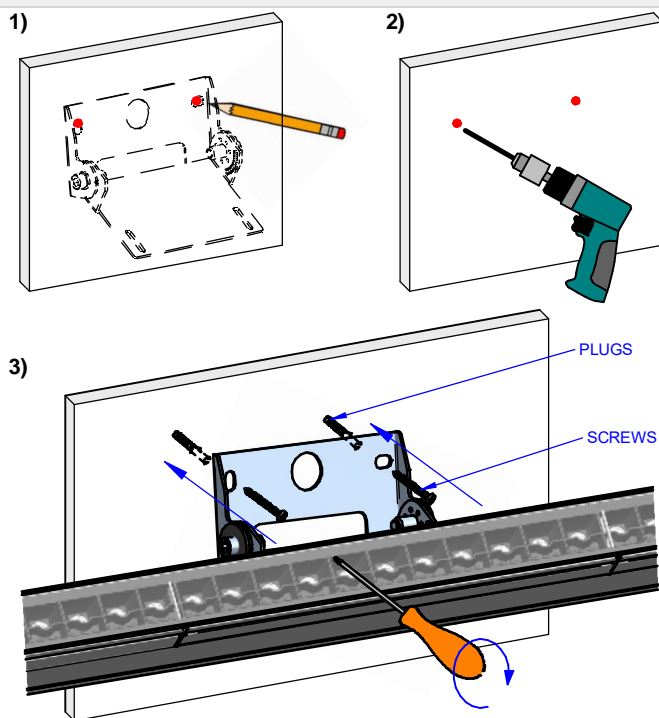

FLAP ASSEMBLY

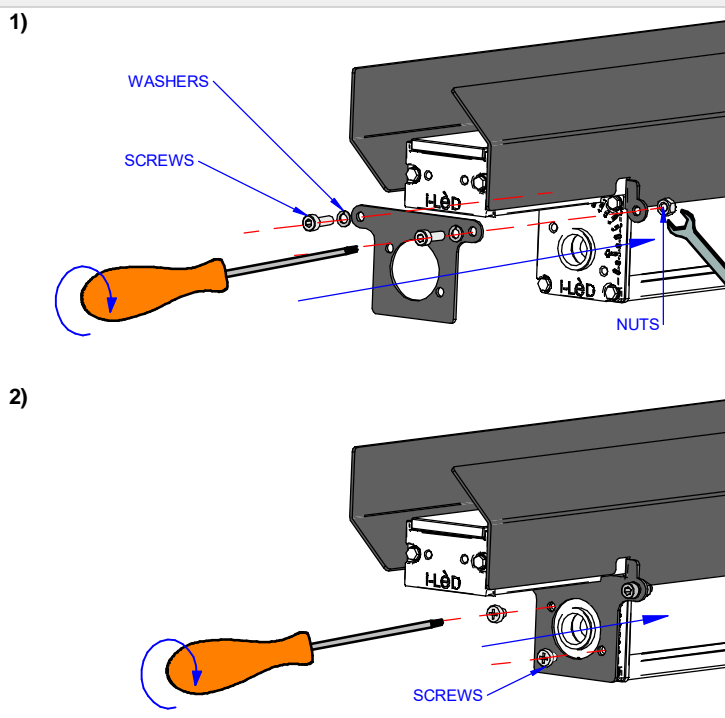

BAR ANGLE ADJUSTMENT

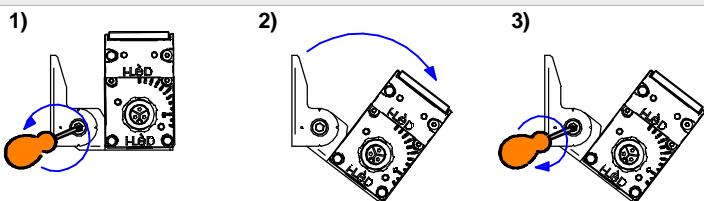

FLAP ANGLE ADJUSTMENT

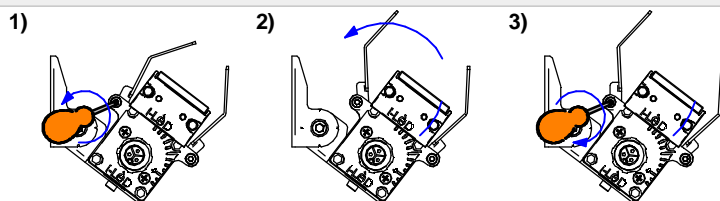

BRACKET POSITION

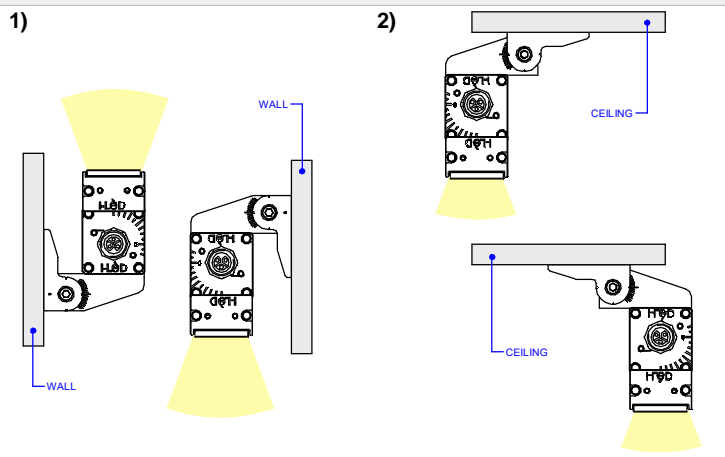

ARCHILINE POSITIONING FOR DARK LIGHT EFFECT

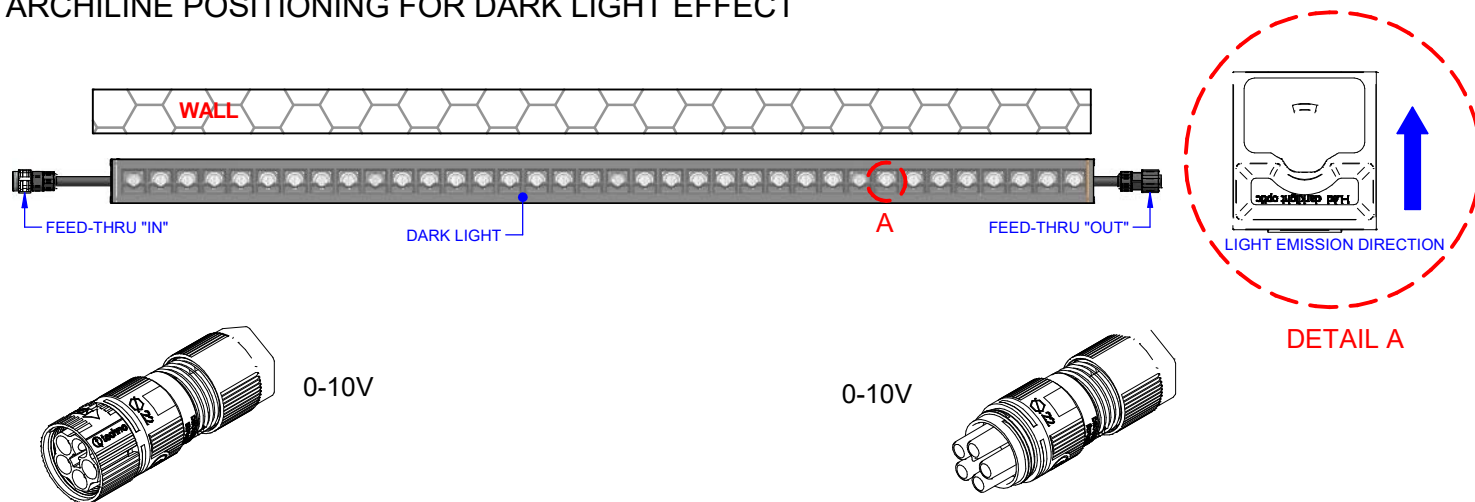

THIS PRODUCT MUST BE INSTALLED IN ACCORDANCE WITH THE APPLICABLE INSTALLATION CODE BY A PERSON FAMILIAR WITH THE CONSTRUCTION AND OPERATION OF THE PRODUCT AND THE HAZARDS INVOLVED

MOUNTING INSTRUCTIONS

READ ALL OF THESE INSTRUCTIONS BEFORE INSTALLING FIXTURES

- Keep all of the instructions for future reference
- Turn off power before installing fixture
- Installation is to be performed by a qualified electrician only
- All installations must conform to the National Electrical Code as well as all local jurisdictional codes and regulations
- Any modification of the luminaire will void any and all written or implied warranties
- The manufacture accepts no responsibility for damage to persons or property arising through improper use or installation

INSTALLATION SEQUENCE

- Instal the outercasing with the appropriate instructions
- Ensure power is off before connecting the Archiline to the main voltage
- Insert the Archiline into the outercasing following the images
- Fix the Archiline on the outercasing
- Energize
- * To calculate the maximum extension cable, please contact the technical service with the technical specifications of the cable used

WARNING !!! (ARCHILINE WALL MONO WHITE LIGHT)

- The light source contained in this luminaire shall only be replaced by the manufacturer or his service agent or a similar qualified person.
- Photobiological risk: unlimited RG1.

0-10V VERSION WIRING DIAGRAM

POWER CABLE E99822 (196.9") / E99826 (39.4")

BLACK = L
WHITE = N
GREEN = EARTH
PURPLE = 0-10V +
GREY = 0-10V -

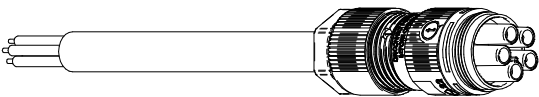
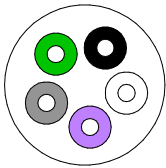

ORANGE = L
BLUE = N
YELLOW = EARTH
RED = 0-10V +
BLACK = 0-10V -

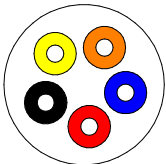

OLDER COLOR CHART!
Previous version of the cable has different color.
Follow the appropriate color chart depending on the installed cable.

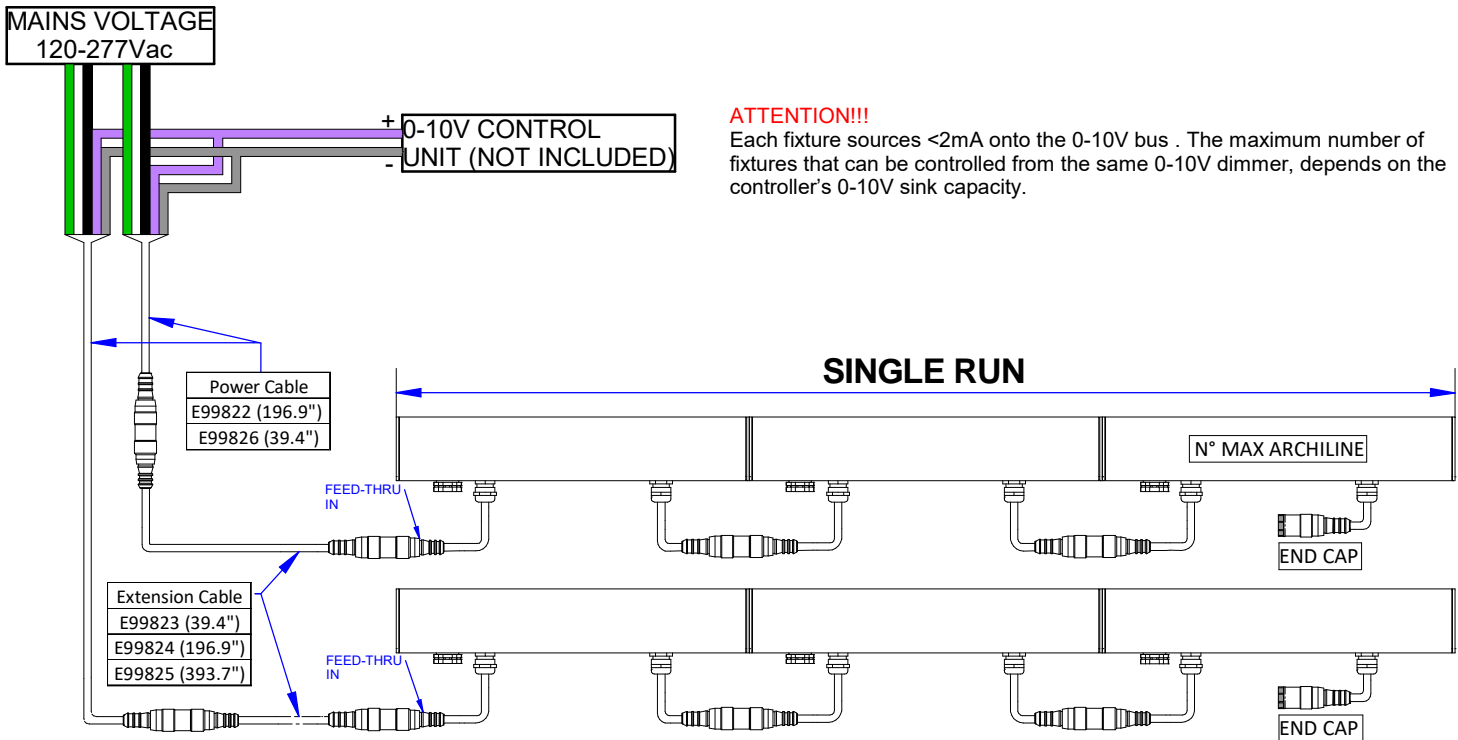

ATTENTION!!!
Each fixture sources <2mA onto the 0-10V bus . The maximum number of fixtures that can be controlled from the same 0-10V dimmer, depends on the controller's 0-10V sink capacity.

FEED-THRU CONNECTORS

"IN" SIDE

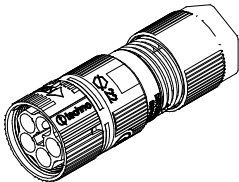

"OUT" SIDE

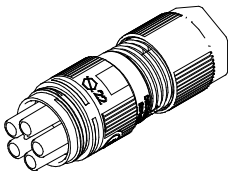

ARCHILINE LENGTH	12.6"	24.4"	36.2"	48.0"	59.8"
MAX N° ARCHILINE ON A SINGLE RUN @ 120V	37	20	13	10	8
MAX N° ARCHILINE ON A SINGLE RUN @ 277VAC	75	40	27	20	16

RGBW DMX VERSION WIRING DIAGRAM

ALLinONE Power and DMX cable

connectors	sec. Ø
F 6 pin	3 x 15 awg + 2 x 24 awg + shield
L ft	
3.28	E98660
16.40	E98661

ALLinONE extension power and DMX cable

connectors	sec. Ø
M / F 6 pin	3 x 15 awg + 2 x 24 awg + shield
L ft	
3.28	E98662
16.40	E98663

Connector | DMX 120 Ω Terminator



E98986
It is mandatory to install this terminator at the end of a single run

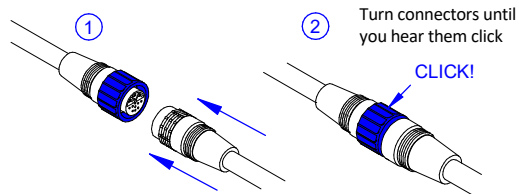

Secondary Cable Colours	Pole
Red wire	DMX+ (A)
White wire	DMX- (B)
Shield	DMX GND
Black wire	L
White wire	N
Green wire	Earth

