

Installation Instructions

Luminaires must be installed by a qualified electrician. Check with local and national codes for proper installation.



Never connect a live fixture!!!

To prevent electrical shock disconnect electrical supply before installation or servicing.

Never connect a fixture to a live driver!!!

Contractor is responsible for adequately reinforcing walls and/or ceilings to support fixture weight. Provide blocking when necessary.

Step 1 - *Open the Box*

- a** Unpack Luminaire unit(s). The Rubber 3D Luminaire is unique among our many offerings and requires special handling during installation. 39.5" (1m) lengths are supplied in Tubes; 197" (5m), 315" (8m), and 394" (10m) lengths are supplied on a Reel, packed in a large anti-static bag. Remote drivers and housings are ordered separately.

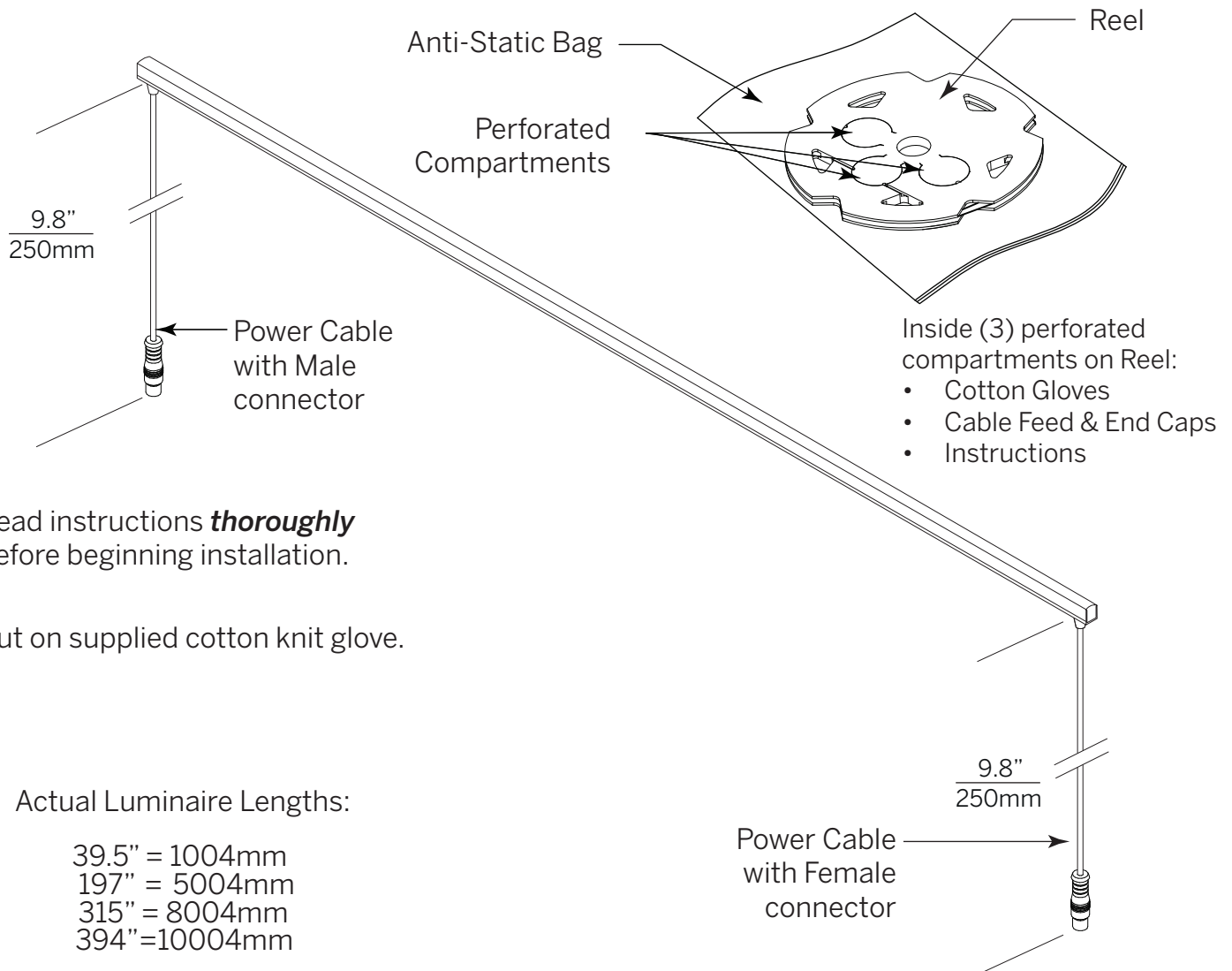

Need Help?

IMPORTANT: As a flexible product, installation should not be attempted by one person working alone.

Installation Instructions

2/9

Step 2 - *Recommended Practices in Handling Fixture*

Open the Bag and lay Reel on work surface

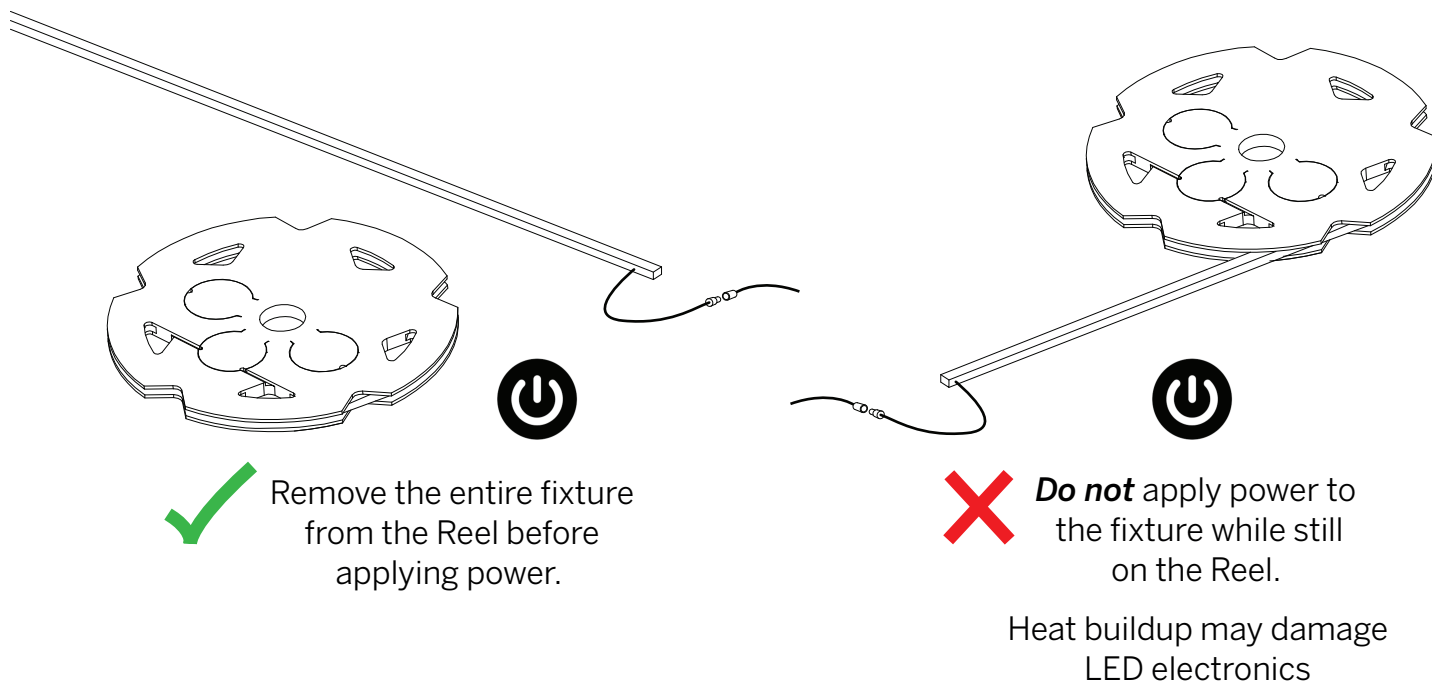
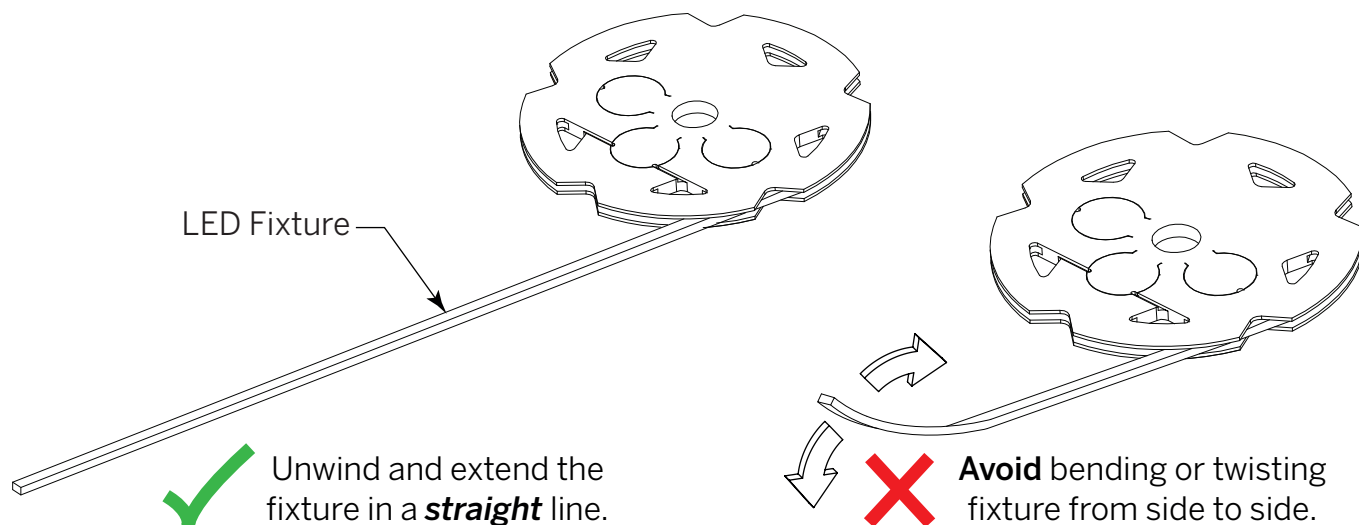

Need
Help?

Installation Instructions

3/9

Step 2 - *Recommended Practices in Handling Fixture* (continued)

Minimum Bending
Radius: 9.8" (250mm)

Bending fixture with a
tighter diameter
will result in breakage

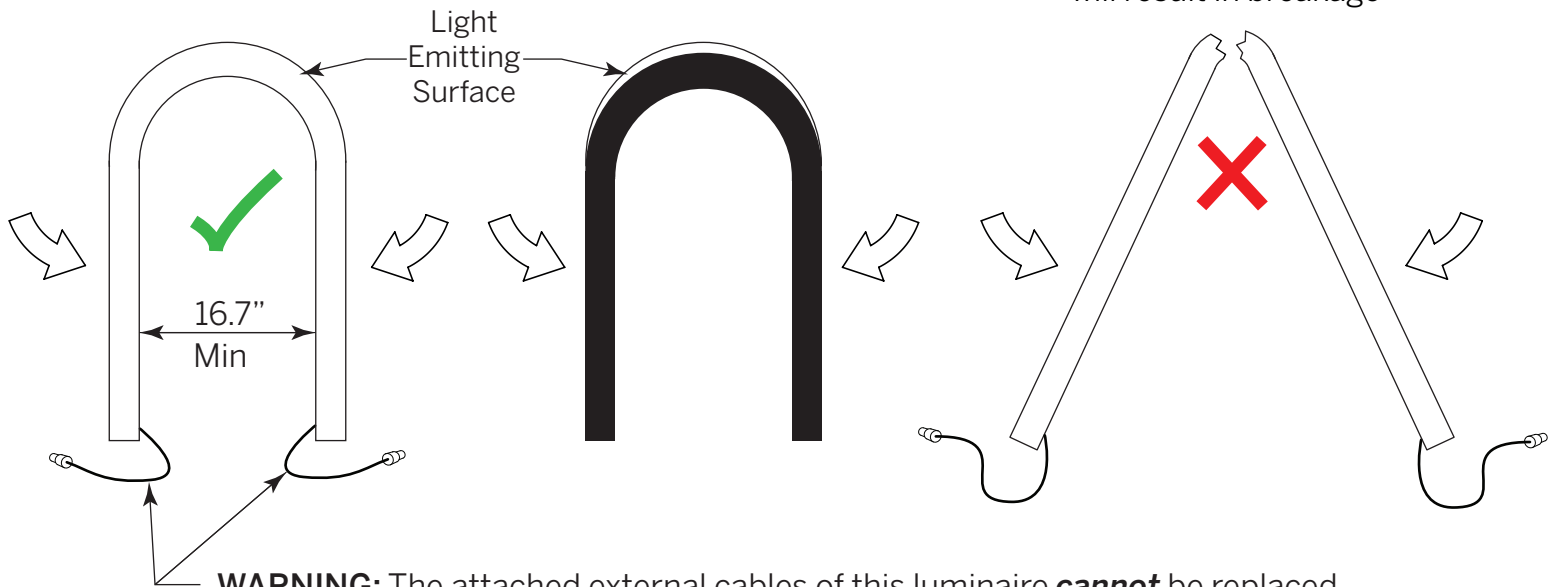

WARNING: The attached external cables of this luminaire **cannot** be replaced. If the cord is damaged, the entire luminaire must be replaced. Similarly, the internal LED strip is not replaceable. At the end of the product's life, the whole luminaire must be replaced.

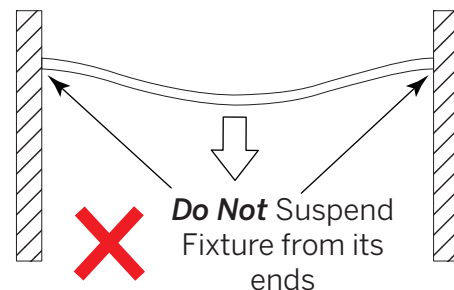
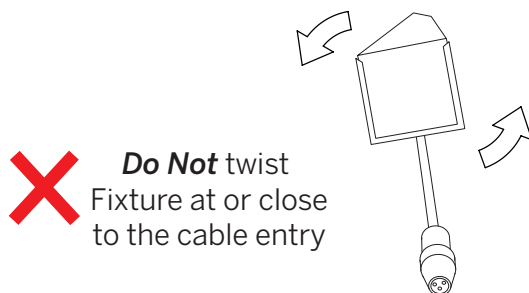

Need
Help?

Installation Instructions

4/9

Step 2 - *Recommended Practices in Handling Fixture* (continued)

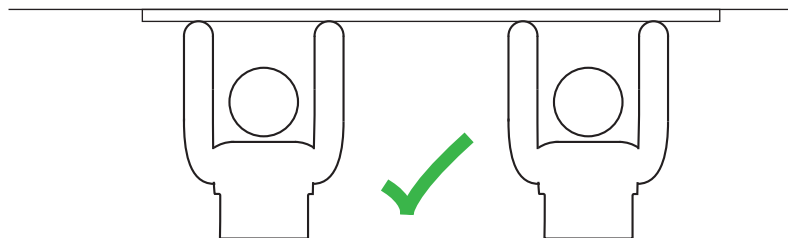

(2) people required to install

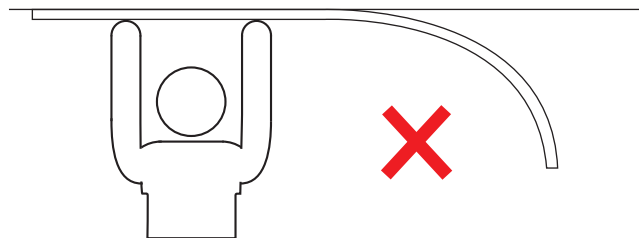

Do Not install by yourself

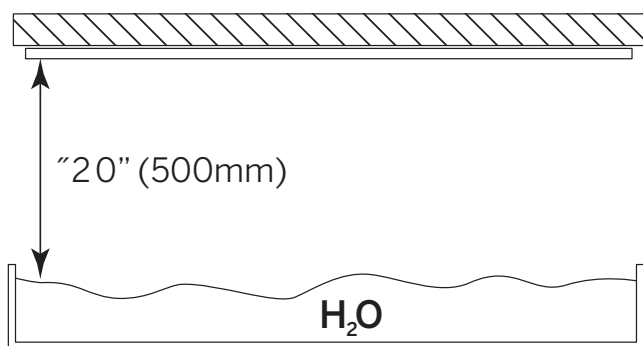

When installing fixture near water, allow for a minimum of 20" (500mm) above water level.

Fixtures are not rated for continuous submersion.

Need
Help?

Installation Instructions

Step 3 - *How to Measure & Cut Fixture*

WARNING! Read cutting instructions carefully *before* cutting fixture. If directions are not followed, an unlit section may result!

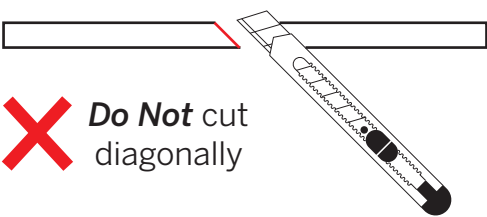
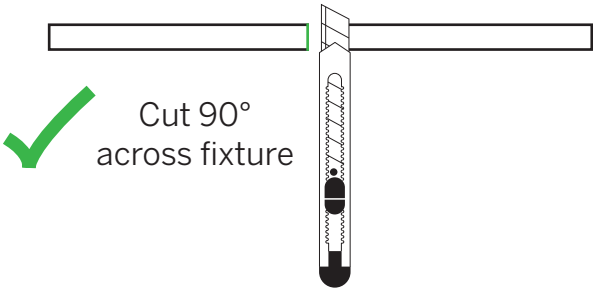
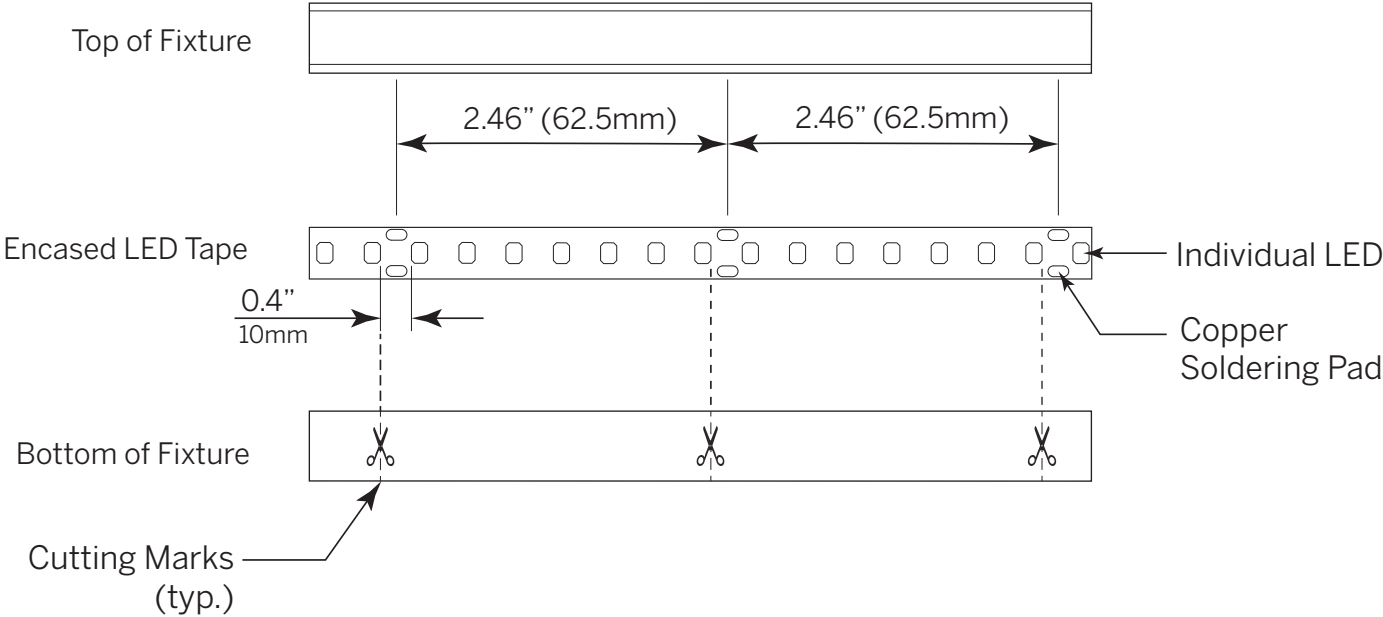

Cutting

Cut **exactly** on these marks to ensure a fully lit section. If not, unpowered LEDs may result.

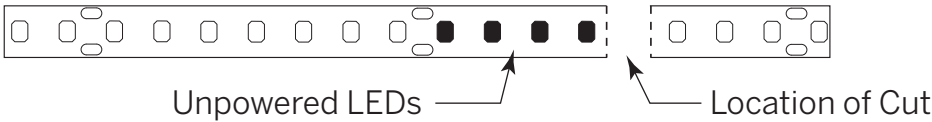

NOTE: Illustration not representative of actual LED count.

Installation Instructions

6/9

Step 4 - *Terminating a Cut Luminaire*

Ends of cut fixtures must be terminated with an End Cap, ordered as part of the 9539 End Cap Kit.

99539 End Cap Kit includes (2) Caps and (1) Tube of Silicone.

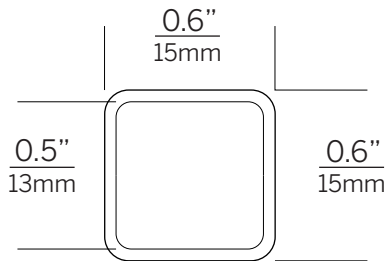

- a** Apply silicone at end of End Cap before sealing cut Fixture. Avoid squeeze-out as too much silicone can cover the LED tape's diodes.

- b** Mount End Cap

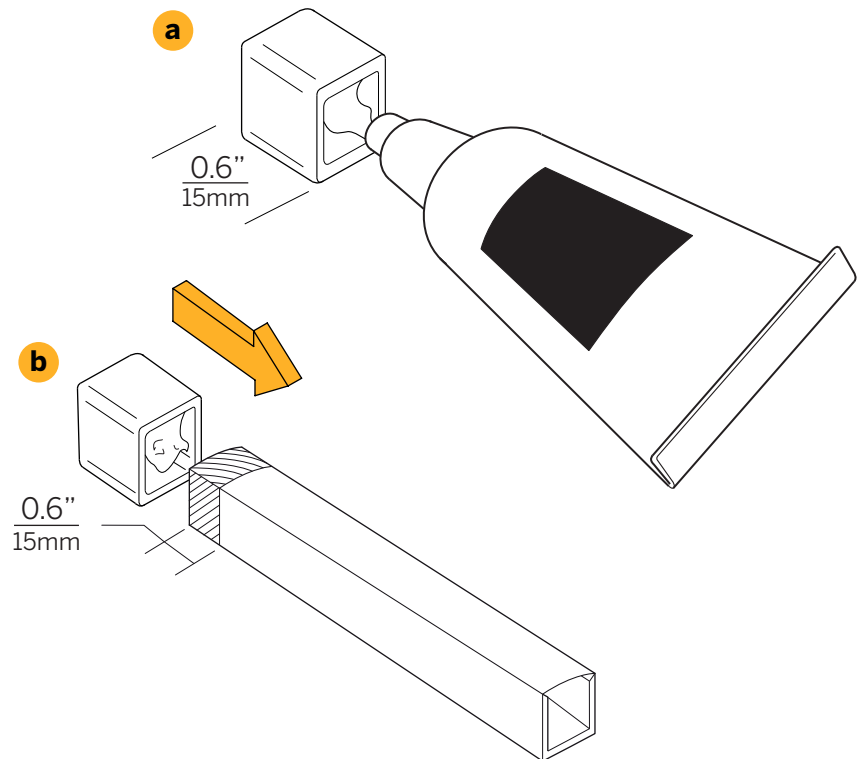

NOTE: If using a Channel to house the fixture, Channel needs to be cut 0.6" (15mm) shorter, as the End Cap does not fit within its confines. See illustration below.

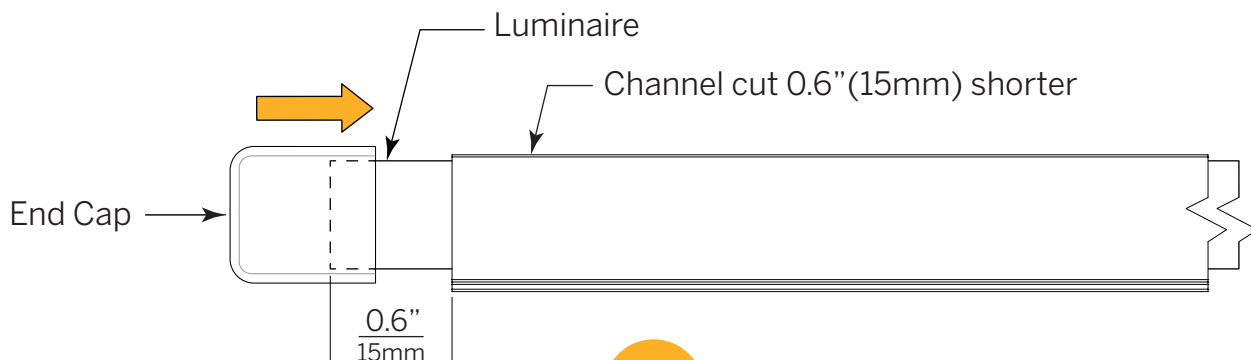

Need Help?

Installation Instructions

7/9

Step 4 - **Wiring - Static White**

Stand Alone Unit

24VDC Constant Voltage, 1.5W/ft
24VDC Constant Voltage, 2.9W/ft

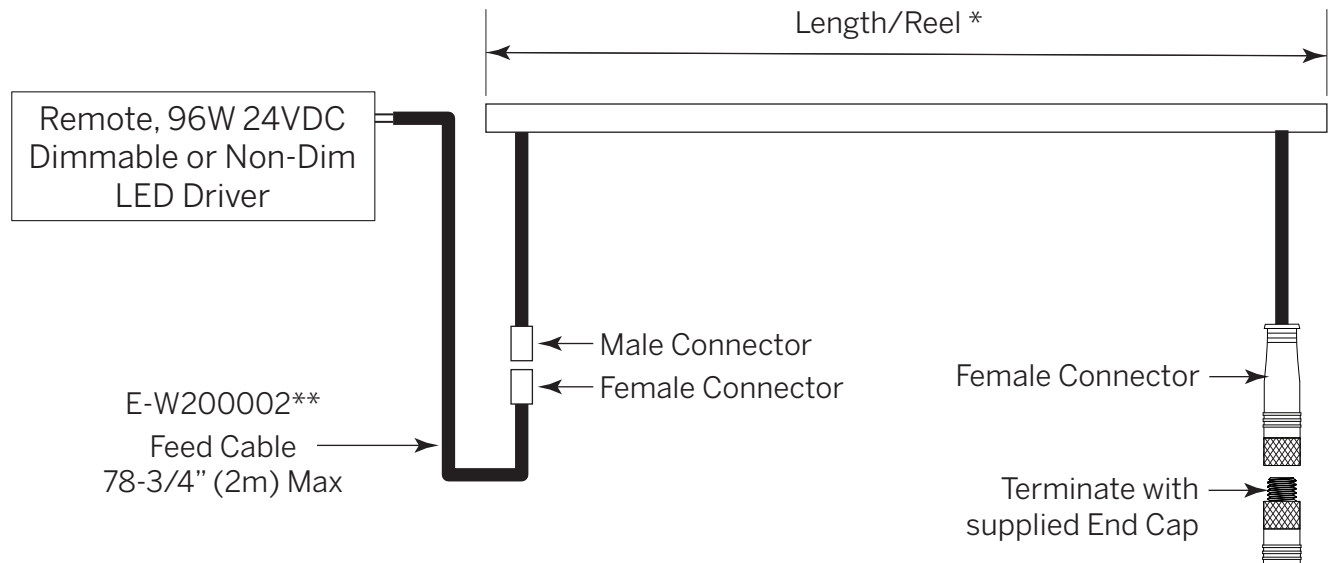

*Lengths:

3'3" Reel (39.5"/1m) @1.5W/ft = 5W; @2.9W/ft = 9.6W
16'5" Reel (197"/5m) @1.5W/ft = 25W; @2.9W/ft = 48W
26'3" Reel (315"/8m) @2.9W/ft only = 76.8W
32'10" Reel (394"/10m) @1.5W/ft only = 50W

Multi Unit Run - Single Run, Single Driver

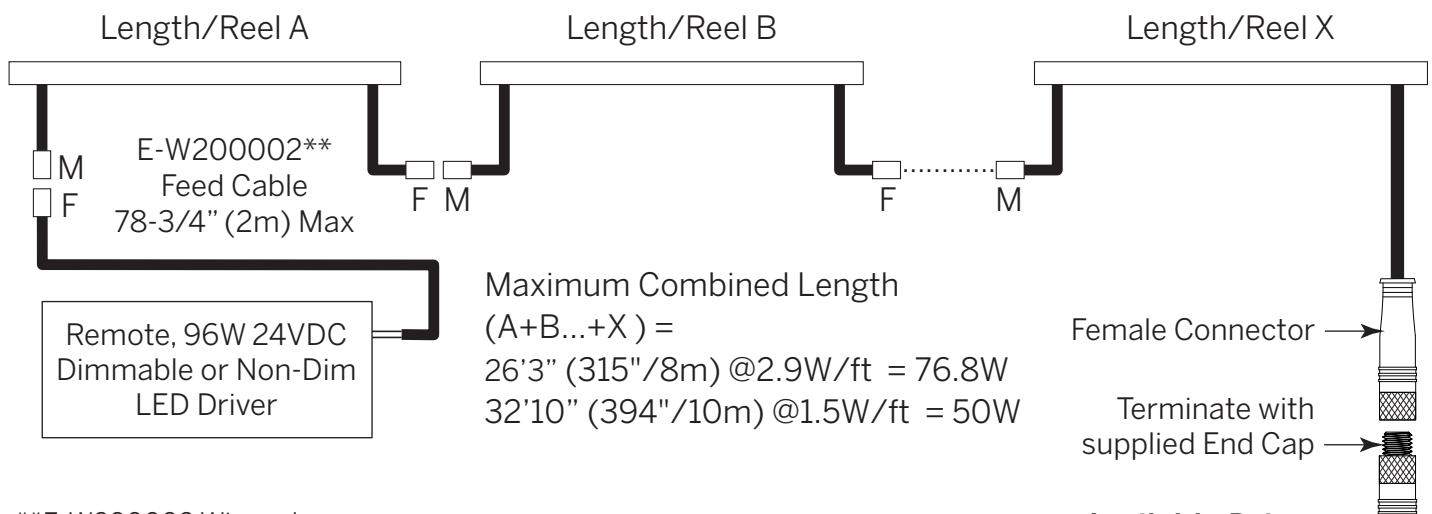

Maximum Combined Length
(A+B...+X) =
26'3" (315"/8m) @2.9W/ft = 76.8W
32'10" (394"/10m) @1.5W/ft = 50W

**E-W200002 Wire colors:
Clear wire (-)
White wire (+)

Need
Help?

Available Drivers

- OT96-D010
- DI96-24V-JBX-DPH-D010
- LUT96-L3D0

Installation Instructions

8/9

Step 4 - **Static White** (continued)

Multi Unit Run - Dual Run, Single Driver

24VDC Constant Voltage, 1.5W/ft
24VDC Constant Voltage, 2.9W/ft

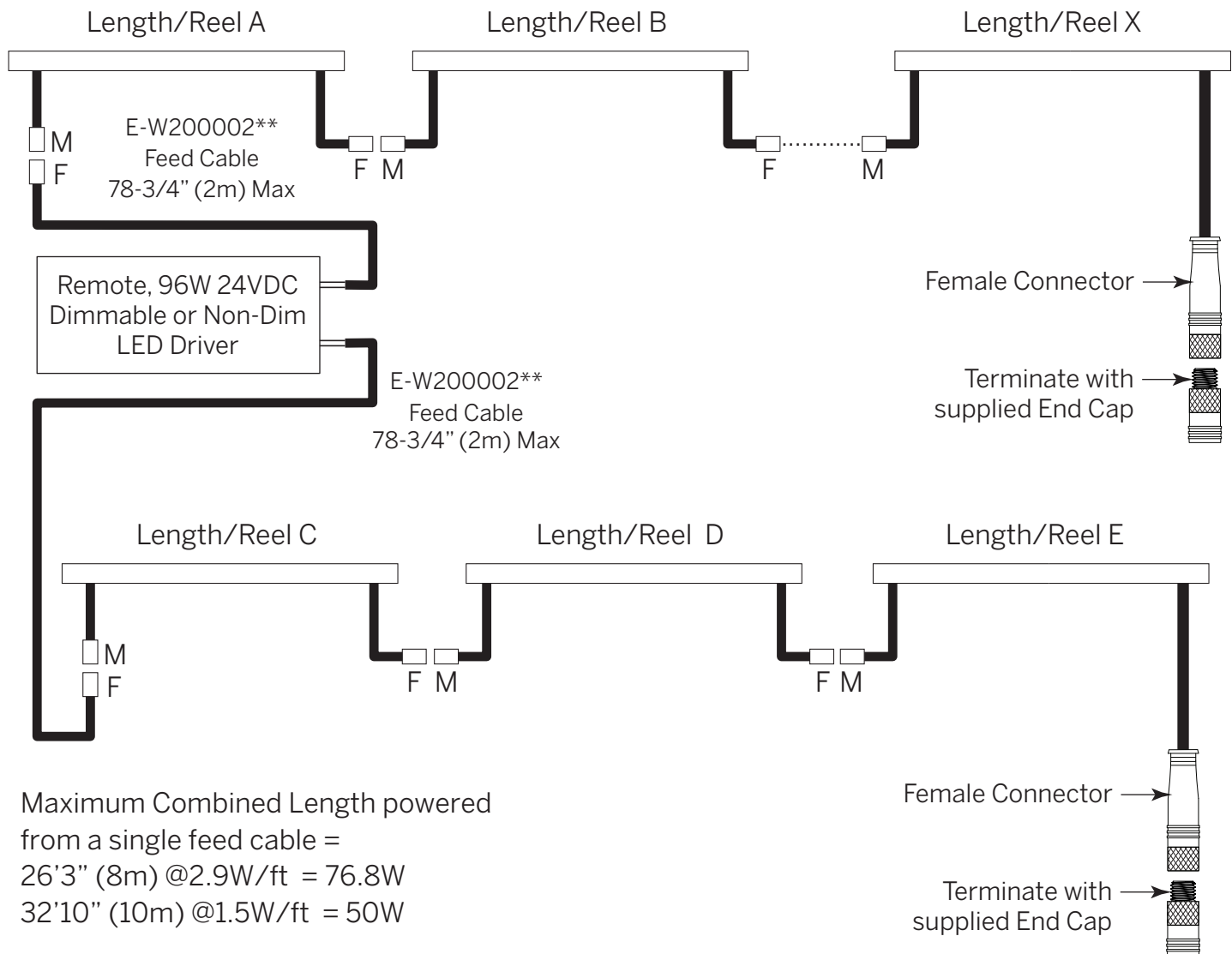

Maximum Combined Length powered from a single feed cable =
26'3" (8m) @2.9W/ft = 76.8W
32'10" (10m) @1.5W/ft = 50W

Maximum Combined Length (A+B+C+D +E...+X) using two or more feed cables =
26'3" (8m) @2.9W/ft = 76.8W
49'2" (15m) @1.5W/ft = 75W

**E-W200002 Wire colors:
Clear wire (-)
White wire (+)

Need Help?

Available Drivers

- OT96-D010
- DI96-24V-JBX-DPH-D010
- LUT96-L3D0

Installation Instructions

9/9

Step 4 - **Wiring - RGBW**

24VDC Constant Voltage, 4.6W/ft

Stand Alone Unit

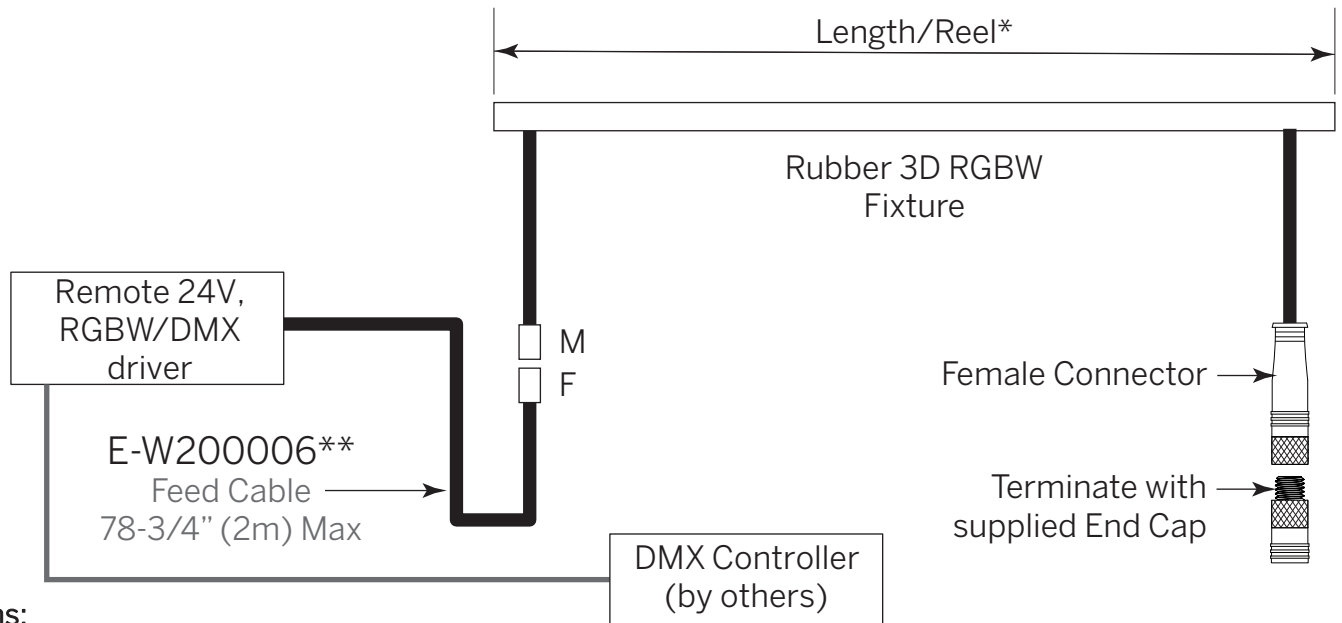

*Lengths:

3'3" Reel (39.5"/1m) @4.6W/ft = 15W

16'5" Reel (197"/5m) @4.6/ft = 75W

Multi Unit Run

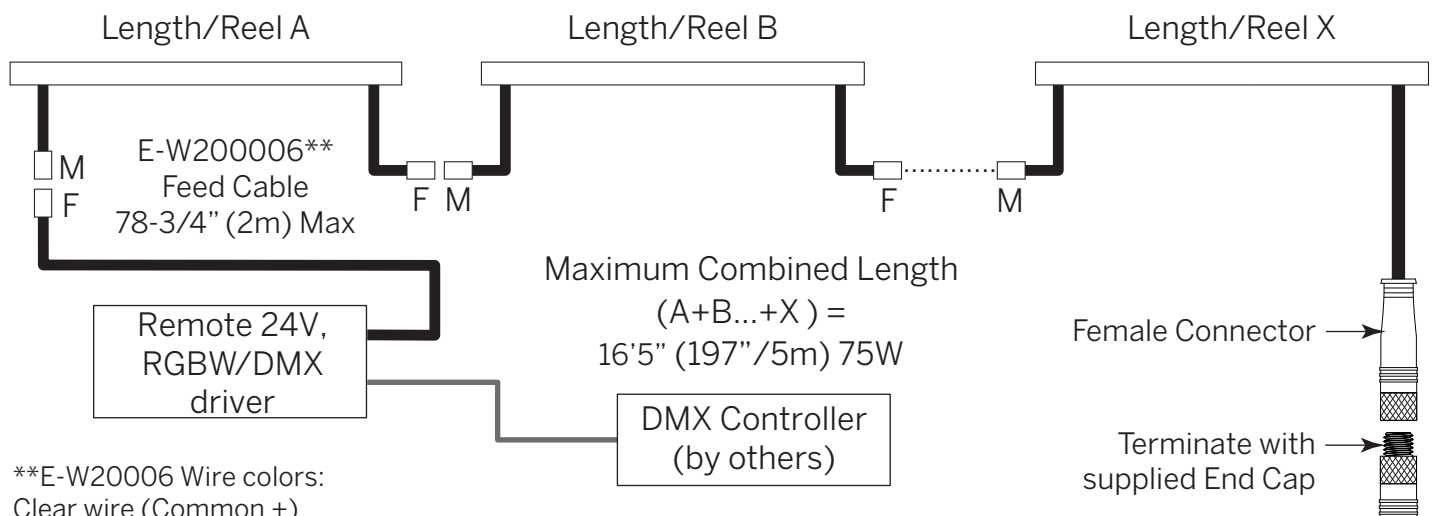

**E-W20006 Wire colors:

Clear wire (Common +)

Red wire (Red -)

Green wire (Green -)

Blue wire (Blue -)

White wire (White -)

Need
Help?

Available Driver

•EL96-DMX

Accessory Selection Guide

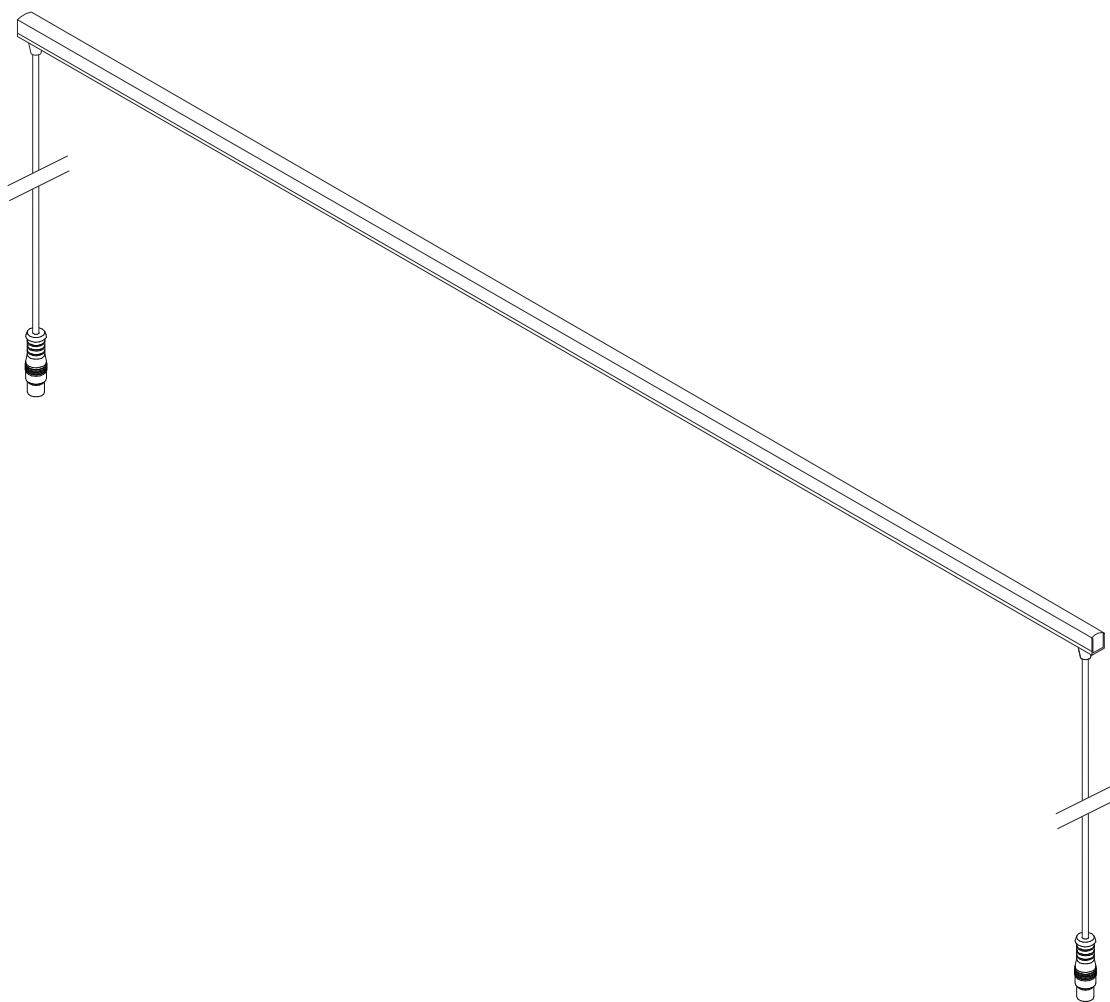

Need
Help?

Linear Profiles

Used to mount Luminaire in straight runs. Screws and anchors supplied for Aluminum Clips. PVC Clips require mounting hardware (by others).

Aluminum

- 99549 - 39-3/8"(1m)
Clear Anodized Finish
- C-K100007 - 39-3/8"(1m)
Black Anodized Finish
- (5) Mounting Screws
included per profile

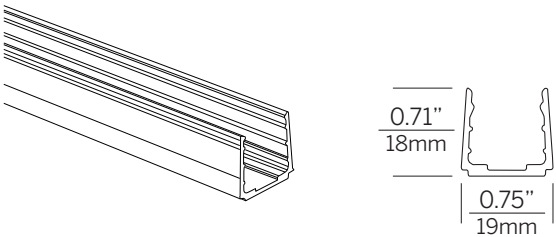

NOTE: Contractor must construct way to hide cable and connectors.

Aluminum with Connector Cavity¹

- 83034 - 39-3/8"(1m)
Clear Anodized Finish
- C-K100009 - 39-3/8"(1m)
Black Anodized Finish
- (5) Mounting Screws
included per profile

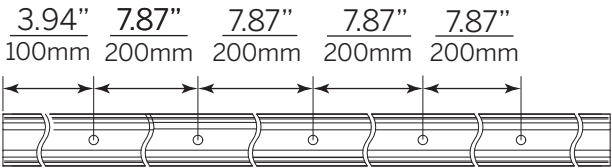
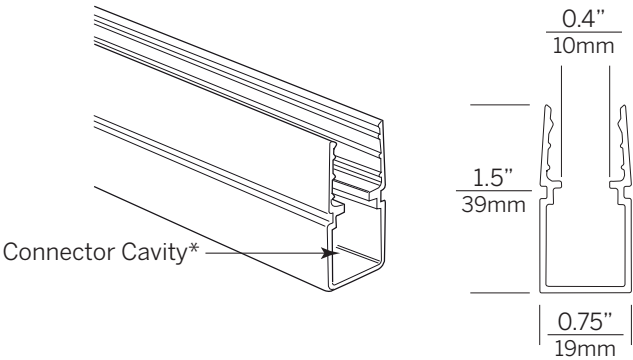

Screw Hole Spacing for both Aluminum Channels

PVC²

- C-K100002 - White, 39-3/8"(1m)

PVC with Connector Cavity²

- C-K100005 - White, 39-3/8"(1m)

Dimensions same as above.

NOTE: Contractor must construct way to hide cable and connectors.

Dimensions same as above.

¹ Connector Cavity can accomodate only **one** connector pair and **no** other additional connectors or cables.

² PVC Channels are not predrilled; screws and anchors supplied by others.



Mounting Luminaire and Linear profiles to Surface

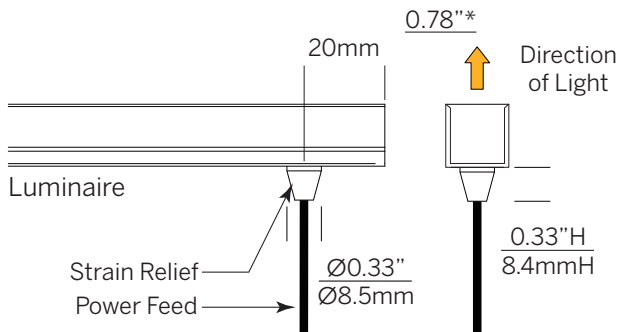

For 99549, C-K100007, C-K100002 Linear Profiles

- Fasten Channel to Surface with supplied screws and anchors (Aluminum only). PVC requires screws and anchors by others.
- Extend Strain Relief and Power Feed slightly beyond Channel.
- Insert Luminaire into Channel.

*Feed Cable distance from end of Reel has a $\pm .04$ " (1mm) tolerance

For 83034, C-K100009, C-K100007 Linear Profiles **with** Connector Cavity¹

- Fasten Channel to Surface with supplied screws and anchors (Aluminum only). PVC requires screws and anchors by others.
- Position end of Luminaire flush with end of Channel
- Insert Luminaire into Channel. Slot allows Luminaire to fully seat within Channel.

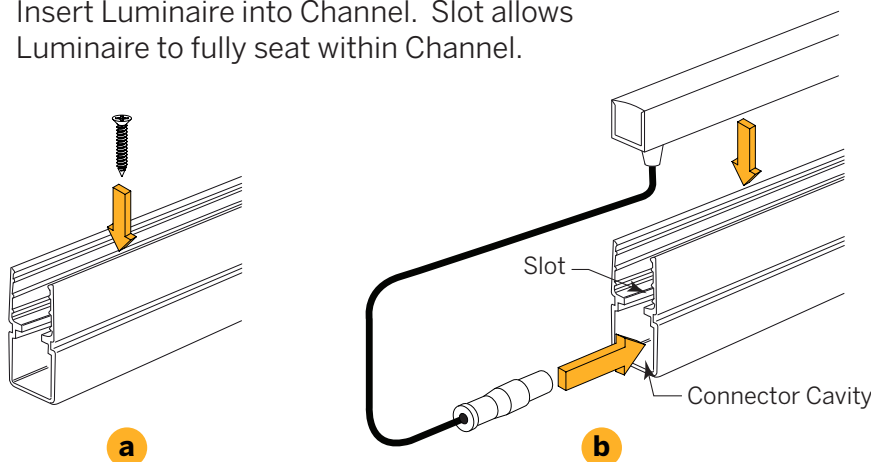
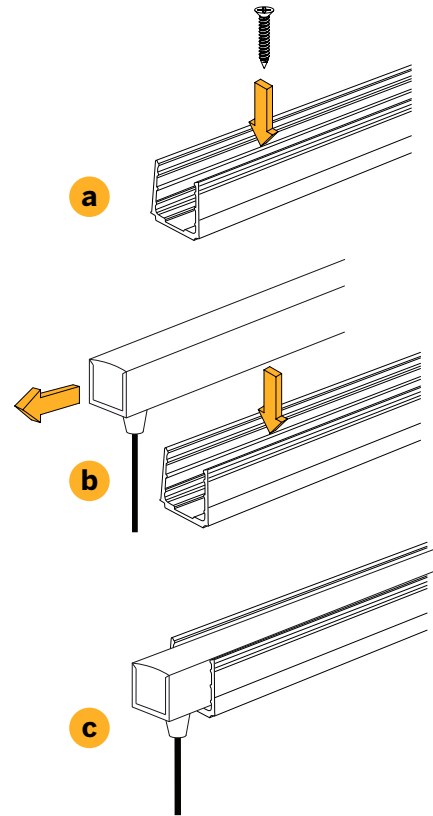

Need Help?

¹Connector Cavity can accommodate only **one** connector pair and **no** other additional connectors or cables.

Removing Luminaire from Linear Profile

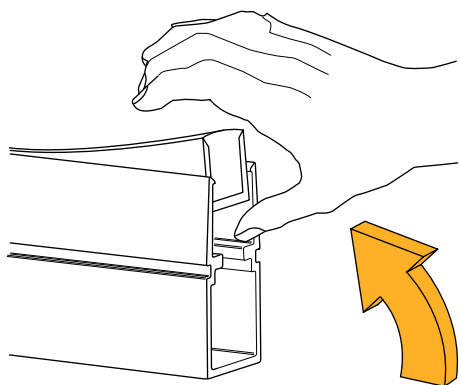

- a** Lift end of Luminaire slightly.

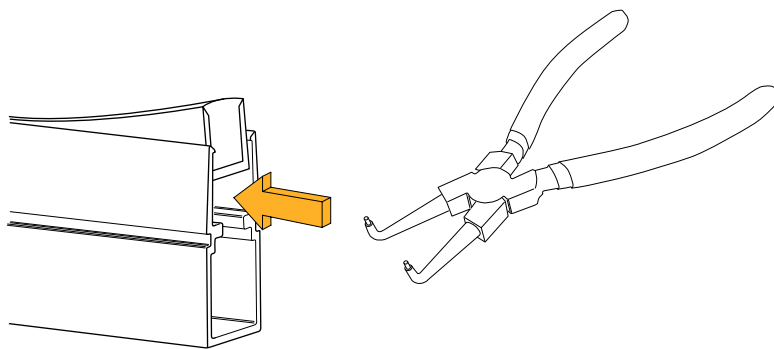

- b** Insert bent nose pliers into Channel underneath Luminaire.

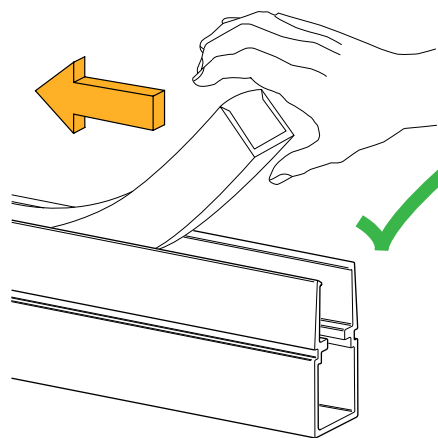
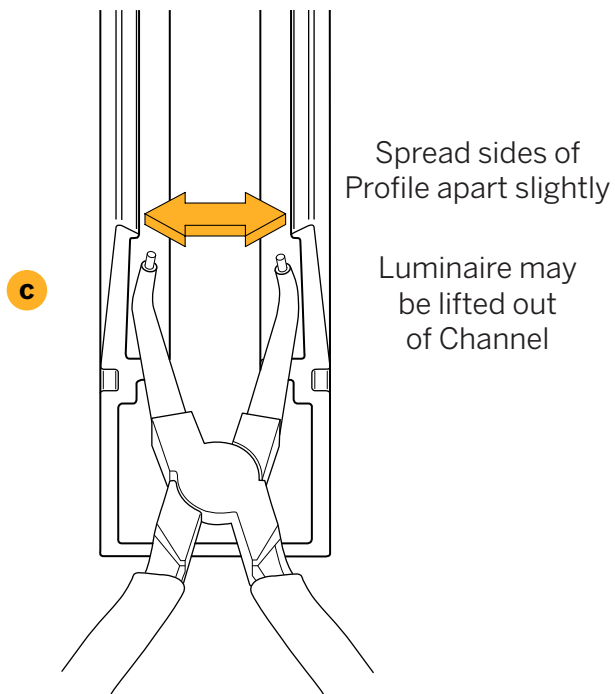

- d** Continue to lift Luminaire out along length of Channel.

Need
Help?

Clips

Used to mount Luminaire in curved runs. They may also be used in straight runs, just like the linear profiles. Recommended spacing is 4" on center. Screws and anchors supplied for Aluminum Clips. PVC Clips require mounting hardware (by others).

Aluminum

 C-F400001 - 2" (50mm)
Clear Anodized Finish

 C-F400002 - 2" (50mm)
Black Anodized Finish



(1) Mounting Screws
included per profile

Aluminum with Connector Cavity¹

 C-F400003 - 2" (50mm)
Clear Anodized Finish

 C-F400004 - 2" (50mm)
Black Anodized Finish



(1) Mounting Screws
included per profile

PVC²

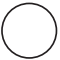
 C-K100003 - White, 2" (50mm)

PVC² with Connector Cavity¹

 C-K100006 - White, 2" (50mm)

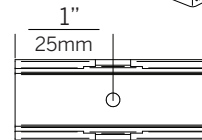
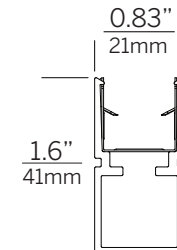
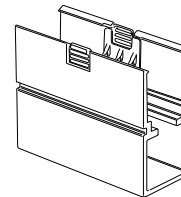
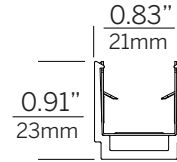
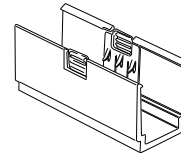

Top View of
Aluminum Clips

Suggested Spacing:
4" (100mm) on center.

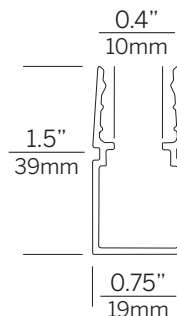
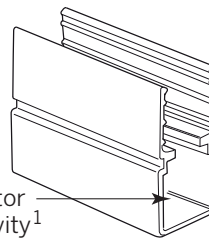
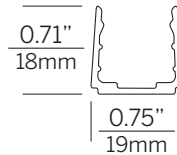
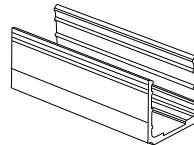

Connector
Cavity¹

¹ Connector Cavity can accommodate only **one** connector pair and **no** other additional connectors or cables.

² PVC Channels are not predrilled; screws and anchors supplied by others. Alternatively, they may be installed using double stick tape (by others).

Need
Help?

Clips (continued)

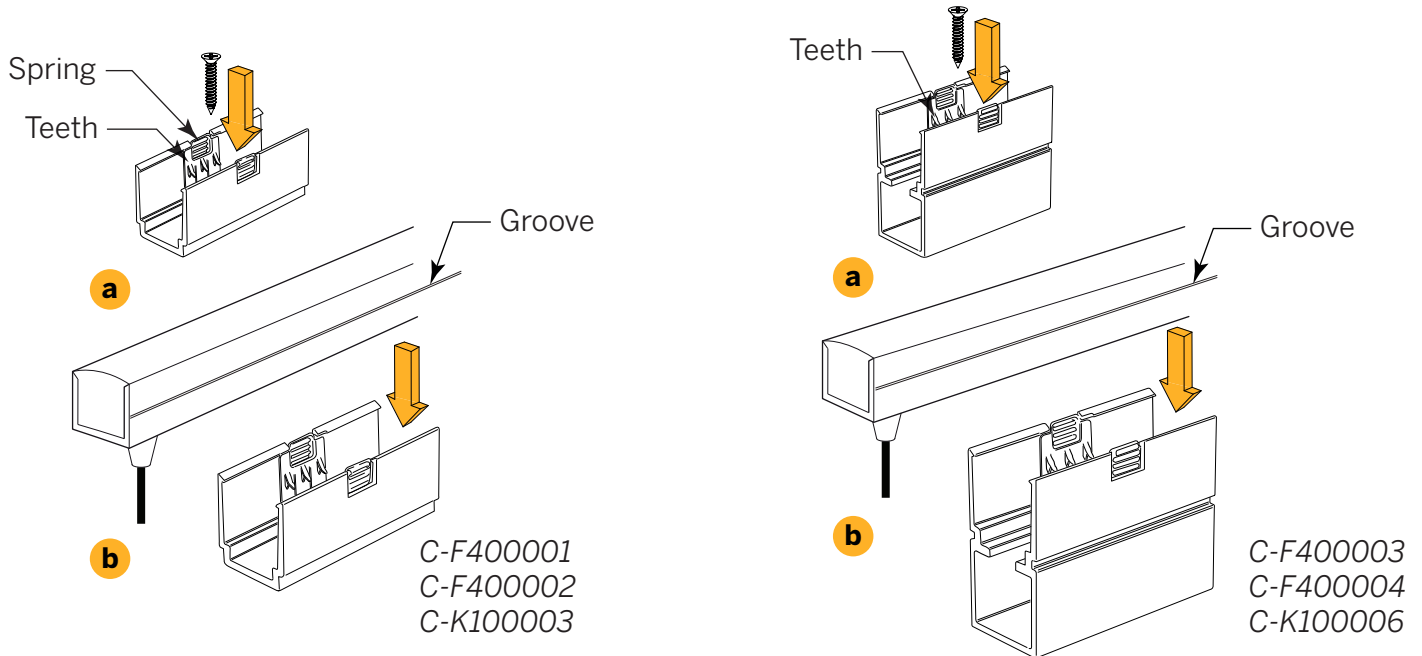

Teeth on Spring engage Luminaire Groove and lock it into place.

Removing Luminaire from Clips

Luminaire may also be removed from clips, and repositioned, as shown below:

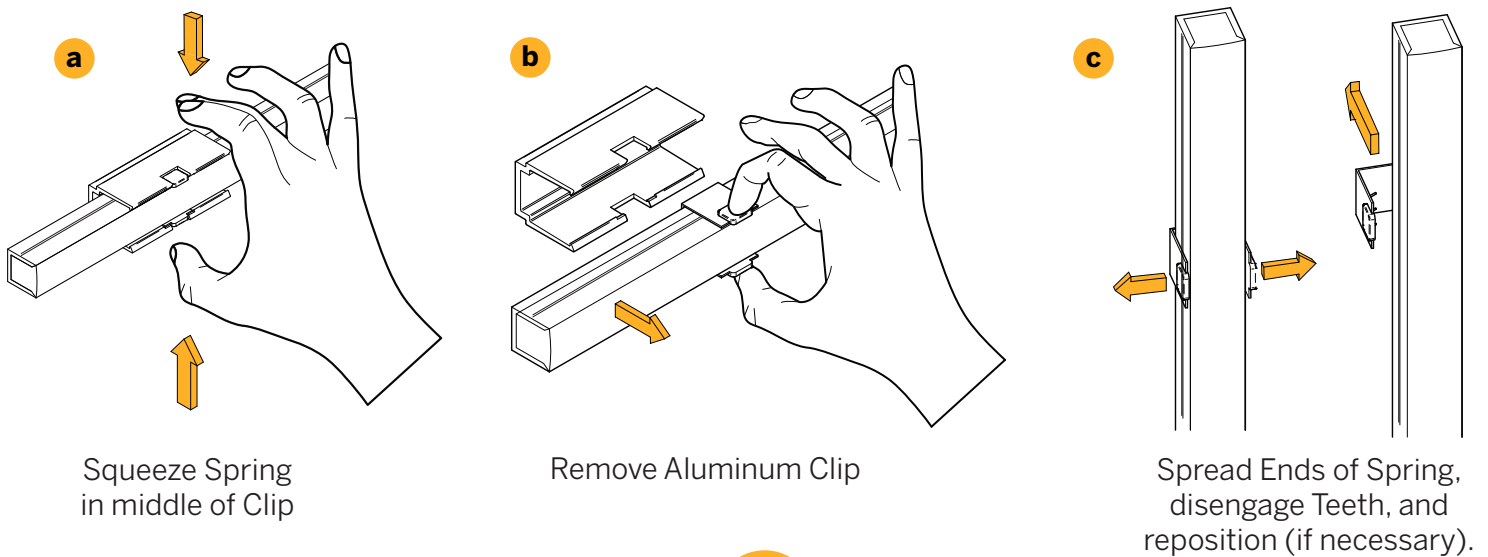

Need
Help?

Flexible Channels

- C-K100011 Stainless Steel Flexible Channel
39.7" (Nominal 1m) L x 5/8" (16mm) W x 1/2" (13mm) H

Used to directly mount Luminaire in a curved run, in place of Channels or Clips. Requires mounting screws and anchors (by others).

NOTE: Contractor must construct way to hide cable and connectors.

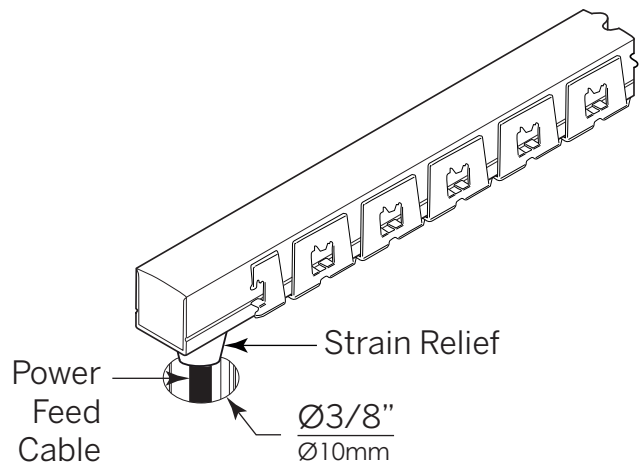
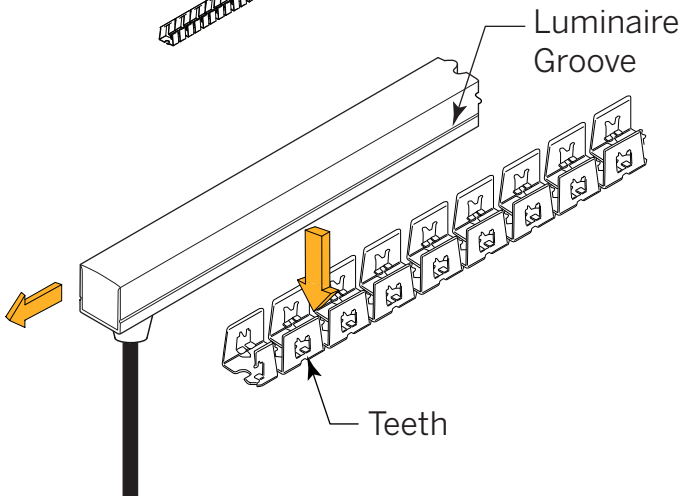
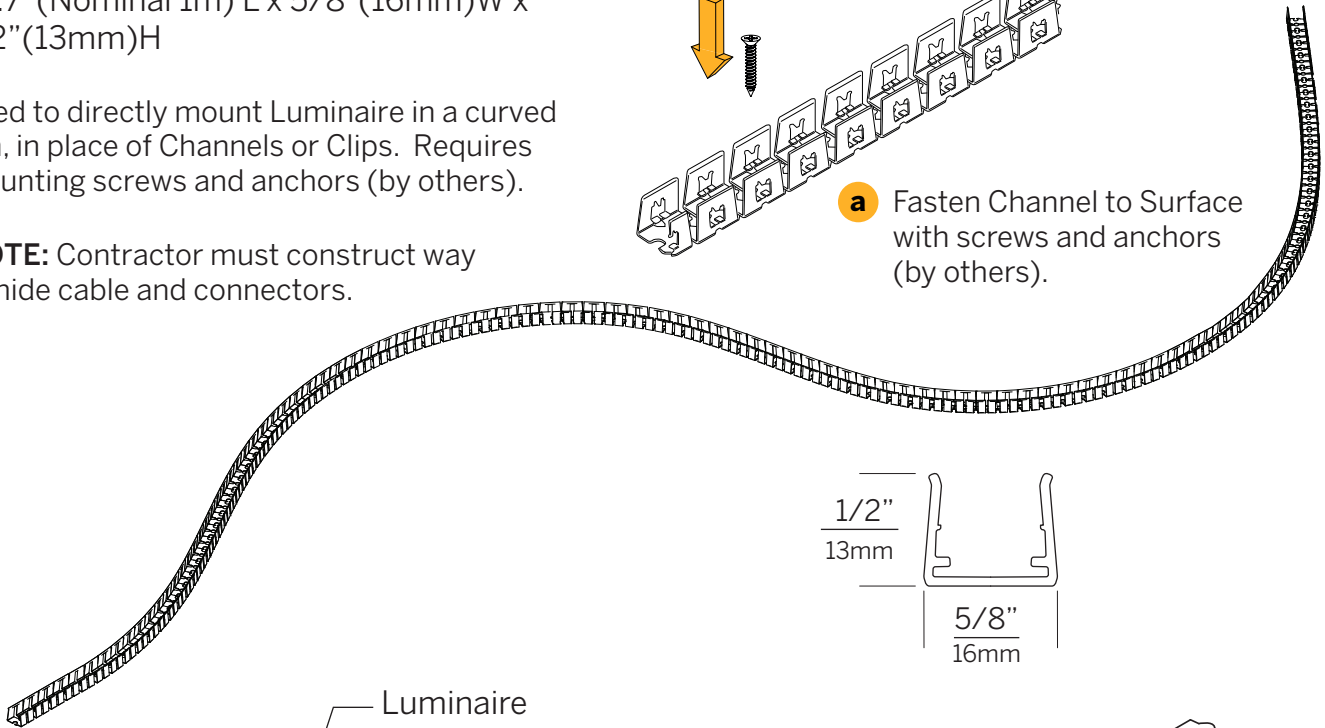
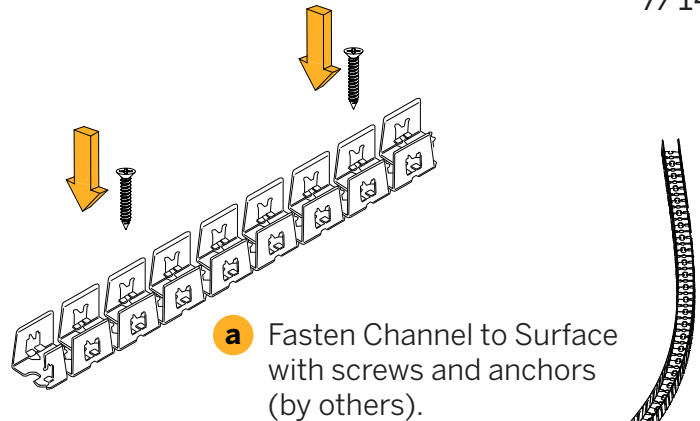

- b** Extend Strain Relief and Power Feed slightly beyond Channel.
- c** Insert Luminaire such that Teeth engage Luminaire Groove
- d** Drill a 3/8" (10mm) hole in the masonry or drywall to allow Luminaire to lie flush on surface.

Need Help?

Flexible Channels (Continued)

- C-K100032 Stainless Steel Flexible Anti-Glare Shield
80.1"(Nominal 2m)L x 4" (103mm)H

Used to mount Luminaire in a straight or curved run with the addition of an Anti-Glare Shield. Requires use of Channels or Clips. Mounting screws and anchors supplied with Aluminum Channels or Clips (ordered separately). PVC channels or clips require mounting hardware (by others).

NOTE: Contractor must construct way to hide cable and connectors.

Channel

Insert Screws through Aluminum Channel Mounting Holes then again through Flexible Channel to surface

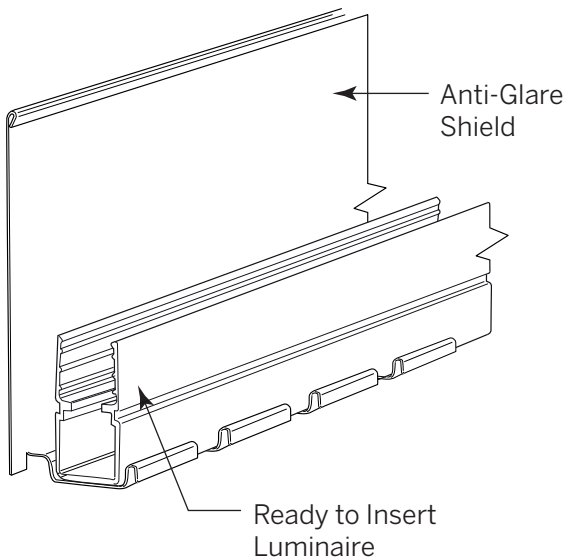
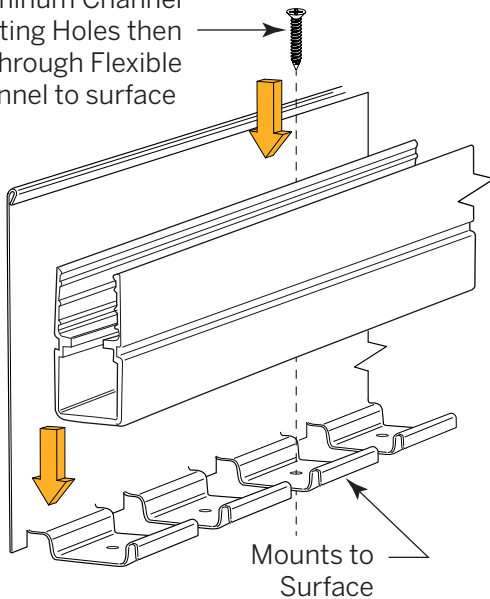

Clips

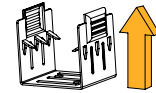

Spring

- a** Remove Spring from Clips as shown on **Page 8** to access Mounting Holes.

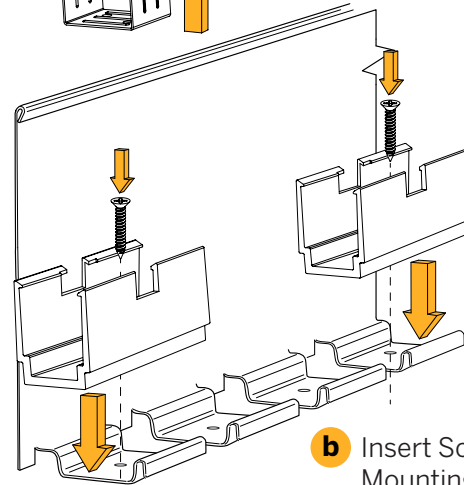

- b** Insert Screws through Clip Mounting Holes and then through Flexible Channel to surface.

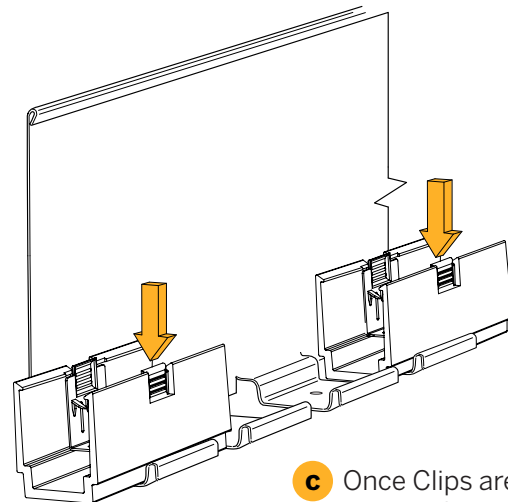

- c** Once Clips are mounted, replace Springs and insert Luminaire.

Need Help?

Rubber 3D

LL-RUB-3D

inter•lux

9/14

83351 Spike with Rigid Bracket

Used in conjunction with Channel or Clips, each ordered separately. Bracket Mounting Screws included.

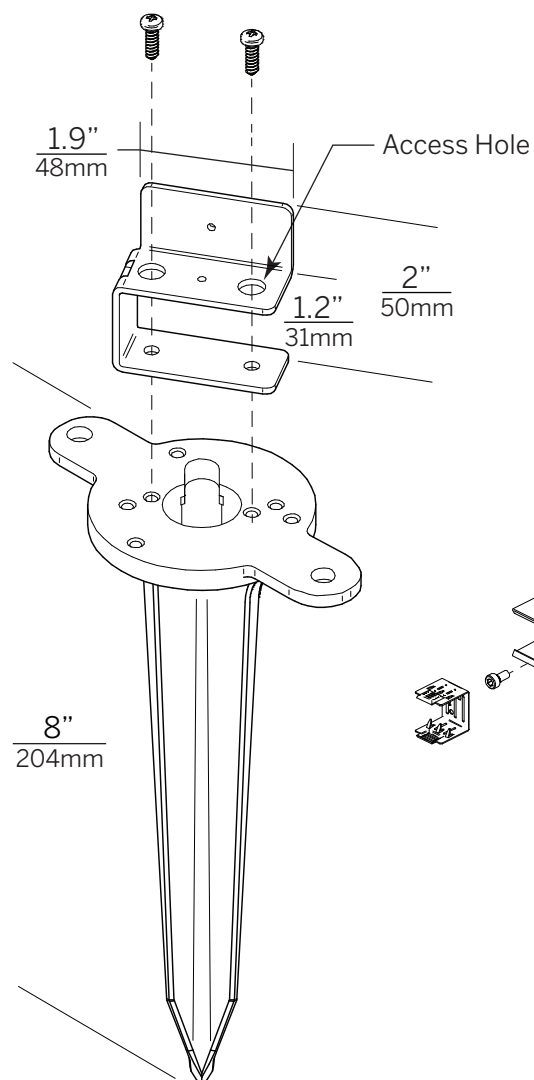

The Rigid Bracket can position the Rubber 3D in two ways: Parallel to the ground or Perpendicular the ground.

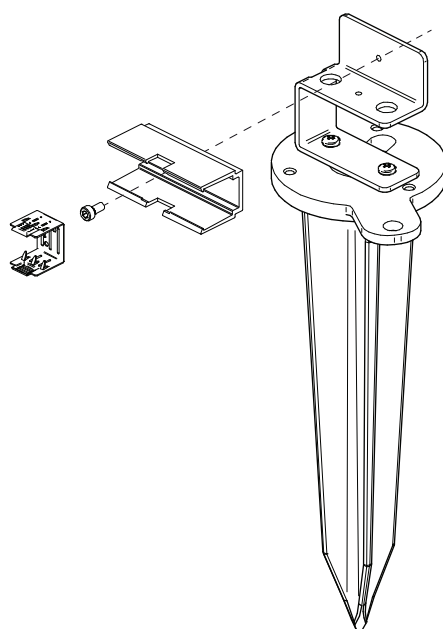
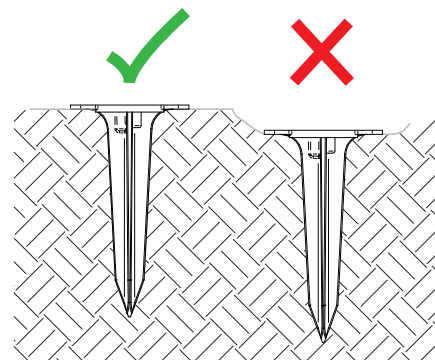

Parallel to Ground

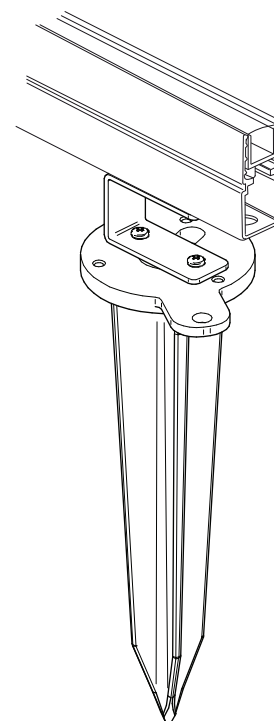

Perpendicular to Ground

Need
Help?

C-K400168 **2" Metal Tilting Bracket**
C-K400169 **4" Metal Tilting Bracket**

Used in conjunction with Channel or Clips, each ordered separately. May be mounted on vertical or horizontal surface. Bracket Mounting Screws and Anchors are provided.

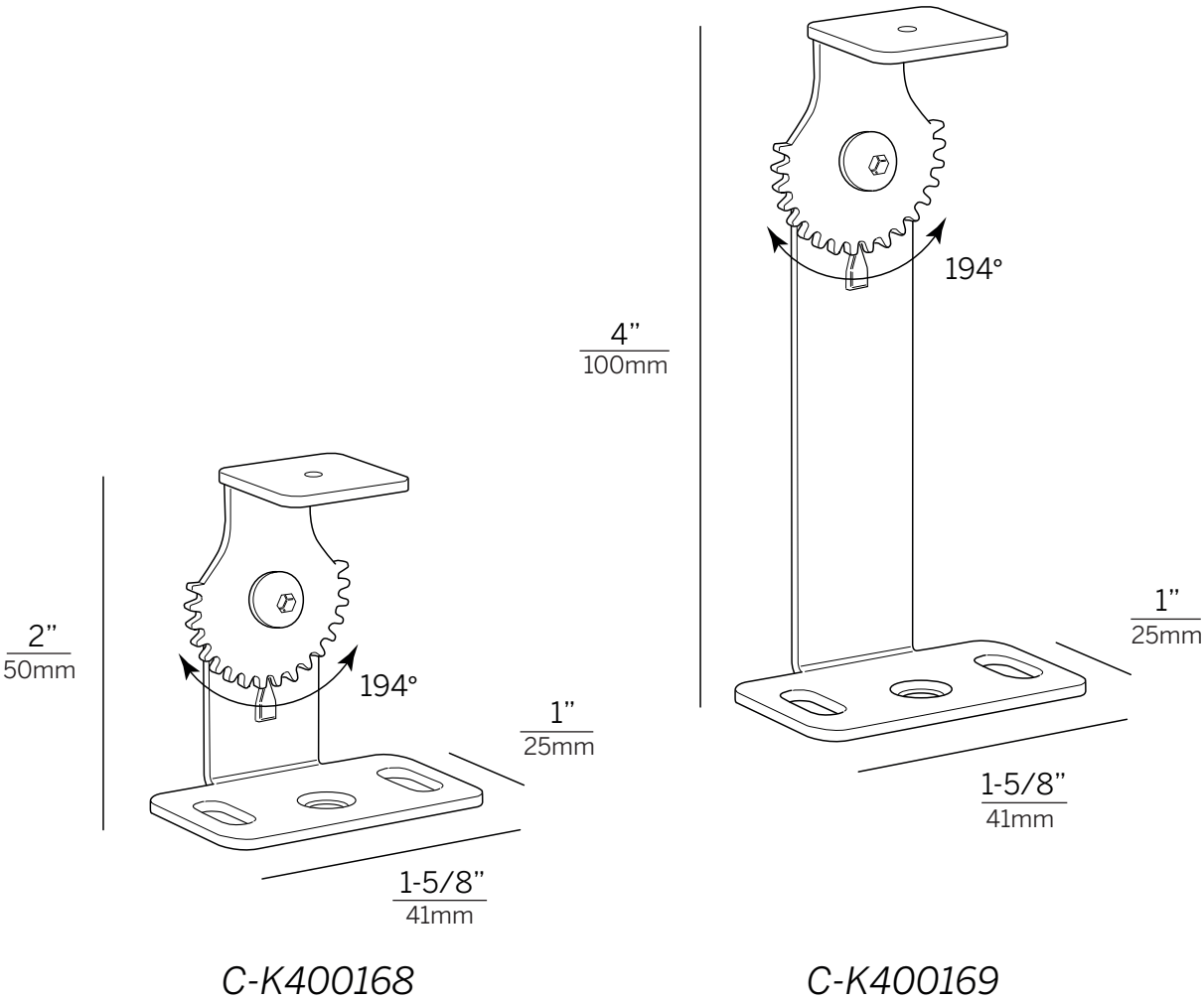

C-F500004 *Metal Tilting Bracket on Spike*
C-F500005 *Metal Tilting Bracket on Spike*

Used in conjunction with Channel or Clips, each ordered separately. Bracket Mounting Screws included.

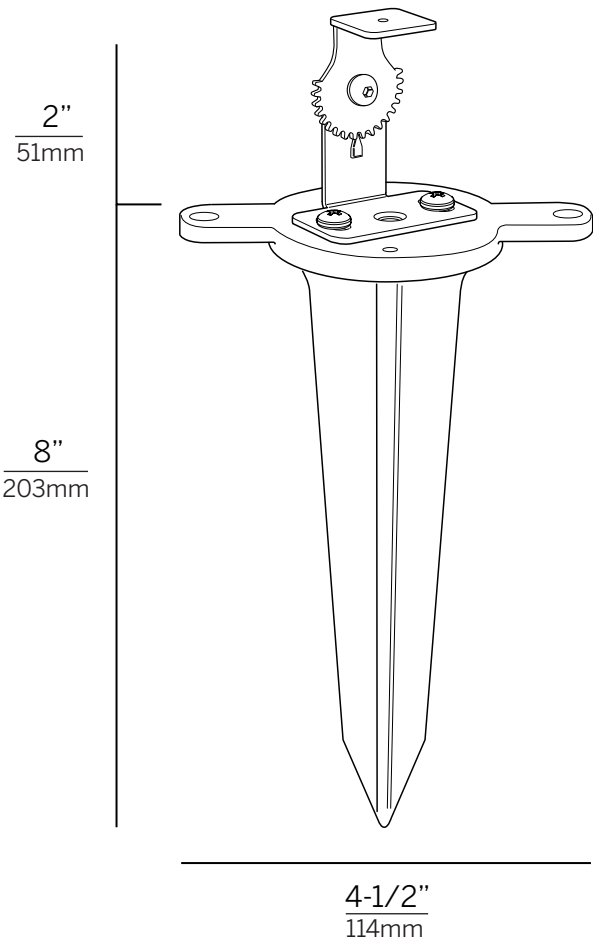
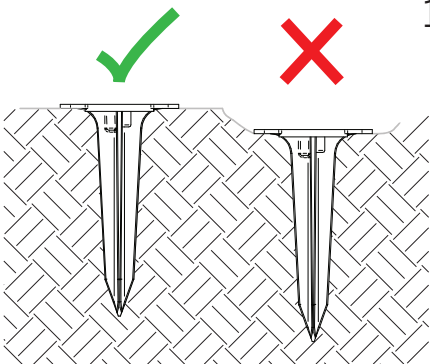

C-F500004

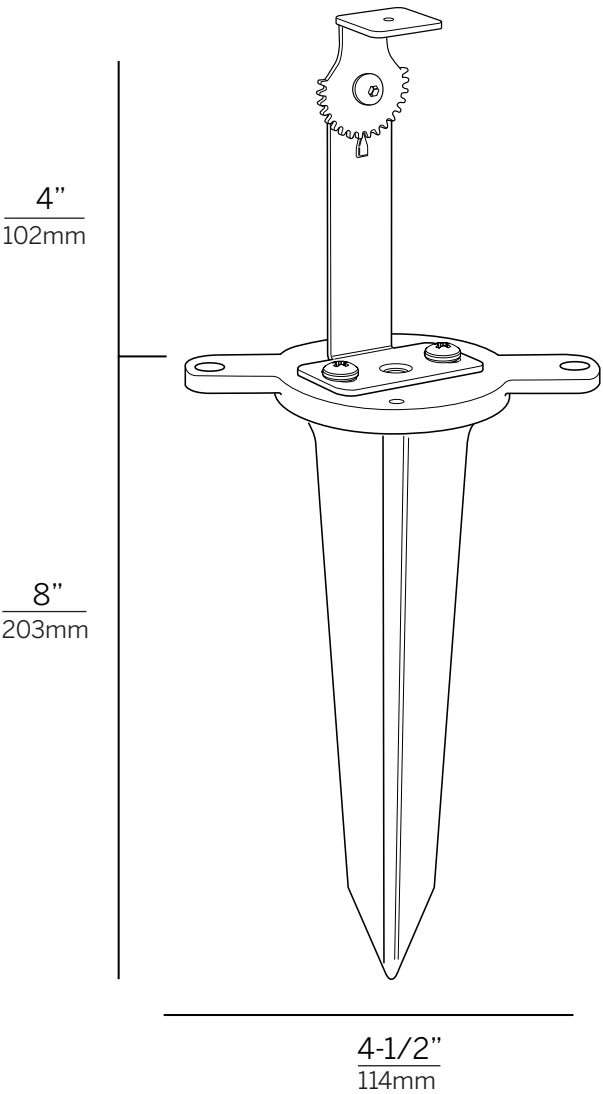

C-F500005



99539 End Cap Kit

Field cut fixtures must be terminated with an End Cap.

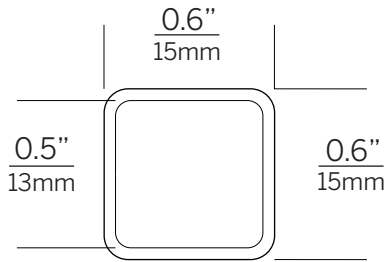

99539 End Cap Kit includes (2) Caps and (1) Tube of Silicone.

- a** Apply silicone at end of End Cap before sealing cut Fixture. Avoid squeeze-out as too much silicone can cover the LED tape's diodes.

- b** Mount End Cap

NOTE: If using a Channel to house the fixture, Channel needs to be cut 0.6" (15mm) shorter, as the End Cap does not fit within its confines. See illustration below.

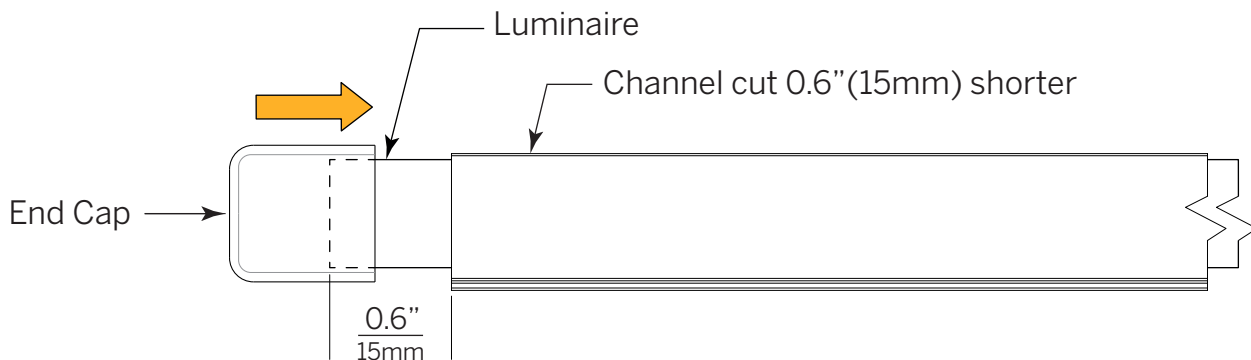
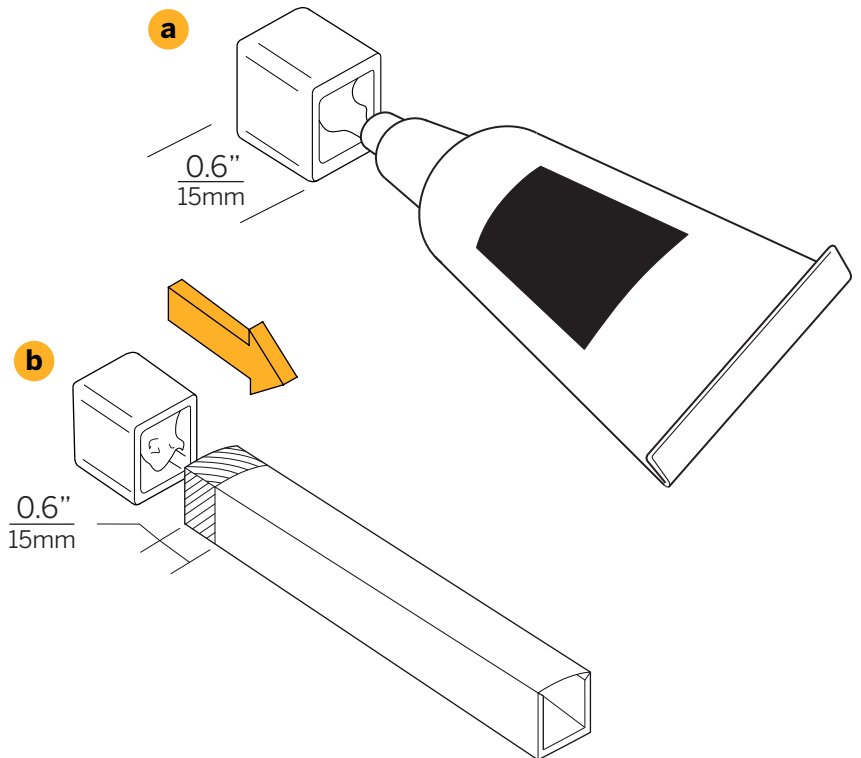

Need Help?

99521 **Polystyrene Concrete-Pour Preparation Kit for 83034/C-K100009**

1.6"H x 0.9"W x 39.8"L polystyrene strip used as template for recessed mounting of Aluminum Channel with Wireway in poured concrete. Cannot be used on curved runs. Set the template in place before pour, and remove before concrete fully sets. Note that an entry/exit path for power feed from remote driver must still be constructed before pouring concrete.

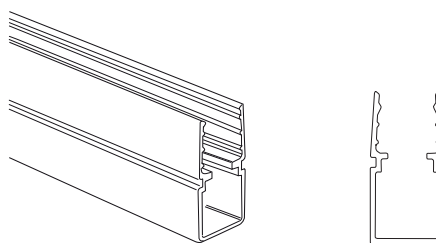
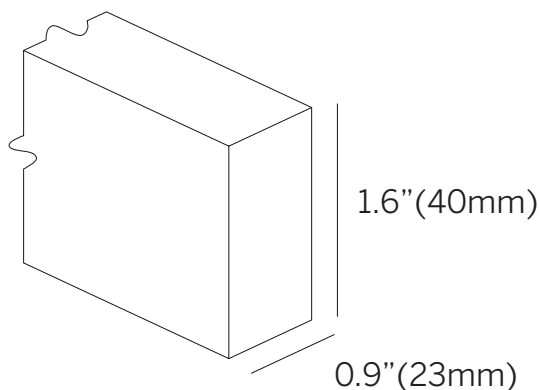

Need
Help?

Cables

2-Pole (for single CCT reels only)

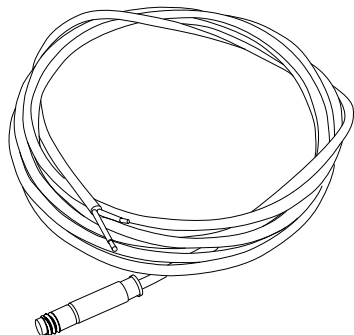

E-W200002 78.7"(2m)
Feed Cable, Female
2-Pin to Bare Leads

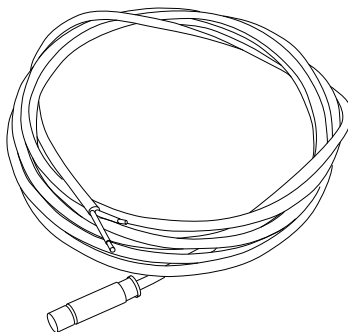

E-W200001 78.7"(2m)
Feed Cable, Male
2-Pin to Bare Leads

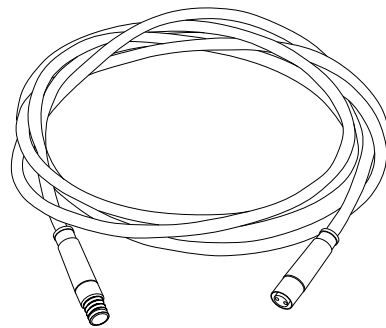

E-W200007 196.8"(5m)
Extension Cable,
Male-Female 2-Pin

5-Pole (for RGBW reels only)

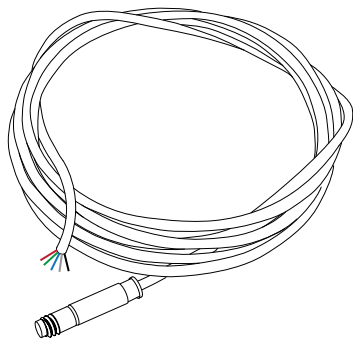

E-W200006 78.7"(2m)
Feed Cable, Female
5-Pin to Bare Leads

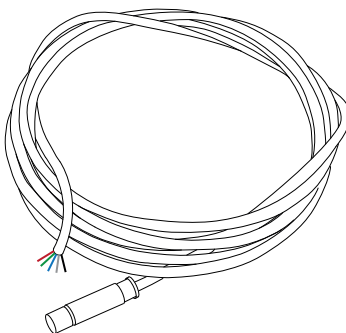

E-W200005 78.7"(2m)
Feed Cable, Male
5-Pin to Bare Leads

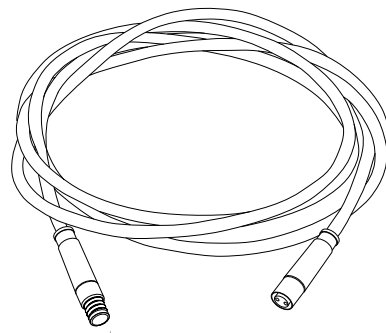

E-W200011 196.8"(5m)
Extension Cable,
Male-Female 5-Pin

Need
Help?