

Z Cove Sample Case Guide

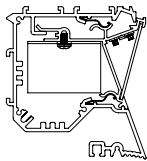
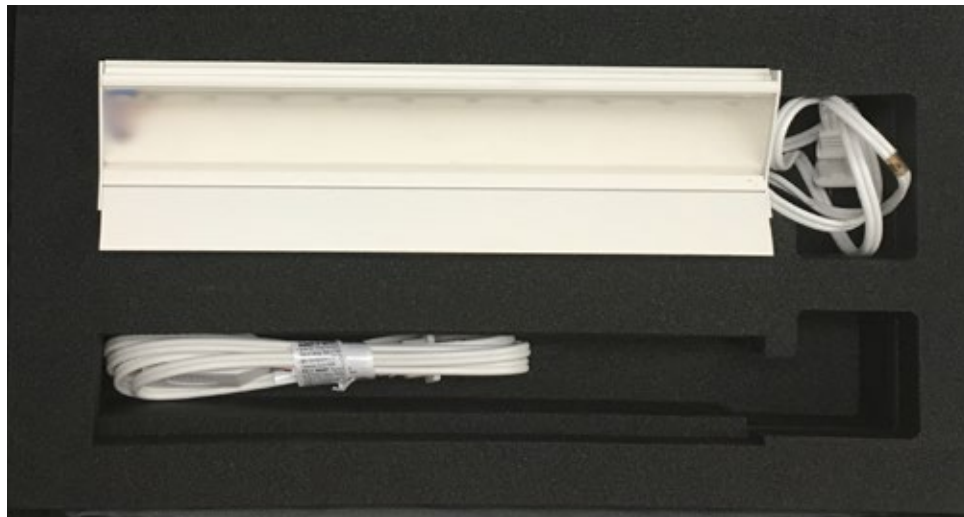

2.9"
74mm

3.5"
89mm

3.2"
81mm

Plaster Trim (RPT)

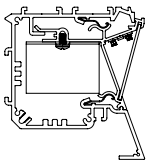

2.8"
71mm

3.5"
89mm

3.2"
81mm

Bezel Trim (RBT)

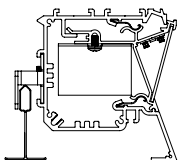

2.8"
71mm

3.5"
89mm

3.2"
81mm

4.76"
121mm

Grid Trim (RGT9/RGT15)

WG-ZC

Luminaire

- Linear perimeter slot system featuring plaster-in or bezel precision knife edge for clean, minimal effect.
- Suitable for 5/8" drywall ceiling.
- Lengths and angles factory cut to exact field dimensions.
- Mitered corners available with continuous LED illumination.
- Powder coat painted white - RAL 9010.
- Optional adjustable In-Fill panel to accommodate 4" - 6" slot.

Fixation

- RPT = Recessed Plaster Trim
- RBT = Recessed Bezel Trim
- RGT9 = Recessed Grid Trim 9/16"
- RGT15 = Recessed Grid Trim 15/16"

Pattern

- S = Straight run
- PC = Standard patterns coffer 2, 3 or 4 sided with 90° corners¹
- PR = Standard patterns raft 2, 3 or 4 sided with 90° corners¹
- PZ = Non-standard patterns and/or corners other than 90°, consult factory¹

Length

- A, B, C = specify inches to the nearest 0.25" (i.e. 72.25") For patterns specify each length (i.e. 2 sided: A x B = 72.25" x 48"; 3 sided: A x B x C; 4 sided: A x B x A x B)

Power²

- L = 3.2W/ft low power (24V)
- M = 6.4W/ft mid power (24V)
- H = 10.5W/ft high power (24V)

CCT / CRI³

90+ CRI minimum (Low/Mid/High)

- 927 = 2700K, (256/473/706 lm/ft)
- 930 = 3000K, (264/488/728 lm/ft)
- 935 = 3500K, (270/498/743 lm/ft)
- 940 = 4000K, (272/503/750 lm/ft)

In-fill

- X = No in-fill panel
- P4 = 4" - 5" adjustable in-fill panel
- P5 = 5" - 6" adjustable in-fill panel

Lens

- SD = Satin clear diffuser (standard)

Finish

- W = White, 20% gloss, RAL9010 (standard)
- B = Black, 20% gloss
- G = Gray, 20% gloss
- F = Custom finished trim, specify RAL

Options

- LEC = Left end cap
- REC = Right end cap
- LREC = Left & Right end caps

Emergency

- Contact factory for emergency lighting options

¹ See pattern spec sheet. Standard setup assumes the cove ends at a perpendicular wall and the led board is setback from the end to minimize light on the perpendicular wall. Contact us for options.

² Wattage shown does not include power supplies/drivers.

³ Delivered lumens with satin clear diffuser shown.