

# SUELO Fixed RGBW Vandal Resistant



**General:** Suelo is a family of round LED in-grades that includes a broad selection of specialty optics in multiple sizes and outputs, making it possible to find the perfect luminaire to illuminate outdoor architectural elements such as facades, columns as well as landscape and pathway lighting within the same product range.

The standard Suelo R provides maximum output and a selection of accessories to control the emission based on application needs. The Suelo PRO version has a more recessed optical chamber instead, to guarantee the best glare control without the need of any louver.

Lastly, Suelo is also available with a Dual Optic (Double, allowing to aim light at two different areas from one fixture) and in a Telescopic version, with an adjustable aluminum tube that elevates the fixture off the ground, to prevent growing vegetation from blocking the light.

**Fixture Body:** Open-pore Anodized and Powder Coated Die-Cast Aluminum.

**Trim:** Semi-Flush (Stainless Steel) Trim with Extra-clear Tempered glass.

**Mounting/Casing:** Black, ABS casings for Concrete installations.

**Drive-over:** Up to 5,511 lbs.

**Dimensions/Weight:** 4.4" (1.54 lbs) – 6.7" (2.21 lbs) – 9.1" (6.61 lbs)

**Driver:** Remote, 120-277V Constant Current DMX (630mA).

**CC features:** Less susceptible to voltage drop (exceeding 32' distance); Allows for dimming down to 0.1%; Fixtures need to be wired in series.

**Wattages:** 8W (4.4") – 16W (6.7") – 30W (9.1")

**Cable:** Fixture comes with 3.28' of power cable and built-in Aquastop® (anti-wicking) system

**IP rating:** IP67 for temporary submersion up to 3.3' of depth for up to a maximum of 1 hr.

**IK rating:** IK 10

**ETL Certification:** ETL, wet location

**Optics:** Fixed, RGBW. Available in Narrow Spot – Spot – Flood – Medium Wide Flood – Wide Flood.

**Color temperatures:** RGBW-3000K – RGBW-4000K.

**CRI:** 80+

**Lumen Maintenance:** L70 projections tested at Tj 65° C and Ta 25°.

**Warranty:** 5-year Limited Warranty on fixtures. 1-year Limited Warranty on Remote Drivers.



4.4" (8W)



6.7" (16W)



9.1" (30W)

Nominal Lumens RGB/RGBW	4.4"	6.1"	9.1"
Red	74	123	177
Green	121	225	320
Blue	21	55	75
White 3000K/4000K	122/153	300/N/A	422/N/A

## Ordering Information (Required)<sup>4</sup>

SUR	SFSTVR	F							
Product	Trim	Type	Diameter	Wattage/Operation	Color Temp	Optic	+	Housing	Driver
SUR = Suelo R	SFSTVR = Semi-Flush St. Steel Vandal Resistant	F = Fixed	44 = 4.4"	8 CCDMX = 8W / Constant Current DMX (630mA)	R3 = RGBW-3000K R4 = RGBW-4000K <sup>1</sup>	NSP = Narrow Spot <sup>2</sup> SP = Spot FL = Flood <sup>3</sup> MWFL = Medium Wide Flood <sup>2</sup> WFL = Wide Flood <sup>3</sup>		E98121 (4.4") E84933 (6.7") E99794 (9.1")	PWR50W-630 PWR50W-350
			67 = 6.7"	16 CCDMX = 16W / Constant Current DMX (350mA)					
			91 = 9.1"	30 CCDMX = 30W / Constant Current DMX (630mA)					

<sup>1</sup> 4.4" ONLY

<sup>2</sup> 4.4" ONLY

<sup>3</sup> N/A for 4.4"

<sup>4</sup> See page 2



## 4.4" 8W

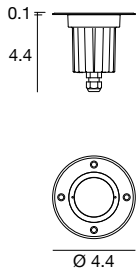

### Housing

**E98121**  
Recessed Housing



### C.C. Power supply options (remote only)

#### PWR50W-630

DMX driver, EldoLED POWERdrive 50W Factory pre-programmed or RDM programmable, DMXcontrol not included/Ordered separately 50W for 1-4 fixtures

## 6.1" 16W

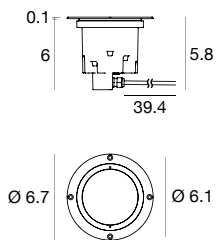

### Housing

**E84933**  
Recessed Housing



### C.C. Power supply options (remote only)

#### PWR50W-350

DMX driver, EldoLED POWERdrive 50W Factory pre-programmed or RDM programmable, DMXcontrol not included/Ordered separately 50W for 1-2 fixtures

## 9.1" 30W

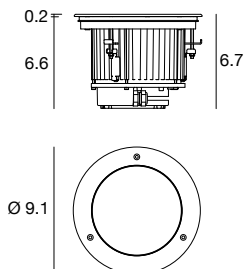

### Housing

**E99794**  
Recessed Housing

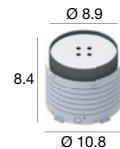

### C.C. Power supply options (remote only)

#### PWR50W-630

DMX driver, EldoLED POWERdrive 50W Factory pre-programmed or RDM programmable, DMXcontrol not included/Ordered separately 50W for 1 fixture