

20 Linear Wash Light Surface

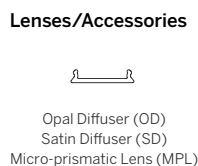

Ordering Information									
Model	Fixation	Pattern	Length	Power ²	CRI/ CCT ³	Driver ⁴	Lens	Finish ⁵	Options
WG-20LWW-SM	SC GT9 GT15	S PI ¹ PO ¹	A A x B A x B x C A x B x A x B	L M H	927 930 935 940 WD RGBW	X S D010 L3DAE L3D0E DFPN EL96 DMX	OD (std) SD MPL	W (std) B S F	EM WL ⁶

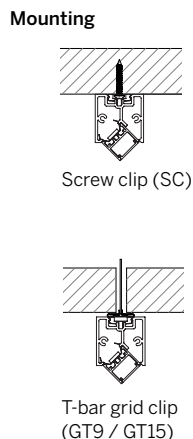
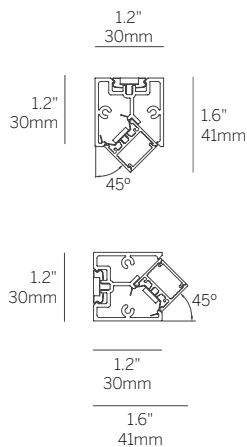

Luminaire

- Surface mounted wash light with minimal housing for continuous mounting to any desired length (1/4" increments), as well as standard grid multiples.
- Multiple lens options for diffuse, high efficiency and low brightness.
- Remote driver options (required). Field replaceable LED boards.
- Lengths and angles factory cut to exact field dimensions.
- Supplied with 4' class 2 plenum rated feed cable per fixture length.
- 90+ CRI, 3 steps MacAdam.
- L70 (TM21 Projected 85C) Static White 60,000 hours, RGBW 50,000 hours, WD 36,000 hours.
- ETL and ETL-C for dry and damp location.

Fixation

- SC = Screw clip
- GT9 = 9/16" T-bar grid clip
- GT15 = 15/16" T-bar grid clip

Pattern

- S = Straight run
- PI = Standard patterns 2, 3 or 4 sided with 90° inside corners on the same plane¹
- PO = Standard patterns 2, 3 or 4 sided with 90° outside corners on the same plane¹

Length

- A, B, C = specify inches to the nearest 0.25" (i.e. 72.25") For patterns specify each length (i.e. 2 sided: A x B = 72.25" x 48"; 3 sided: A x B x C; 4 sided: A x B x A x B)
- For 2 and 4 foot fixtures to fit ceiling grids specify 24" and 48" lengths

Power²

- L = 3W/ft low power (WD 2.7 W/ft) (24V)
- M = 6W/ft mid power (WD 5.5 W/ft) (24V) (RGBW - 7.6W/ft)
- H = 10W/ft high power (WD 8 W/ft) (24V)

CRI/CCT (90+ CRI)³

- 927 = 2700K
- 930 = 3000K
- 935 = 3500K
- 940 = 4000K
- WD = Warm Dimming 1800 - 3000K
- RGBW = 3000K White (M power only)

Driver (remote)⁴

- X = No driver, ordered separately
- S = Standard, non-dim driver 120-277V
- D010 = Osram, 10%, 0-10V dimming, 120-277V
- L3DAE = Lutron Hi-lume 1% EcoSystem, 120-277V
- L3D0E = Lutron Hi-lume Premier 0.1% EcoSystem, 120-277V
- DFPN = Lutron Forward Phase 1%, 120VAC
- EL96 = Osram / EldoLED, 24V, 0.1% 0-10V Dimming
- DMX = Osram / EldoLED, 24V, 0.1% DMX Dimming

Lens

- OD = Satin opal diffuser (standard)
- SD = Satin clear diffuser
- MPL = Micro-prismatic lens

Finish⁵

- W = White, 15% gloss, Tiger Drylac 49/11350 (standard)
- B = Black, 15% gloss, Tiger Drylac 44/90053
- S = Silver, 15% gloss, Tiger Drylac 49/90500
- F = Custom finished trim, specify RAL

Options

- EM = Emergency LED driver (remote only)
- WL = Wet Location Under Canopy / Cover⁶

1 See pattern spec sheet.
 2 Wattage shown is for LED boards only, system wattage varies depending on driver selected.
 3 See photometric data sheet for delivered lumens.
 4 Remote power supply required. See power supply page for details.
 5 See Tiger Drylac color chart: inter-lux.com/tiger
 6 Wet Location option available for OD / SD / MPL lenses and recessed / surface ceiling applications only.

20 Linear Wash Light Surface

WG-20LWW-SX-...-OD-W

Delivered Lumens Per Foot

		Power			
		L [3 W/ft]	M [6 W/ft]	H [10 W/ft]	RGBW [7.6 W/ft]
CCT	927	183	366	641	-
	930	199	398	697	-
	935	236	473	828	-
	940	281	562	983	-
	WD ²	140	291	421	-
	RGBW ³	-	-	-	238
UGR ⁴		37.4	39.9	41.7	-
Fixture Efficiency = 60%		Lumens Per Watt = 67			

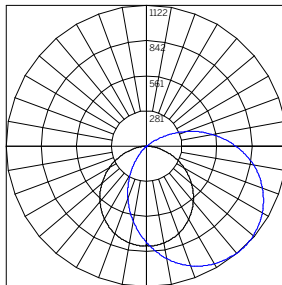

BEAM ANGLE (0-180) = 110.2
BEAM ANGLE (90-270) = 110.9

ILLUMINANCE - 48" OD H 3500K

WG-20LWW-SX-...-S-48-H-935-...-OD-W...¹

Mounting Height [ft]	Illuminance [fc at max cd]	Beam Width [ft]
2	281	5.7
4	70	11.5
6	31	17.2
8	18	22.9
10	11	28.7
12	8	34.4
14	6	40.1
16	4	45.9
18	3	51.6
20	3	57.3

WG-20LWW-SX-...-SD-W

Delivered Lumens Per Foot

		Power			
		L [3 W/ft]	M [6 W/ft]	H [10 W/ft]	RGBW [7.6 W/ft]
CCT	927	251	502	879	-
	930	274	546	956	-
	935	324	649	1136	-
	940	385	771	1349	-
	WD ²	192	400	578	-
	RGBW ³	-	-	-	327
UGR ⁴		39.2	41.7	43.5	-
Fixture Efficiency = 83%		Lumens Per Watt = 91			

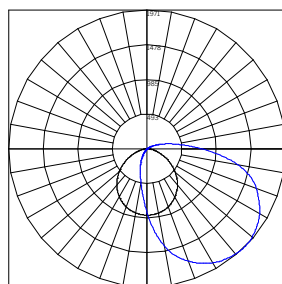

BEAM ANGLE (0-180) = 84.6
BEAM ANGLE (90-270) = 106

ILLUMINANCE - 48" SD H 3500K

WG-20LWW-SX-...-S-48-H-935-...-SD-W...¹

Mounting Height [ft]	Illuminance [fc at max cd]	Beam Width [ft]
2	493	3.6
4	123	7.3
6	55	10.9
8	31	14.5
10	20	18.2
12	14	21.8
14	10	25.5
16	8	29.1
18	6	32.7
20	5	36.4

WG-20LWW-SX-...-MPL-W

Delivered Lumens Per Foot

		Power			
		L [3 W/ft]	M [6 W/ft]	H [10 W/ft]	RGBW [7.6 W/ft]
CCT	927	209	418	732	-
	930	228	454	795	-
	935	270	540	945	-
	940	321	641	1123	-
	WD ²	160	332	481	-
	RGBW ³	-	-	-	272
UGR ⁴		40.8	43.4	45.2	-
Fixture Efficiency = 69%		Lumens Per Watt = 72			

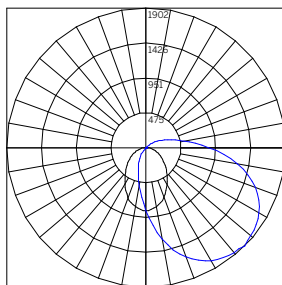

BEAM ANGLE (0-180) = 85.5
BEAM ANGLE (90-270) = 81.4

ILLUMINANCE - 48" MPL H 3500K

WG-20LWW-SX-...-S-48-H-935-...-MPL-W...¹

Mounting Height [ft]	Illuminance [fc at max cd]	Beam Width [ft]
2	476	3.7
4	119	7.4
6	53	11.1
8	30	14.8
10	19	18.5
12	13	22.2
14	10	25.9
16	7	29.6
18	6	33.3
20	5	37

Power Multiplier				
	L [3 W/ft]	M [6 W/ft]	H [10 W/ft]	RGBW [7.6 W/ft]
9XX/RGBW	0.29	0.57	1.00	0.29
WD	0.17	0.35	0.51	-
CCT Multiplier				
	927	930	935	940
	0.77	0.84	1.00	1.19

- 1 Polar Plot and Cone of Light are applicable to part number noted; use Multiplication Factor table to approximate other models or refer to online photometry.
- 2 WD lumen data at maximum output (3000K).
- 3 RGBW lumen data at maximum output with 3000K White LED.
- 4 UGR value noted is the maximum UGR (crosswise) with 935 LEDs / 48" length.