

archiline



Archiline is a linear outdoor light offering a high level of luminosity and flexibility. This extremely wide and competitive range is the result of many years' research. Each item is precision engineered using top-quality materials, and each Archiline family offers a range of outputs, with dedicated narrow, wide, elliptical and asymmetric wallwasher beams and optical compartments designed to ensure a uniquely pure beam, easy to plug connectors for simpler installation, various dimming protocols, a choice of monochrome warm and natural white or RGBW, with the colors being mixed in the optic.

Recessed model materials

Anodized 6060 aluminum alloy or AISI 316L stainless steel flange
Extra-clear tempered glass or white ceramic varnished tempered glass diffuser

Wall/ceiling model materials

Anodized 6060 aluminum alloy or AISI 316L stainless steel body
Extra-clear tempered glass diffuser





archiline range

Archiline_F



Archiline_FL







	_F	_F Darklight	_FL
12.6 in	14.5 W	13.5 W	3.6 W
20.1 in	22 W	22 W	6 W
39.4 in	44 W	43.5 W	12 W
Finish			
powerLED	2700K 3000K 3500K 4000K RGBW (3K) RGBW (4K)	2700K 3000K 3500K 4000K	2700K 3000K 3500K 4000K RGBW (3K) RGBW (4K)
Optics	Narrow S. Spot Medium Fl. Flood Elliptical Asymmetric	Spot Medium Fl. Flood Elliptical	General
Driver	120/277VAC On/Off, 0-10V, DMX	120/277VAC On/Off, 0-10V	120/277VAC On/Off, 0-10V, DMX
Fixture	Trimless	Trimless/Draklight Louver	Trimless/Diffused
Continuous runs	Ok	Ok	Ok

Archiline_A



Archiline_I



	_A	_A Darklight	_I	_I Darklight
14.6 in	13.2 W	12 W	-	-
14.8 in	-	-	13 W	12 W
22.1 in	20 W	20 W	-	-
22.2 in	-	-	20 W	20 W
41.4 in	40 W	40 W	-	-
41.9 in	-	-	40 W	40 W
Finish				
powerLED	2700K 3000K 3500K 4000K RGB+W RGB+N	2700K 3000K 3500K 4000K	2700K 3000K 3500K 4000K RGB+W RGB+N	2700K 3000K 3500K 4000K
Optics	Narrow S. Spot Medium Fl. Flood Elliptical Asymmetric	Spot Medium Fl. Flood Elliptical	Narrow S. Spot Medium Fl. Flood Elliptical Asymmetric	Spot Medium Fl. Flood Elliptical
Driver	120/277VAC On/Off, 0-10V, DMX	120/277VAC On/Off, 0-10V	120/277VAC On/Off, 0-10V, DMX	120/277VAC On/Off, 0-10V
Fixture	Alluminum Flange	Alluminum Flange/Darklight Louver	Stainless Steel Flange	Stainless Steel Flange/ Darklight Louver
Continuous runs	Not recommended	Not recommended	Not recommended	Not recommended

High-quality construction

Archiline bodies are made from extruded 6060 aluminum alloy Anodized to 10 microns.

These two processes provide superior passive heat dissipation and, most importantly, higher corrosion resistance.

The caps are diecast.

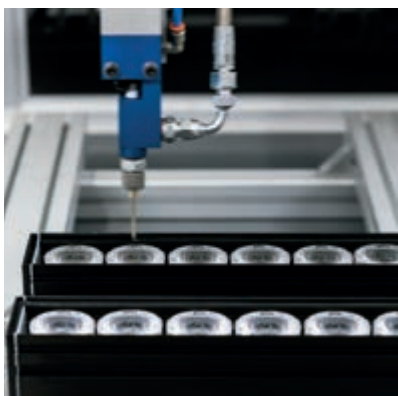

Safety systems

We have developed a variety of corrosion protection technology to maximize the lifespan of our lights.

They also have overtension and electrical discharge protection, TCS® to shield their circuits from moisture, and AquaStop® water protection.



The range

The Archiline range comprises four subranges of recessed mountings.

- ARCHILINE_F: trimless with extra-clear 0.5-inch tempered glass and black-screenprinted optical compartment, with or without darklight or in RGBW. Designed for wall illumination, and can be placed in continuous runs.

- ARCHILINE_FL: trimless with extra-clear 0.5-inch tempered glass and white ceramic varnish, monochrome or RGBW versions. Designed for path marking in parks, squares, drives, and public spaces. Can be placed in continuous runs.

- ARCHILINE_A: 6060 aluminum alloy flange with extra-clear 0.5-inch tempered glass and black-screenprinted optical compartment, with or without darklight or in darklight+RGBW. Designed for wall illumination. Not recommended for continuous runs.

- ARCHILINE_I: AISI 316L stainless steel flange with extra-clear 0.5-inch tempered glass and black-screenprinted optical compartment, with or without darklight or in darklight+RGBW. Designed for wall illumination. Not recommended for continuous runs.

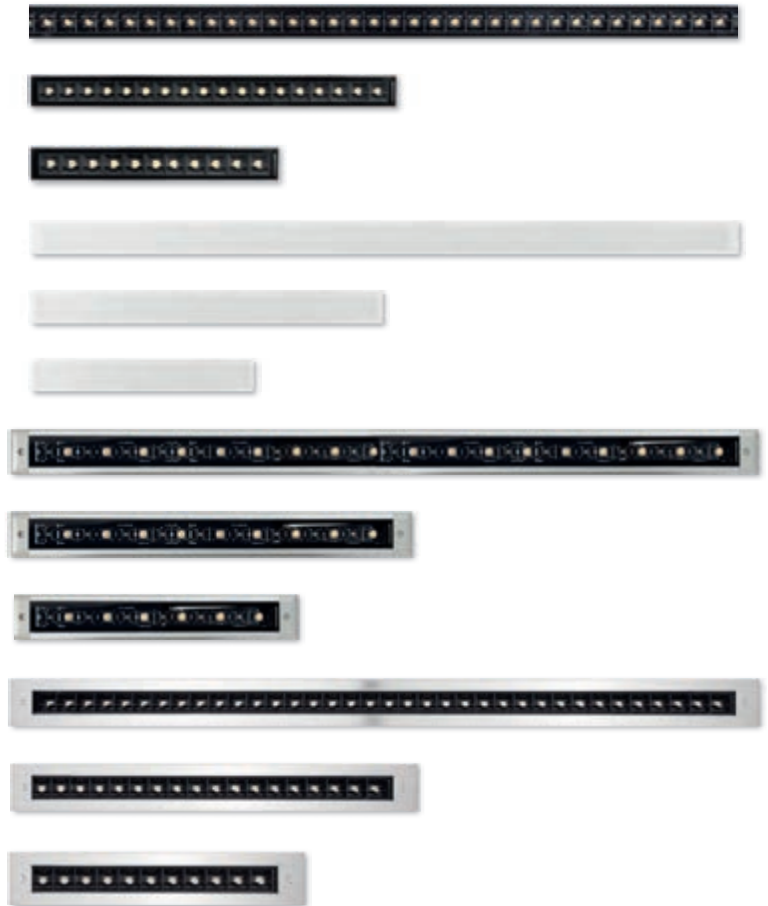

Optics

The Archiline range has optics for every type of design need.

- SPOT and NARROW SPOT for accent lighting
- FLOOD and MEDIUM FLOOD for soft lighting of parts of walls
- ELLIPTIC 20°x50°, which projects an oval beam, ideal for grazing illumination of high and narrow walls
- ASYMMETRIC for a wallwasher effect.

Other features:

- Darklight versions, which section the beam by eliminating the direct component to the exterior and lighting only the wall
- Ability to create continuous lines without affecting the evenness of the light near the ends of each module. In the Archiline_F no-darklight versions, the diodes are arranged so as to maintain the same distance between each one, and between the last ones at each end.

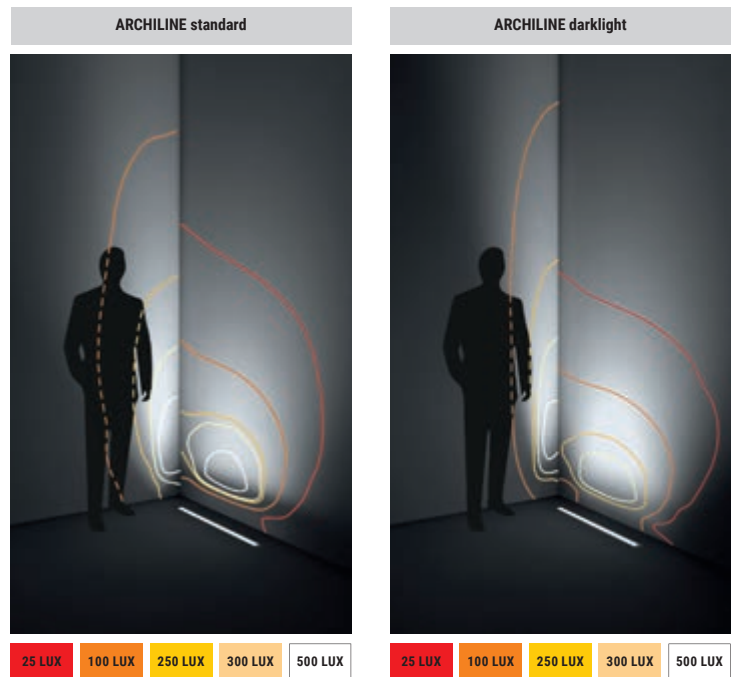

Archiline PRO_I | Linear profiles | 120-277V | powerLED | Wet location IP67 | Integral Driver | Walk over | 26W/ft

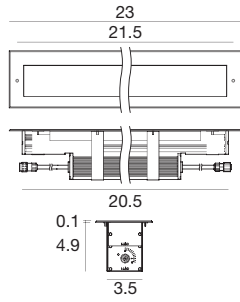

46W CRI80

Steel	On/Off	E81673	2700K	5243 lm	M	Spot	15
Steel	0-10V	E83701	3000K	5243 lm	W	Flood	30
9 LEDs			3500K	5243 lm	T	Medium Flood	60
			4000K	5660 lm	N	Elliptical	25

Steel	On/Off	E81677	2700K	5243 lm	M	Narrow Spot	06
Steel	0-10V	E83702	3000K	5243 lm	W		
9 LEDs			3500K	5243 lm	T		
			4000K	5660 lm	N		

Installation accessories



99771
Outer casing

Cables On/Off

E99057	E98147	E98146
78.7 in power supply cable F 3 pin	196.9 in extension M+F 3 pin	393.7 in extension M+F 3 pin

Cables 0-10V

E99826	E99822	E99823	E99824	E99825
39.4 in power supply cable + 0-10V dimming F 5 pin	196.9 in power supply cable + 0-10V dimming F 5 pin	39.4 in extension cable for power + 0-10V dimming M+F 5 pin	196.9 in extension cable for power + 0-10V dimming M+F 5 pin	393.7 in extension cable for power + 0-10V dimming M+F 5 pin

technical information

Archiline PRO_I RGBW DMX | Linear profiles | powerLED | 120-277V | Wet location IP67 | Integral Driver | Walk over | 26W/ft

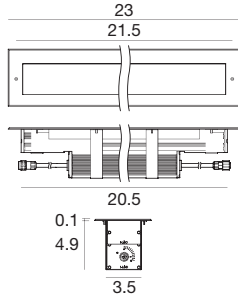
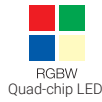

44W CRI80

Steel	E81675	RGBW natural white	Q	Spot	15
		RGBW warm white	V	Medium Flood	30
9 LEDs				Flood	45
				Elliptical	25

Steel **E81679**

RGBW natural white	Q	Narrow Spot	06
RGBW warm white	V		

Installation accessories



E99771
Outer casing

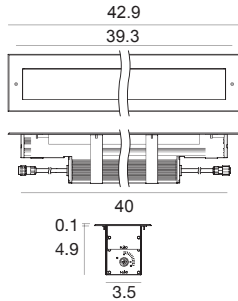

86W CRI80

Steel	E81676	RGBW natural white	Q	Spot	15
		RGBW warm white	V	Medium Flood	30
18 LEDs				Flood	45
				Elliptical	25

Steel **E81680**

RGBW natural white	Q	Narrow Spot	06
RGBW warm white	V		

Installation accessories



E99830
Outer casing

Cables power+DMX

E98660	E98661	E98662	E98663	E98986
39.4 in feed cable all in one power + DMX M+F 6 pin shield	196.9 in feed cable all in one power + DMX M+F 6 pin shield	39.4 in extension all in one power + DMX M+F 6 pin shield	196.9 in extension all in one power + DMX M+F 6 pin shield	DMX 120Ω terminator

technical information