

# Archiline Pro Stainless Steel Frame



**General:** Archiline is a family of high-output, low glare linear LED in-grade and wall fixtures suitable to illuminate outdoor architectural elements such as facades, columns, landscape, and pathway lighting. The PRO version reaches up to 150', making it perfect for tall buildings and towers. Available in Frameless (Drive-Over), Aluminum or Stainless-Steel frame, with a broad range of optics, from Narrow Spot to Asymmetric Wall Washer and Elliptic. Its unique Dark Light (anti-glare) system provides a must-see quiet illumination, while losing almost no output.

**Fixture Body:** Corrosion resistant 6060 Aluminum, Anodized (20 µm), Aluminum finish  
**Trim:** 316 Marine Grade Stainless Steel, Brushed. Extra clear glass - Tempered  
**Mounting/Housing:** Galvanized Steel (required for in ground installations).  
**Drive-over:** Walk-Over only.  
**Dimensions/Weight:** 23" (12.13 lbs), 42.9" (24.3 lbs)

**Driver:** Integral, 120-277V Dimmable 0-10V or Non-Dim.

**Wattages:** 51W (23"), 89W (42.9"),

**Cable:** Fixture comes with 0.66' of cable (Power cable required, ordered separately).

**Safety features:** Built-in Aquastop® (Anti-wicking) and TCS® (Over tension and electrical discharge protection) systems.

**IP rating:** IP67 for temporary flooding up to 3.28' depth for up to a maximum of 30 mins.

**IK rating:** IK 10

**ETL Certification:** ETL, wet location

**Optics:** Fixed. Available in Narrow Spot – Spot – Flood – Elliptic. Archiline PRO comes with Dark Light (Anti-glare) system as a standard feature.

**Color temperatures:** 2700K – 3000K – 3500K – 4000K.

**CRI:** 80+

**Lumen Maintenance:** L70 projections tested at Tj 65° C and Ta 25°.

**Warranty:** 5-year Limited Warranty on fixtures. 1-year Limited Warranty on Remote Drivers.



23" (51W)

42.9" (89W)

Delivered Lumens*	23"	42.9"
Narrow Spot	3526	7052
Spot	3791	7364
Flood	3637	7174
Elliptical	2753	5622

\*Values shown for 3000K

Ordering Information										
ARP	RSF	F			ID					
Product	Mounting/Frame	Type	Length	Wattage	Operation	Color Temp	Optic	+	Housing (Required) <sup>1</sup>	Cables <sup>1</sup>
ARP = Archiline	RSF = Recessed Stainless Steel Frame	F = Fixed	23 = 23"	51 = 51W	ID = Integral (0-10V dim)	27 = 2700K	NSP = Narrow Spot SP = Spot FL = Flood EL = Elliptic/Grazer		E99771 (23) E99830 (43)	E99826 E99822 E99823 E99824 E99825
			43 = 42.9"	89 = 89W		30 = 3000K 35 = 3500K 40 = 4000K				

<sup>1</sup> See page 2

## 23" 51W ID

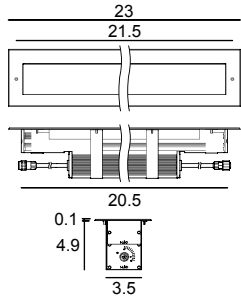

## HOUSING

**E99771**  
Outer Housing



## 42.9" 89W ID

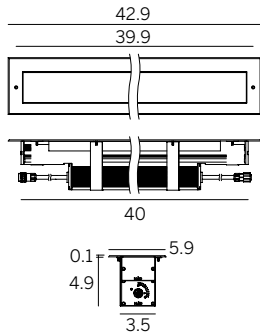

## HOUSING

**E99830**  
Outer Housing



## Cables 0-10V

<b>E99826</b> 39.4" power supply cable +0-10V dimming F 5 pin	<b>E99822</b> 196.9" power supply cable +0-10V dimming F 5 pin	<b>E99823</b> 39.4" extension cable for power +0-10V dimming M+F 5 pin	<b>E99824</b> 196.9" extension cable for power +0-10V dimming M+F 5 pin	<b>E99825</b> 393.7" extension cable for power +0-10V dimming M+F 5 pin
--	---	---	--	--