

# 4" ProTools Downlight Square Recessed

inter•lux

## Multiple luminaire configurations (MLC)

Effortlessly create multiple groups of luminaires in perfect formation without the need for custom housings. It is simple, easy and fast to create any combination required (RPT Recessed Plaster Trim only).\*

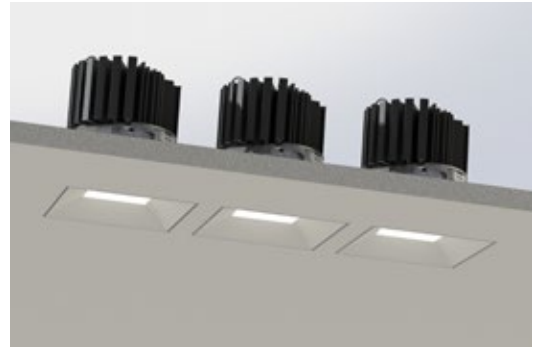
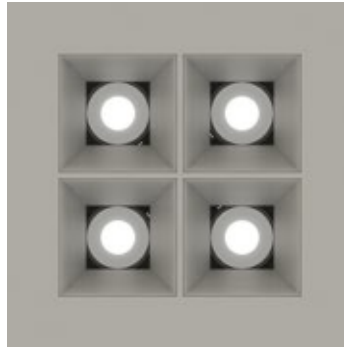

Housings with easy snap-off tabs

Bracket A: 730-20835-101

Bracket B: 730-20836-101



2 x 2 Square Configuration, 4 fixtures  
(brackets required: 2X [730-20835-101](#))

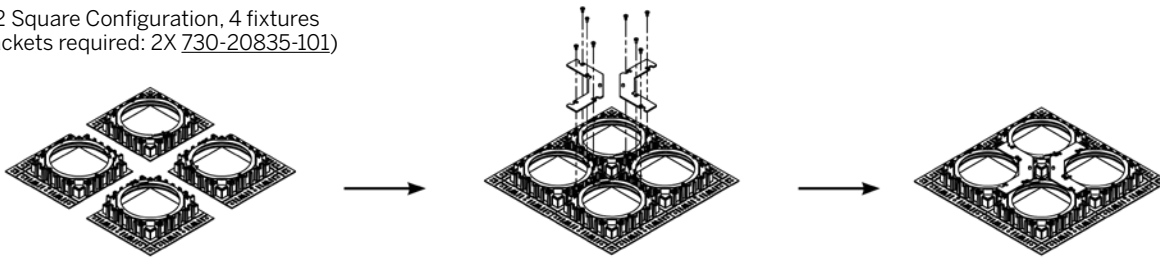

2 x 3 Rectangle Configuration, 6 fixtures  
(brackets required: 2X [730-20835-101](#) and 1X [730-20836-101](#))

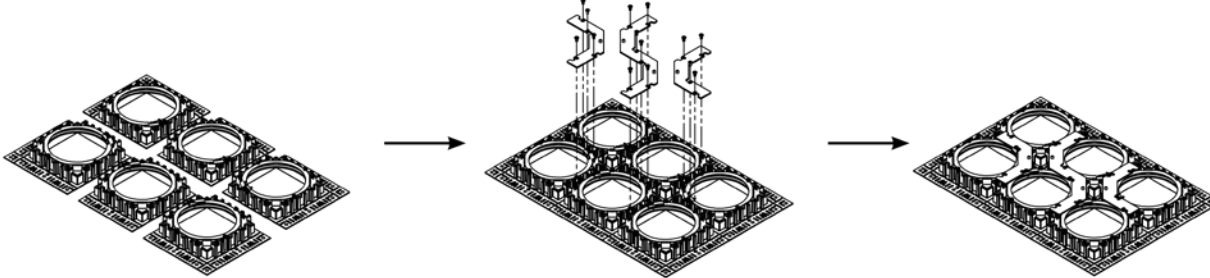

3 Linear (no bracket required)

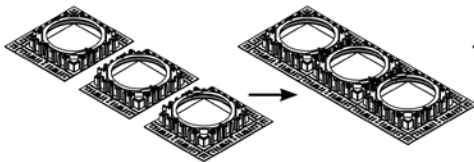

4 Linear (no bracket required)

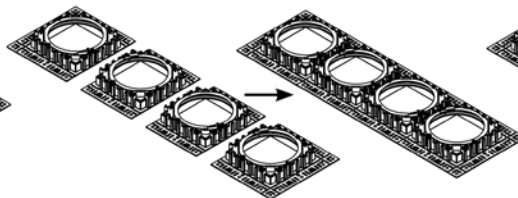

5 Linear (no bracket required)

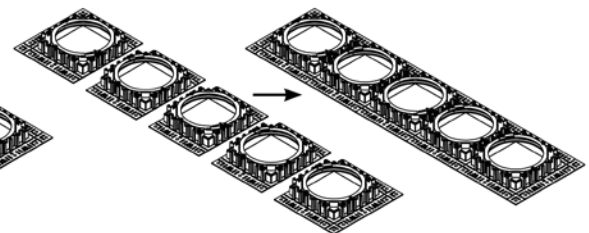

\*Endless linear configurations possible without bracket. Contact factory for additional square and rectangle configurations.

# 4" ProTools Downlight

## Square Recessed



### Wood Ceiling (WC)

\*3/4" thickness standard, custom thickness from 1/4" to 1 1/2" available upon request.  
Black finish standard, custom finishes available upon request.

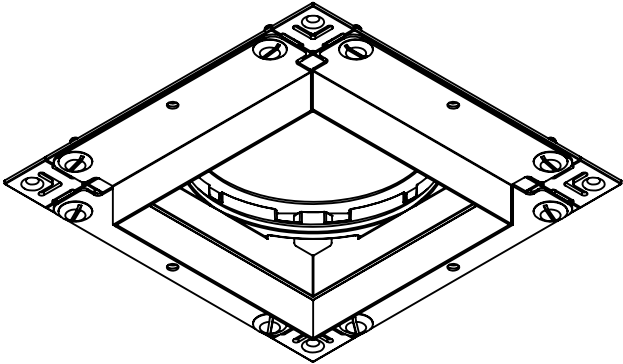
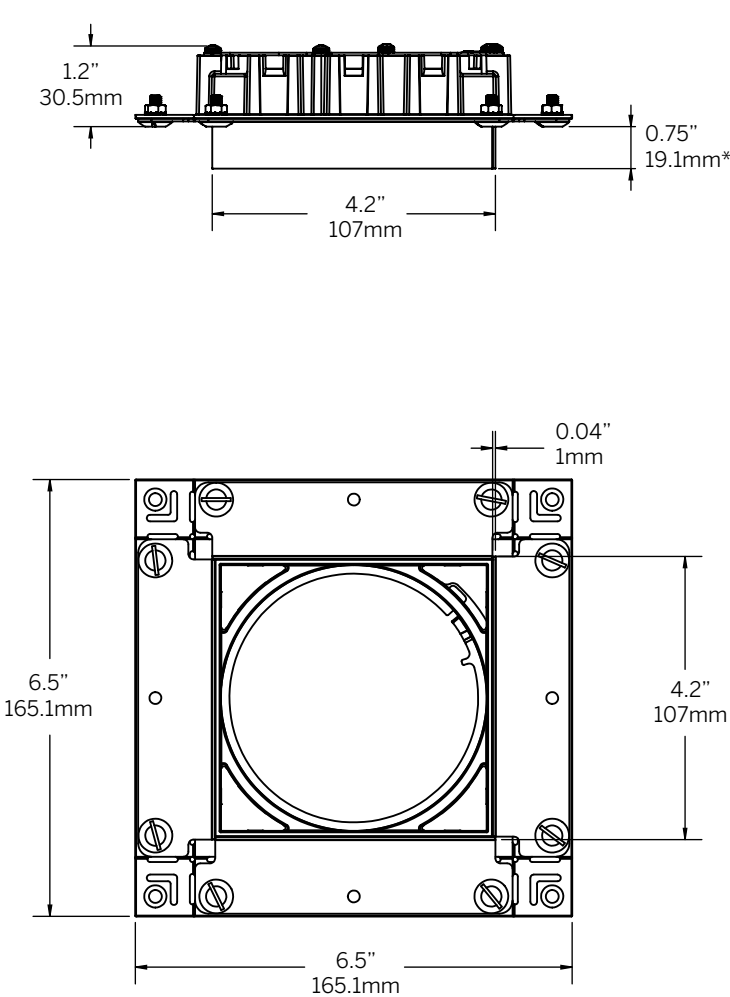

4" ProTools Downlight  
Square Recessed



Thick Ceiling Clip (TC)

Thick Ceiling Clip allows fixture to be installed in ceiling thickness ranging from 1" to 3".

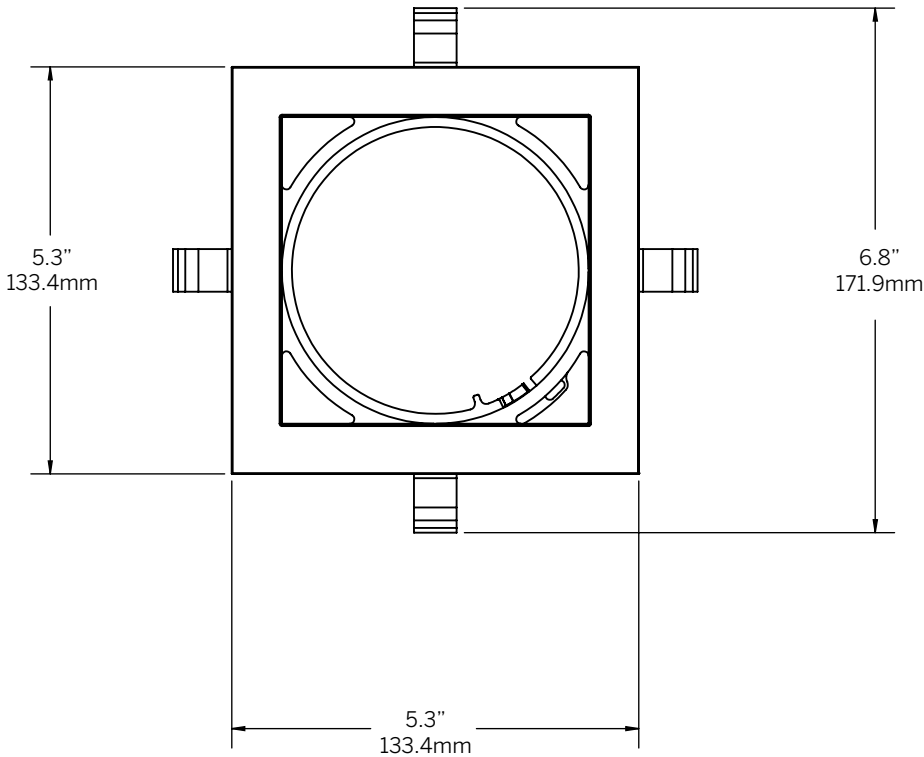
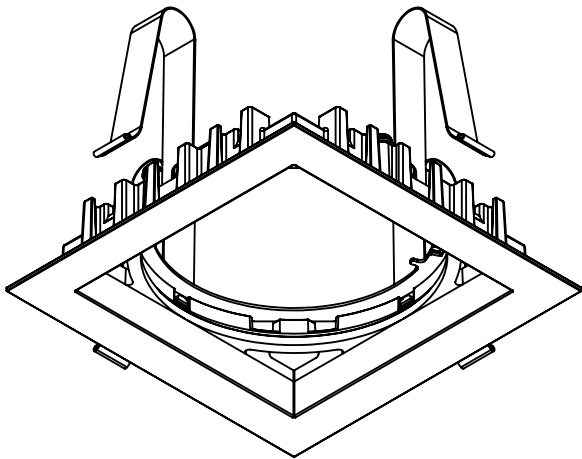
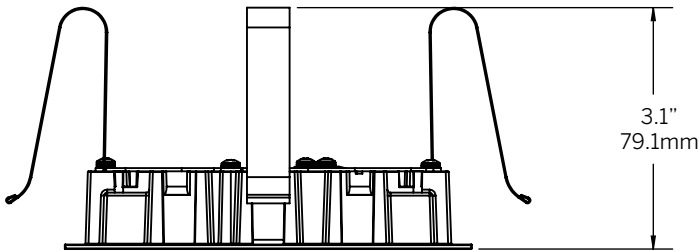

# 4" ProTools Downlight Square Recessed

inter•lux

## Aim Stick & Aim Stick Laser

The focus of tilt is outside the luminaire (red reference lines), thus ensuring that the center of the beam passes through the center of aperture (yellow reference lines), regardless of the angle of illumination selected.

ProTools Aim Stick

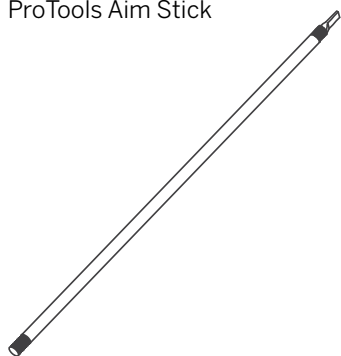

ProTools Aim Stick Laser

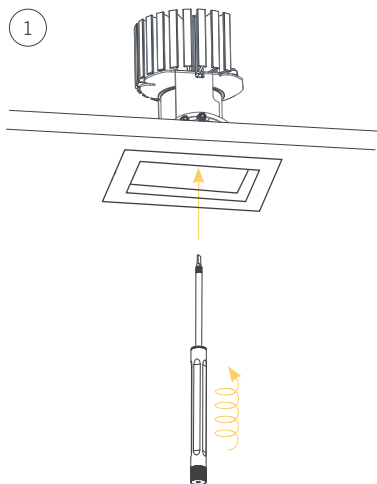
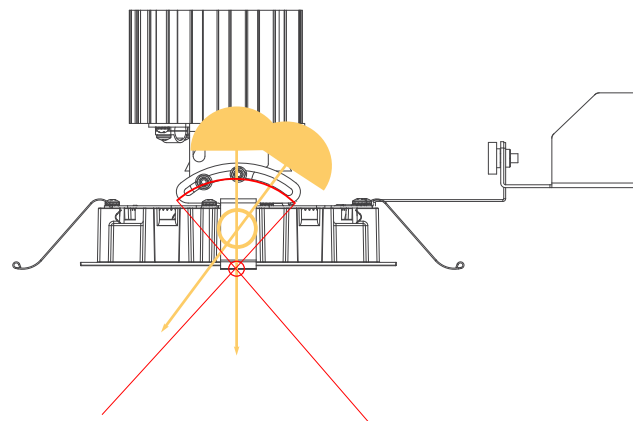

1. Locate the designated hole for the tool. Insert the ProTools Aim Stick into the housing and screw in a few short twists.

View from under the ProTools Adjustable.

The designated hole for the Aim Stick is highlighted in yellow.

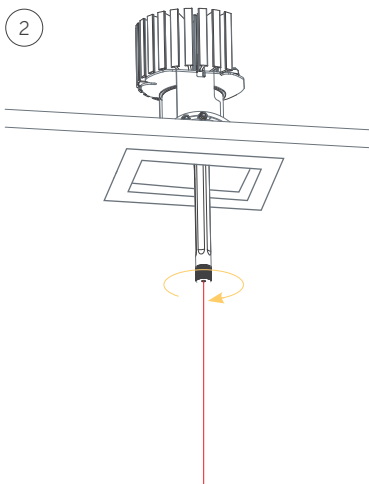
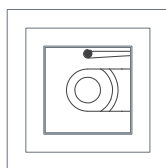

2. Activate the laser by rotating the black dial on the bottom of the Aim Stick clockwise.

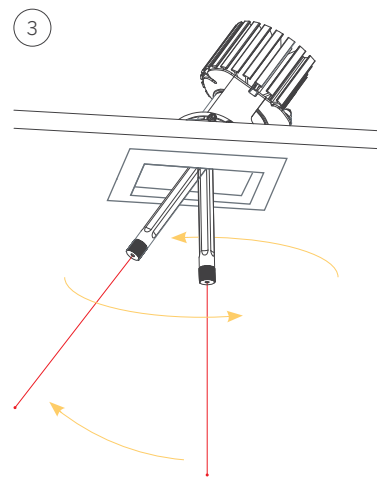

3. Use the tool to rotate the direction of the beam to the desired point. ProTools Adjustable can rotate 365° and has a tilt of 45°.

Once the required adjustment has been made, repeat steps 3-6 in reverse.