

# SUELO Fixed Optics Vandal Resistant



**General:** Suelo is a family of round LED in-grades that includes a broad selection of specialty optics in multiple sizes and outputs, making it possible to find the perfect luminaire to illuminate outdoor architectural elements such as facades, columns as well as landscape and pathway lighting within the same product range.

The standard Suelo R provides maximum output and a selection of accessories to control the emission based on application needs. The Suelo PRO version has a more recessed optical chamber instead, to guarantee the best glare control without the need of any louver.

Lastly, Suelo is also available with a Dual Optic (Double, allowing to aim light at two different areas from one fixture) and in a Telescopic version, with an adjustable aluminum tube that elevates the fixture off the ground, to prevent growing vegetation from blocking the light.

**Fixture Body:** Open-pore Anodized and Powder Coated Die-Cast Aluminum.

**Trim:** Semi-Flush (Stainless Steel) Trim with Extra-clear Tempered glass.

**Mounting/Casing:** Black, ABS casings for Concrete installations.

**Drive-over:** Up to 5,511 lbs.

**Dimensions/Weight:** 4.4" (1.54 lbs) – 6.7" (2.21 lbs) – 9.1" (6.61 lbs)

**CC version:** (4.4" & 6.7") Remote 120-277V Constant Current driver 0-10V dimmable down to 0.1%. Less susceptible to voltage drop (up to 200' wiring distance); Fixtures need to be wired in series.

**CV version:** (4.4") Remote 120-277V Constant Voltage 24VDC. Driver options in 0-10V (typical dim level 10%, dry location) or Non-dim (wet location). Possibility to use higher wattage drivers and feed multiple fixtures with fewer wiring runs; fixtures need to be wired in parallel.

**ID version:** (9.1") Integral 0-10V driver.

**Wattages:** 8W CC / 9W CV (4.4") – 13W CC (6.7") – 33.6W ID (9.1") – 2W CC / 2.5W CV (4.4" HSP)

**Cable:** Fixture comes with 3.28' of power cable and built-in Aquastop® (anti-wicking) system

**IP rating:** IP67 for temporary submersion up to 3.3' of depth for up to a maximum of 1 hr.

**IK rating:** IK 05 (1.2") – IK 09 (2.5") – IK 10 (3.6")

**ETL Certification:** ETL, wet location

**Optics:** Fixed. Available in Hyper Spot – Narrow Spot – Spot – Flood – Wide Flood – Elliptical. Some variants can also mount Honeycomb and Dark Light, anti-glare accessories.

**Color temperatures:** 2700K – 3000K – 4000K.

**CRI:** 80+

**Lumen Maintenance:** L70 projections tested at Tj 65° C and Ta 25°.

**Warranty:** 5-year Limited Warranty on fixtures. 1-year Limited Warranty on Remote Drivers.



4.4" (8W CC / 9W CV)  
(HSP: 2W CC / 2.5W CV)



6.7" (13W CC)



9.1" (33.6W ID)

Fixed Optics Vandal Resistant Delivered Lumens*	4.4"	6.7"	9.1"
HSP	152	–	–
NSP	613	1051	2118
SP	540	978	2928
FL	569	1145	3294
WFL	504	1089	2840

\*Values shown for 3000K

Fixed Optics Vandal Resistant HoneyComb Delivered Lumens*	4.4"	6.7"	9.1"
NSP	470	–	–
SP	478	651	1593
FL	454	697	1817
WFL	326	493	1182

\*Values shown for 3000K

Ordering INFORMATION							(Required) <sup>4</sup>	
SUR	SFSTVR							
Product	Trim	Type	Diameter	Wattage/Operation	Color Temp	Optic	+	Housing
SUR = Suelo R	SFSTVR = Semi-Flush St. Steel Vandal Resistant	F = Fixed	44 = 4.4"	8 CC = 8W/Constant Current (630mA)	27 = 2700K 30 = 3000K 40 = 4000K	HSP = Hyper Spot 3 <sup>o3</sup> NSP = Narrow Spot SP = Spot FL = Flood WFL = Wide Flood EL = Elliptic <sup>3</sup>	+	E98121 (4.4") E84933 (6.1") E99794 (9.1")
		FHC = Fixed HoneyComb <sup>1</sup>		9 CV = 9W/Constant Voltage (24VDC)				
		FDL = Fixed <sup>2</sup> DarkLight		2 CC = HSP 2W/Constant Current (630mA) 25 CV = HSP 2.5W/Constant Voltage (630mA)				
			67 = 6.7"	13 CC = 13W/Constant Current (350mA)				
			91 = 9.1"	34 ID = 33.6W/integral 0-10V				

<sup>1</sup> N/A for 4.4" (FL), 6.7" & 9.1" (HSP, NSP)

<sup>2</sup> N/A for 4.4" & NSP

<sup>3</sup> HSP, EL 4.4" ONLY

<sup>4</sup> See page 2



## 4.4" 8W / 9W (2W / 2.5W HSP)

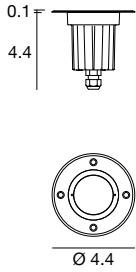

### Housing

#### E98121

Recessed Housing

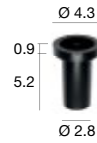

### DRIVER OPTIONS (pick one)

#### C.C. Power supply options (remote only)

##### ECO30W-630

0-10V EldoLED  
ECOdrive 30W  
for 1-3 fixtures

##### SOLO50W-630

0-10V EldoLED  
SOLOdrive 50W  
for 1-4 fixtures

##### SOLO100W-630

0-10V EldoLED  
SOLOdrive 100W  
for 1-8 fixtures

#### 2W HSP C.C. Power supply options (remote only)

##### ECO30W-630

0-10V EldoLED  
ECOdrive 30W  
for 1-10 fixtures

##### SOLO50W-630

0-10V EldoLED  
SOLOdrive 50W  
for 1-16 fixtures

##### SOLO100W-630

0-10V EldoLED  
SOLOdrive 100W  
for 1-32 fixtures

### C.V. Power supply options (remote only)

#### OT96-D010

Osram, 10% 0-10V dim, 96W,  
24VDC, 120-277VAC, supplied  
in a Dry location enclosure

#### OT96-JBX

Osram, Non-dim 24VDC,  
120-277VAC, Wet location

## 6.7" 13W

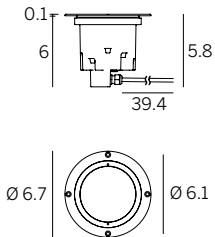

### Housing

#### E84933

Recessed Housing

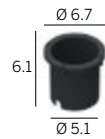

### DRIVER OPTIONS (pick one)

#### C.C. Power supply options (remote only)

##### ECO30W-350

0-10V EldoLED  
ECOdrive 30W  
for 1 fixture

##### SOLO50W-350

0-10V EldoLED  
SOLOdrive 50W  
for 1-2 fixtures

##### SOLO100W-350

0-10V EldoLED  
SOLOdrive 100W  
for 1-4 fixtures

## 9.1" 33.6W

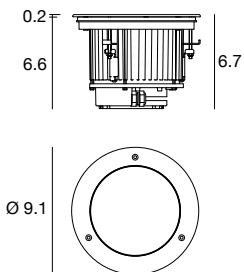

### Housing

#### E99794

Recessed Housing

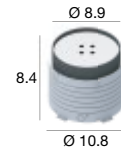

### Integral 0-10V Driver