

SUELO Adjustable Optics Vandal Resistant

inter•lux



General: Suelo is a family of round LED in-grades that includes a broad selection of specialty optics in multiple sizes and outputs, making it possible to find the perfect luminaire to illuminate outdoor architectural elements such as facades, columns as well as landscape and pathway lighting within the same product range.

The standard Suelo R provides maximum output and a selection of accessories to control the emission based on application needs. The Suelo PRO version has a more recessed optical chamber instead, to guarantee the best glare control without the need of any louver.

Lastly, Suelo is also available with a Dual Optic (Double, allowing to aim light at two different areas from one fixture) and in a Telescopic version, with an adjustable aluminum tube that elevates the fixture off the ground, to prevent growing vegetation from blocking the light.

Fixture Body: Open-pore Anodized and Powder Coated Die-Cast Aluminum.

Trim: Semi-Flush (Stainless Steel) Trim with Extra-clear Tempered glass.

Mounting/Casing: Black, ABS casings for Concrete installations. Vandal Resistant, secured with Hex or Torx screws (check installation instructions for details).

Drive-over: Up to 5,511 lbs.

Dimensions/Weight: 4.4" (1.61 lbs) – 6.7" (2.21 lbs) – 9.1" (6.61 lbs) – 12.1"/12.4" (17.6 lbs)

CC version: (4.4", 6.7") Remote 120-277V Constant Current driver 0-10V dimmable down to 0.1%. Less susceptible to voltage drop (up to 200' wiring distance); Fixtures need to be wired in series.

CV version: (4.4") Remote 120-277V Constant Voltage 24VDC. Driver options in 0-10V (typical dim level 10%, dry location) or Non-dim (wet location). Possibility to use higher wattage drivers and feed multiple fixtures with fewer wiring runs; fixtures need to be wired in parallel.

ID version: (9.1", 12.4", 12.1") Integral driver 120-277V dimmable 0-10V down to 1%.

Wattages: 8W / 9W (4.4") – 13W (6.7") – 33.6W (9.1") – 48.2W (12.1" & 12.4")

Cable: Fixture comes with 3.28' of power cable and built-in Aquastop® (anti-wicking) system

IP rating: IP67 for temporary submersion up to 3.3' of depth for up to a maximum of 1 hr.

IK rating: IK 10

ETL Certification: ETL, wet location

Optics: Adjustable. Available in Ultra Spot – Spot – Narrow Flood – Flood – Medium Wide Flood – Wide Flood.

Color temperatures: 2700K – 3000K – 4000K.

CRI: 80+

Lumen Maintenance: L70 projections tested at Tj 65° C and Ta 25°.

Warranty: 5-year Limited Warranty on fixtures. 1-year Limited Warranty on Remote Drivers.



4.4" SFSTVR (8W / 9W)



6.7" SFSTVR (13W)



9.1" SFSTVR (33.6W)

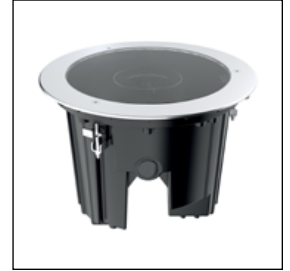

12.4" SFSTVR (48.2W)

Delivered Lumens*	4.4"	6.7"	9.1"	12.1" & 12.4"
USP	–	–	–	3209
SP	–	914	3123	4340
NFL	625	–	–	–
FL	559	1021	3069	4332
MWFL	–	1183	–	–
WFL	573	–	2979	4161

*Values shown for 3000K

Ordering Information							(Required) ¹⁰		
SUR	SFSTVR								
Product	Trim	Type	Diameter	Wattage/Operation	Color Temp	Optic	+	Housing	Driver
SUR = Suelo R	SFSTVR = Semi-Flush St. Steel Vandal Resistant SFBTVR = Semi-Flush Brass Trim Vandal Resistant ¹	A = Adjustable AHC = Adjustable Honeycomb ³ ADL = Adjustable DarkLight ³	44 = 4.4"	8 CC = 8W / Constant Current (630 mA) 9 CV = 9W / Constant Voltage (24 VDC)	27 = 2700K 30 = 3000K 40 = 4000K	USP = Ultra Spot ⁴ SP = Spot ⁵ NFL = Narrow Flood ⁶ FL = Flood MWFL = Medium Wide Flood ⁷ WFL = Wide Flood ^{8,9}	+	E98121 (4.4") E84933 (6.7") E83096 (12.1" & 12.4") E93099 (12.1" & 12.4") E83097 (12.4") E83098 (12.1")	CC: ECO30W-XXX SOLO50W-XXX SOLO100W-XXX CV: OT96-D010 OT96-JBX
			67 = 6.7"	13 CC = 13W / Constant Current (350 mA)					
			91 = 9.1"	34 ID = 33.6W / Integral 120/277VAC 0-10V dim					
			124 = 12.4"	48 ID = 48.2W / Integral 120/277VAC 0-10V dim					
	FTVR = Flush Trim Vandal Resistant (St. Steel) ²		121 = 12.1"	48 ID = 48.2W / Integral 120/277VAC 0-10V dim					

¹ SFBTVR 6.7" ONLY
² FTVR 12.1" & 12.4" ONLY

³ AHC & ADL 12.1" & 12.4" ONLY

⁴ USP 12.1" & 12.4" ONLY

⁵ SP N/A for 4.4"

⁶ NFL 4.4" ONLY

⁷ MWFL 6.7" ONLY

⁸ WFL N/A for 6.7"

⁹ WFL N/A for ADL 12.1" & 12.4"

¹⁰ See page 2



410 381 1497 inter-lux.com answers@inter-lux.com
Inter-lux reserves the right to make technical changes without notice.



Updated 8.2024

4.4" 8W / 9W

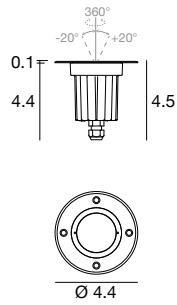

Housing

E98121

Recessed Housing

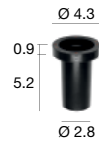

DRIVER OPTIONS (pick one)

C.C. Power supply options (remote only)

ECO30W-630

0-10V EidoLED
ECOdrive 30W
for 1-3 fixtures

SOLO50W-630

0-10V EidoLED
SOLOdrive 50W
for 1-4 fixtures

SOLO100W-630

0-10V EidoLED
SOLOdrive 100W
for 1-8 fixtures

C.V. Power supply options (remote only)

OT96-D010

Osram, 10% 0-10V dim, 96W,
24VDC, 120-277VAC, supplied
in a Dry location enclosure

OT96-JBX

Osram, Non-dim 24VDC,
120-277VAC, Wet location

6.7" 13W

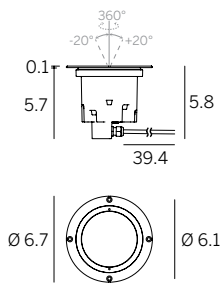

Housing

E84933

Recessed Housing

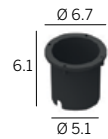

DRIVER OPTIONS (pick one)

C.C. Power supply options (remote only)

ECO30W-350

0-10V EidoLED
ECOdrive 30W
for 1 fixture

SOLO50W-350

0-10V EidoLED
SOLOdrive 50W
for 1-2 fixtures

SOLO100W-350

0-10V EidoLED
SOLOdrive 100W
for 1-4 fixtures

9.1" 33.6W

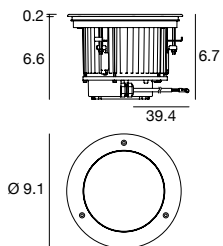

Housing

E99794

Recessed Housing



Integral 120/277VAC 0-10V dim Driver

12.4" 48.2W

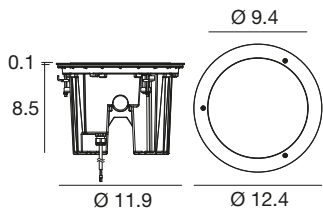

Housing

E83096

Recessed Housing

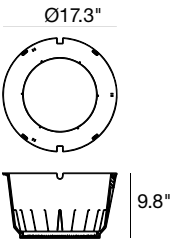

Integral 120/277VAC 0-10V dim Driver

E93099

Housing bottom plate (optional)

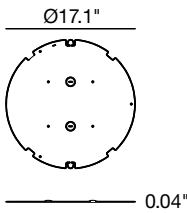

E83098

Concrete pour cover (required)

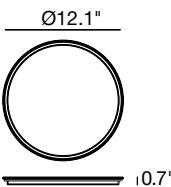

12.1" 48.2W

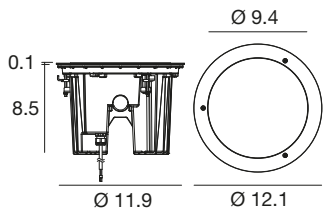

Housing

E83096

Recessed Housing

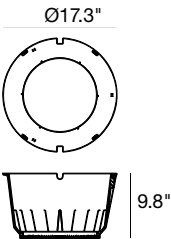

Integral 120/277VAC 0-10V dim Driver

E93099

Housing bottom plate (optional)

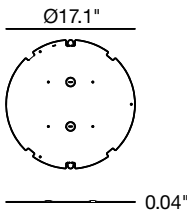

E83097

Concrete pour cover (required)

