

**WARNING:**
INSTALL PRODUCT IN ACCORDANCE WITH LOCAL AND NATIONAL ELECTRICAL CODES BY A QUALIFIED ELECTRICIAN OR ELECTRICAL CONTRACTOR.

**WARNING:**
FAILURE TO COMPLY WITH THE INSTALLATION INSTRUCTIONS MAY RESULT IN DEATH OR SERIOUS INJURY

**WARNING:**
READ ALL SAFETY INSTRUCTIONS INCLUDED WITH LUMINAIRE BEFORE INSTALLING LUMINAIRE.

CAUTION:
THIS IS AN ELECTRONIC DEVICE. CARE MUST BE TAKEN DURING STORAGE AND HANDLING. STORE IN A CLEAN, COOL AND DRY LOCATION. ELECTROSTATIC DISCHARGE (ESD) CAN HARM THIS PRODUCT. AVOID STATIC DISCHARGE WHILE HANDLING THIS PRODUCT.

CAUTION:
INTER-LUX IS NOT RESPONSIBLE FOR THE STRUCTURAL INTEGRITY OF THE BUILDING TO SUPPORT THE LUMINAIRE. ADDITIONAL BACKING MAY BE REQUIRED.

MOUNTING DIMENSIONS

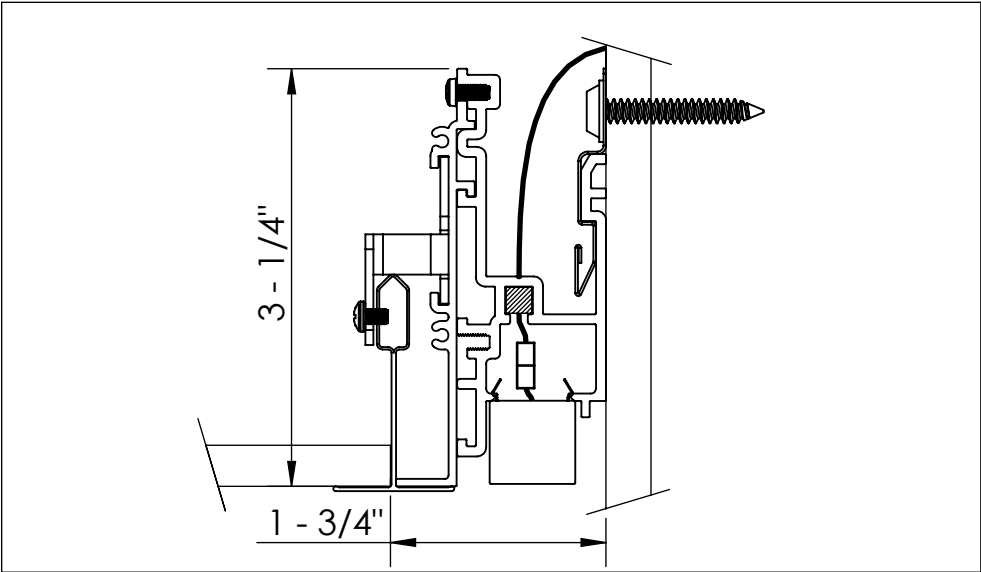

ISOMETRIC VIEW

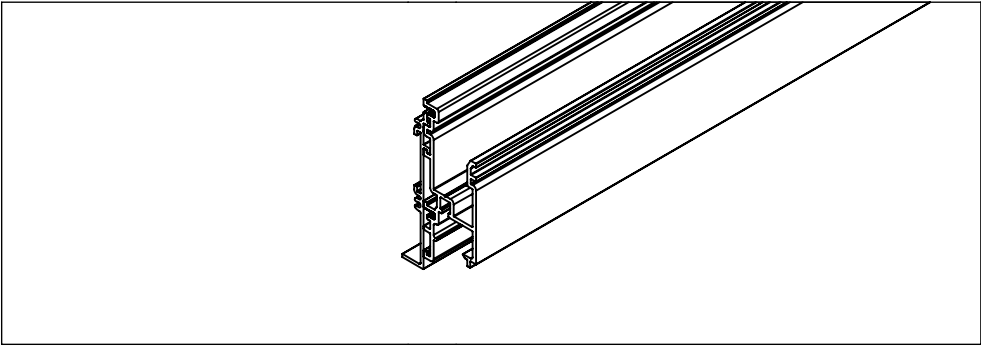

PACKAGE INCLUDES: (refer to package list to identify parts)

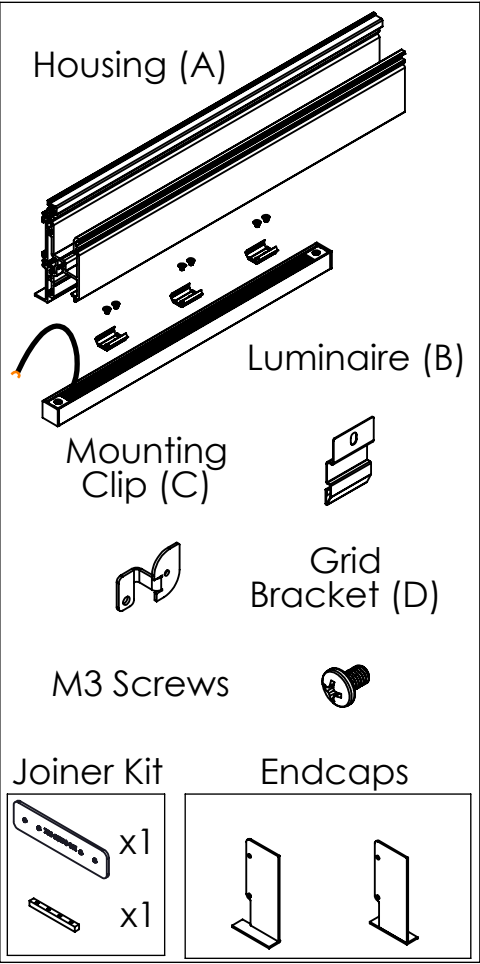

ITEMS NEEDED (SUPPLIED BY OTHERS):

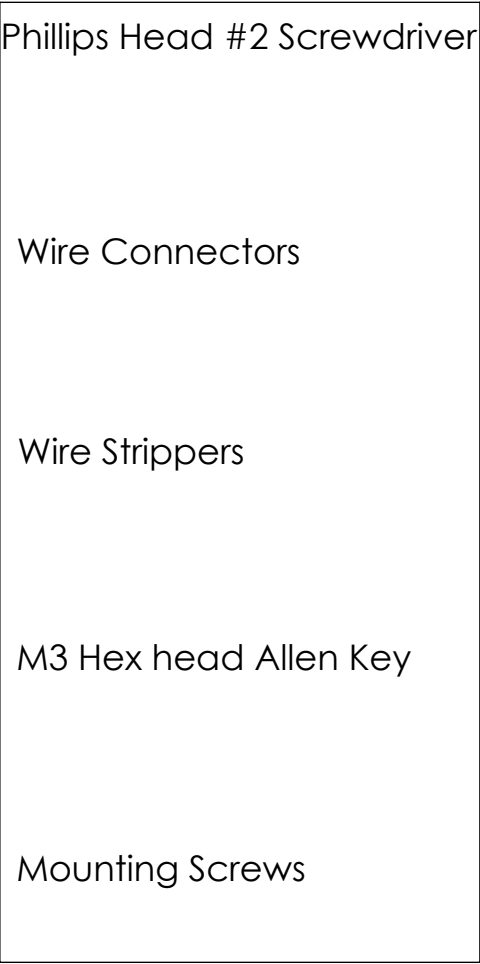

INSTALLATION INSTRUCTIONS

LOCATE AND REVIEW ANY CONSTRUCTION PLANS AND INTERLUX RECORD DRAWINGS FOR ALL FIXTURE RUNS. It is recommended to locate and lay out all components for each fixture "run". A fixture run typically consist of joiners, lengths of housings, lengths of inserts, and endcaps. BE SURE TO IDENTIFY ALL CORRECT LENGTHS FOR EACH FIXTURE RUN.

Step 1; Mounting Clips: **Turn off Power before Installing.** Mark the wall at the intended height of the Mounting Clips (C), 3 - 1/4" above the bottom of the intended ceiling. Then screw Mounting Clips (C) into the wall, it is recommended you use appropriate backing or drywall anchors. The surrounding structure is required to support the weight of the fixture (1 - 1/2 lb per foot). Use at least one Clip every 16", for each Housing (A) Length. For shorter Housings (A), must use at least 2 Clips per Housing (A), 3 recommended. No Clip should be within 3" from the ends of any Housing (A).

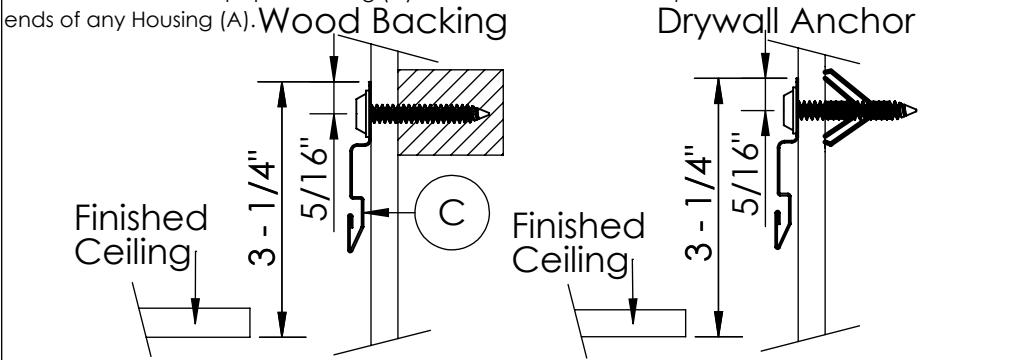

Step 2; Feed Holes: Determine which end the Luminaire (B) cables will start at on each Housing (A) and mark them on the shown location on the Housings (A), no less than 3 inches from the end. Then drill 1/4" holes where you marked. Finally look at where the Housings (A) will be installed and drill 1/4" holes above the line of the Mounting Clips, and close to where the holes in the Housings (A) will end up.

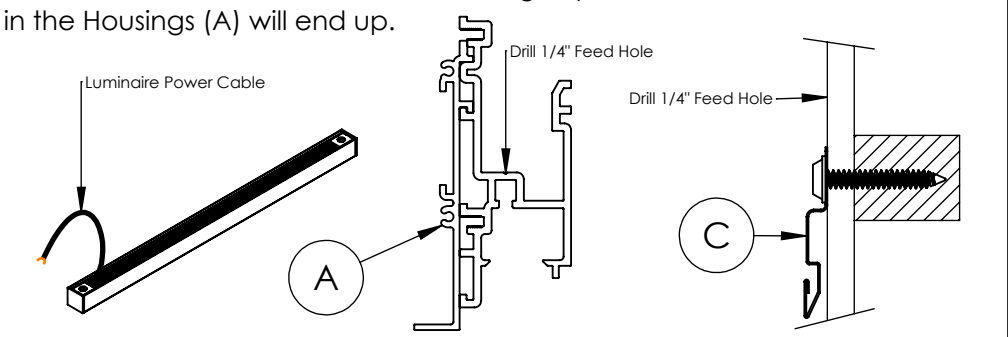

Step 3; Remote Drivers: Install the Remote drivers and run Low voltage cables to the wall. Then run the Low voltage cables through the feed holes drilled above the Mounting Clips (C).

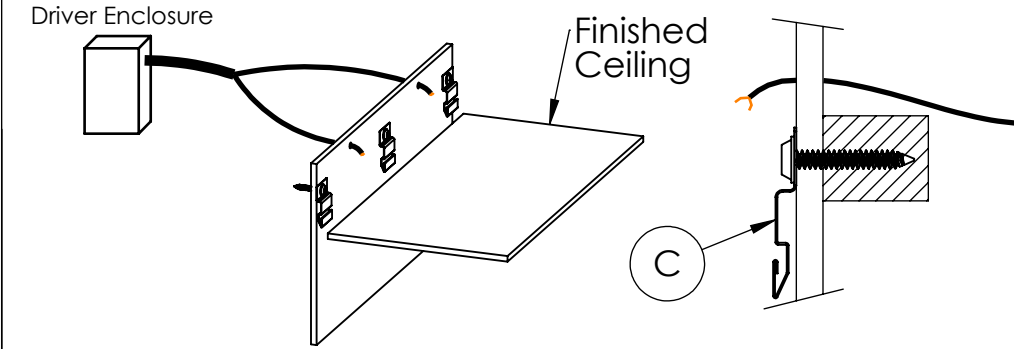

Step 4; Mounting Hardware: Install Endcaps on first and last Housing (A) of each run. Insert two T - grid Brackets (D) and Joiners on each Housing (A). T - grid Brackets (D) should be positioned equally spaced from ends of Housing (A), and fastened with provided set screws. Then install Snap-in clips on Luminaires (B) using provided screws.

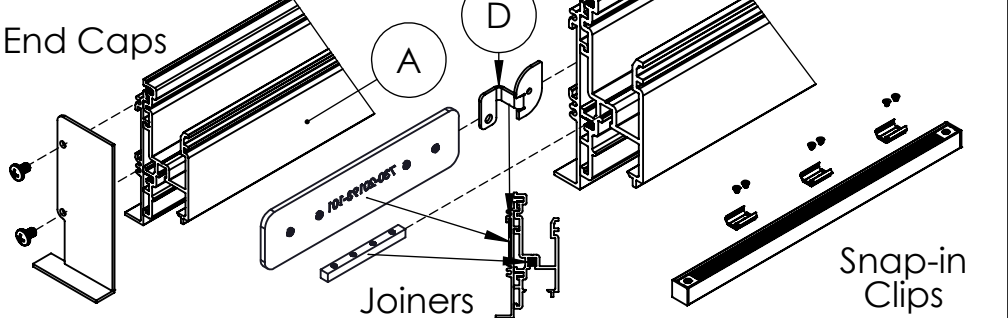

Step 5; Install Housing: Ensure all Low voltage cables are pulled through the wall and accessible. Check that Housings (A) and Luminaires (B) have correct End caps and Joiners installed. Then push the Housing (A) up until it engages with the Mounting Clips (C). Repeat until all Housings (A) are installed. Next slide all joiners (example below) halfway in between each Housing (A) and tighten the set screws. Run Low voltage cables through Housing (A) feed holes. Finally make electrical connections to Luminaire (B) cables with supplied connectors.

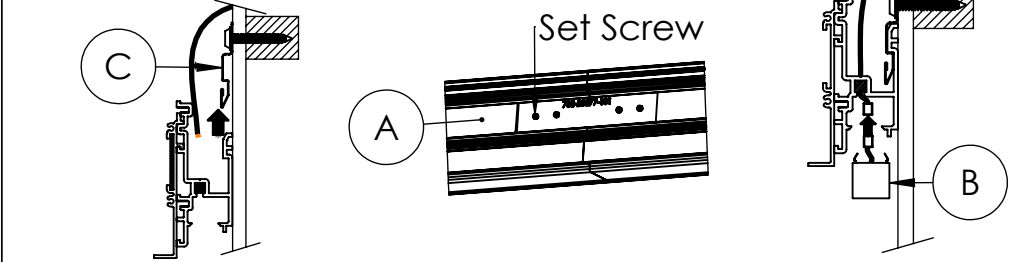

Step 6; Install Luminaire: Push the Luminaires (B) up until they snap into the Housings (A). When the ceiling and grid is installed, it will need to end 1 - 3/4" from the the wall (as shown below) to accomodate the Housings (A). Then fold the Grid Bracket (D) over the T - grid and drive a screw through them both (recommended Phillips #8-32 x 3/8"). Finally power the Luminaires (B) to double check electrical connections.

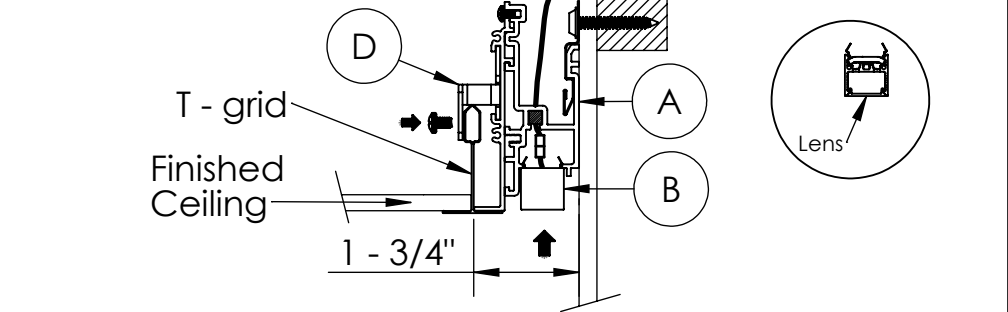

WARNING:
INSTALL PRODUCT IN ACCORDANCE
WITH LOCAL AND NATIONAL ELECTRICAL
CODES BY A QUALIFIED ELECTRICIAN
OR ELECTRICAL CONTRACTOR.

WARNING:
FAILURE TO COMPLY WITH THE
INSTALLATION INSTRUCTIONS MAY
RESULT IN DEATH OR SERIOUS INJURY

WARNING:
READ ALL SAFETY INSTRUCTIONS
INCLUDED WITH LUMINAIRE BEFORE
INSTALLING LUMINAIRE.

CAUTION:
THIS IS AN ELECTRONIC DEVICE. CARE MUST BE TAKEN
DURING STORAGE AND HANDLING. STORE IN A CLEAN, COOL
AND DRY LOCATION. ELECTROSTATIC DISCHARGE (ESD) CAN
HARM THIS PRODUCT. AVOID STATIC DISCHARGE WHILE
HANDLING THIS PRODUCT.

CAUTION:
INTER-LUX IS NOT RESPONSIBLE FOR THE
STRUCTURAL INTEGRITY OF THE BUILDING TO
SUPPORT THE LUMINAIRE. ADDITIONAL BACKING
MAY BE REQUIRED.

MOUNTING DIMENSIONS

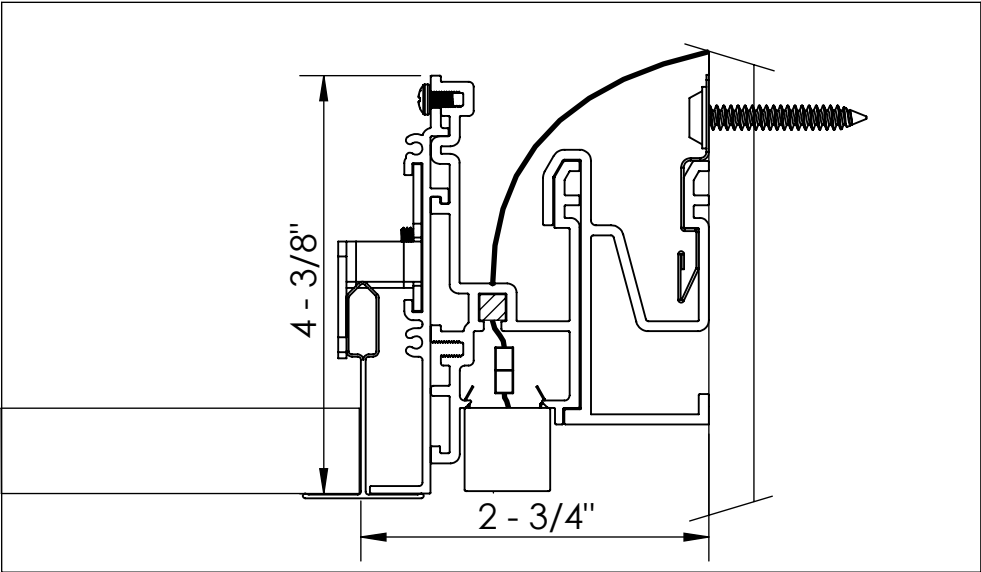

ISOMETRIC VIEW

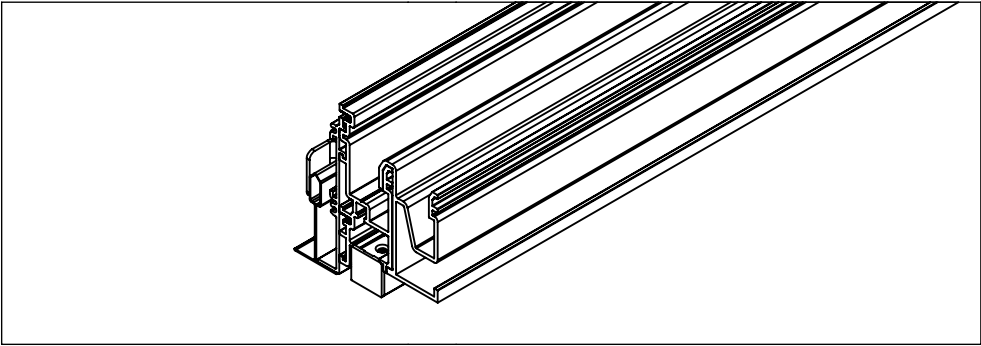

PACKAGE INCLUDES: (refer to package list to identify parts)

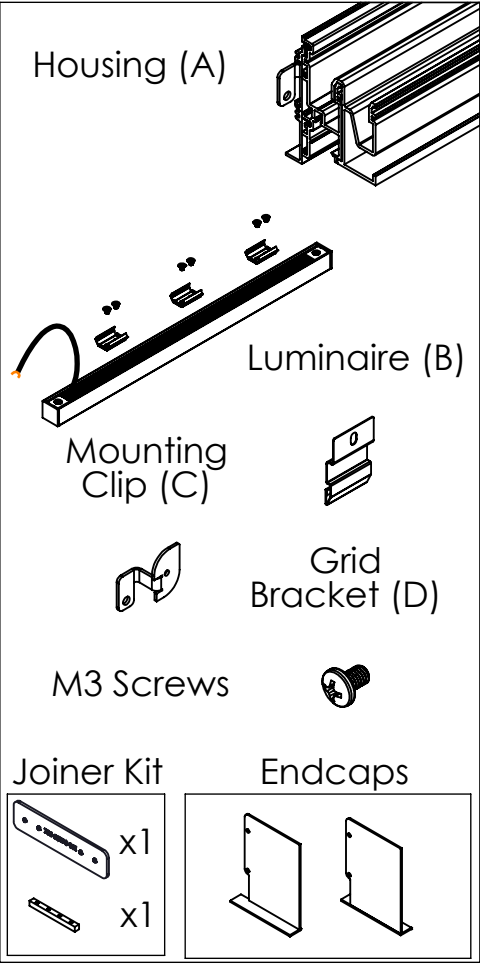

ITEMS NEEDED (SUPPLIED BY OTHERS):

- Phillips Head #2 Screwdriver
- Wire Connectors
- Wire Strippers
- M3 Hex head Allen Key
- Mounting Screws

INSTALLATION INSTRUCTIONS

LOCATE AND REVIEW ANY CONSTRUCTION PLANS AND INTERLUX RECORD DRAWINGS FOR ALL FIXTURE RUNS.
It is recommended to locate and lay out all components for each fixture "run". A fixture run typically consist of joiners, lengths of housings, lengths of inserts, and endcaps.
BE SURE TO IDENTIFY ALL CORRECT LENGTHS FOR EACH FIXTURE RUN.

Step 1; Mounting Clips: **Turn off Power before Installing.** Mark the wall at the intended height of the Mounting Clips (C), 3 - 1/4" above the bottom of the intended ceiling. Then screw Mounting Clips (C) into the wall, it is recommended you use appropriate backing or drywall anchors. The surrounding structure is required to support the weight of the fixture (1 - 1/2 lb per foot). Use at least one Clip every 16", for each Housing (A) Length. For shorter Housings (A), must use at least 2 Clips per Housing (A), 3 recommended. No Clip should be within 3" from the ends of any Housing (A).

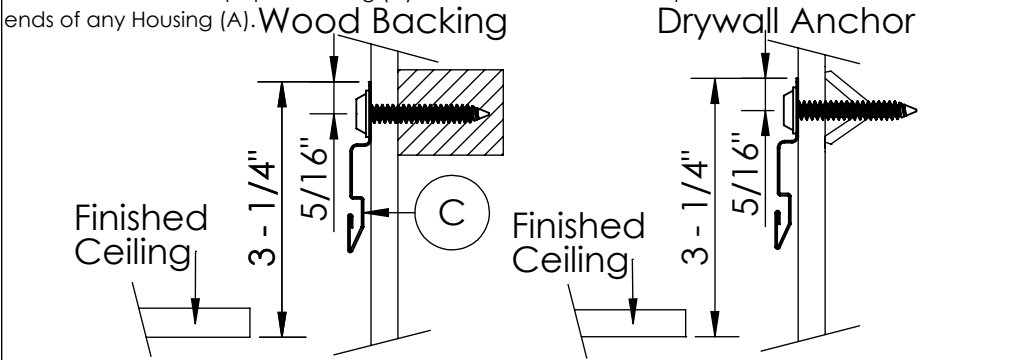

Step 2; Feed Holes: Determine which end the Luminaire (B) cables will start at on each Housing (A) and mark them on the shown location on the Housings (A), no less than 3 inches from the end. Then drill 1/4" holes where you marked. Finally look at where the Housings (A) will be installed and drill 1/4" holes above the line of the Mounting Clips, and close to where the holes in the Housings (A) will end up.

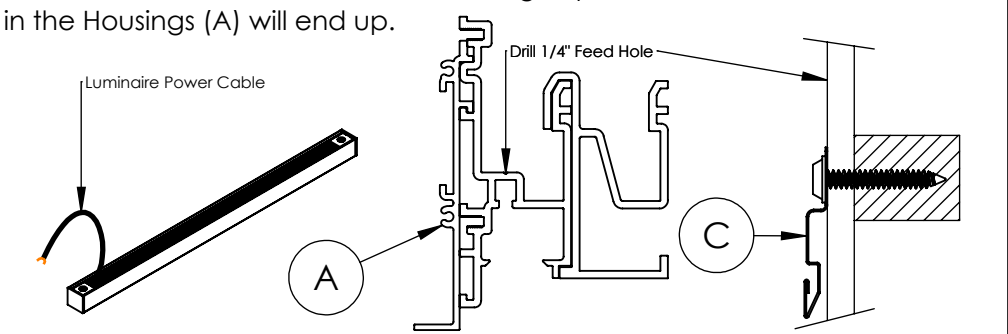

Step 3; Remote Drivers: Install the Remote drivers and run Low voltage cables to the wall. Then run the Low voltage cables through the feed holes drilled above the Mounting Clips (C).

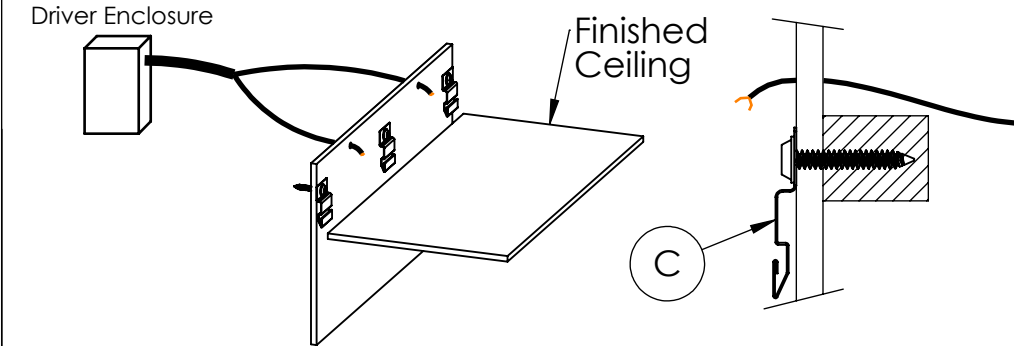

Step 4; Mounting Hardware: Install Endcaps on first and last Housing (A) of each run. Insert two T - grid Brackets (D) and Joiners on each Housing (A). T - grid Brackets (D) should be positioned equally spaced from ends of Housing (A), and fastened with provided set screws. Then install Snap-in clips on Luminaires (B) using provided screws.

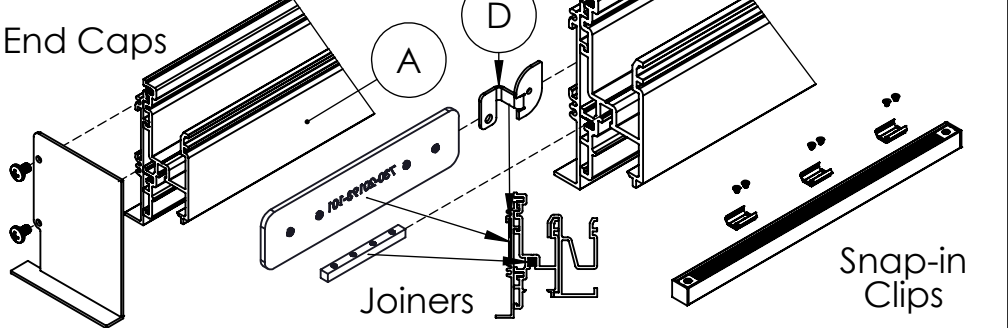

Step 5; Install Housing: Ensure all Low voltage cables are pulled through the wall and accessible. Check that Housings (A) and Luminaires (B) have correct End caps and Joiners installed. Then push the Housing (A) up until it engages with the Mounting Clips (C). Repeat until all Housings (A) are installed. Next slide all joiners (example below) halfway in between each Housing (A) and tighten the set screws. Run Low voltage cables through Housing (A) feed holes. Finally make electrical connections to Luminaire (B) cables with supplied connectors.

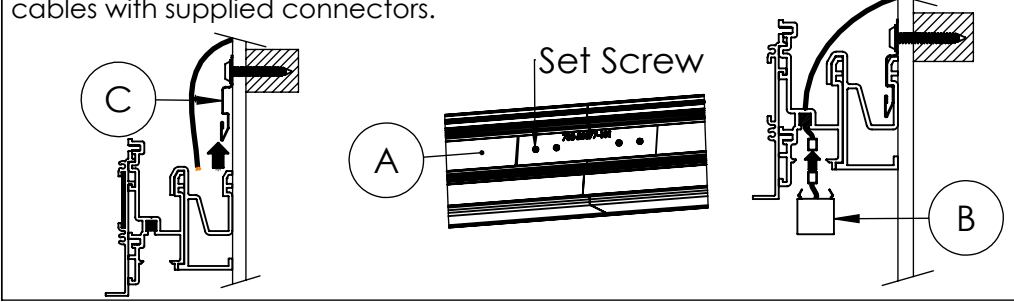

Step 6; Install Luminaire: Push the Luminaires (B) up until they snap into the Housings (A). When the ceiling and grid is installed, it will need to end 2 - 3/4" from the the wall (as shown below) to accomodate the Housings (A). Then fold the Grid Bracket (D) over the T - grid and drive a screw through them both (recommended Phillips #8-32 x 3/8"). Finally power the Luminaires (B) to double check electrical connections.

