

20 Linear Recessed Flush

- Miniature, fully recessed line of light.
- Trimless and bezel trim for all types of hard ceilings.
- Seamless integration into any drywall, wood and metal surfaces.
- Straight runs and configurations with factory corners in exact lengths as specified.
- Multiple distribution options.
- 90+ CRI, 3 Steps MacAdam delivering excellent color rendering.
- Choice of White, RGBW and Warm Dim to emulate incandescent.
- Identical LED technology used throughout all Whitegoods Linears, Coves and Perimeter products deliver consistent quality and performance throughout a project.
- Made in USA.
- 5-year warranty.

Housing	Precision extruded aluminum for true dimensions and tolerances Integration into any ceiling type All low voltage connections made in the housing Luminaires snaps into the housing without tools Finishes: white, black, silver and custom
Integration	Fixation into gypsum, hard ceilings and all grid ceiling types
Distribution	Multiple lenses and louvers for general, accent, decorative and grazing applications
LED	Constant Voltage, 90+ CRI, 3 Steps MacAdam 120 nominal lumens/watt average (see spec sheet for delivered lumens) Conformal coated for protection against humidity optional (-WL) Warm Dim to emulate incandescent when dimming; 75 nominal lumens per watt average RGBW for color changing applications; 50 nominal lumens per watt average L70 (TM21 Projected 85C) Static White = 60,000 hours RGBW = 50,000 hours, WD = 36,000 hours
Lens	OD - Opal Diffuser provides even, continuous line of light and general illumination MPL - Micro-prismatic lens provides lower brightness, general illumination NL16 - Narrow Lens optic provides narrow beam for wall grazing applications LL45 - 45 Degree Louver in white, black and satin provides extreme low brightness BD - Block Diffuser of satin acrylic provides general illumination and decorative effect
Weight	2lbs per foot
Operating Temp	Suitable for operation in maximum ambient temperature of 35C (95F)
Warranty	5-year Limited (see complete company warranty information)
Certifications	ETL and ETL-C for dry and damp location, CE
Voltages	24V Fixture / 120-277VAC Driver (remote)

Lenses/Accessories

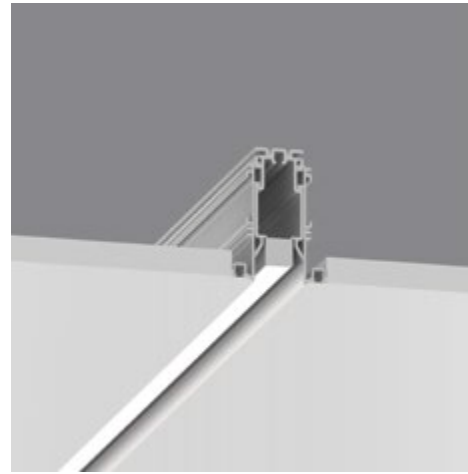
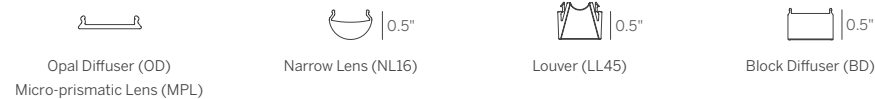

Recessed Plaster Trim (RPT)

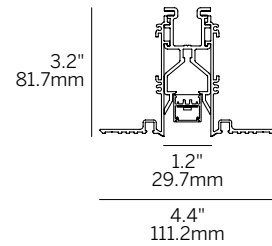

Recessed Plaster Trim (RPT)

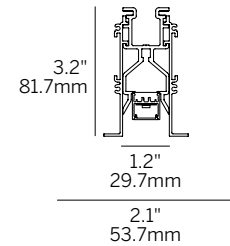

Recessed Bezel Trim (RBT)
Recessed Grid Trim (RGT9/
RGT15)

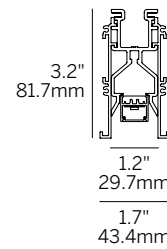

Recessed Return Trim (RRT)

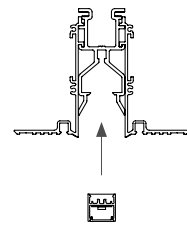

20 Linear Recessed Flush

Model	Fixation	Pattern	Length	Power ²	CRI/ CCT ³	Driver ⁴	Lens	Finish ⁷	Options
WG-20LRF	RPT RBT RRT RGT9 RGT15	S P ¹	A A x B A x B x C A x B x A x B	L M H	927 930 935 940 WD RGBW	X S D010 L3DAE L3DOE DFPN EL96 DMX	OD (std) MPL NL16 LL45B ⁵ LL45W ⁵ LL45S ⁵ BD ⁶	W (std) B S F	BEC FEC PEC EM WL ⁸

Model

- WG-20LRF = 20 Linear Recessed Flush

Fixation

- RPT = Recessed plaster trim
- RBT = Recessed bezel trim
- RRT = Recessed return trim
- RGT9 = Recessed grid trim 9/16"
- RGT15 = Recessed grid trim 15/16"

Pattern

- S = Straight run
- P = Standard patterns 2, 3 or 4 sided with 90° corners on the same plane¹

Length

- A, B, C = specify inches to the nearest 0.25" (i.e. 72.25")
For patterns specify each length (i.e. 2 sided: A x B = 72.25" x 48"; 3 sided: A x B x C; 4 sided: A x B x A x B)
- For 2 and 4 foot fixtures to fit ceiling grids specify 24" and 48" lengths

Power²

- L = 3W/ft low power (WD 2.7 W/ft) (24V)
- M = 6W/ft mid power (WD 5.5 W/ft) (24V) (RGBW - 7.6 W/ft)
- H = 10W/ft high power (WD 8 W/ft) (24V)

CRI/CCT (90+ CRI)³

- 927 = 2700K
- 930 = 3000K
- 935 = 3500K
- 940 = 4000K
- WD = Warm Dimming 1800 - 3000K
- RGBW = 3000K White (M power only)

Driver (remote)⁴

- X = No driver, ordered separately
- S = Standard, non-dim driver 120-277V
- D010 = Osram, 10%, 0-10V dimming, 120-277V
- L3DAE = Lutron Hi-lume 1% EcoSystem, 120-277V
- L3DOE = Lutron Hi-lume Premier 0.1% EcoSystem, 120-277V
- DFPN = Lutron Forward Phase 1%, 120VAC
- EL96 = Osram / EldoLED, 24V, 0.1% 0-10V Dimming
- DMX = Osram / EldoLED, 24V, 0.1% DMX Dimming

Lens

- OD = Satin opal diffuser (standard)
- MPL = Micro-prismatic lens
- NL16 = Linear narrow lens, 16°
- LL45B = Linear louver black⁵
- LL45W = Linear louver white⁵
- LL45S = Linear louver satin⁵
- BD = Block diffuser⁶

Finish⁷

- W = White, 15% gloss, Tiger Drylac 49/11350 (standard)
- B = Black, 15% gloss, Tiger Drylac 44/90053
- S = Silver, 15% gloss, Tiger Drylac 49/90500
- F = Custom finished trim, specify RAL

Options

- BEC = Bezel end caps
- FEC = Flat end caps
- PEC = Plaster-in end caps
- EM = Emergency (remote)
- WL = Wet Location Under Canopy / Cover⁸

Whitegoods reserves the right to change any information without prior notice.

Notes

- 1 See pattern spec sheet.
- 2 Wattage shown is for LED boards only, system wattage varies depending on driver selected.
- 3 See spec page for delivered lumens.
- 4 Remote power supply required. See power supply page for details.
- 5 Louver available in 4.75" increments.
- 6 Butt seam (lens) when in continuous run, straight runs only.
- 7 See Tiger Drylac color chart: inter-lux.com/tiger
- 8 Wet Location option available for OD / MPL lenses and recessed / surface ceiling applications only.