

20 Linear Perimeter Flush Lens

A perimeter pocket system with flush mounted light source for continuous illumination of adjacent surfaces, available in any dimension to fully integrate with the architecture

- Continuous, evenly illuminated snap-in lens without visible LED pattern.
- Continuous mounting to any desired length (within 1/4").
- Standard Opal Diffuser for even illumination and no LED appearance.
- Remote driver options.
- Field replaceable LED boards.
- 90+ CRI, 3 Steps MacAdam delivering excellent color rendering.
- Lengths and angles factory cut to exact field dimensions.
- Standard and custom corners.
- Made in the USA.

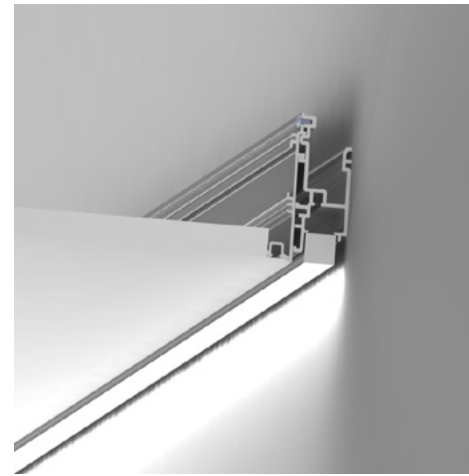

Plaster Trim

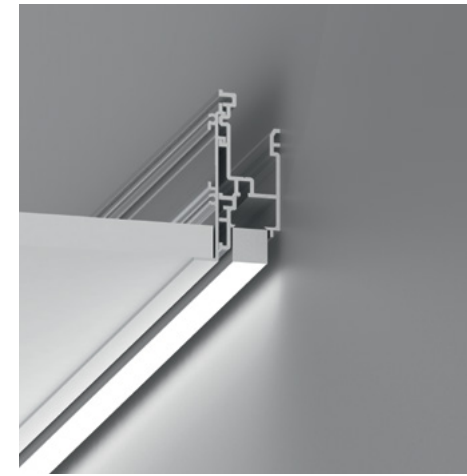

Bezel Trim

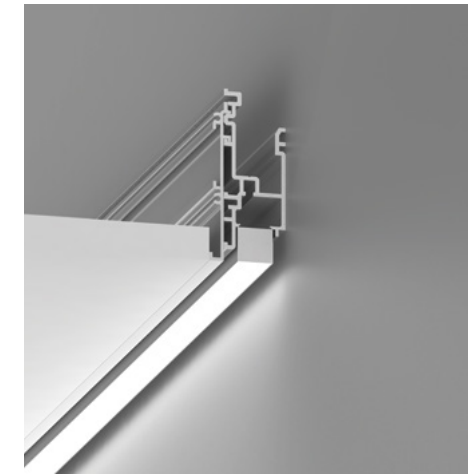

Return Trim

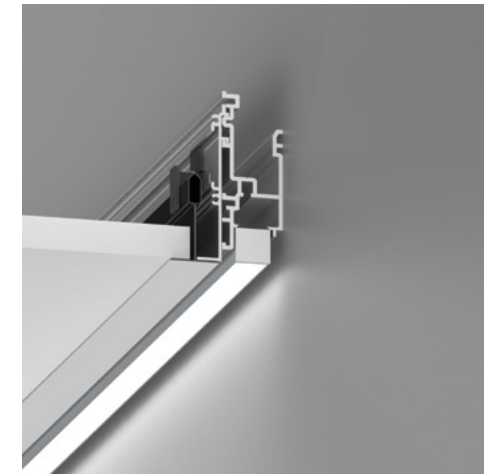

Grid Trim

Housing Precision extruded aluminum for true dimensions and tolerances
 Wall mounted spring steel clips to securely fasten the housing to the wall
 Housing provided in any exact length
 Snap-in LED fixture; easy installation and maintenance
 Corners: standard and non-standard
 Finishes: RAL 9010 white 15% gloss

Integration Wall mounted spring steel clips to securely fasten the housing to the wall
 Compatible with any ceiling type

Distribution Continuous even illumination using an opal lens for homogeneous lens appearance, or satin diffuser for higher efficiency and minimal LED image

LED >90 CRI, 3-Step MacAdam, 2700-4000K white
 3W - 10W per foot, 120 Lumens/watt average
 RA 91-94 (2700K - 4000K)
 Conformal coated for protection against humidity standard

Driver Remote driver
 Compatible with quality constant voltage drivers

Connectivity POE

Weight 2lbs per foot

Operating Temp Suitable for operation in maximum ambient temperature of 35C (95F)

Warranty 5-year Limited (see complete company warranty information)

Certifications ETL and ETL-C for dry and damp location, CE

Voltages 120-277VAC, 347VAC

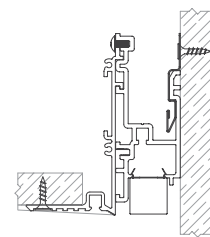
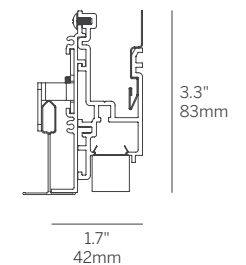
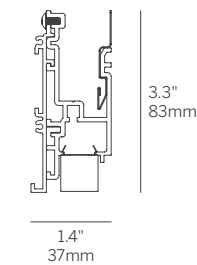
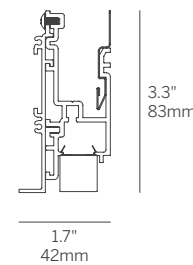
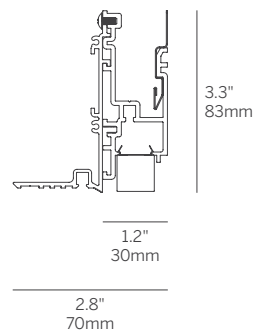

Gypsum Ceiling Mounting

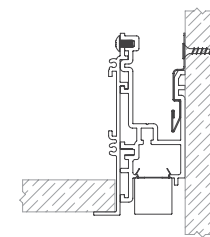

Solid Ceiling Mounting

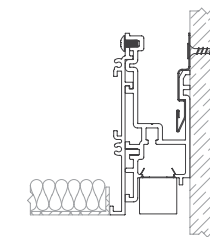

Metal Ceiling Tile Mounting

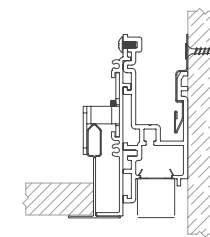

Grid Ceiling Tile Mounting

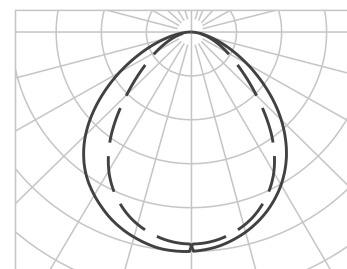

Polar Plot*

| Efficiency | Power (W/FT) | | | |
|------------|--------------|------|-------|------|
| | L 3W | M 6W | H 10W | |
| CCT | 2700K | 332 | 665 | 1108 |
| | 3000K | 332 | 665 | 1108 |
| | 3500K | 339 | 678 | 1130 |
| | 4000K | 339 | 678 | 1130 |

Lumens per foot*

Soft Graze (SG)

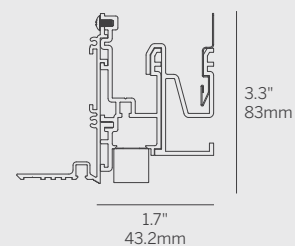

Plaster Trim (RPT)

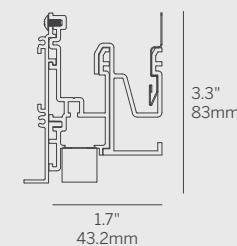

Bezel Trim (RBT)

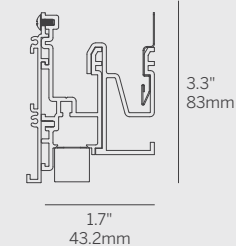

Bezel Return Trim (RRT)

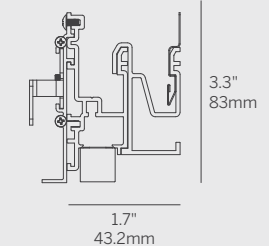

Grid Trim (RGT9, RGT15)

technical information

20 Linear Perimeter Flush Lens

| Model | Soft Graze | Fixation | Pattern ¹ | Length | Power ² | CRI/ CCT ³ | Driver ⁴ | Lens | Finish | Options |
|----------|---------------|------------------------------------|----------------------|--|--------------------|--------------------------|--|----------------|------------------------|-------------------|
| WG-20LPF | SG (optional) | RPT RBT RRT RGT9 RGT15 | S P | A A x B A x B x C A x B x A x B | L M H | 927 930 935 940 | X S D010 L3DAE L3DOE DFPN | OD (std) SD | W (std) B G F | BEC FEC PEC |

Model

- WG-20LPF = 20 Linear Perimeter Flush Lens

Soft Graze

- SG = *Soft Graze*, extends the luminaire an additional 0.5" from the wall to soften the effect (optional)

Fixation

- RPT = Recessed plaster trim
- RBT = Recessed bezel trim
- RRT = Recessed return trim
- RGT9 = Recessed grid trim 9/16"
- RGT15 = Recessed grid trim 15/16"

Pattern¹

- S = Straight run
- P = Standard patterns 2, 3 or 4 sided with 90° corners on the same plane.

Length

- A, B, C = specify inches to the nearest 0.25" (i.e. 72.25")
For patterns specify each length (i.e. 2 sided: A x B = 72.25" x 48"; 3 sided: A x B x C; 4 sided: A x B x A x B)

Power²

- L = 3W/ft low power (24V)
- M = 6W/ft mid power (24V)
- H = 10W/ft high power (24V)

CCT / CRI³

90+ CRI minimum (Low/Mid/High)

- 927 = 2700K, (332/665/1108 lm/ft)
- 930 = 3000K, (332/665/1108 lm/ft)
- 935 = 3500K, (339/678/1130 lm/ft)
- 940 = 4000K, (339/678/1130 lm/ft)

Whitegoods reserves the right to change any information without prior notice.

Notes

- 1 See pattern specs sheet.
- 2 Wattage shown does not include power supplies/drivers.
- 3 Delivered lumens with satin clear diffuser shown.
- 4 Remote drivers required. See power supply page for details.

Driver (remote)⁴

- X = No driver
- S = Standard driver, 120-277V
- D010 = 10%, 0-10V dimming, 120-277V
- L3DAE = Lutron Hi-lume 1% EcoSystem, 120-277V
- L3DOE = Lutron Hi-lume Premier 0.1% EcoSystem, 120-277V
- DFPN = Lutron Forward Phase 1%, 120VAC

Lens

- OD = Satin opal diffuser (standard) (SG only)
- SD = Satin clear diffuser (high efficiency)

Finish

- W = White, 15% gloss, RAL9010 (standard)
- B = Black, 15% gloss
- G = Gray, 15% gloss
- F = Custom finish, specify RAL

Options

- BEC = Bezel end caps
- FEC = Flat end caps
- PEC = Plaster-in end caps

Emergency Remote Only

- Emergency LED battery backup available, order separately.



technical
information