

COLOUR	CODE 3,3ft	CODE 16,5ft	lm/ft* LM80
2500K	E98347	E98348	249

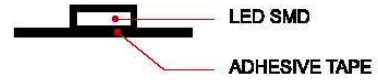

Dimensions

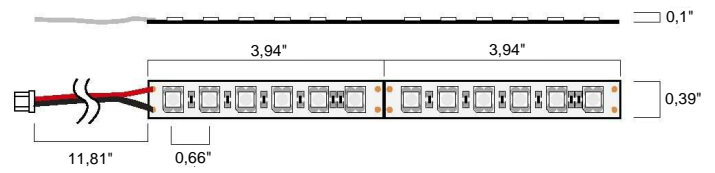

REEL N° LEDS	300 (18leds/ft)
REEL	196,9"x0,39"x0,1"
VOLTAGE	22-24VDC
POWER	72W (4,39W/ft)
CURRENT	3A (0,18A/ft)
TEMPERATURE	-20 / +40 °C
LASTING	30.000h
MAX CONTINUOUS LENGHT	16,40ft
CRI (COLOR RENDERING INDEX)	70



Finishes

Product Description

StripLed is composed of 18 Leds/ft integrated in a flexible circuit. Easily adaptable in every type of application and can be cut in 6 Led (3,94") unit without damaging the rest of the module. The maximum continue Length is 49ft (roll).

LED White :
2500K

Color LED :
-

Optic :
-

LED RGB :
-

Optic :
-

Applications

Only for indoor use (IP20), perfect for perimetral areas, for exalt stairs, architectural pourposes, false-ceiling, furniture and decorative interior lighting.

Power Led:
LED-Rebel SMD CRI70

Resin: No
 Cable type included: Yes, 11,81" 2X19AWG
 Connector type: Female quick connector
 Input (V - mA) : see tab.
 Nominal power (W): see tab.
 Real power (W): -
 Life article: 30000 hr
 Temperature on the surface of the glass: -
 Adjustability: No
 Drive over: No
 Glow Wire: -
 Power supply: Remote
 Insulation class: Class 2
 IP 20
 IK -
 Weigh: -
 Volume: -

Luminous flux

*Value of the luminous flux from the LED data sheet.



Installation

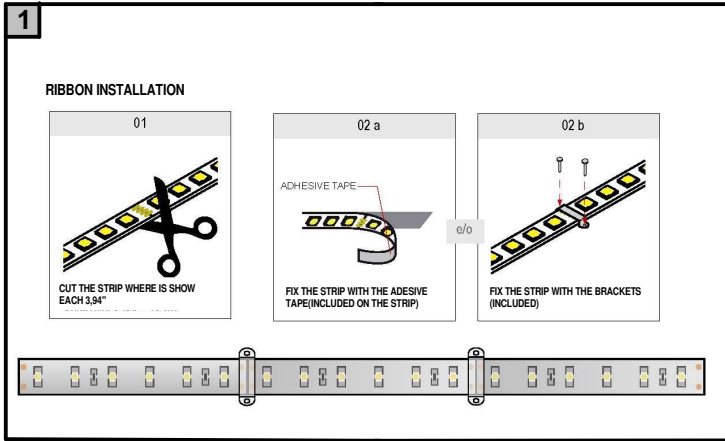

THIS PRODUCT MUST BE INSTALLED IN ACCORDANCE WITH THE APPLICABLE INSTALLATION CODE BY A PERSON FAMILIAR WITH THE CONSTRUCTION AND OPERATION OF THE PRODUCT AND THE HAZARDS INVOLVED

READ ALL OF THESE INSTRUCTIONS BEFORE INSTALLING FIXTURES

- Keep all of the instructions for future reference
- Turn off power before installing fixture
- Installation is to be performed by a qualified electrician only
- All installations must conform to the National Electrical Code as well as all local jurisdictional codes and regulations
- Any modification of the luminaire will void any and all written or implied warranties
- The manufacture accepts no responsibility for damage to persons or property arising through improper use or installation

INSTALLATION SEQUENCE

- Mount remote driver in accessible well ventilated space
- Ensure power is off before connecting driver to line voltage
- Cut the strip to the desired length
- Fix the strip with the adhesive tape, and with the brackets
- Cut the secondary cable for remove the connector
- Connect secondary cable without the connector on the power supply
- **WARNING:** Be sure secondary wiring is connected to driver BEFORE energizing to avoid LED failure
- Energize the power line

Accessories

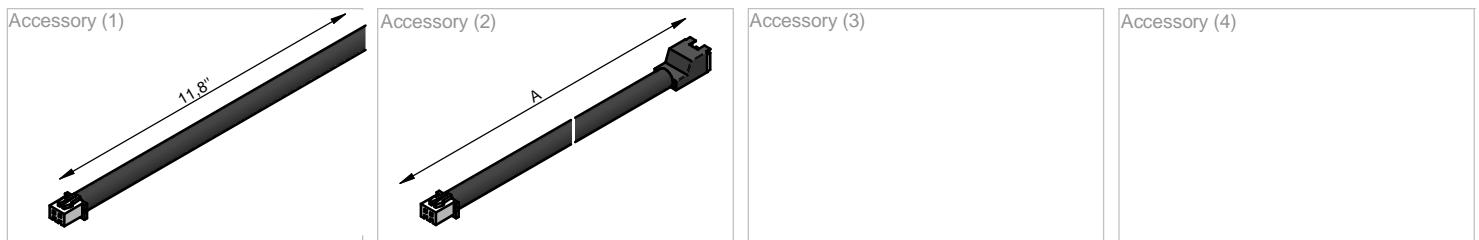

Accessory (1)
To wire the cutted part. Cable lenght 11,8" and female quick connector. Cod.E89121

Accessory (2)
Extension cable with male/female quick connectors lenght A=39,37". Cod.E89123
Extension cable with male/female quick connectors lenght A=118,11". Cod.E89125

Accessory (3)

Accessory (4)