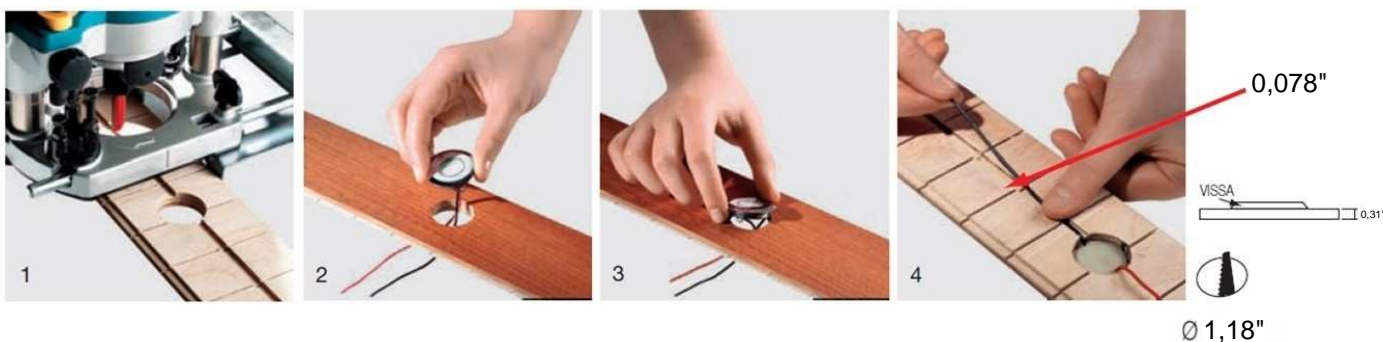
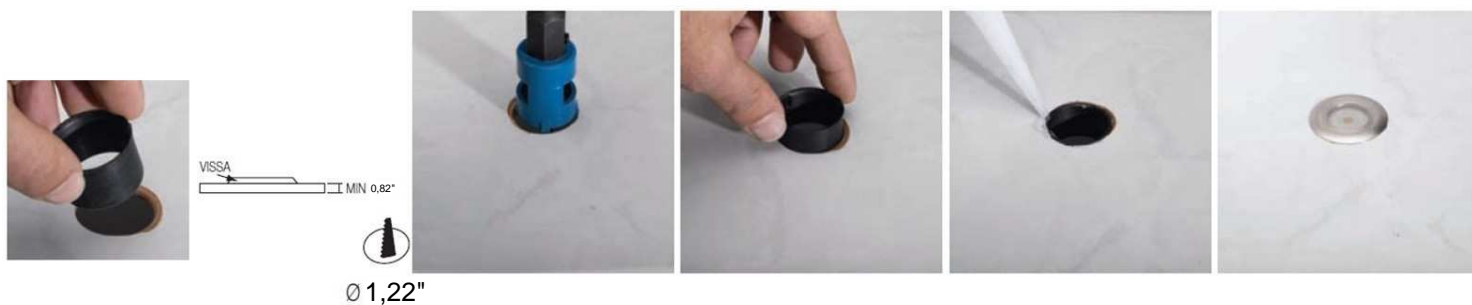
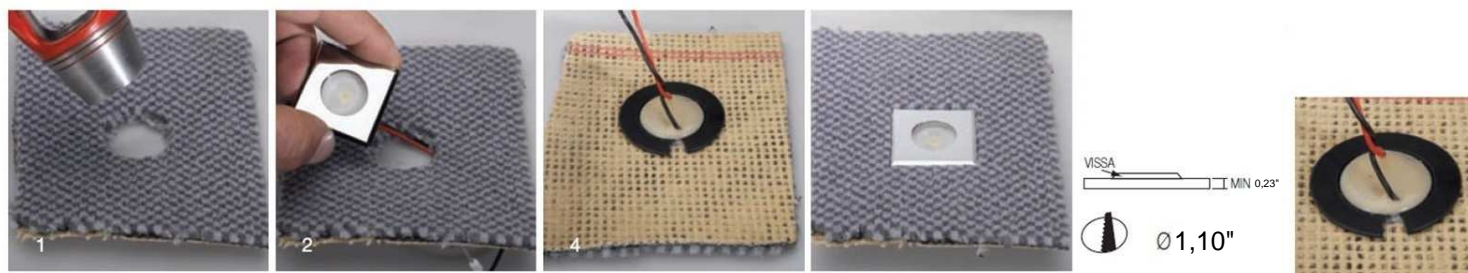
**Installation on wood without outercasing****Installation on the floor with outercasing cod. 84995****Installation on the carpet with outercasing cod. 84952**

THIS PRODUCT MUST BE INSTALLED IN ACCORDANCE WITH THE APPLICABLE INSTALLATION CODE BY A PERSON FAMILIAR WITH THE CONSTRUCTION AND OPERATION OF THE PRODUCT AND THE HAZARDS INVOLVED

MOUNTING INSTRUCTIONS

READ ALL OF THESE INSTRUCTIONS BEFORE INSTALLING FIXTURES

- Keep all of the instructions for future reference
- Turn off power before installing fixture
- Installation is to be performed by a qualified electrician only
- All installations must conform to the National Electrical Code as well as all local jurisdictional codes and regulations
- Any modification of the luminaire will void any and all written or implied warranties
- The manufacture accepts no responsibility for damage to persons or property arising through improper use or installation

INSTALLATION SEQUENCE ON THE WOOD WITHOUT OUTERCASING

- Mount remote driver in accessible well ventilated space
- Ensure power is off before connecting driver to line voltage
- Cut the correct opening size in the wood
- Connect secondary wiring to fixture wiring
- Insert the Vissa into the wood
- **WARNING** - Be sure secondary wiring is connected to driver **BEFORE** energizing to avoid LED failure
- Energize

INSTALLATION SEQUENCE ON THE FLOOR WITH OUTERCASING cod. 84995

- Mount remote driver in accessible well ventilated space
- Ensure power is off before connecting driver to line voltage
- Cut the correct opening size in the floor
- Insert the outercasing on the floor
- Apply plaster for flush installation of the outercasing
- Connect secondary wiring to fixture wiring
- Insert the Vissa into the outercasing
- **WARNING** - Be sure secondary wiring is connected to driver **BEFORE** energizing to avoid LED failure
- Energize

INSTALLATION SEQUENCE ON THE CARPET WITH OUTERCASING cod. 84952

- Mount remote driver in accessible well ventilated space
- Ensure power is off before connecting driver to line voltage
- Cut the correct opening size in the carpet
- Fix the outercasing on the carpet
- Connect secondary wiring to fixture wiring
- Insert the Vissa into the outercasing
- **WARNING** - Be sure secondary wiring is connected to driver **BEFORE** energizing to avoid LED failure
- Energize

WIRING SEQUENCE

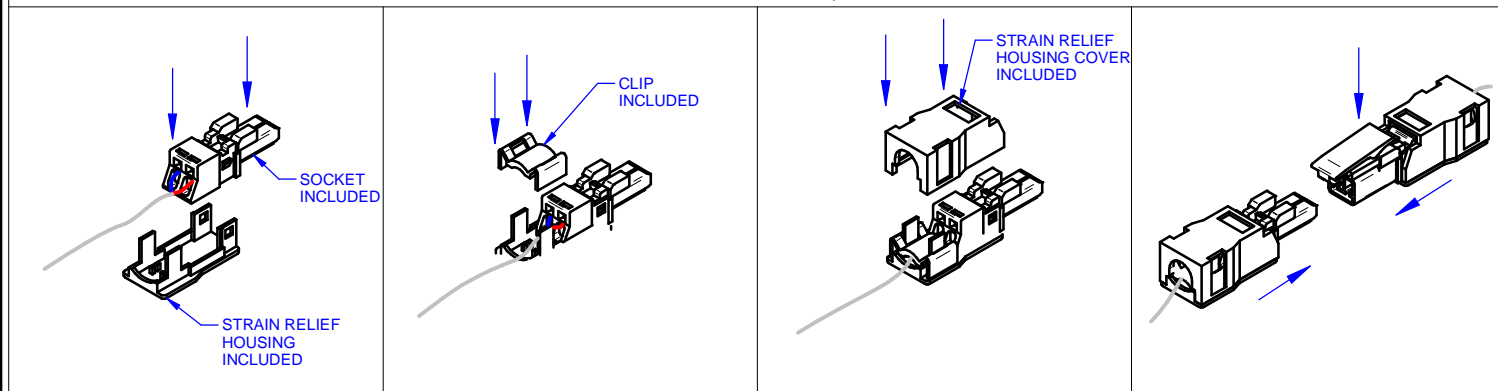

WIRING SEQUENCE

- Wire the cable on the socket
- Push the socket already wire on the strain relief housing
- Press the clip on the strain relief housing
- Push the strain relief housing cover on the strain relief housing
- Press the locking lever and connect the socket and the plug