



ORMA



SMALL

MEDIUM

LARGE

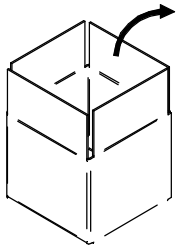

ORMA
ORMA_J
ORMA_L

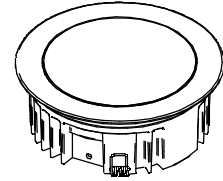
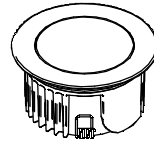

+

+

+

OUTER CASING

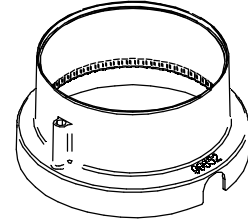
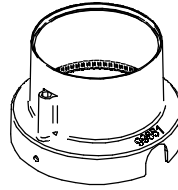
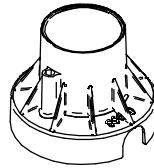

E99650

E99651

E99652

A

ORMA_F
ORMA_FJ
ORMA_FL

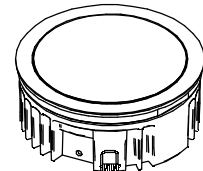
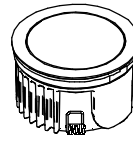
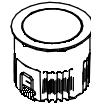

+

+

+

OUTER CASING

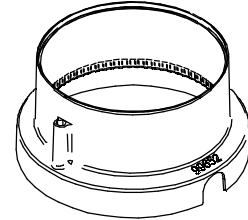
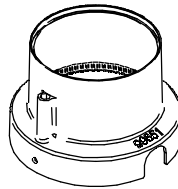
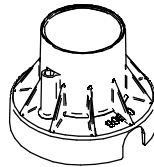

E99650

E99651

E99652

B

OR

OR

OR

OUTER CASING
WITH ANTI-VANDALISM
FLANGE

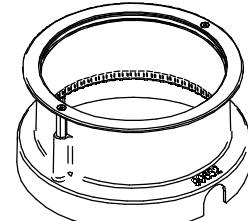
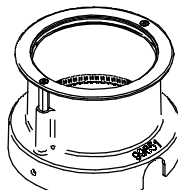
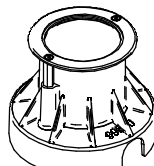

E99560

E99563

E99564

C



WARNING:

INSTALL PRODUCT IN ACCORDANCE WITH LOCAL AND NATIONAL ELECTRICAL CODES BY A QUALIFIED ELECTRICIAN



WARNING:

FAILURE TO COMPLY WITH THE INSTALLATION INSTRUCTIONS MAY RESULT IN DEATH OR SEVERE INJURY.



WARNING:

READ ALL SAFETY INSTRUCTIONS INCLUDED WITH LUMINAIRE BEFORE INSTALLING LUMINAIRE. SAVE INSTRUCTIONS FOR FUTURE USE.

CAUTION:

THIS IS AN ELECTRONIC DEVICE. CARE MUST BE TAKEN DURING STORAGE AND HANDLING. STORE IN A CLEAN, COOL AND DRY LOCATION. ELECTROSTATIC DISCHARGE (ESD) CAN HARM THIS PRODUCT. AVOID STATIC DISCHARGE WHILE HANDLING THIS PRODUCT.

CAUTION:

INTER-LUX IS NOT RESPONSIBLE FOR THE STRUCTURAL INTEGRITY OF THE BUILDING TO SUPPORT THE LUMINAIRE. ADDITIONAL BACKING MAY BE REQUIRED.

LOCATE AND REVIEW ANY CONSTRUCTION PLANS AND INTER-LUX RECORD DRAWINGS FOR ALL FIXTURE RUNS. IT IS RECOMMENDED TO LOCARE AND LAY OUT ALL COMPONENTS FOR EACH FIXTURE "RUN". A FIXTURE RUN TYPICALLY CONSISTS OF JOINERS, LENGTHS OF HOUSING, AND ENDCAPS. BE SURE TO IDENTIFY ALL CORRECT LENGTHS FOR EACH FIXTURE RUN.

INSTALLATION INSTRUCTIONS

OPTIC ORIENTATION (ONLY ORMA_J - ORMA_FJ)

1 REMOVE THE PROTECTION CAP

2 ROTATE THE PIN TO ADJUST THE TILTING

3 CLOSE THE PROTECTION CAP

PREPARATION FOR CONCRETE OUTERCASING

ART.		SMALL	MEDIUM	BIG
ORMA, ORMA_J, ORMA_L, ORMA_F, ORMA_FJ, ORMA_FL	L	3.82"	4.49"	6.06"
	H	3"		

A ORMA, ORMA_J, ORMA_L

A.1 PLACE THE OUTER CASING INTO THE OPENING AND FILL THE GAP WITH CONCRETE (DARK GREY ZONE IN THE DRAWING BELOW)

A.2 ONCE THE CONCRETE IS DRYED, MAKE THE WIRINGS AS SHOWN IN THE WIRING DIAGRAM, ROTATE THE SPRINGS AND INSERT THE FIXTURE INTO THE OUTER CASING

A.3 INSTALLATION COMPLETED

B ORMA_F, ORMA_FJ, ORMA_FL

B.1 PLACE THE OUTER CASING INTO THE OPENING AND FILL THE GAP WITH CONCRETE (DARK GREY ZONE IN THE DRAWING BELOW)

B.2 ONCE THE CONCRETE IS DRYED, MAKE THE WIRINGS AS SHOWN IN THE WIRING DIAGRAM, ROTATE THE SPRINGS AND INSERT THE FIXTURE INTO THE OUTER CASING

B.3 INSTALLATION COMPLETED

C ORMA_F, ORMA_FJ, ORMA_FL WITH ANTI-VANDALISM OUTER CASING

C.1 PLACE THE OUTER CASING INTO THE OPENING AND FILL THE GAP WITH CONCRETE (DARK GREY ZONE IN THE DRAWING BELOW). LET THE CONCRETE TO DRY.

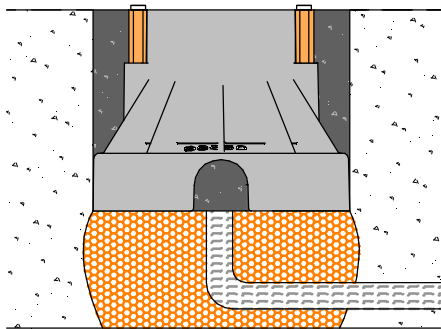

C.2 REMOVE THE SCREWS AND THE FRAME BEFORE THE INSTALLATION USING THE INCLUDED KEY. KEEP THE SCREWS TO REASSEMBLE THE FRAME

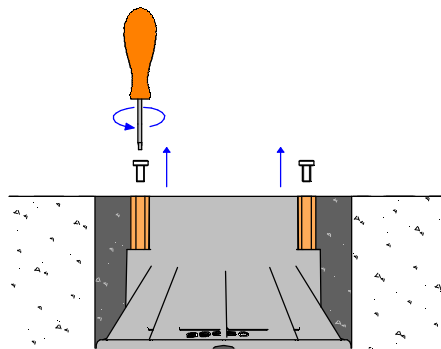

C.3 INSERT THE FIXTURE INTO THE FLANGE AND LOCK THE SNAP RING (INCLUDED) AS SHOWN TO SECURE THE FIXTURE TO THE FLANGE.

ORMA SMALL

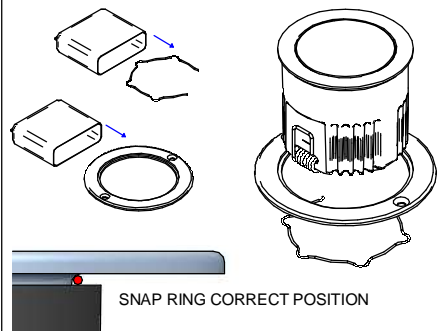

C.3 INSERT THE FIXTURE INTO THE FLANGE AND LOCK THE SNAP RING (INCLUDED) AS SHOWN TO SECURE THE FIXTURE TO THE FLANGE.

ORMA MEDIUM / BIG

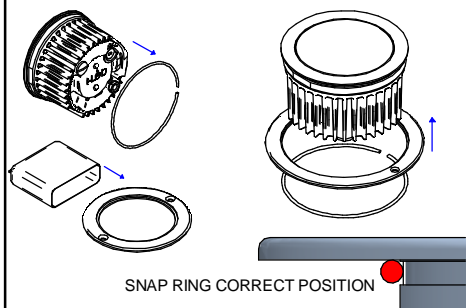

C.4 MAKE THE WIRINGS AS SHOWN IN THE WIRING DIAGRAM, ROTATE THE SPRINGS AND INSERT THE FIXTURE INTO THE OUTER CASING

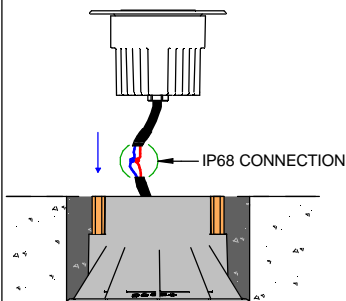

C.5 SECURE THE FLANGE WITH THE SCREWS TO COMPLETE THE INSTALLATION

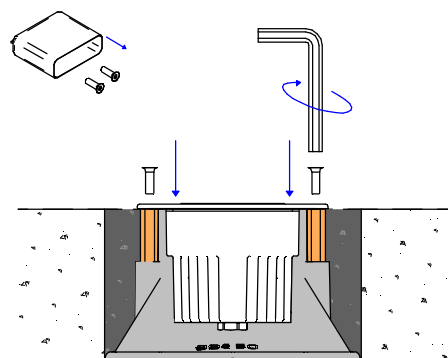

SPOTLIGHT REMOVAL FROM THE OUTERCASING

1 APPLY THE SUCTION CUP SUPPLIED WITH THE SPOTLIGHT

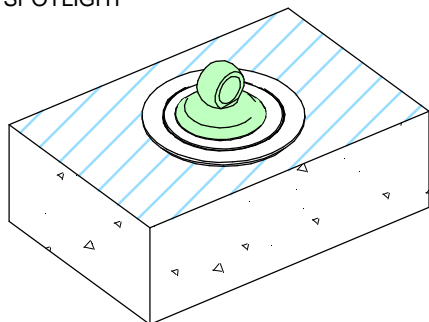

2 PULL UP

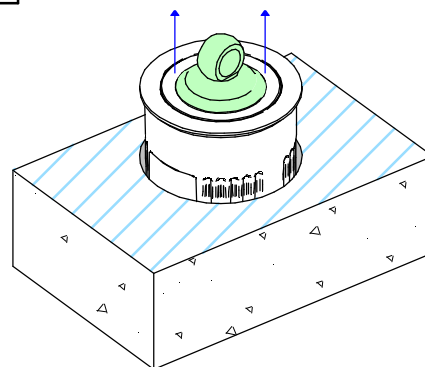

SPOTLIGHT REMOVAL FROM THE ANTI-VANDALISM OUTER CASING (ORMA_F - ORMA_FJ - ORMA_FL)

1 UNSCREW THE TWO SCREWS WITH USING THE SUPPLIED SPECIAL KEY

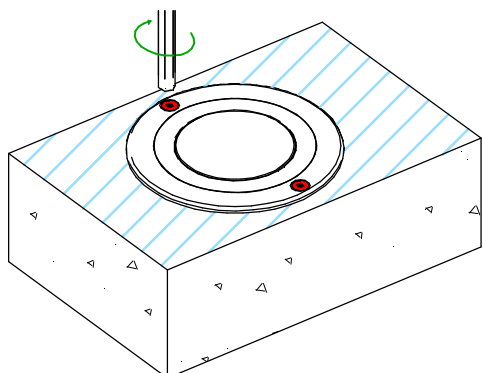

2 APPLY THE SUCTION CUP SUPPLIED WITH THE SPOTLIGHT

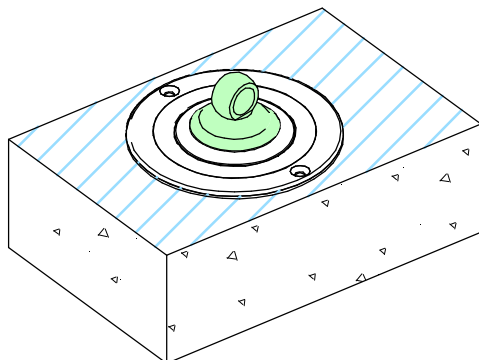

3 PULL UP

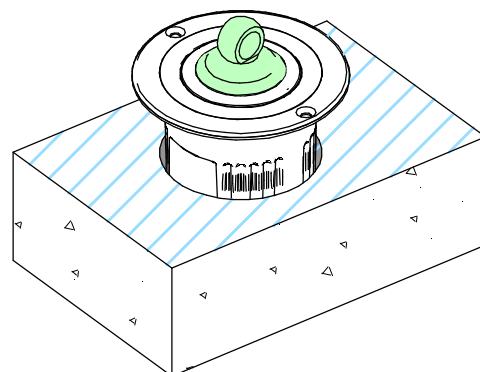

WIRING DIAGRAM

SINGLE ORMA FIXTURE

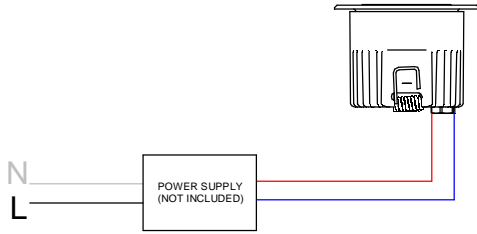

MULTIPLE ORMA FIXTURES WIRED IN SERIES (Constant Current)

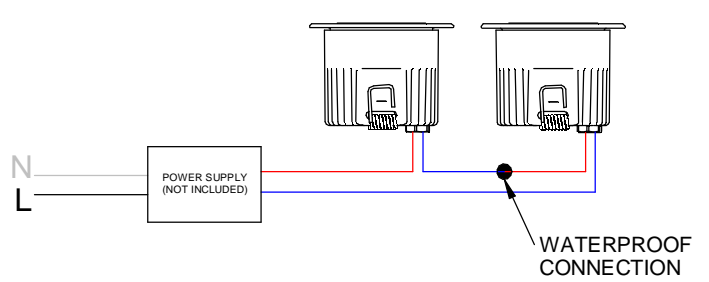

MULTIPLE ORMA FIXTURES WIRED IN PARALLEL (24V Constant Voltage)

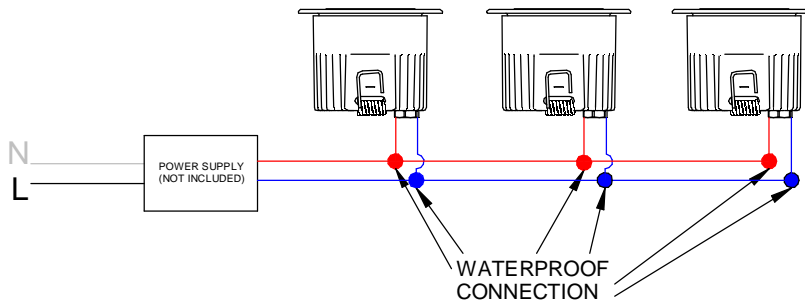

<i>Secondary Cable Colours</i>	<i>Pole</i>
Red wire	+
Blue wire	-

MULTIPLE ORMA RGBW FIXTURES WIRED IN SERIES (Constant Current)

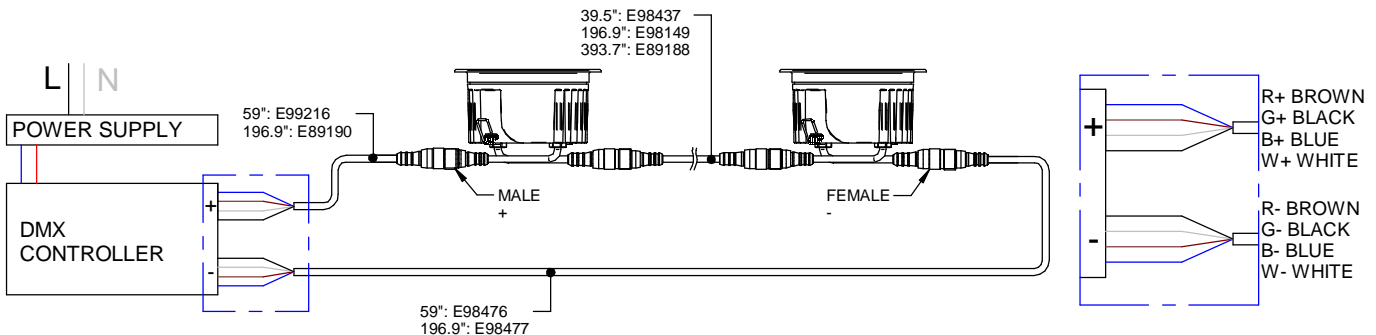

RGBW FIXTURES INCLUDE A 9.8" TAIL WITH MALE 4PIN M12 CONNECTOR AND A 9.8" TAIL WITH FEMALE 4PIN M12 CONNECTOR.

FEED CABLES (E99216/E89190/E98476/E98477) AND EXTENSION CABLES BETWEEN FIXTURES (E98437/E98149/E89188) ORDERED SEPARATELY.

THIS PRODUCT MUST BE INSTALLED IN ACCORDANCE WITH THE APPLICABLE INSTALLATION CODE BY A PERSON FAMILIAR WITH THE CONSTRUCTION AND OPERATION OF THE PRODUCT AND THE HAZARDS INVOLVED

MOUNTING INSTRUCTIONS

READ ALL OF THESE INSTRUCTIONS BEFORE INSTALLING FIXTURES

- CAUTION: USE ONLY WITH CLASS 2 POWER UNIT
- Keep all of the instructions for future reference
- Turn off power before installing fixture
- Installation is to be performed by a qualified electrician only
- All installations must conform to the National Electrical Code as well as all local jurisdictional codes and regulations
- Any modification of the luminaire will void any and all written or implied warranties
- The manufacture accepts no responsibility for damage to persons or property arising through improper use or installation