

Assembly instruction

06.11.2020

TOCCATA Ø 1550 / 1900 mm

Safety instructions:

The light fixture has to be installed only by qualified electricians. Qualified personnel are people which are familiar with the installation and implementing of the product, and which have special qualification. For example:

- Training as an electrical competent person or electro technical instructed person.
- Education or instruction in handling moderate safety equipment accordantly to the standard safety technique for electrical circuit.
- Education or instruction in first aid and accident prevention.



Dangers

- The supply line might be on voltage at installation time.
- Heavy injuries caused by electricity are possible.
- Before installation or dismounting check for de-energized supply line and light fixture.

Technical data:

Device sticker

Size:	Weight luminaire	Weight technical unit
Ø 1550-1240-700 mm	11 kg	ca. 5 kg
Ø 61.0-48.8-27.6"	24.2 lbs	approx. 11.0 lbs
Ø 1900-1550-1240-900-600 mm	14 kg	ca. 5 kg
Ø 74.8-61.0-48.8-35.4-23.6"	30.8 lbs	approx. 11.0 lbs

Standard:

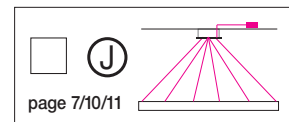

Ø 1550 mm / 61.0", 6 current-carrying steel cables with external power supply unit in suspended ceiling. **Optional:** Ø 1900 mm / 74.8" 14 current-carrying steel cables.

Standard:

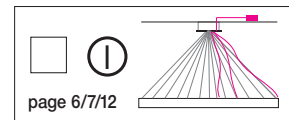

Ø 1900 mm / 74.8", 14 suspensions through canopy and 3 power supply cables with external power supply unit in suspended ceiling.

Optional:

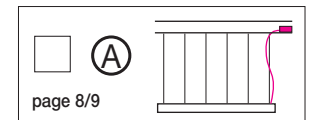

Ø 1550 mm / 61.0" / Ø 1900 mm / 74.8" 6 / 14 suspension with external power supply unit in suspended ceiling.

Scope of delivery

Package 1: Pendant light

<input checked="" type="checkbox"/>	Light fixture rings, pre-assembled ①	1 unit
<input type="checkbox"/>	Ø 1550 mm, 3 -parts, 6 Steel cables	
<input type="checkbox"/>	Ø 1900 mm, 5 -parts, 14 Steel cables	
<input checked="" type="checkbox"/>	Assembling aid ②	1 unit
	Supply line depending on type of installation ③	

Package 2: technical unit, canopy

<input type="checkbox"/>	Canopy incl. power supply unit ⑤	1 unit
<input type="checkbox"/>	External power supply unit ④	1 unit
<input checked="" type="checkbox"/>	rope spirit level premounted ⑥	1 unit
<input checked="" type="checkbox"/>	Gloves, white ⑦	1 pair
<input checked="" type="checkbox"/>	Screwdriver	1 unit
<input checked="" type="checkbox"/>	Assembly instruction	1 unit

Dimming

<input type="checkbox"/>	Not dimmable
<input type="checkbox"/>	DMX interface
<input type="checkbox"/>	Dimmer interface 0-10V
<input type="checkbox"/>	Dimmer interface 1-10V
<input type="checkbox"/>	DALI interface
<input type="checkbox"/>	LUTRON interface
<input type="checkbox"/>	Bluetooth interface
<input type="checkbox"/>	Enocean interface

Package 1

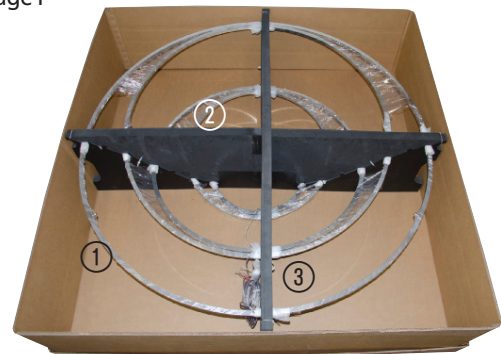

Package 2

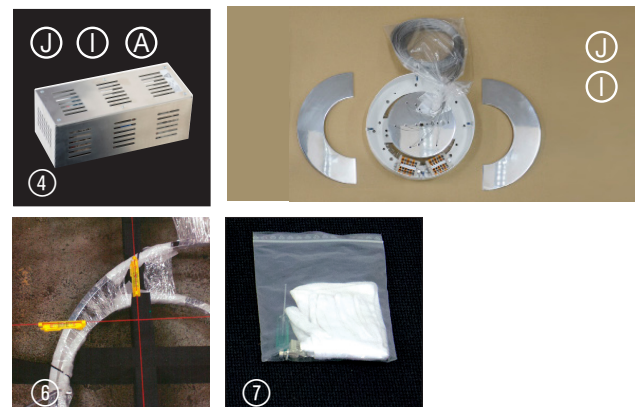

Assembly instruction

06.11.2020

TOCCATA Ø 1550 / 1900 mm

Warranty

Use the enclosed assembly instructions for the installation of the lighting fixture. Contravention of the assembly instruction leads to expiration of warranty.

The assigned installation team is briefed to handle the product carefully and reliably to prevent damage towards third parties. The present light fixture has been tested in combination with the appendant technical part for full operational functions.



TOCCATA 1900, Mounting version ①



TOCCATA 1550

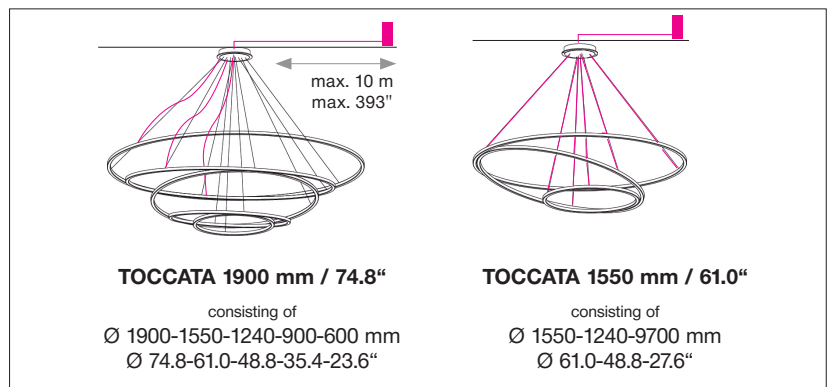

Delivery contains 2 packages

Unpack lamp and check for completeness according to parts list (page 1). Use the enclosed cloth gloves for mounting the lamp to avoid soiling polished surfaces and the opal diffuser. Do not remove the protective foil from the diffuser until after mounting the light.

IMPORTANT:

Do not remove the black (reusable) plastic mounting aid ② of the lamp at first.

TOCCATA Ø 900, 1550, 1900 mm

Attaching the spirit level

In order to facilitate the alignment of the TOCCATA lamp, two spirit levels are attached to the mounting aid, which should be mounted or tensioned as follows:

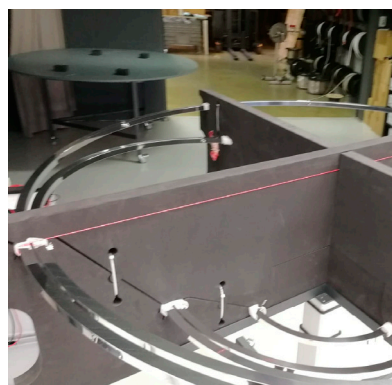
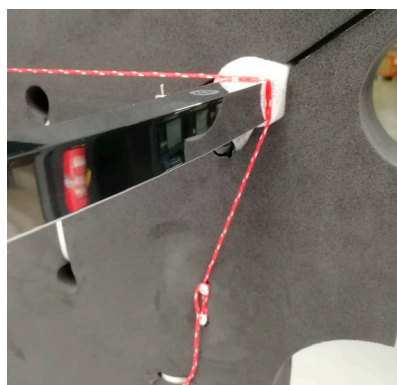
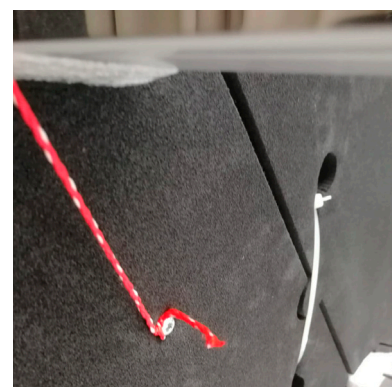
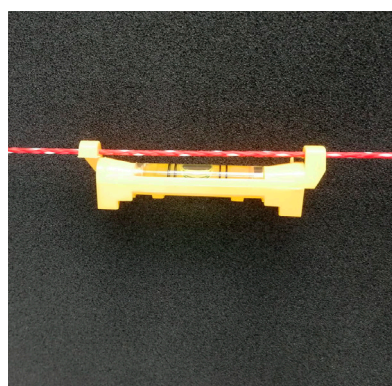
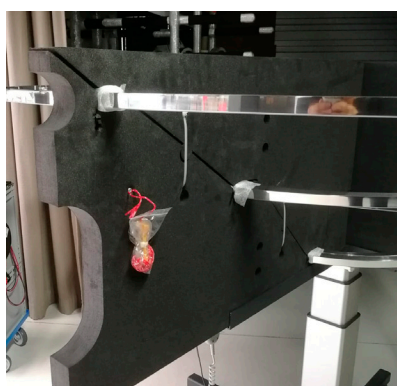

TOCCATA Ø 1550 / 1900 mm

**Fit the canopy**

Mark the mounting points of the canopy ⑤.

Pre-drill the mounting points for the canopy into the ceiling, using a Ø 6mm drill. Then insert the wall plugs and fasten with 4 screws. Please ensure the load capacity of the ceiling is sufficient.

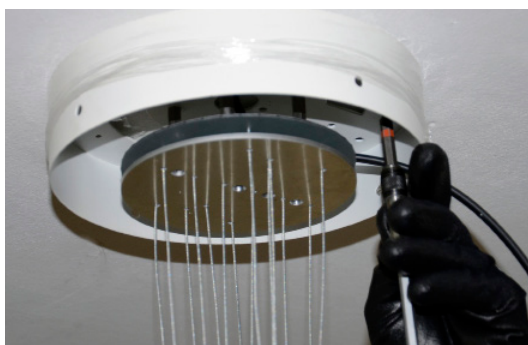
**Alignment of light fixture**

Align the cross-shaped plastic assembling aid ② so that it is parallel to the cables in the canopy ⑤.

**Mounting of the light fixture**

First, remove both upper parts of the plastic assembling aid by cutting the **white cable straps**.

Please do not yet remove the lower 2 assembling aids which are attached to the light fixture with **black cable straps**.

**Please note:**

The 4-part assembling aid ② provided is a resource-saving reusable element. Please send it back to us in the package provided in order to receive a refund.

TOCCATA Ø 1550 / 1900 mm

**Fastening the cord suspension**

Insert the lower ends of the steel cables into the cable holds which are pre-assembled and mounted on the light fixture. In order to do this, completely open the respective lock nut.

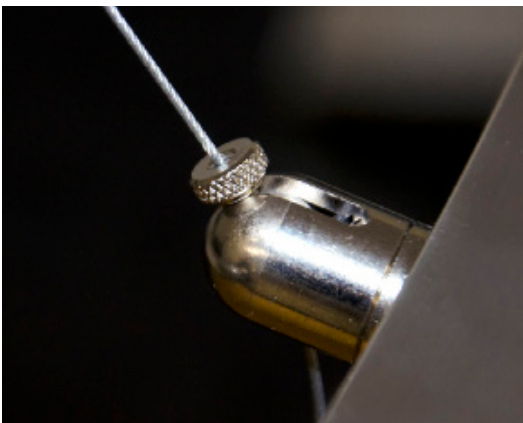

When mounting the 6/14 fastening cables to the light fixture rings, work from the outside towards the inside. The alignment of the light fixture according to the mounted ceiling plate is important here.

The light fixture ring can be moved up by applying slight pressure to the spring-loaded duct of the cable hold. As soon as the cable hold is fully loaded, it locks and cannot slide in any direction anymore.

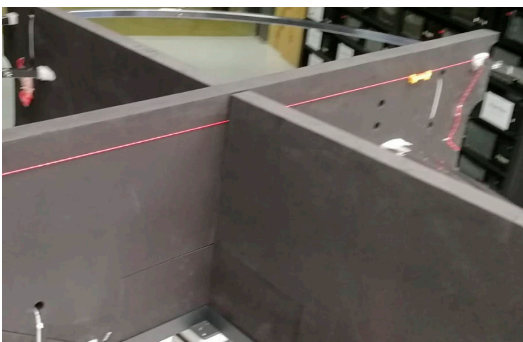
**Alignment of the light fixture**

For preliminary alignment, lift light fixture and tighten the steel cables, one after the other. Then, align the light fixture horizontally with the aid of a spirit level. In order to achieve this, it is necessary to re-adjust the cable holds of the respective rings several times. Once the light fixture has been aligned correctly, (the light fixture is still fastened to the assembling aid) tightly screw in the lock nuts of the cable holds by hand (without any tools!) and tighten them.

Advice:

The steel cable brackets are just for indoor use. Cables need to be flawless. The nozzle of the steel cable bracket must show noticeable spring loaded pressure. To ensure the full load capacity the cables shouldn't be greasy or rusty.

The steel cable brackets are just for use of supplied steel cables at static load.

TOCCATA Ø 1550 / 1900 mm

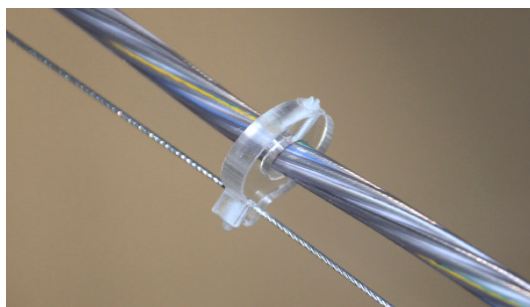

Connect the light fixture cables



Run the 3 light fixture cables alongside the respective steel cable up to the ceiling plate and fasten them to the cable with the pre-assembled cable brackets.

Connect the light fixture cable to the canopy according to the connection diagram. Afterwards, mount both covers to the ceiling plate.

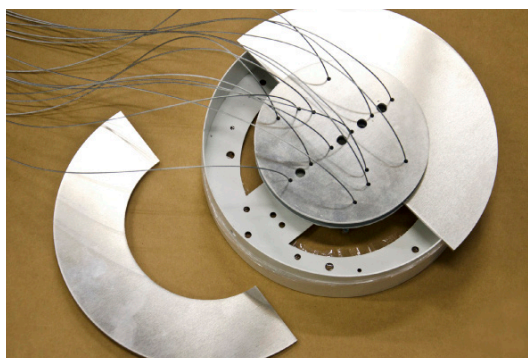

Now fully remove the assembling aid. ②

Connection of the operation unit according to the connection diagram on the following page.

Assembly instruction

06.11.2020

TOCCATA Ø 1550 / 1900 mm

Light fixture with canopy – Connection of the light fixture with current-carrying steel cables and separate technical unit



Mounting of the canopy



Make sure the ceiling has sufficient support capacity!

1. Fit the base of the canopy to the ceiling with the 4 mounting points. Ø Drill 6mm / 1/4" holes and anchor to fasten canopy to ceiling (see scale sketch on the left).
2. Connect the power supply and the control signal to the terminal block of the power supply unit (see wiring diagram J from page 10/11).

Connect the supply line of the power supply unit to the clamping point in the canopy.

Connection of the light fixture

3. Insert the 6 or 14 steel cables mounted on the canopy into the cable grippers premounted on the luminaire, bring the luminaire together with the mounting aid and rope spirit levels into the desired position and align them by applying slight pressure on the cable grippers ①.
5. Lock the cable grippers in place by use of the knurled screw.
6. Shorten excessive steel cables.



Consider the polarity of the current-carrying cables in accordance with the markings on the light fixture and the canopy.

Never adjust the suspension under pressure. The steel cables might get damaged.

Shortened cables can only be replaced by the factory!

6. Mount the canopy cover and fasten it.
7. Check whether the light fixture is functioning.

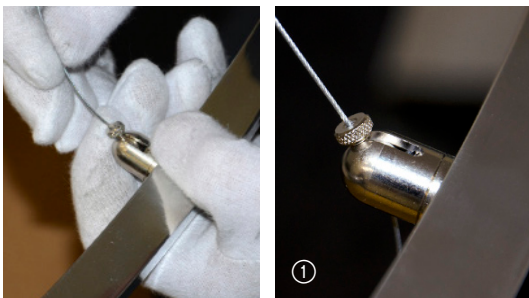
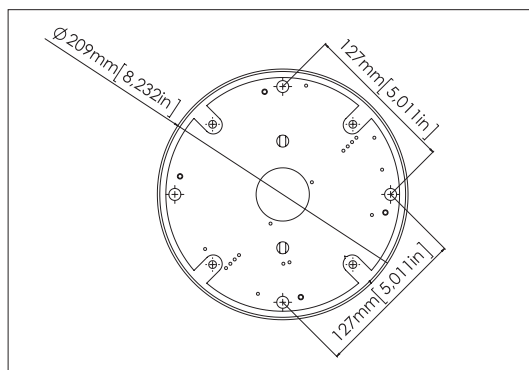
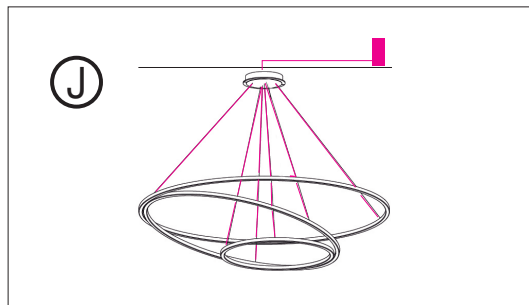

<p>max. 10m / 33 feet</p>	
<p>Power supply unit:</p> <p>Toccata Ø 1550</p> <p>DE 2F L/W/H 360 x 300 x 85 mm 14.2 x 11.8 x 3.3"</p>	<p>Toccata Ø 1900</p> <p>DE 3F L/W/H 360 x 400 x 85 mm 14.2 x 15.7 x 3.3"</p>

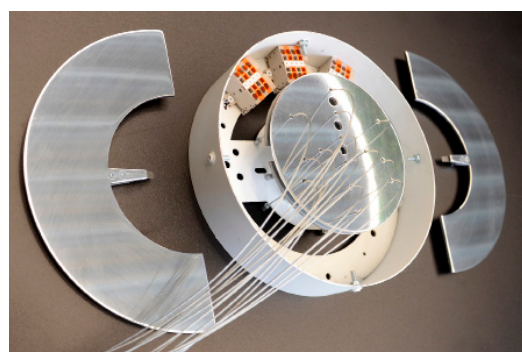

Baldachin mit vormontierten Seilen und Abdeckungen

Assembly instruction

06.11.2020

TOCCATA Ø 1550 / 1900 mm

Light fixture with steel cable suspension – Connection of the light fixture with external power supply unit

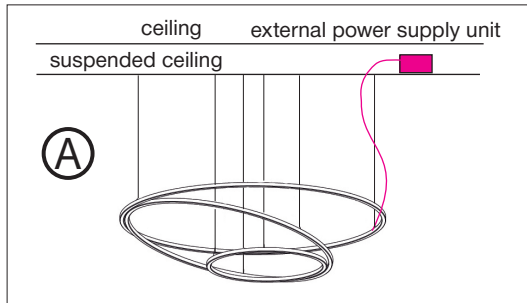

Mounting of the cable grippers, installation of the light fixture



Make sure the ceiling has sufficient load-carrying capacity!

1. Mark the 6 b/ 14 anchor positions of the light fixture on the ceiling.
2. Drill Ø 6mm / 1/4 holes, insert anchors and fasten steel cable holders, see pictures ① - ③ .



The steel cable grippers cannot be used for outdoor areas. Make sure cables are not damaged. Prior to mounting, the nozzle of the steel cable bracket has to have noticeable spring pressure. In order to ensure full suspension, the steel cables have to be clean and free from grease, oil and rust. The steel cable grippers can only be used in connection with the provided fixation cables for stationary and static loads, see picture ③.

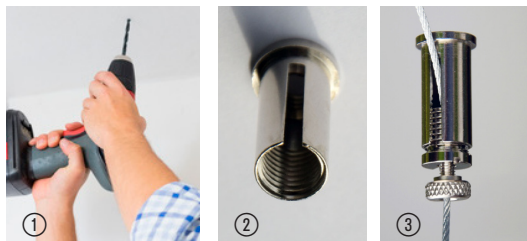

3. Insert the cables which have been pre-attached to the light fixture in the steel cable grippers.
4. bring the luminaire together with the mounting aid and rope spirit levels into the desired position and align them by applying slight pressure on the cable grippers ①.
5. If provided, lock the steel cable grippers in place by use of the insulated knurled screw.
6. Shorten excessive steel cables.



Shortened cables can only be replaced at the factory!



Assembly of the operating unit, connection to light fixture

Mount external power supply unit only in a dry and aerated place!

Power supply cable from the operating unit to the light fixture max. 10m / 33 feet

7. Open the housing of the operating unit by loosening the 4 screws.
8. Fasten operating unit sufficiently.
9. Connect primary connection and power supply cable of the light fixture according to the wiring diagram A from page 9, then fasten the housing of the operating unit again.
10. Check whether the light fixture is functioning.

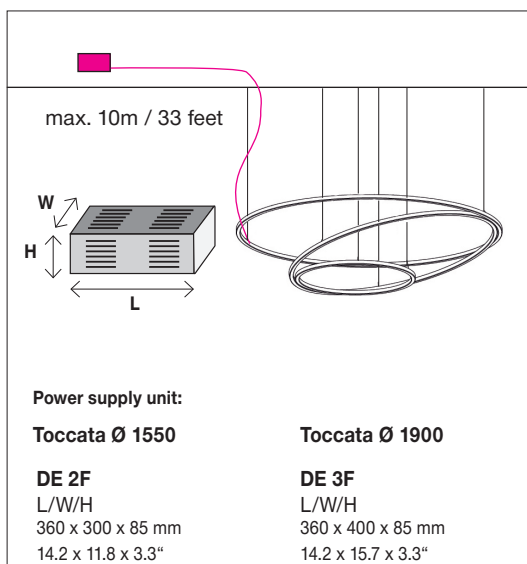
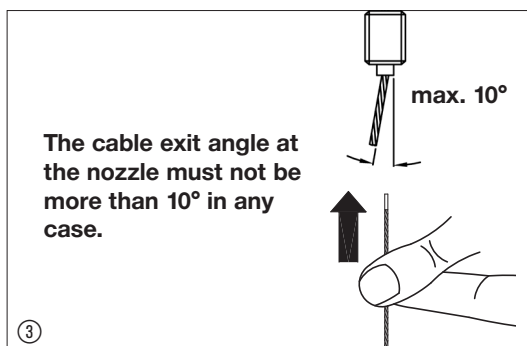

Assembly instruction

06.11.2020

TOCCATA Ø 1550 / 1900 mm

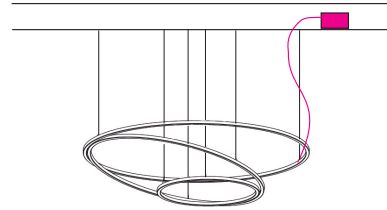

Wiring diagram mounting version A:

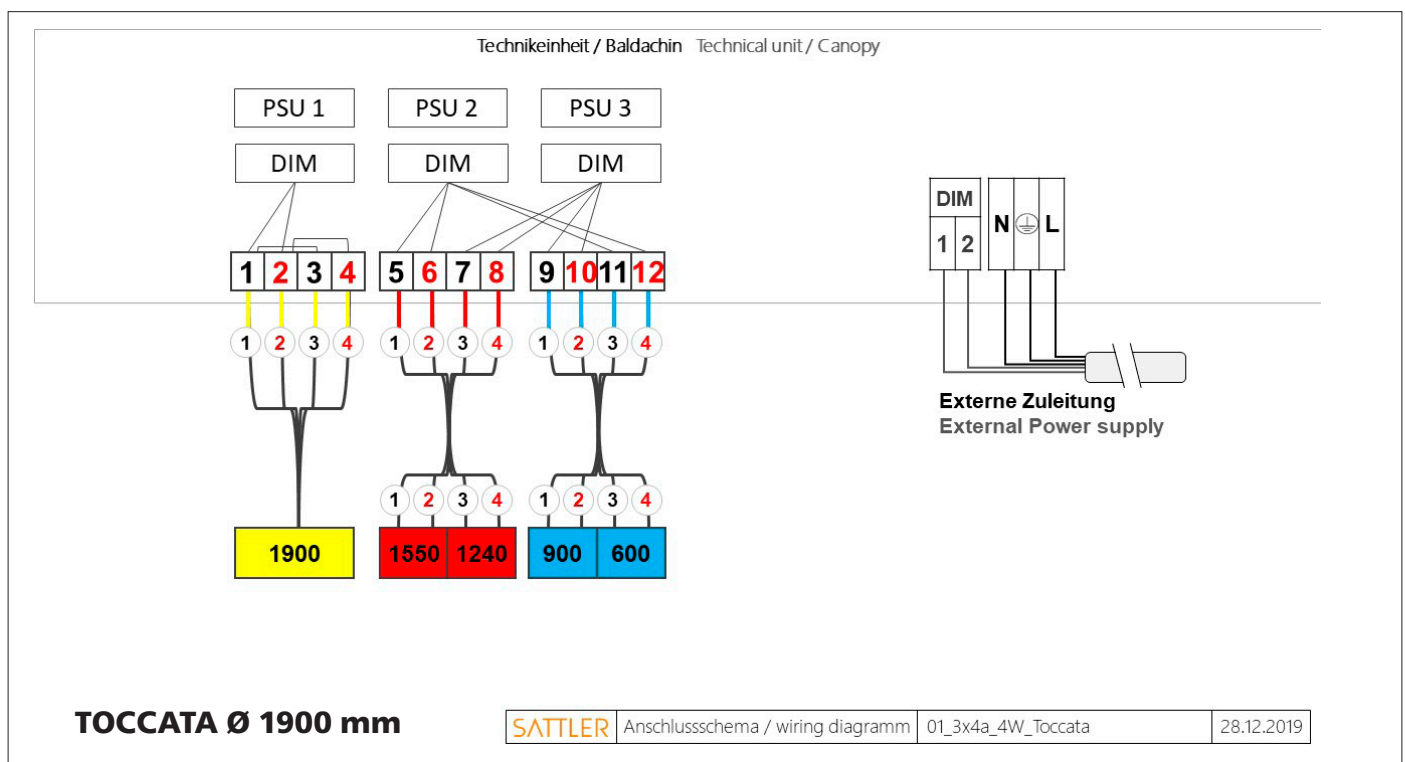
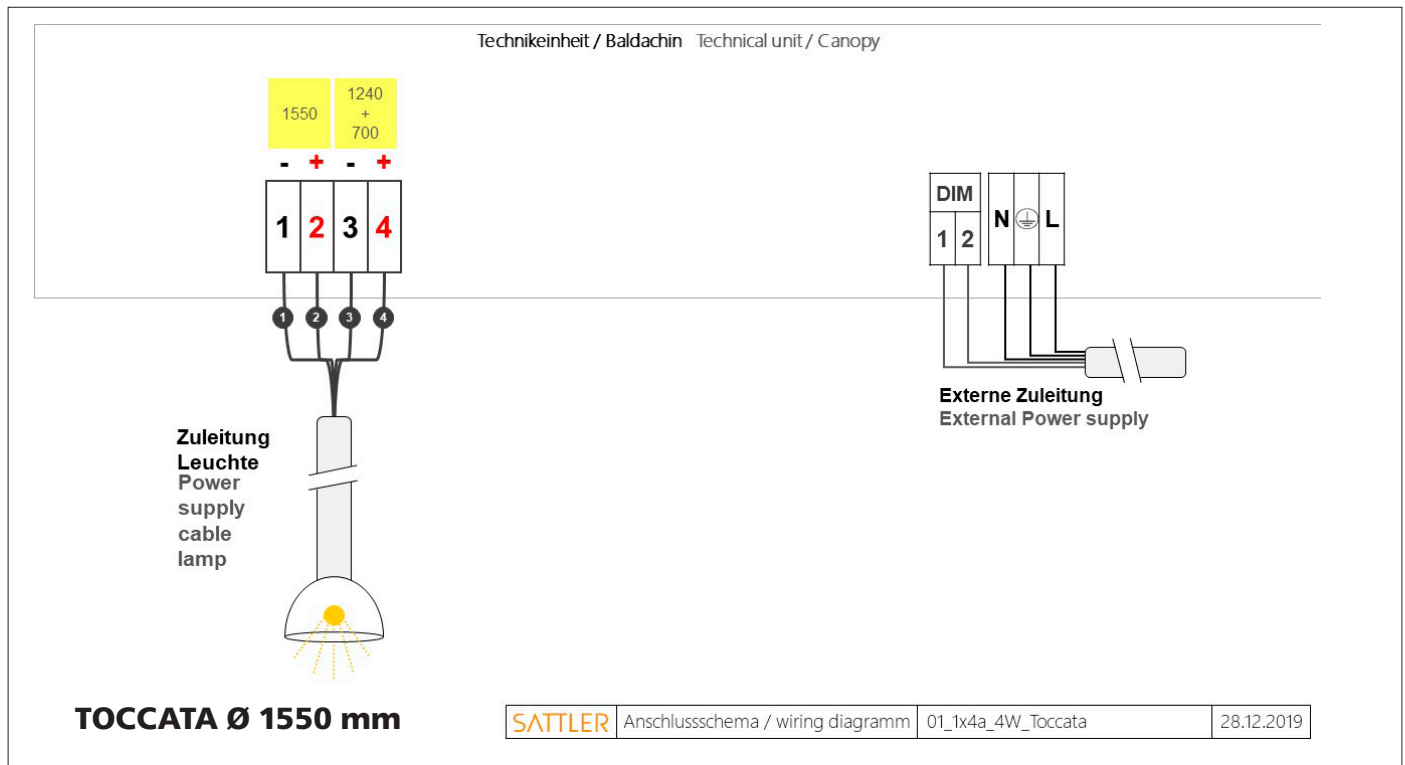

Assembly instruction

06.11.2020

TOCCATA Ø 1550 mm

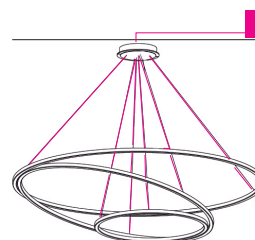

Wiring diagram mounting version J:

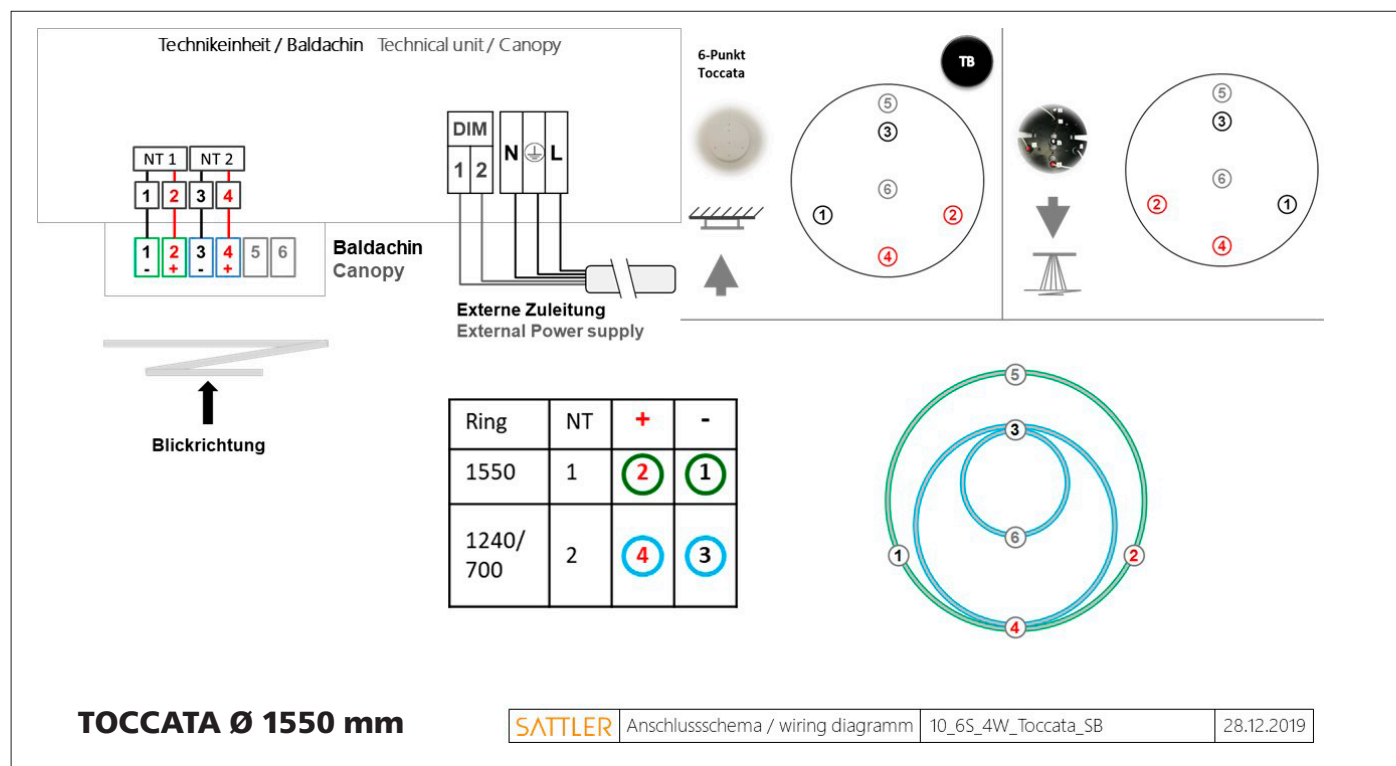

Assembly instruction

06.11.2020

TOCCATA Ø 1900 mm

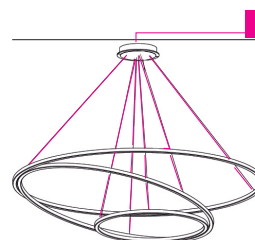

Wiring diagram mounting version J:

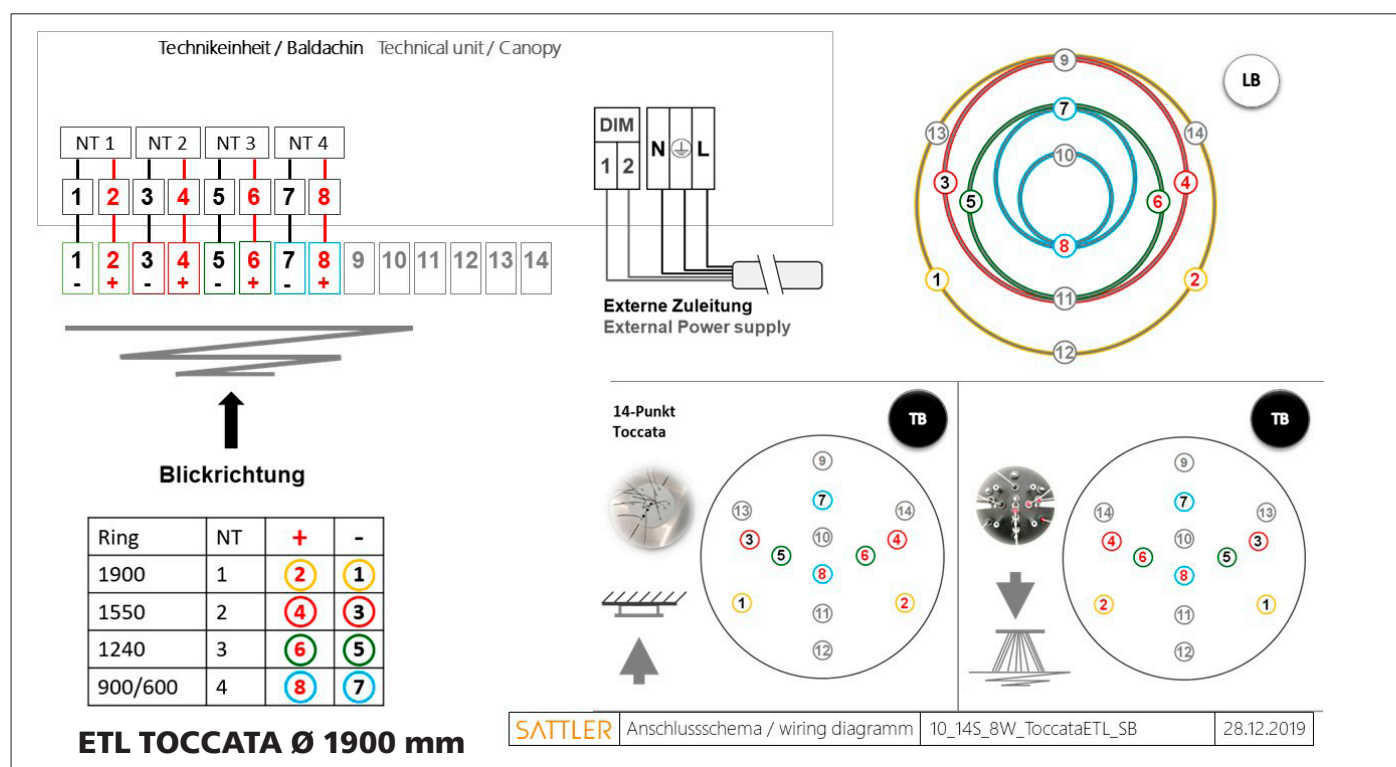
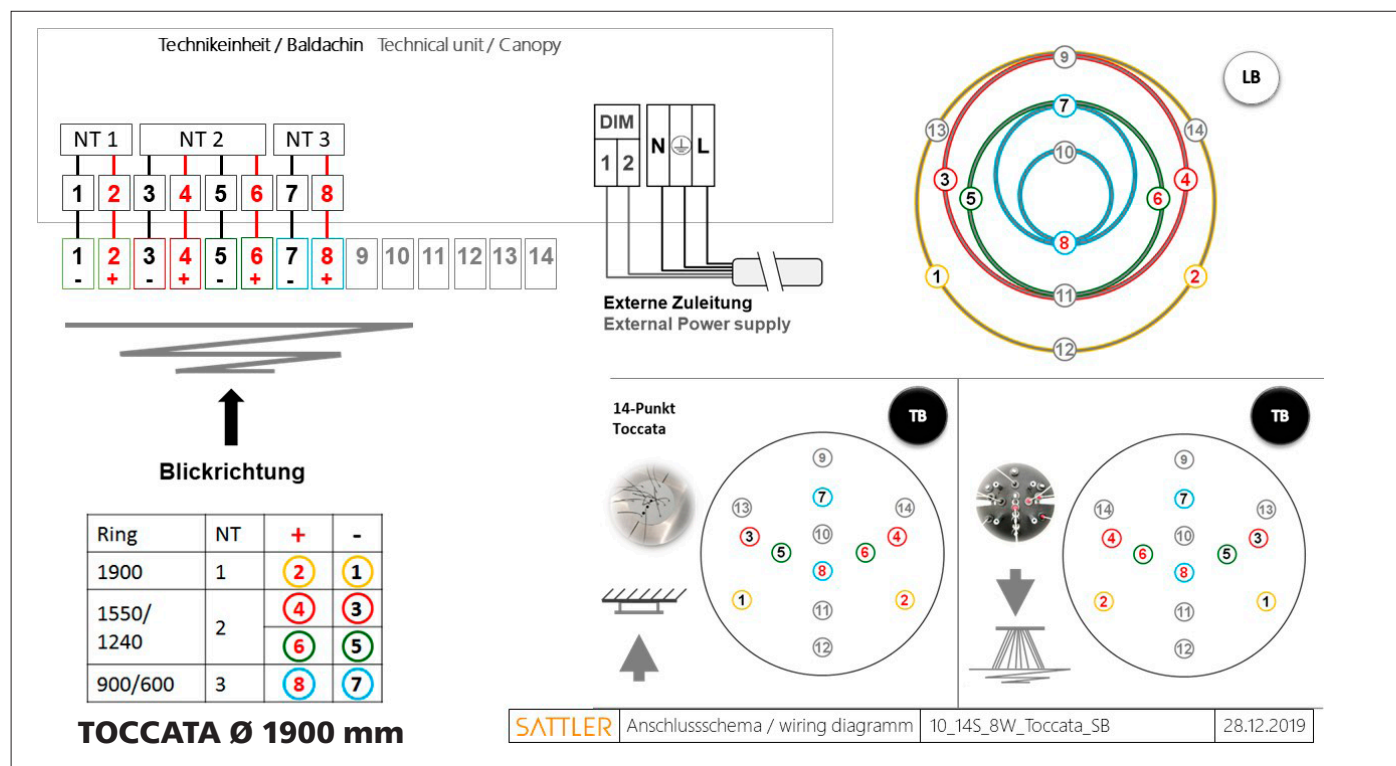

Assembly instruction

06.11.2020

TOCCATA Ø 1900 mm

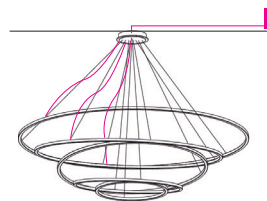

Wiring diagram mounting version I:

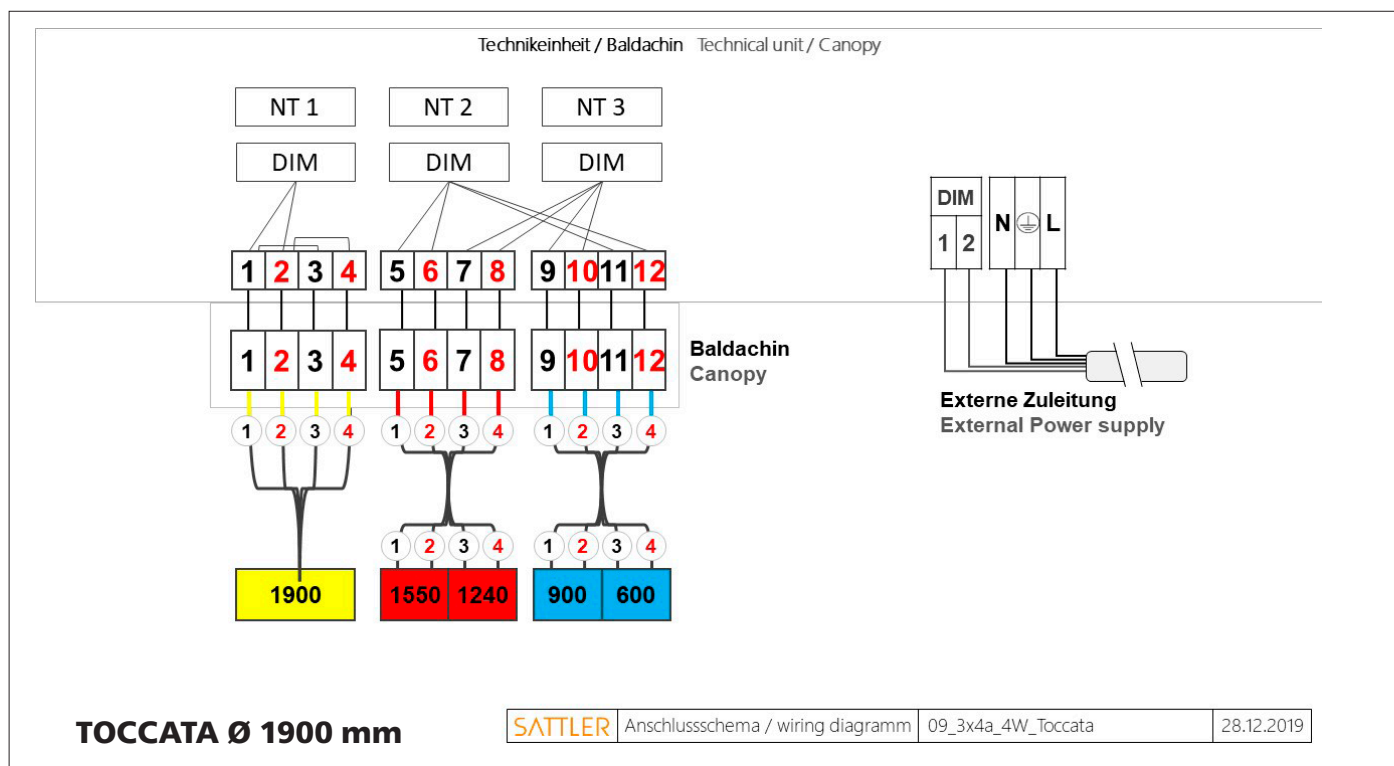

We will be glad to assist you with any further questions regarding the assembly of our light fixtures.

Contact: Inter-lux, 3741 Commerce Dr. #306-308, Baltimore, MD 21227. 410.381.1497 inter-lux.com

Legal disclaimer: Please make sure to adhere to all safety instructions. Every single assembly step is crucial in order to ensure the safety of the light fixture and the technician. Inter-lux and SATTLER GmbH cannot be held liable for any damages or injuries in case of negligence of safety instructions.