

1. **20 Linear Under Cabinet** Surface Mount standard satin opal lens  
WG-20LUC-SM-OD
2. **20 Linear Under Cabinet** Surface Mount with narrow lens  
WG-20LUC-SM-NL16
3. **20 Linear Under Cabinet** Surface Mount with black louver  
WG-20LUC-SM-LL45B

## 20 DELUXE SPECIFICATIONS

### Luminaire

- Standard Opal Diffuser for even illumination and no LED appearance.
- Field replaceable LED boards.

### Power

- L = 3.2W/ft low power (24V)
- M = 6.4W/ft mid power (24V)

### CRI/CCT (source lumens shown)

90+ CRI (low/mid power)

- 927 = 2700K, (332/614lm/ft)
- 930 = 3000K, (343/634 lm/ft)
- 935 = 3500K, (350/647 lm/ft)
- 940 = 4000K, (353/653 lm/ft)

### Multipliers

- OD = Satin Opal Lens (transmission 0.566)
- SD = Satin Clear Lens (transmission 0.732)
- ROD = Round Satin Opal Lens (transmission 0.731)
- LL45B = Linear Louver Black (transmission 0.19)
- NL16 = Linear Narrow Lens, 16° (transmission 0.676)

### Length

- A = specify inches to the nearest 0.25" (i.e. 72.25")

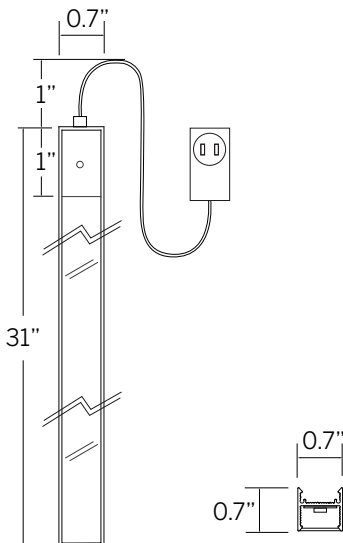

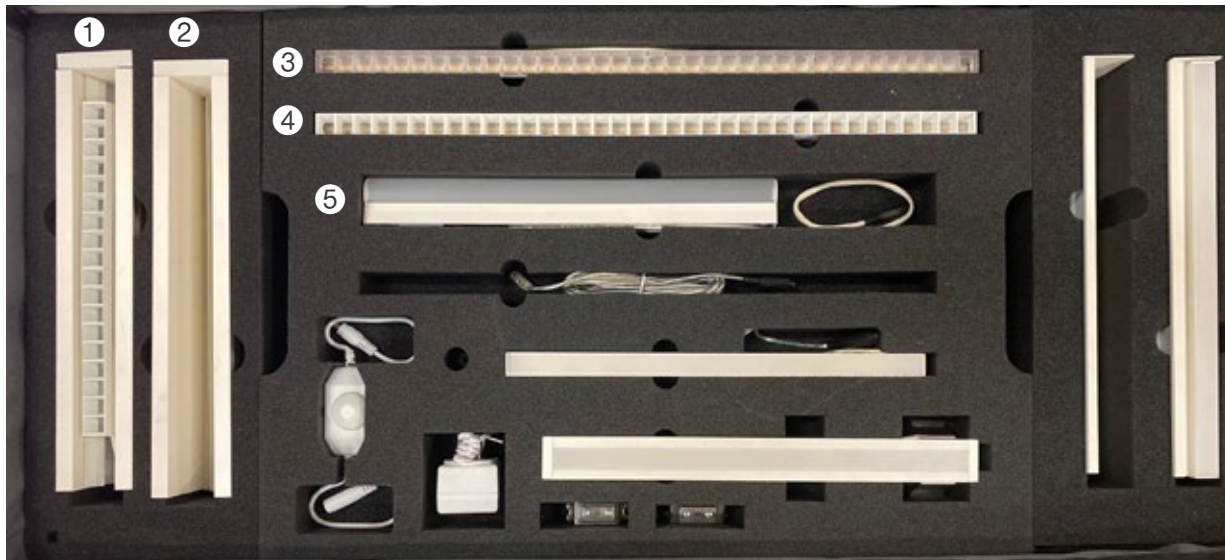

## 1. 20 Linear Recessed, Recessed Bezel Trim Flush Linear Louver White

WG-20LRF-RBT-LL45W

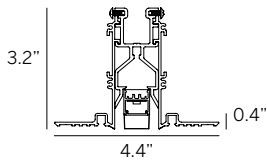

Recessed Plaster Trim (RPT)

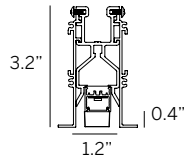

Recessed Bezel Trim (RBT)  
(shown)

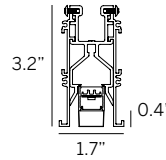

Recessed Return Trim (RRT)

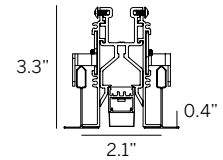

Recessed Grid Trim (RGT9/RGT15)

## 2. 20 Linear Recessed, Recessed Bezel Trim Regressed Satin Clear Lens

WG-20LRR-RPT-SD

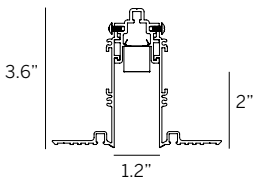

Recessed Plaster Trim (RPT)

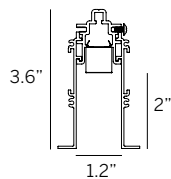

Recessed Bezel Trim (RBT)  
(shown)

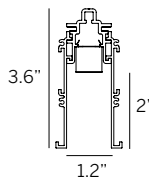

Recessed Return Trim (RRT)

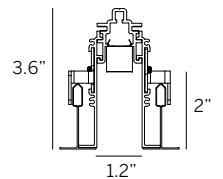

Recessed Grid Trim (RGT9/RGT15)

## 3. 20 Linear Surface Louver Satin Clear (LL45C)

## 4. 20 Linear Surface Louver White (LL45W)

WG-20LDL-SM

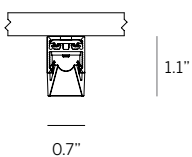

## 5. 20 Linear Surface Round Satin Opal Lens

WG-20LDL-SM-ROD

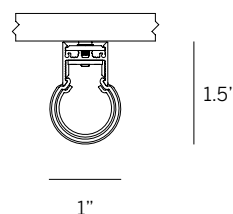

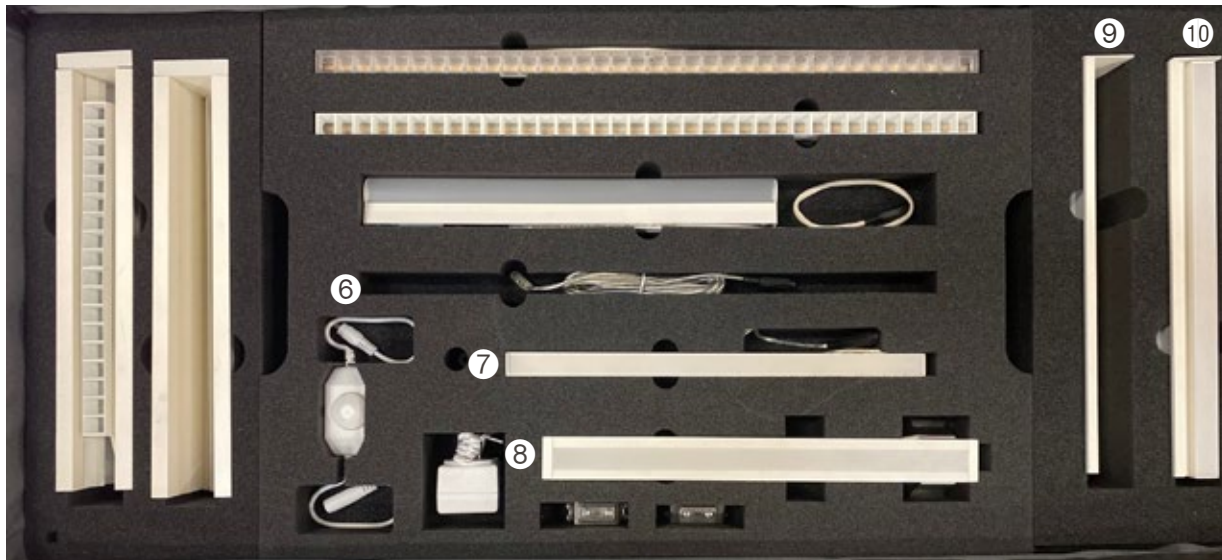

**6. 20 Linear Surface** Narrow Lens  
WG-20LDL-SM-NL16

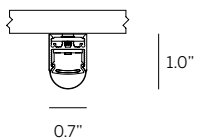

**7. 20 Linear Direct / Indirect** Suspended Satin Opal Lens / Satin Clear Lens  
WG-20LDI-S-OD-SD

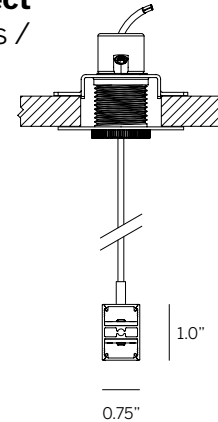

**8. 20 Linear Bezel Trim** Satin Opal Lens  
WG-20LDL-RBT-OD

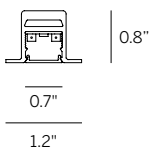

**9. 20 Linear Perimeter Recessed, Recessed Bezel Trim** Recessed Narrow Lens  
WG-20LPR-RBT-NL16

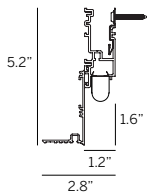

Recessed Plaster Trim (RPT)

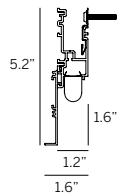

Recessed Bezel Trim (RBT)  
(shown)

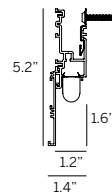

Recessed Return Trim (RRT)

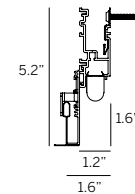

Recessed Grid Trim (RGT9/RGT15)

**10. 20 Linear Perimeter Flush, Recessed Bezel Trim** Flush Satin Opal Lens  
WG-20LPP-RBT-OD

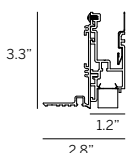

Recessed Plaster Trim (RPT)

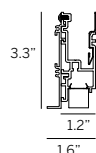

Recessed Bezel Trim (RBT)  
(shown)

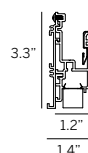

Recessed Return Trim (RRT)

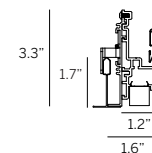

Recessed Grid Trim (RGT9/RGT15)

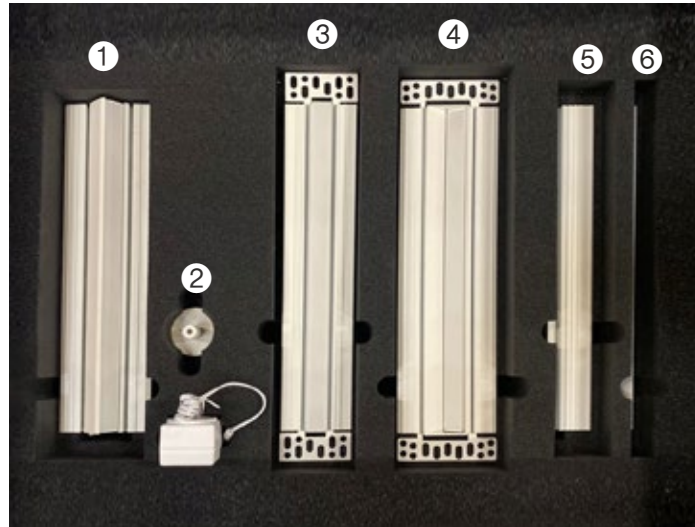

**1. 20 Linear Semi Recessed Wall Wash**  
Recessed Plaster Trim - Satin Opal Lens  
WG-20LWW-SRPT-OD

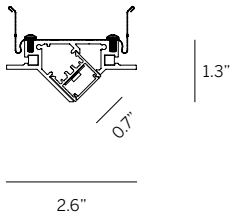

**4. 20 Linear Wall Wash Recessed**  
Plaster Trim - Satin Opal Lens  
WG-20LWW-RPT

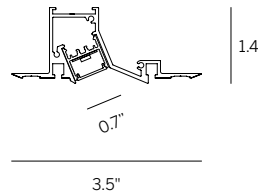

**2. Canopy for 20 Linear Direct / Indirect**  
Suspended

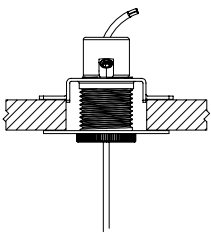

**5. 20 Linear Perimeter**  
Recessed Plaster Trim  
WG-20LP-RPT



**3. 20 Linear Recessed**  
Plaster Trim - Satin Opal Lens  
WG-20LDL-RPT-OD

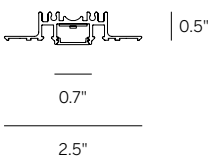

**6. 20 Linear Perimeter**  
Recessed Bezel Trim  
WG-20LPR-RBT

